

F.A.P. RTE.	SECTION	COUNTY	TOTAL SHEETS	SHEET NO.
704	(1)N & TS-1	McLEAN	497	97
STA. 16+150.000		TO STA. 16+238.730		
FED. ROAD DIST. NO.		ILLINOIS FED. AID PROJECT		

CONTRACT NO. 70514

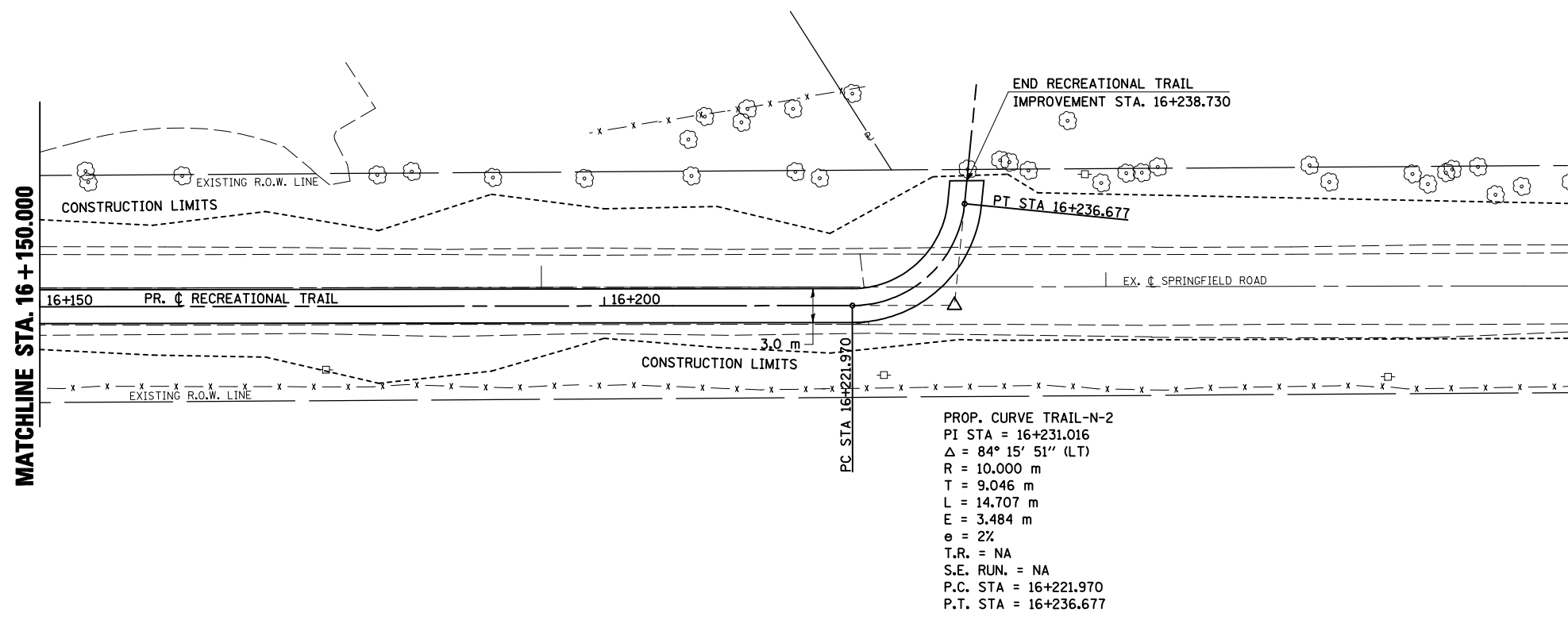
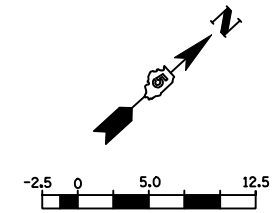

PROP. CURVE TRAIL-N-2
 PI STA = 16+231.016
 $\Delta = 84^\circ 15' 51''$ (LT)
 R = 10.000 m
 T = 9.046 m
 L = 14.707 m
 E = 3.484 m
 $e = 2\%$
 T.R. = NA
 S.E. RUN. = NA
 P.C. STA = 16+221.970
 P.T. STA = 16+236.677

FINAL SURVEY PLOTTED	BY	DATE
NOTE BOOK TEMPLATE AREAS CHECKED		
NO.		

DATE OF LAST REVISION: 05-27-09

ORIGINAL SURVEY PLOTTED	BY	DATE
NOTE BOOK TEMPLATE AREAS CHECKED		
NO.		

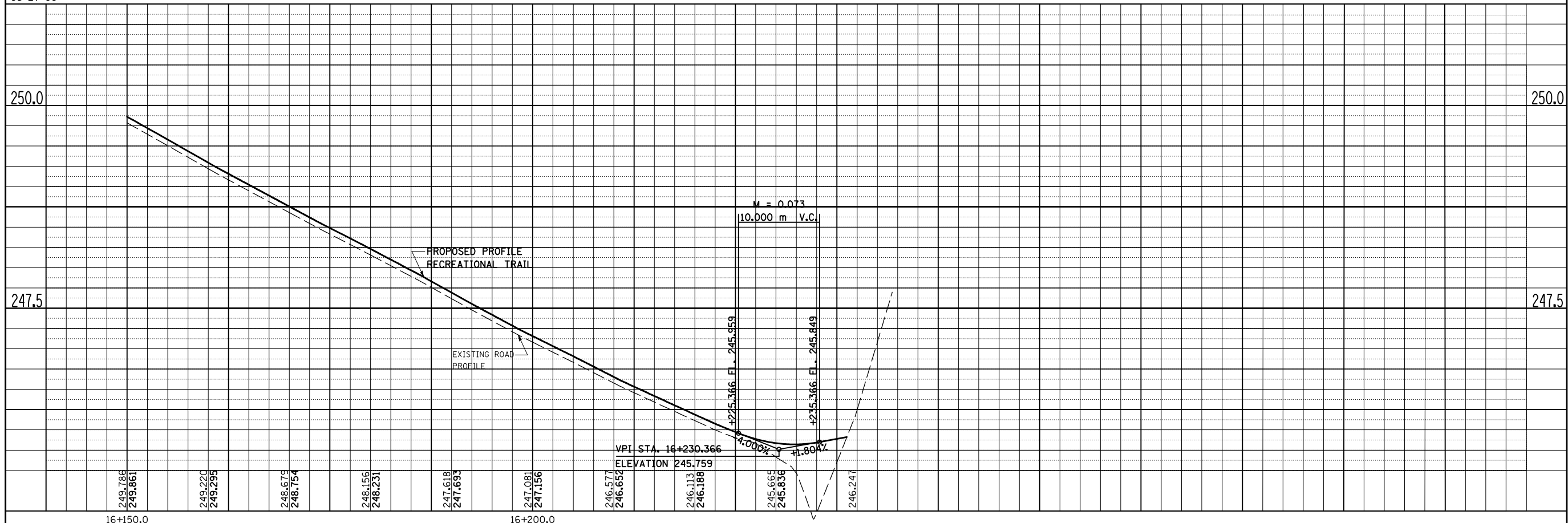

RECREATIONAL TRAIL, PLAN & PROFILE, STA. 16+150.000 TO STA. 16+238.730