

F.A.P. RTE.	SECTION	COUNTY	TOTAL SHEETS	SHEET NO.
704	(1)N & TS-1	McLEAN	497	129
STA. 10+300.000		TO STA. 10+600.000		
FED. ROAD DIST. NO.	ILLINOIS FED. AID PROJECT		CONTRACT NO. 70514	

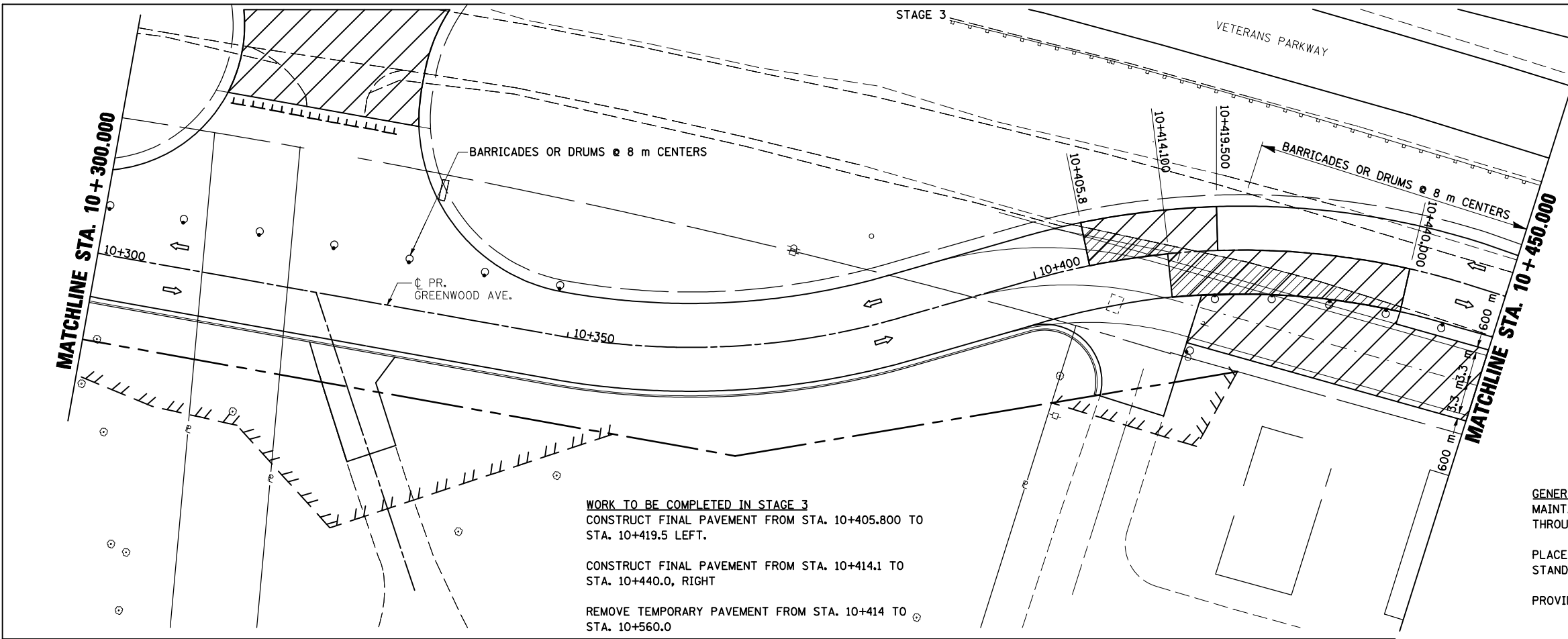

WORK TO BE COMPLETED IN STAGE 3

CONSTRUCT FINAL PAVEMENT FROM STA. 10+405.800 TO STA. 10+419.5 LEFT.

CONSTRUCT FINAL PAVEMENT FROM STA. 10+414.1 TO STA. 10+440.0, RIGHT

REMOVE TEMPORARY PAVEMENT FROM STA. 10+414 TO STA. 10+560.0

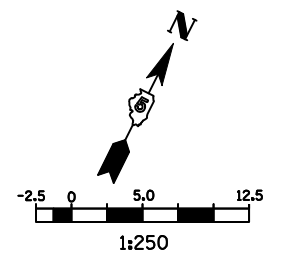

- LEGEND**
- ⊥ TYPE III BARRICADE
 - ↑ SIGN
 - DRUM, BARRICADE OR VERTICAL BARRICADE WITH STEADY BURNING LIGHT
 - ▨ WORK AREA
 - ▩ TEMPORARY PAVEMENT
 - ⇨ DIRECTION OF TRAFFIC

GENERAL STAGING NOTES

MAINTAIN ACCESS TO ALL ADJACENT PROPERTIES THROUGHOUT THE DURATION OF THE PROJECT.

PLACE TYPE III BARRICADES IN ACCORDANCE WITH STANDARD 701901.

PROVIDE TEMPORARY MAILBOX SERVICE.

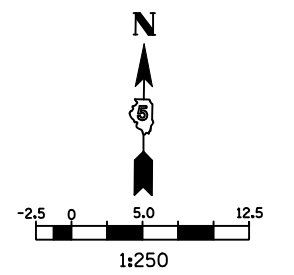
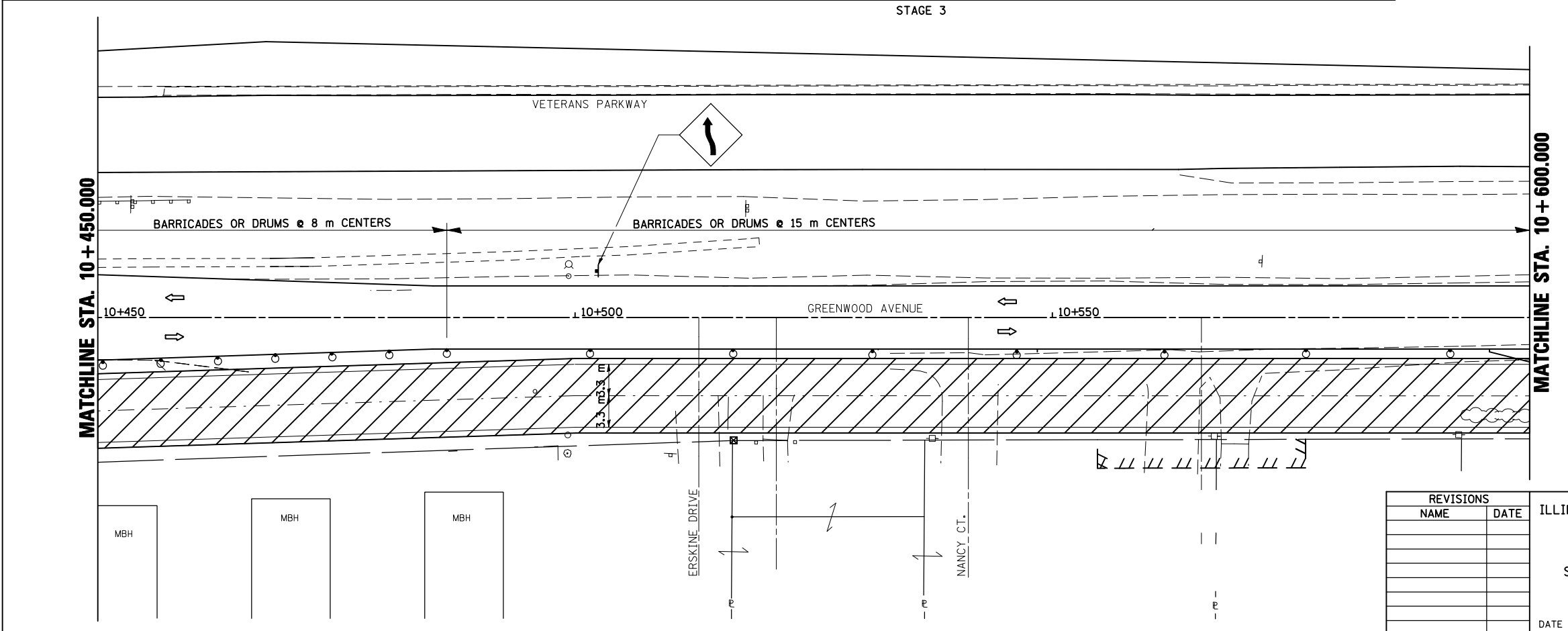

- LEGEND**
- ⊥ SIGN
 - DRUM, BARRICADE OR VERTICAL BARRICADE WITH STEADY BURNING LIGHT
 - ▨ WORK AREA
 - ▩ TEMPORARY PAVEMENT
 - ⇨ DIRECTION OF TRAFFIC

REVISIONS	
NAME	DATE

ILLINOIS DEPARTMENT OF TRANSPORTATION

STAGING PLANS
STAGE 3 GREENWOOD AVENUE (EAST)

DATE 05-27-09

DRAWN BY SAM
CHECKED BY PMH

PLOT DATE = 8/12/2010
FILE NAME = c:\pwworkspace\11818\stage3\stage3.dgn
PLOT SCALE = 1:250000 m / in.
USER NAME = craig

STAGING PLANS, STAGE 3 GREENWOOD AVENUE (EAST)