

F.A.P. RTE.	SECTION	COUNTY	TOTAL SHEETS	SHEET NO.
704	(1)N & TS-1	McLEAN	497	170
STA. 0+515.000		TO STA. 0+650.000		
FED. ROAD DIST. NO.		ILLINOIS FED. AID PROJECT		

CONTRACT NO. 70514

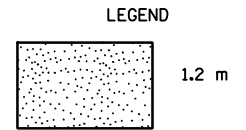
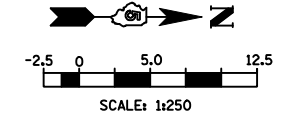

EXCAVATION NOT TO EXCEED LISTED DEPTH UNLESS APPROVED BY THE ENGINEER

(TB X) TRENCH BACKFILL QUANTITY

NO.	AREAS CHECKED	DATE	BY

NO.	AREAS CHECKED	DATE	BY

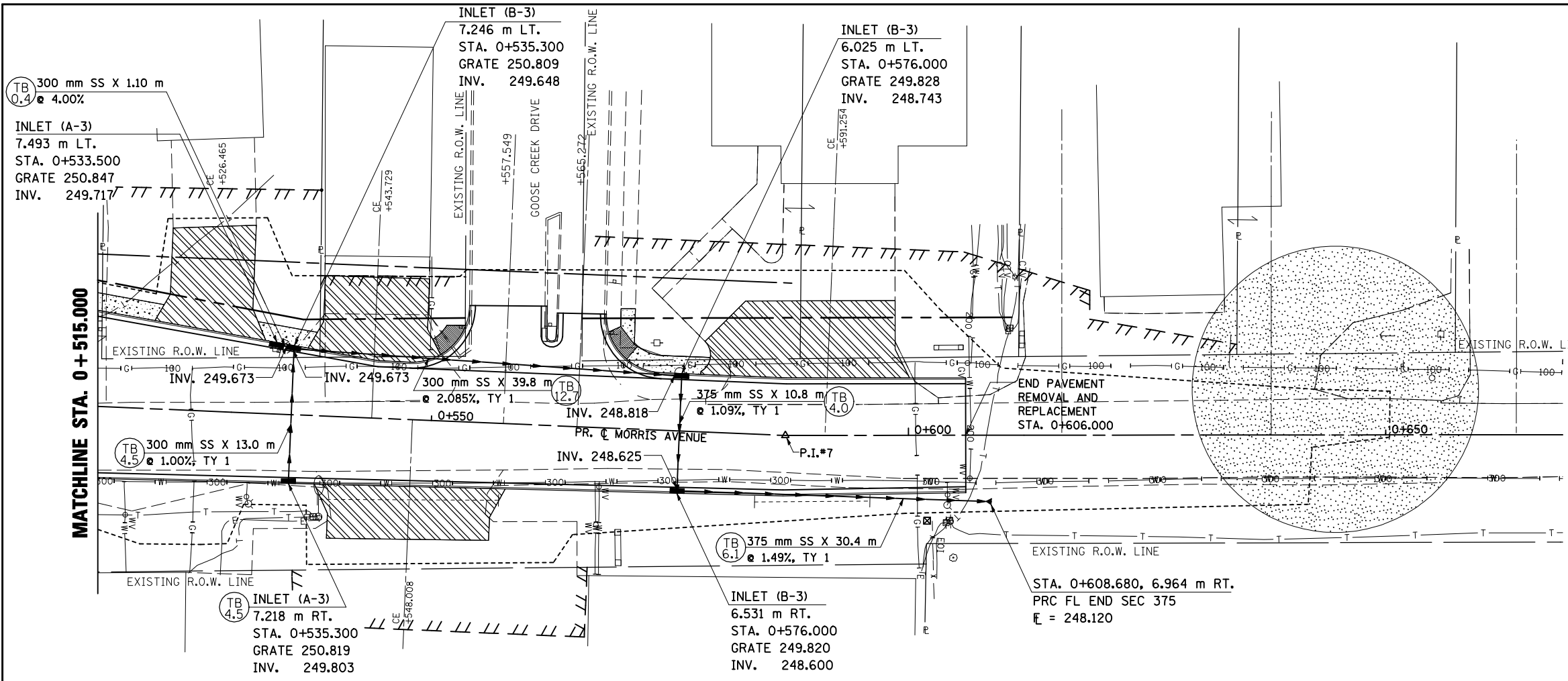

DATE OF LAST REVISION: 05-27-09

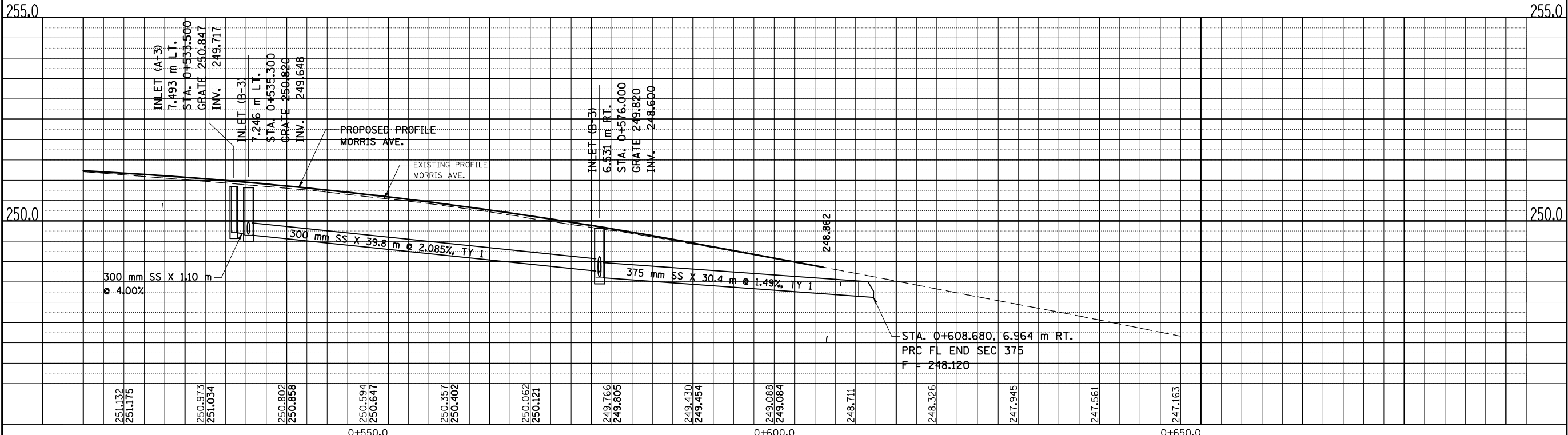

MORRIS AVENUE, DRAINAGE & UTILITIES SHEETS, STA. 0 + 515.000 TO STA. 0 + 650.000