

F.A.P. RTE.	SECTION	COUNTY	TOTAL SHEETS	SHEET NO.
704	(1)N & TS-1	McLEAN	70514	185
STA. 10+600.000		TO STA. 10+715.000		
FED. ROAD DIST. NO.		ILLINOIS FED. AID PROJECT		
CONTRACT NO. 70514				

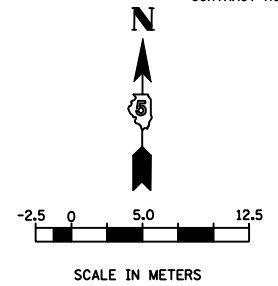

BY	DATE
FINAL SURVEY PLOTTED	
NOTE BOOK TEMPLATE	
AREAS CHECKED	
NO.	

BY	DATE
ORIGINAL SURVEY PLOTTED	
NOTE BOOK TEMPLATE	
AREAS CHECKED	
NO.	

PLOT DATE = 8/2/2010  
 FILE NAME = c:\pwworkspace\orange\eddis\10+600 to 10+715.dwg  
 USER NAME = orange

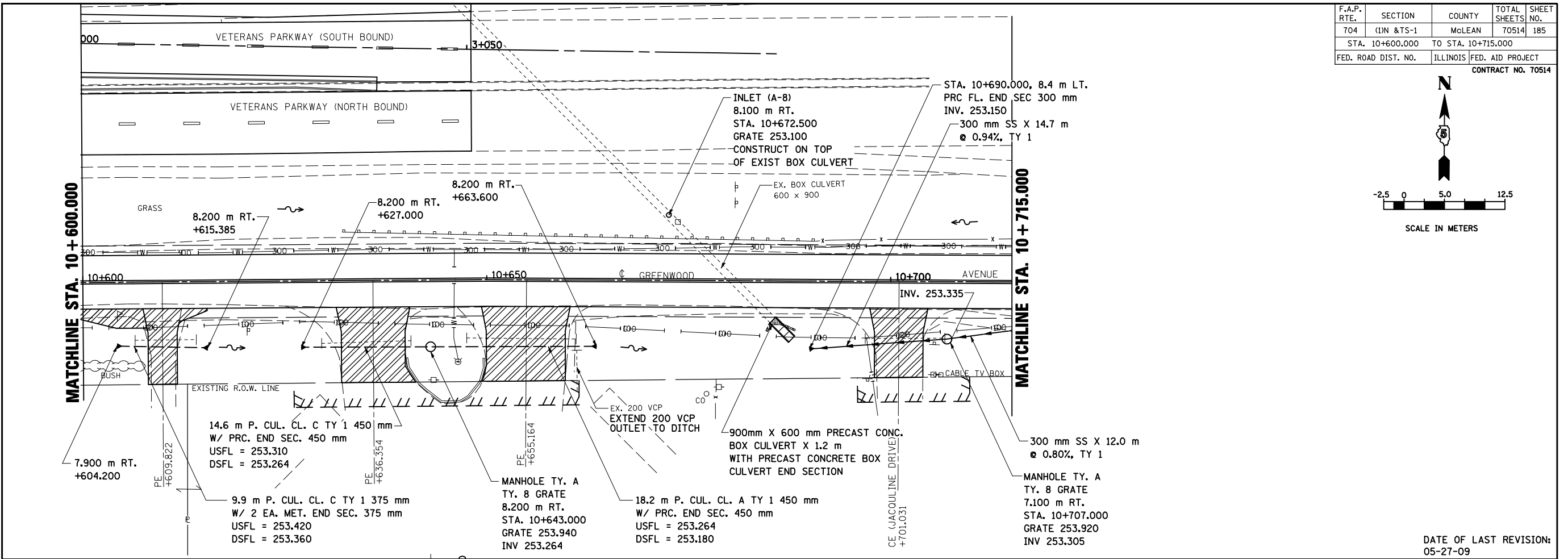

DATE OF LAST REVISION: 05-27-09

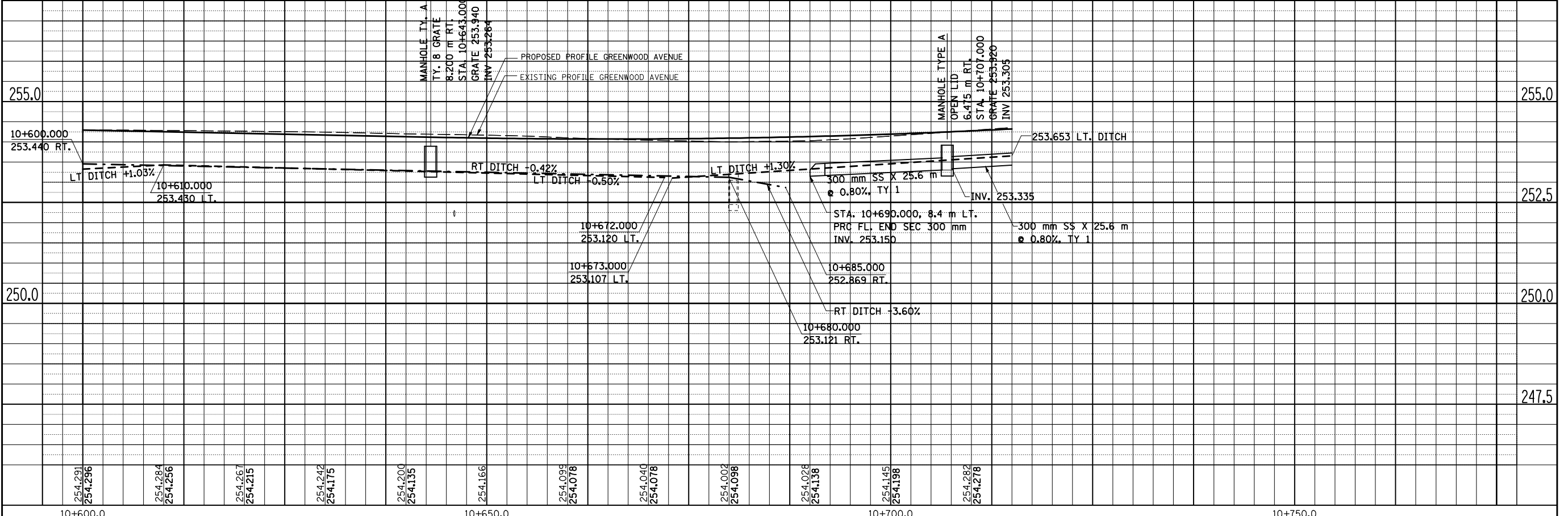

**GREENWOOD AVENUE, DRAINAGE & UTILITIES SHEETS, STA. 10+600.000 TO STA. 10+715.000**