

F.A.P. RTE.	SECTION	COUNTY	TOTAL SHEETS	SHEET NO.
704	(1)N & TS-1	McLEAN	497	215
STA. 0+185.000		TO STA. 0+325.000		
FED. ROAD DIST. NO.		ILLINOIS FED. AID PROJECT		
CONTRACT NO. 70514				

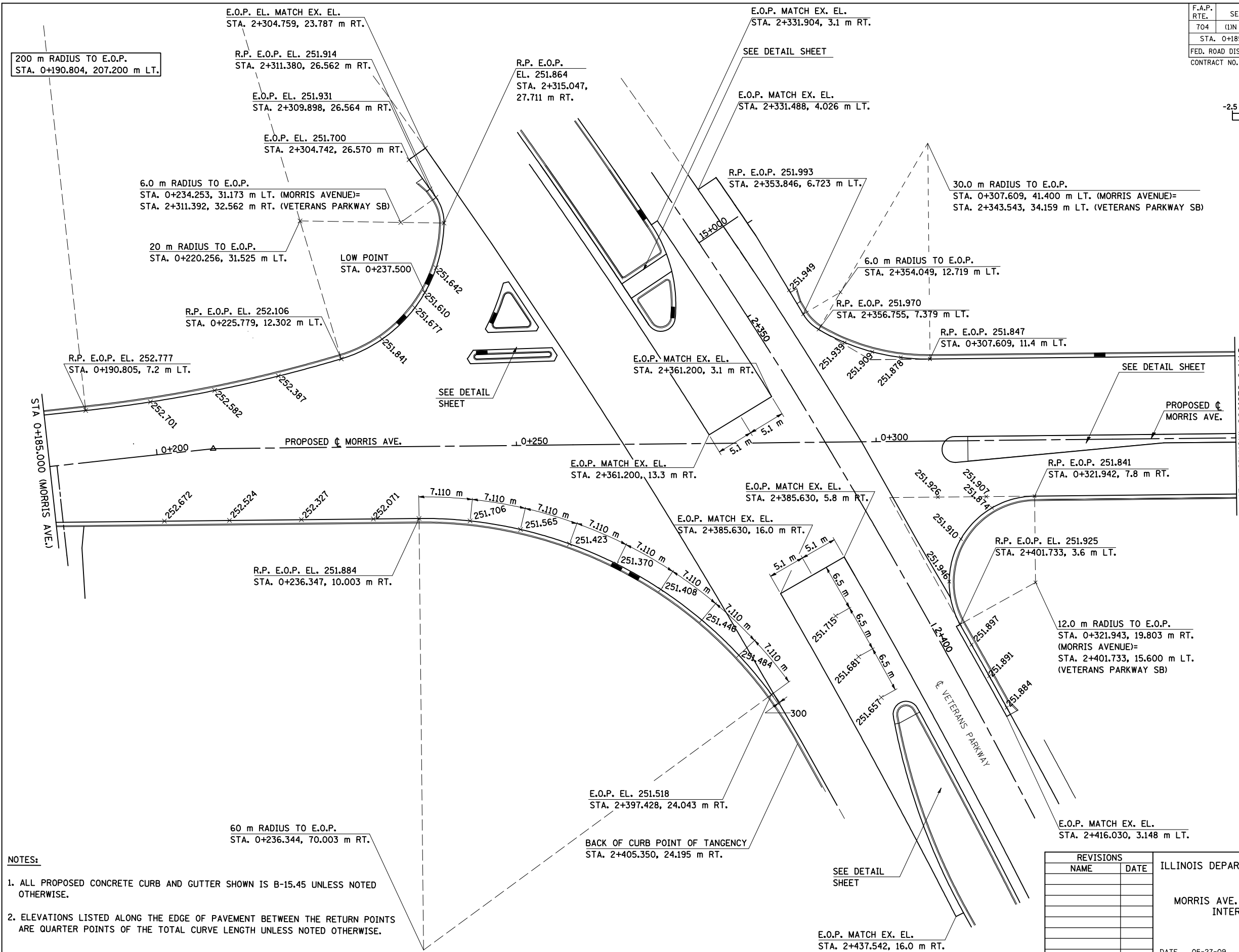
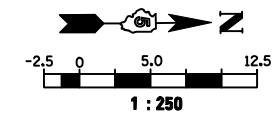

- NOTES:**
1. ALL PROPOSED CONCRETE CURB AND GUTTER SHOWN IS B-15.45 UNLESS NOTED OTHERWISE.
  2. ELEVATIONS LISTED ALONG THE EDGE OF PAVEMENT BETWEEN THE RETURN POINTS ARE QUARTER POINTS OF THE TOTAL CURVE LENGTH UNLESS NOTED OTHERWISE.

REVISIONS		ILLINOIS DEPARTMENT OF TRANSPORTATION
NAME	DATE	
		MORRIS AVE. AND VETERANS PARKWAY INTERSECTION DETAILS  DRAWN BY SAM CHECKED BY PMH DATE 05-27-09