

| | | | | |
|---------------------|-------------|----------|------------------|-----------|
| F.A.P. RTE. | SECTION | COUNTY | TOTAL SHEETS | SHEET NO. |
| 704 | (1)N & TS-1 | McLEAN | 497 | 216 |
| STA. | | TO STA. | | |
| FED. ROAD DIST. NO. | | ILLINOIS | FED. AID PROJECT | |
| CONTRACT NO. 70514 | | | | |

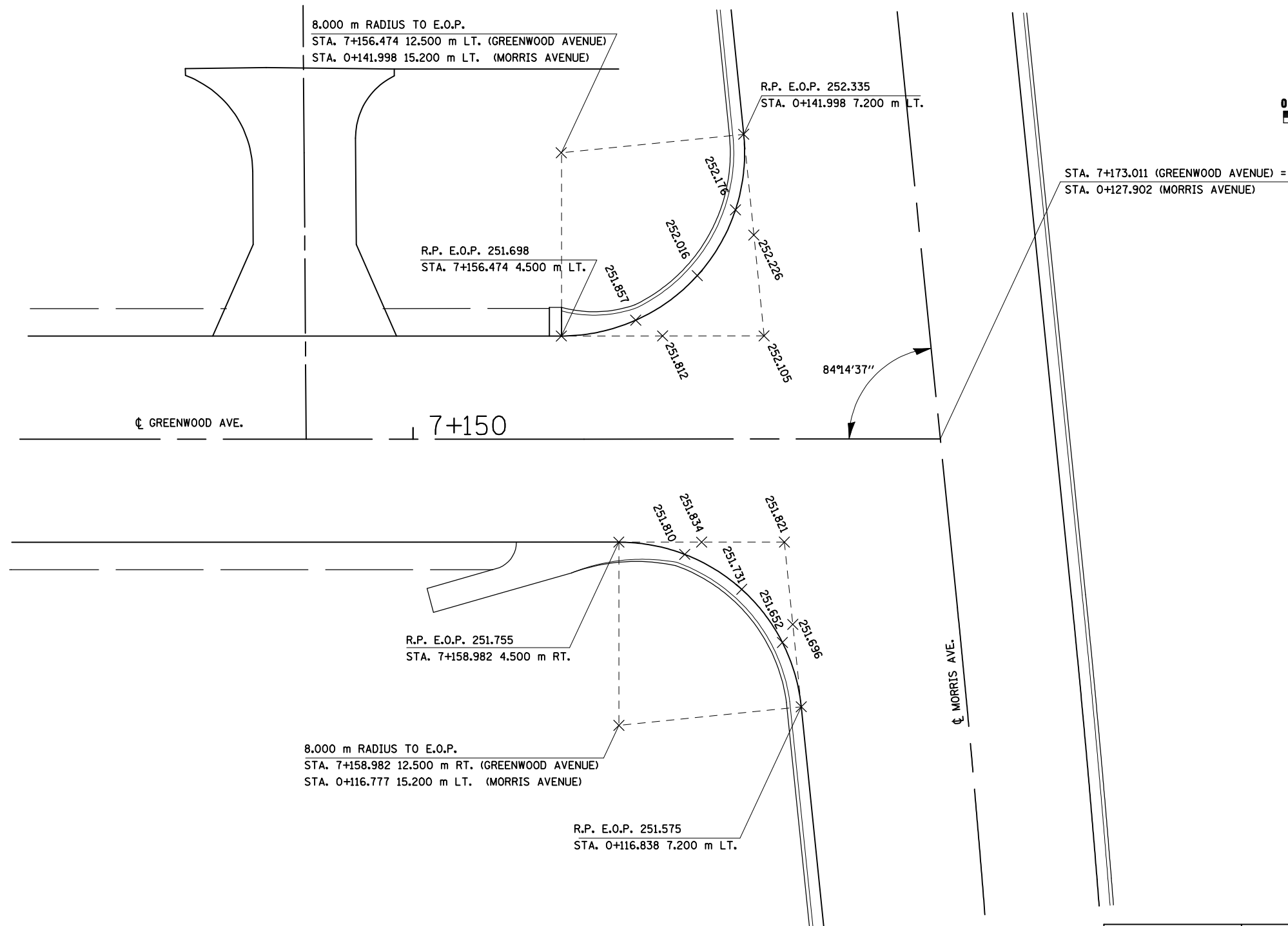
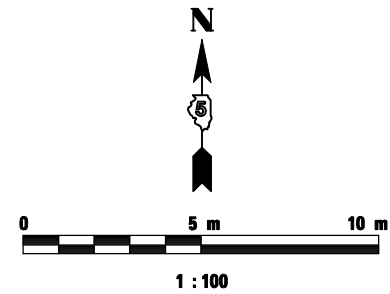

NOTES:

1. ALL PROPOSED CONCRETE CURB AND GUTTER SHOWN IS B-15.45 UNLESS NOTED OTHERWISE.
2. ELEVATIONS LISTED ALONG THE EDGE OF PAVEMENT BETWEEN THE RETURN POINTS ARE QUARTER POINTS OF THE TOTAL CURVE LENGTH.

| REVISIONS | | ILLINOIS DEPARTMENT OF TRANSPORTATION |
|-----------|------|---|
| NAME | DATE | |
| | | MORRIS AVENUE AND GREENWOOD AVENUE INTERSECTION DETAILS |
| | | |
| | | |
| | | |
| | | |
| | | DATE 05-27-09 |
| | | DRAWN BY BER CHECKED BY PMH |