

F.A.P. RTE.	SECTION	COUNTY	TOTAL SHEETS	SHEET NO.
704	(11N & TS-1)	McLEAN	497	238
STA. 0+057.000		TO STA. 0+350.000		
FED. ROAD DIST. NO.	ILLINOIS FED. AID PROJECT		CONTRACT NO. 70514	

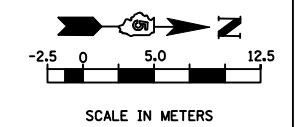
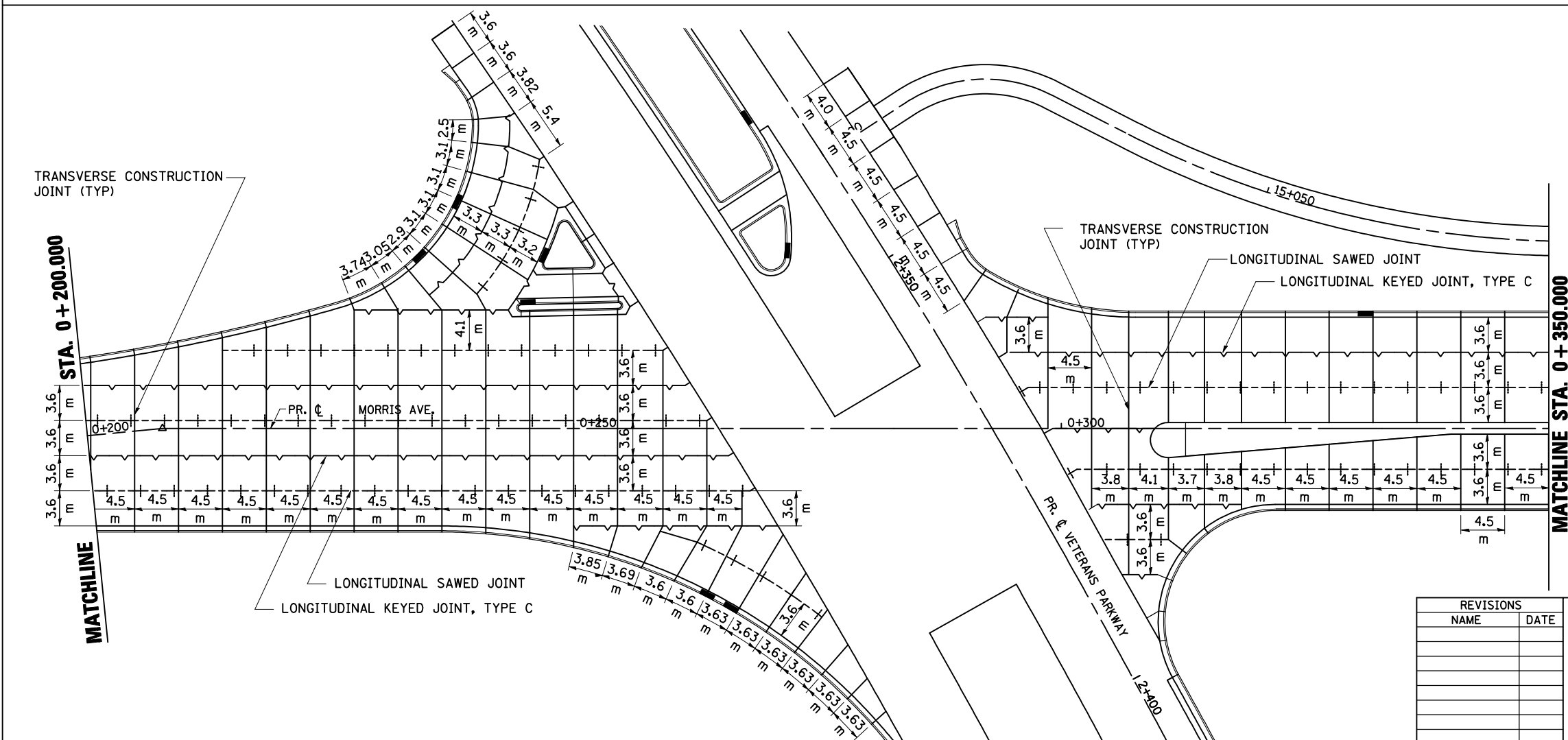
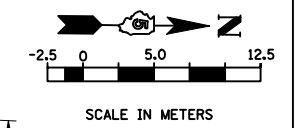
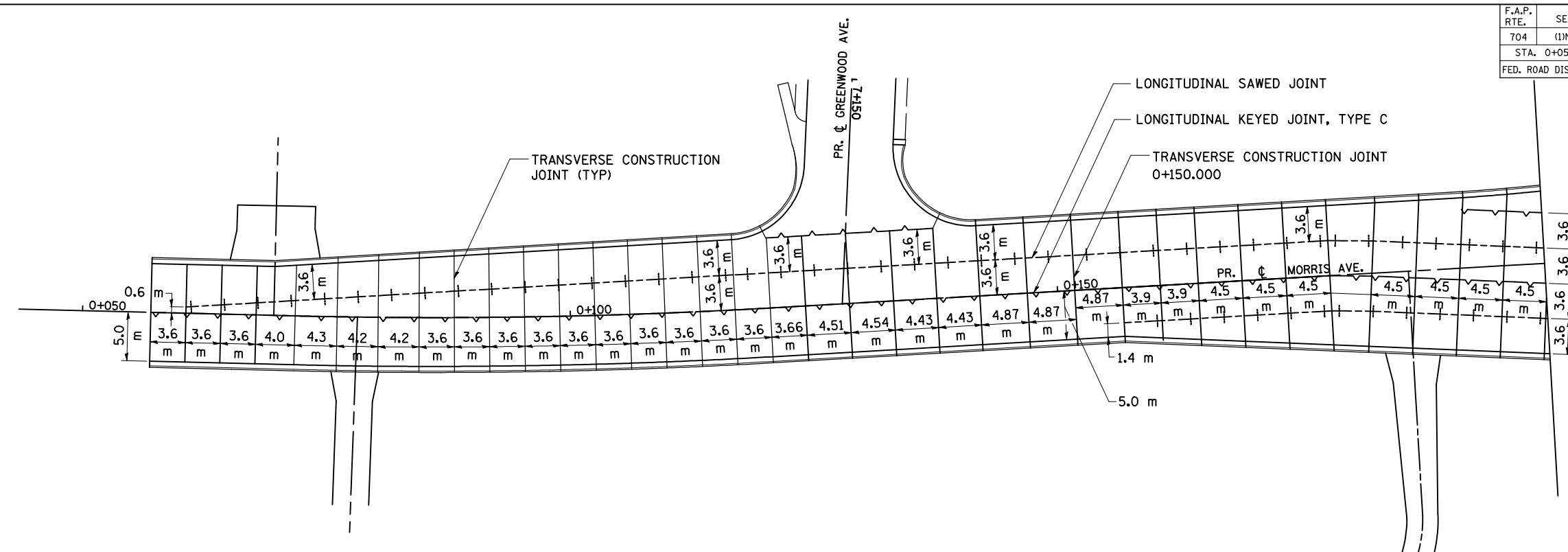

REVISIONS		ILLINOIS DEPARTMENT OF TRANSPORTATION
NAME	DATE	
		PAVEMENT JOINTING PLAN MORRIS AVENUE DRAWN BY SAM CHECKED BY PMH DATE 05-27-09

MORRIS AVENUE PAVEMENT JOINTING PLAN STA. 0+057.000 TO STA. 0+350.000