

F.A.P. RTE.	SECTION	COUNTY	TOTAL SHEETS	SHEET NO.
704	(1)N & TS-1	McLEAN	497	331
STA. 2+430.000 TO STA. 2+440.000				
FED. ROAD DIST. NO.		ILLINOIS FED. AID PROJECT		
CONTRACT NO. 70514				

BY	DATE
FINAL SURVEY	SURVEYED
NOTE BOOK NO.	PLOTTED
	DATE
	AREAS CHECKED

BY	DATE
ORIGINAL SURVEY	SURVEYED
NOTE BOOK NO.	PLOTTED
	DATE
	AREAS CHECKED

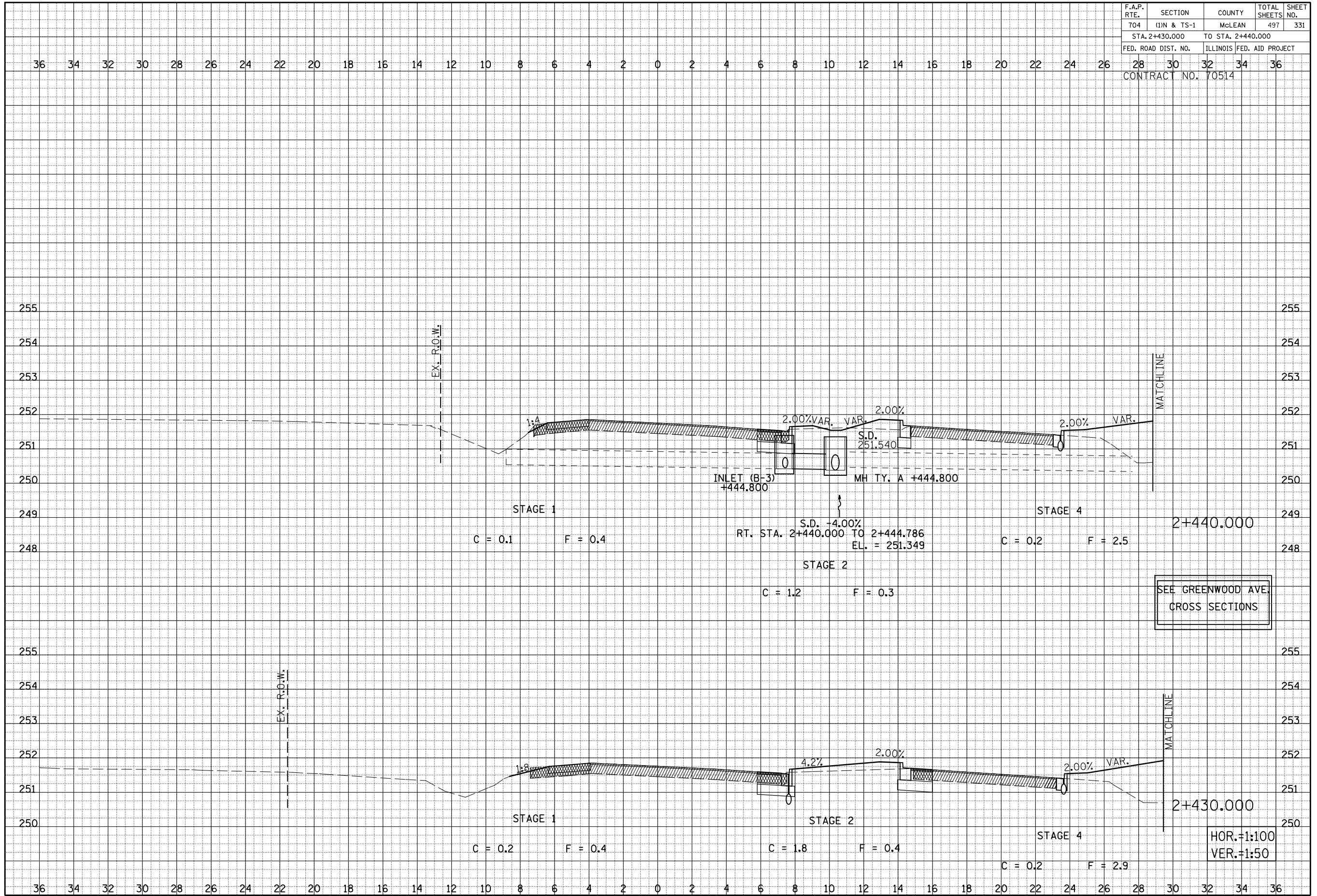

VETERANS PARKWAY CROSS SECTIONS, STA. 2+430.000 TO STA. 2+440.000