

F.A.P. RTE.	SECTION	COUNTY	TOTAL SHEETS	SHEET NO.
704	(1)N&TS-1	MCLEAN	497	375
STA. 0+430.000 TO STA. 0+440.000				
ILLINOIS FED. AID PROJECT				

CONTRACT NO. 70514

BY	DATE

BY	DATE

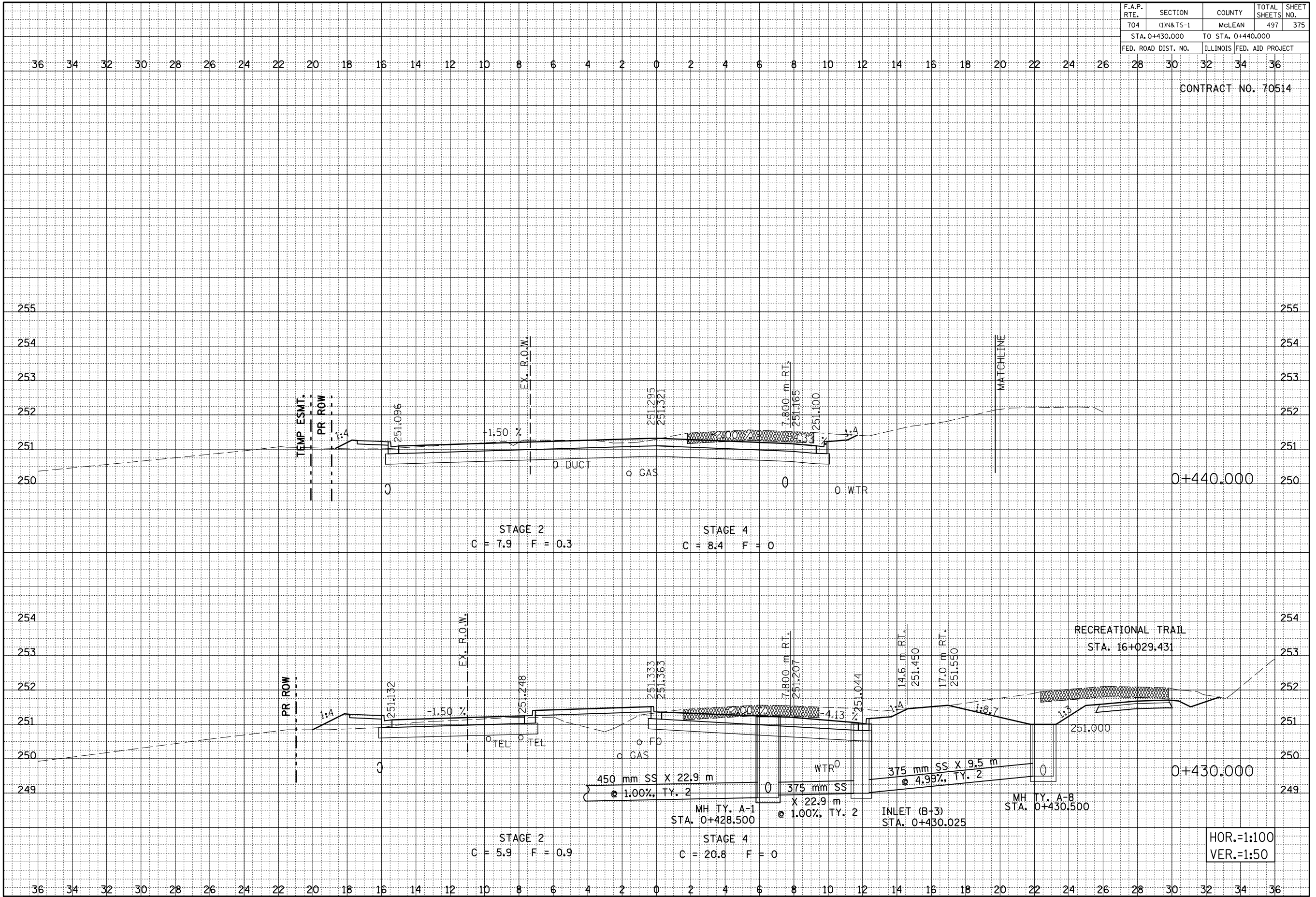

HOR.=1:100  
VER.=1:50

MORRIS AVENUE, CROSS SECTIONS, STA. 0+430.000 TO STA. 0+440.000