

F.A.S. RTE. 704	SECTION (11N & TS-1)	COUNTY MCLEAN	TOTAL SHEETS 497	SHEET NO. 398
STA. 0+290.000		TO STA. 0+299.373		
FED. ROAD DIST. NO.		ILLINOIS FED. AID PROJECT		

BY	DATE
ORIGINAL SURVEY PLOTTED	SURVEYED
NOTE BOOK NO.	PLANTING AREAS
	AREAS CHECKED

BY	DATE
ORIGINAL SURVEY PLOTTED	SURVEYED
NOTE BOOK NO.	PLANTING AREAS
	AREAS CHECKED

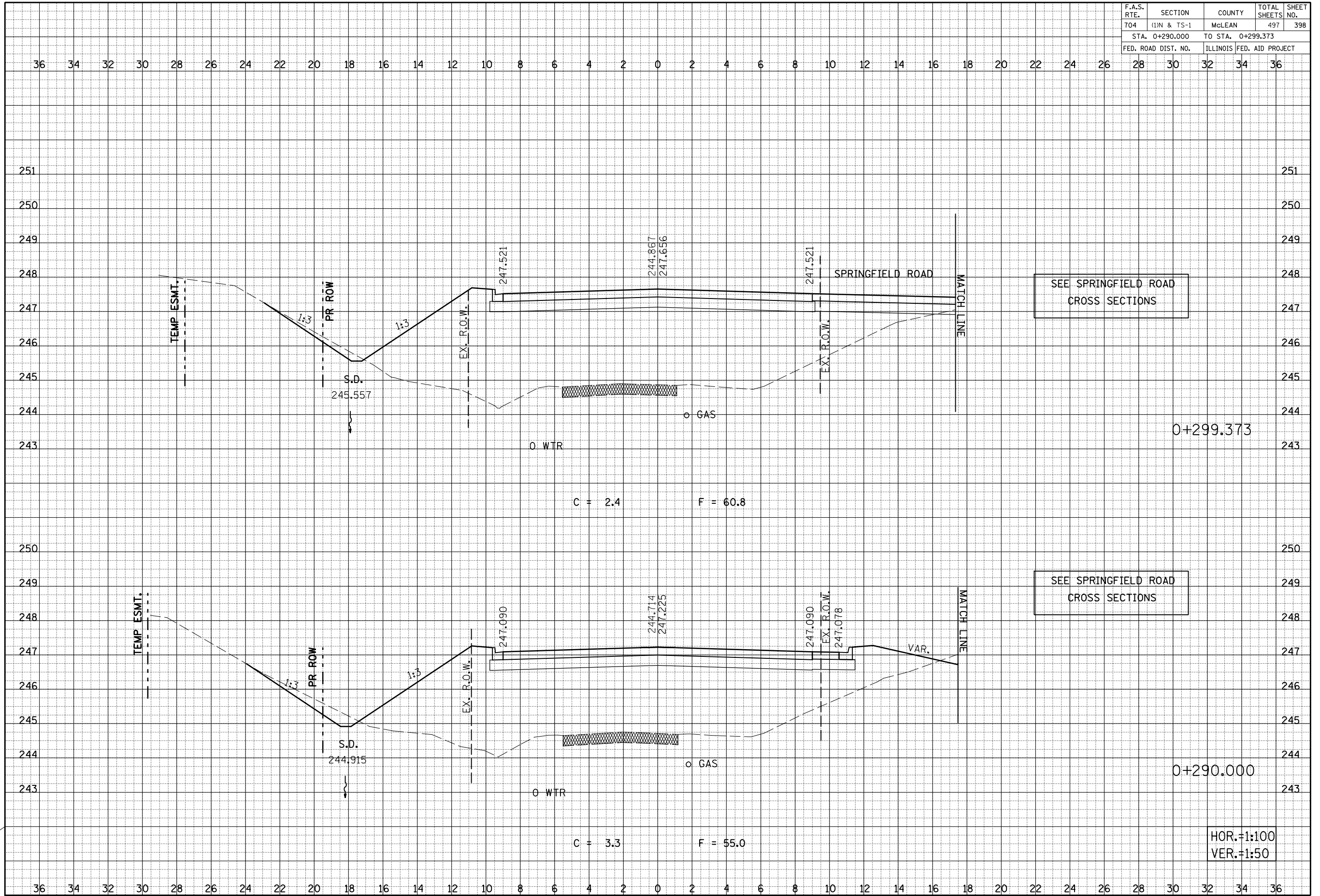

C = 2.4      F = 60.8

C = 3.3      F = 55.0

SEE SPRINGFIELD ROAD  
CROSS SECTIONS

SEE SPRINGFIELD ROAD  
CROSS SECTIONS

0+299.373

0+290.000

HOR.=1:100  
VER.=1:50

SIX POINTS ROAD CROSS SECTIONS, STA. 0+290.000 TO STA. 0+299.373