

F.A.S. RTE.	SECTION	COUNTY	TOTAL SHEETS	SHEET NO.
704	(1)N & TS-1	MCLEAN	497	400
STA. 0+320.000		TO STA. 0+320.000		
FED. ROAD DIST. NO.		ILLINOIS FED. AID PROJECT		

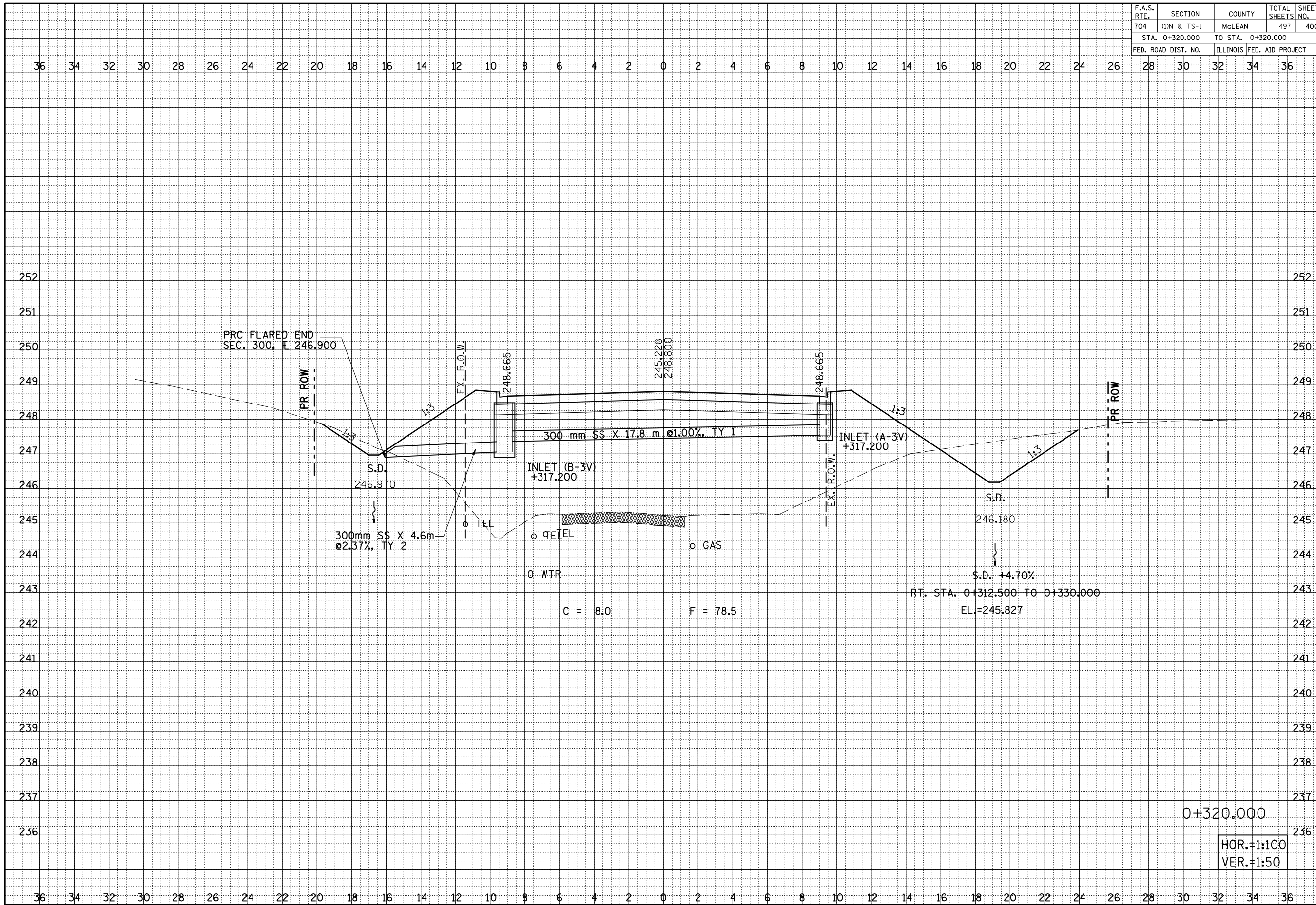

SIX POINTS ROAD CROSS SECTIONS, STA. 0+320.000

BY	DATE

FINAL SURVEY NOTE BOOK NO.	SURVEYED PLOTTED AREAS CHECKED

BY	DATE

ORIGINAL SURVEY NOTE BOOK NO.	SURVEYED PLOTTED AREAS CHECKED