

F.A.P. RTE.	SECTION	COUNTY	TOTAL SHEETS	SHEET NO.
704	(1)N&TS-1	MGLEAN	497	427
STA. 1+030.000 TO STA. 1+040.000				
FED. ROAD DIST. NO.	ILLINOIS FED. AID PROJECT			
28	30	32	34	36
CONTRACT NO. 70514				

BY _____	DATE _____
FINAL SURVEY NOTE BOOK NO. _____	SURVEYED PLOTTED AREAS CHECKED _____

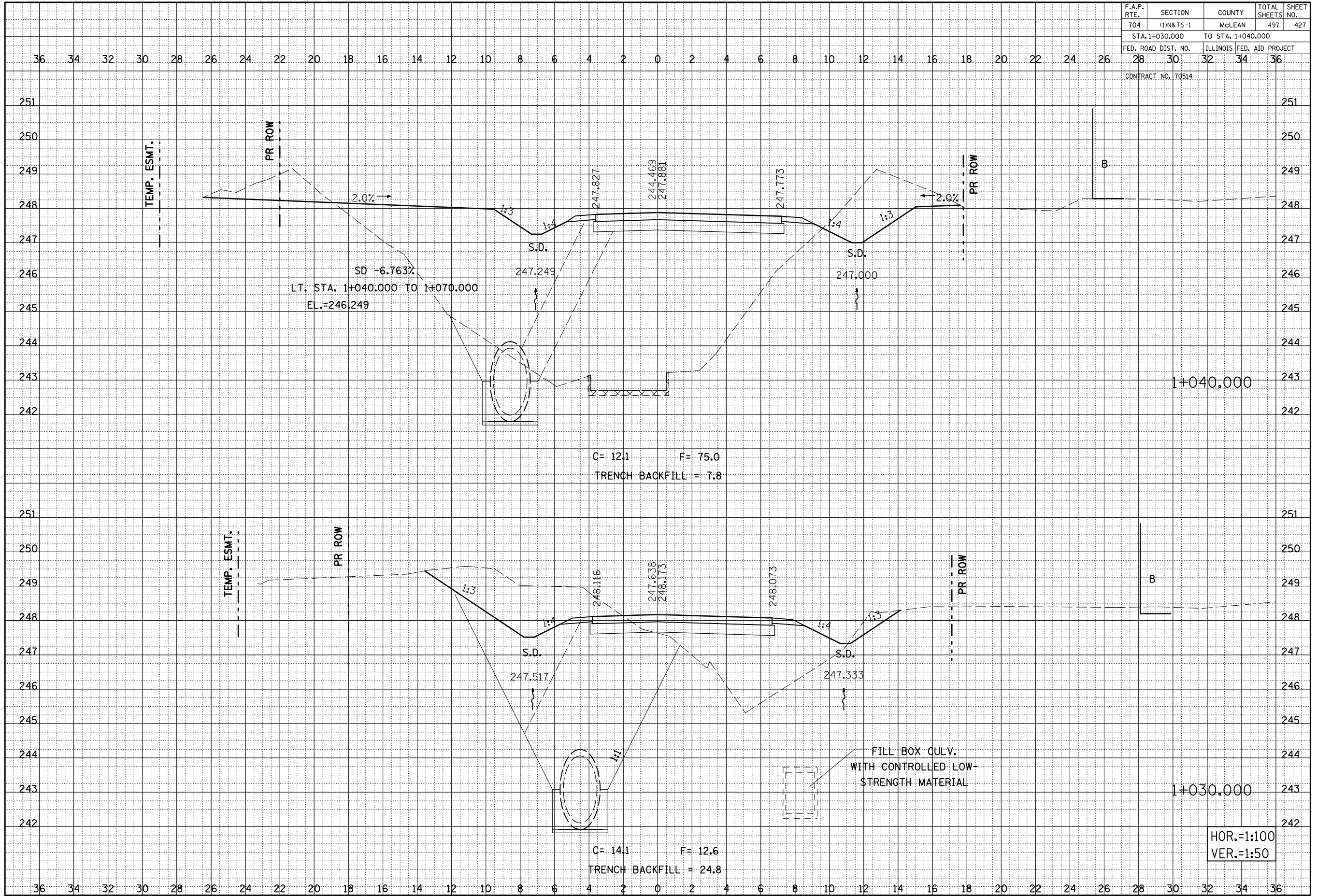

BY _____	DATE _____
ORIGINAL SURVEY NOTE BOOK NO. _____	SURVEYED PLOTTED AREAS CHECKED _____

SPRINGFIELD ROAD, CROSS SECTIONS, STA. 1+030.000 TO STA. 1+040.000

HOR.=1:100  
VER.=1:50