

F.A.P. RTE.	SECTION	COUNTY	TOTAL SHEETS	SHEET NO.
704	(1)N & TS-1	McLEAN	497	494
STA. 0+200.000		TO STA. 0+350.000		
FED. ROAD DIST. NO. -		ILLINOIS FED. AID PROJECT		
CONTRACT NO. 70514				

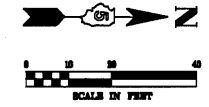

BY	DATE

FINAL SURVEY PLOTTED
NOTE BOOK TEMPLATE
AREAS CHECKED
NO. _____

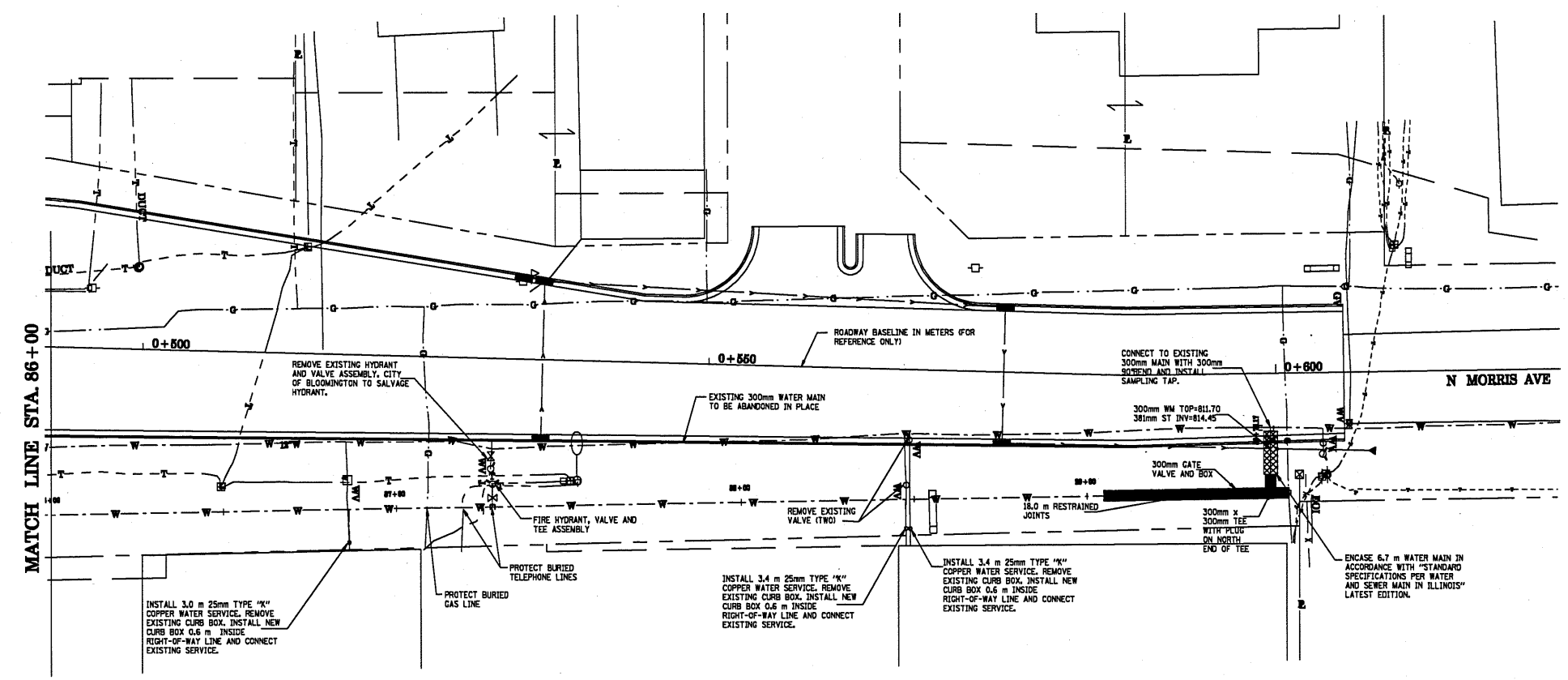

BY	DATE

ORIGINAL SURVEY PLOTTED
NOTE BOOK TEMPLATE
AREAS CHECKED
NO. _____

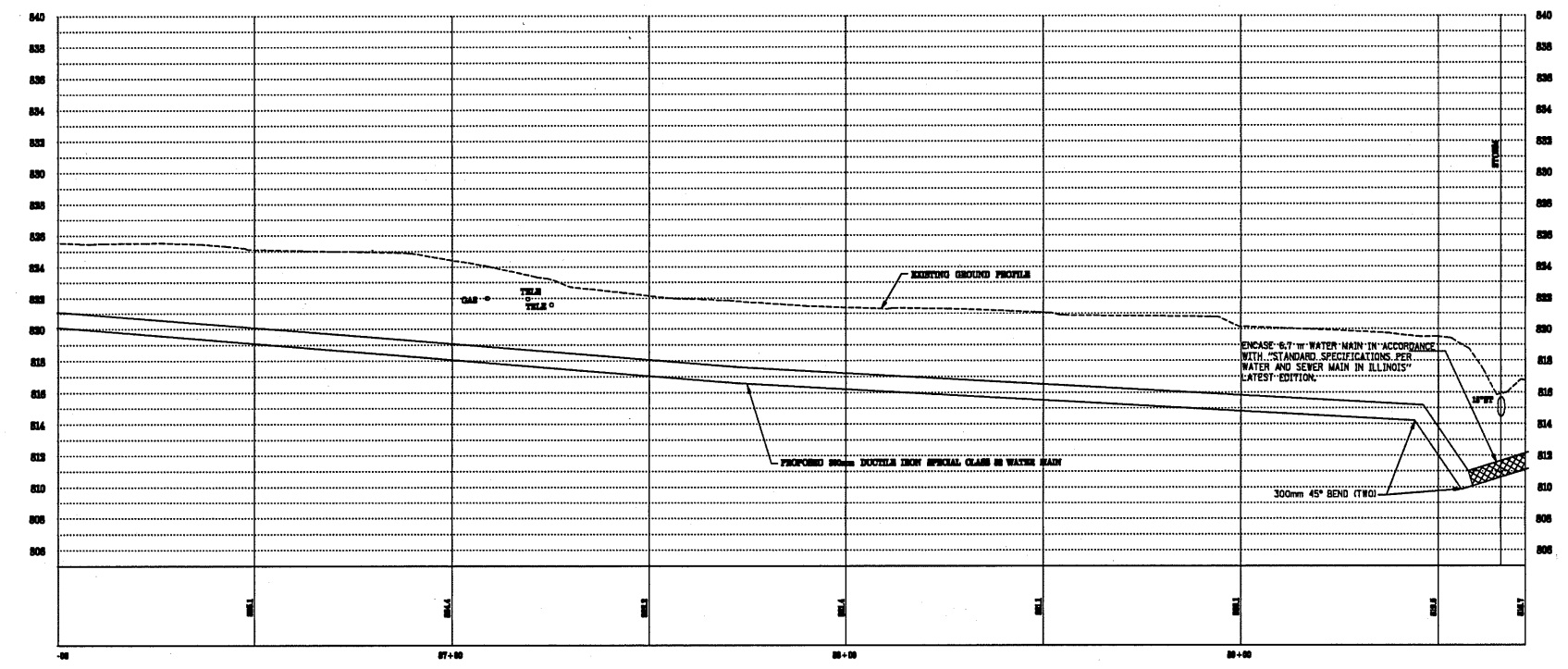

MORRIS AVE. WATER MAIN, STA. 86+00 TO STA. 89+13.60