

DIRECT TRAFFIC ON I-74 TO OUTSIDE LANE AWAY FROM MERGING I-55 NORTHBOUND TRAFFIC. USING TC&P STANDARDS 701400 AND 701401. BEGIN WORK AREA SHOWN ON TC&P STANDARD 701401 @ STA. 612+00 (I-74 WESTBOUND).

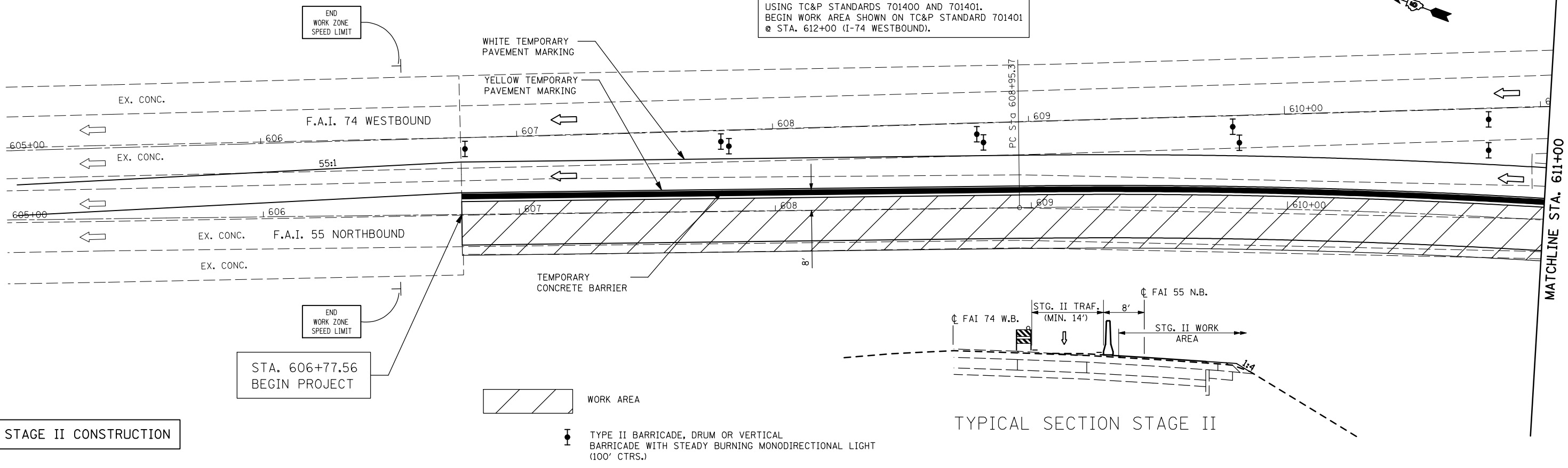

STAGE II CONSTRUCTION

DIRECT TRAFFIC ON I-74 TO OUTSIDE LANE WHEN WORK IS BEING PERFORMED ON I-55 NORTHBOUND. USING TC&P STANDARDS 701400 AND 701406. BEGIN WORK AREA SHOWN ON TC&P STANDARD 701406 @ STA. 612+00 (I-74 WESTBOUND). OPEN BOTH I-74 WESTBOUND LANES AT NIGHT OR WHEN NO WORK IS BEING PERFORMED ON I-55 NORTHBOUND.

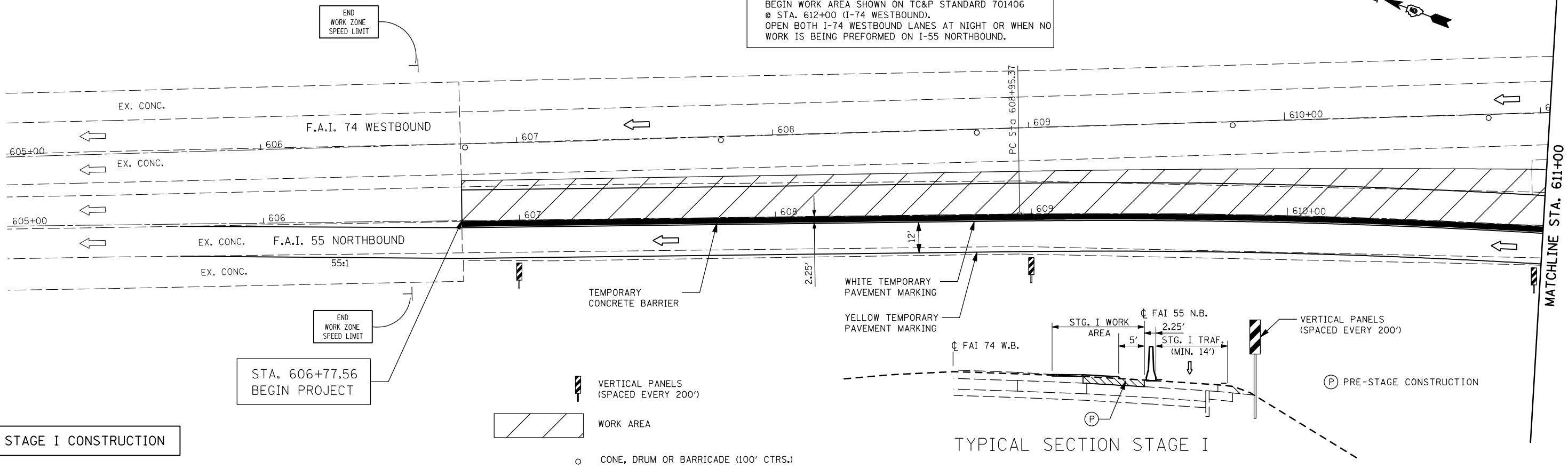

STAGE I CONSTRUCTION

FILE NAME = USER NAME = keysrb
 ct:\pw\work\p\dot\keysrb\0101450\0570520-sht-staging.dgn
 PLOT SCALE = 40.0000' / IN.
 PLOT DATE = 8/18/2010

DESIGNED -
 DRAWN -
 CHECKED -
 DATE -

REVISED -
 REVISED -
 REVISED -
 REVISED -

STATE OF ILLINOIS
 DEPARTMENT OF TRANSPORTATION

STAGING PLANS F.A.I. 55 NORTHBOUND
 SCALE: 1" = 20'
 SHEET NO. OF SHEETS STA. 605+00 TO STA. 611+00

F.A.I. RTE.	SECTION	COUNTY	TOTAL SHEETS	SHEET NO.
55	(57-7HB-2 & 57-7HB-1)BR	MCLEAN	153	32
CONTRACT NO. 70520				
ILLINOIS FED. AID PROJECT				