

STATE OF ILLINOIS
DEPARTMENT OF TRANSPORTATION

Notes:

See sheet 10 of 27 for Detail A.
Approach slab concrete shall be paid for as Concrete Superstructure.
Approach footing concrete shall be paid for as Concrete Structures.
Reinforcement shall be paid for as Reinforcement Bars, Epoxy Coated.
For v(E) bar details, see sheets 18 & 20 of 27.
The approach footing maximum applied service bearing pressure (Qmax) = 2.0 ksf.
For bar splicer details, see sheet 25 of 27.
Cost of excavation for approach footing included with Concrete Structures.
For Porous Granular Embankment (Special) and drainage treatment details, see sheet 2 of 27.

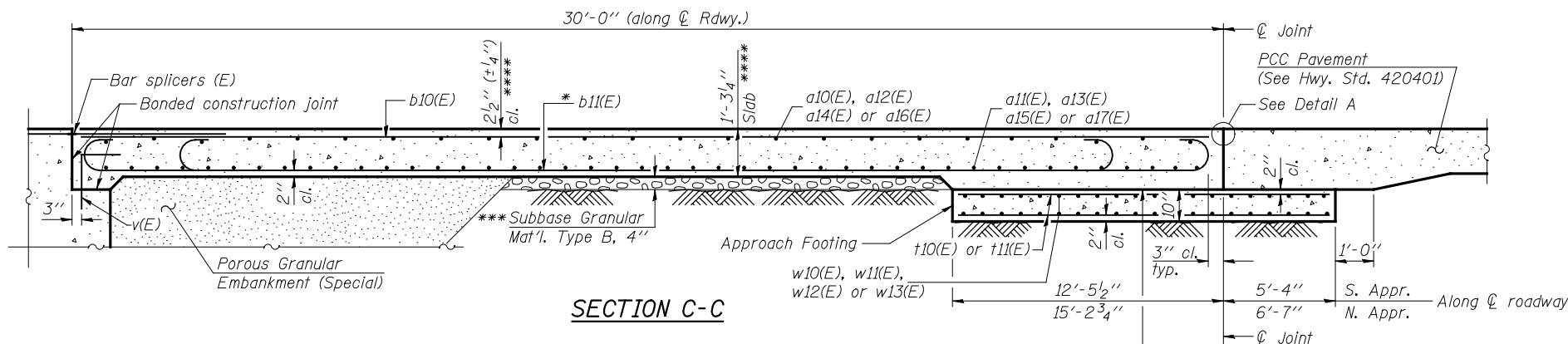

SECTION C-C

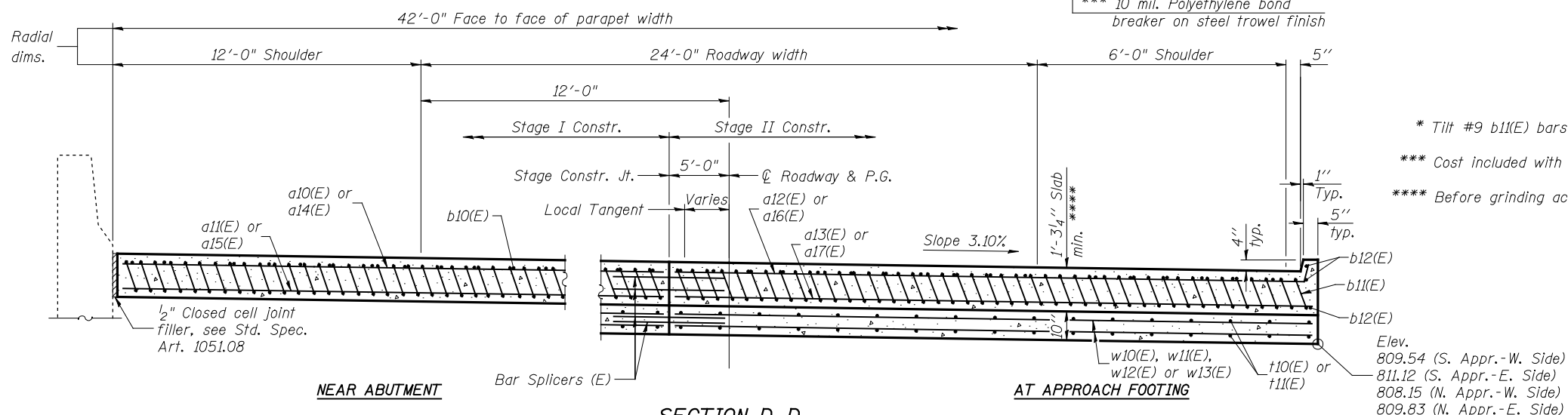

SECTION D-D

(See Plan for dimensions not shown)

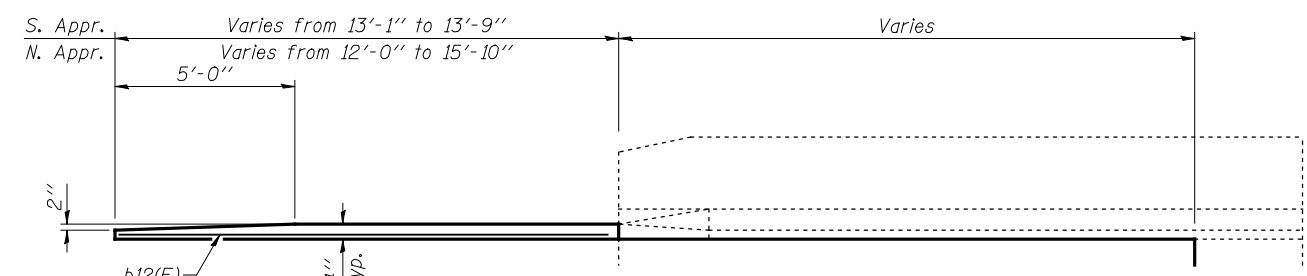

VIEW E-E

* Tilt #9 b11(E) bars as required to maintain clearance.
*** Cost included with Concrete Superstructure.
**** Before grinding according to Bridge Smoothness Specification.

TWO APPROACHES
BILL OF MATERIAL

Bar	No.	Size	Length	Shape
a10(E)	13	#4	33'-3"	—
a11(E)	24	#5	33'-3"	—
a12(E)	11	#4	34'-4"	┘
a13(E)	21	#5	34'-5"	—
a14(E)	14	#4	41'-0"	—
a15(E)	26	#5	41'-0"	—
a16(E)	10	#4	42'-1"	┘
a17(E)	19	#5	42'-2"	—
a20(E)	14	#4	39'-3"	—
a21(E)	26	#5	39'-3"	—
a22(E)	10	#4	41'-7"	┘
a23(E)	19	#5	41'-6"	—
a24(E)	12	#4	49'-0"	—
a25(E)	22	#5	49'-0"	—
a26(E)	12	#4	51'-7"	┘
a27(E)	23	#5	51'-6"	—
b10(E)	68	#4	29'-0"	—
b11(E)	200	#9	29'-9"	┘
b12(E)	12	#4	12'-9"	—
t10(E)	88	#4	17'-3"	—
t11(E)	88	#4	21'-0"	—
w10(E)	40	#5	34'-5"	—
w11(E)	40	#5	42'-2"	—
w12(E)	40	#5	41'-6"	—
w13(E)	40	#5	51'-6"	—
Concrete Superstructure		Cu. Yd.	121.8	
Concrete Structures		Cu. Yd.	52.9	
Reinforcement Bars, Epoxy Coated		Pound	41410	

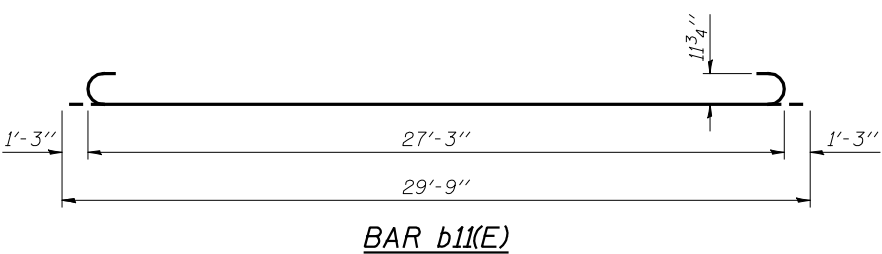
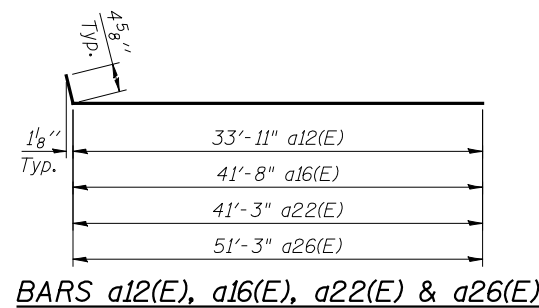

JD Johnson, Depp & Quisenberry
CONSULTING ENGINEERS
Springfield, Illinois

DESIGNED: DCD DRAWN: P. Ray
CHECKED: CMV CHECKED: CMV/DCD

BA-L 11-1-09 (Modified)

(Sheet 2 of 2)
BRIDGE APPROACH SLAB DETAILS
STRUCTURE NO. 057-0250

SHEET 11 OF 27	F.A.I. RTE.	SECTION	COUNTY	TOTAL SHEETS	SHEET NO.
	55	(57-7HB-1)BR	MCLEAN	153	61
STA. 626+53.70		CONTRACT NO. 70520			
FED. ROAD DIST. NO.		ILLINOIS FED. AID PROJECT			

FILE: J:\JDO\10169 IL-D5 1-55NB McLeon\14EB\0570250-70520-010-approslab.dgn USER: DCD PRINT DATE: 08/06/2010 20:56:25 SAVE DATE: 8/5/2010