

EXIST. CURVE 11
 PI STA. = 672+36.18
 $\Delta = 11^\circ 06' 28''$ (RT)
 $D = 1^\circ 30' 20''$
 $R = 3,805.84'$
 $T = 370.07'$
 $L = 737.82'$
 $E = 17.95'$
 $e = 2.2\%$
 P.C. STA. = 668+66.11
 P.T. STA. = 676+03.93
 S.E. ATTAINED MATCH EXISTING

PLAN	SURVEYED	DATE
	PLOTTED	
	CHECKED	
	ALIGNED	
	FILED	
	NO.	

PROFILE	SURVEYED	DATE
	PLOTTED	
	CHECKED	
	GRADES	
	STRUCTURE	
	NOTATIS	
	CHKD	
	NO.	

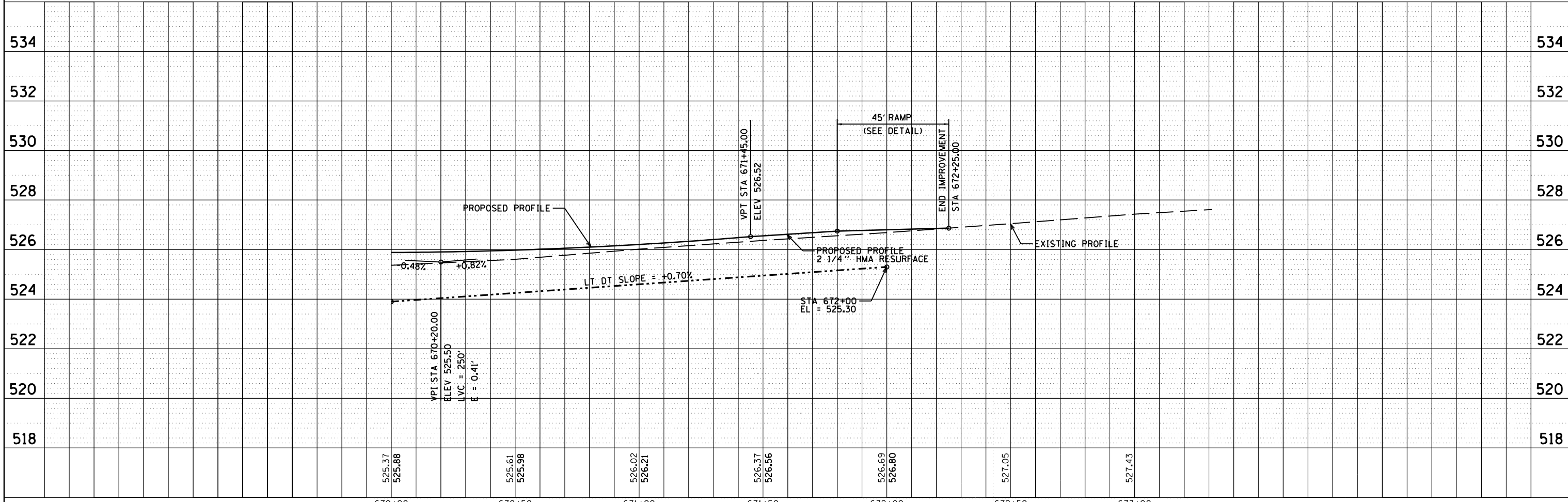
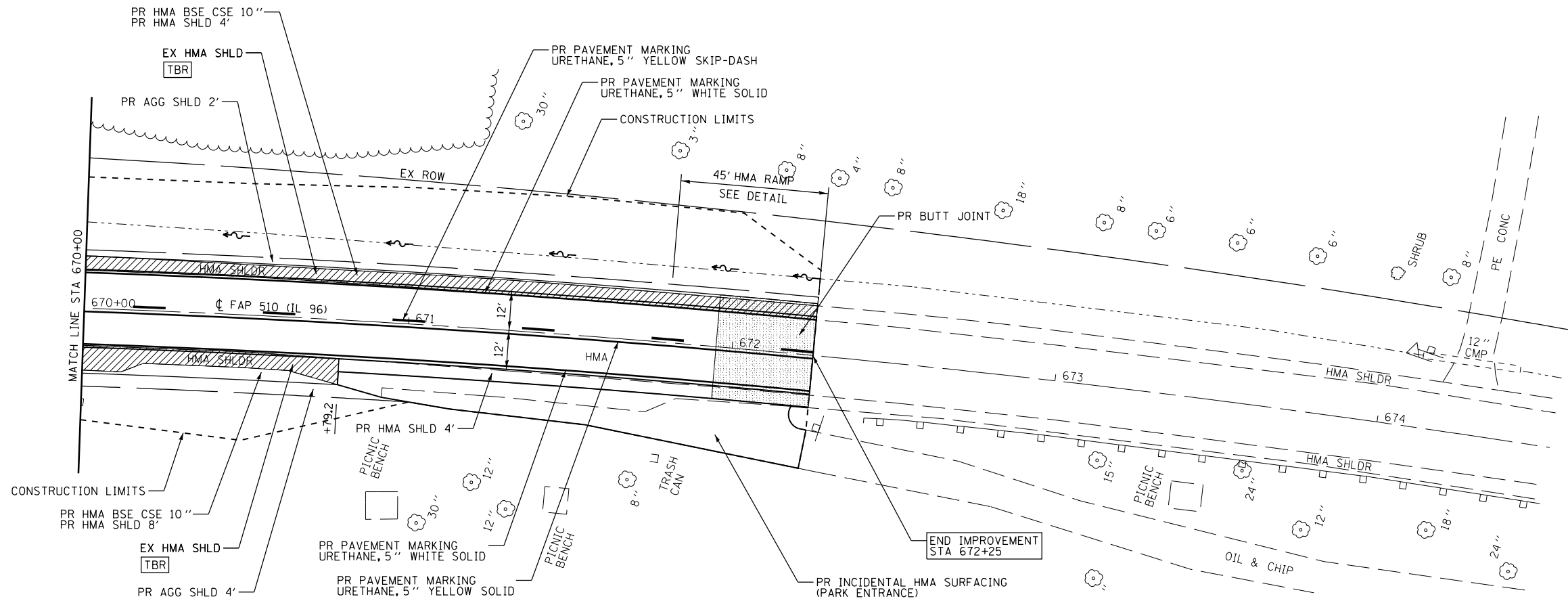
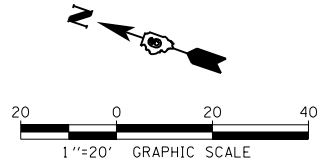

FILE NAME =	USER NAME = laughl1nr1	DESIGNED -	REVISED -	STATE OF ILLINOIS DEPARTMENT OF TRANSPORTATION	PLAN AND PROFILE	F.A.P. RTE.	SECTION	COUNTY	TOTAL SHEETS	SHEET NO.
c:\pwork\pwork\laughl1nr1\d0229630\PP_04.dgn	CHECKED -	REVISED -	510			120 (B-4, B-5)	HANCOCK	80	30	
PLOT SCALE = 40.0000' / in.	DRAWN -	REVISED -	CONTRACT NO. 72A65							
PLOT DATE = 8/9/2010	CHECKED -	REVISED -	ILLINOIS FED. AID PROJECT							