

F.A.P. RTE.	SECTION	COUNTY	TOTAL SHEETS	SHEET NO.
VARIOUS	D6 BDGE PAINTING 2011	MONTGOMERY, SANGAMON, SCHUYLER	16	1
FED. ROAD DIST. NO. 6	ILLINOIS	CONTRACT NO. 72D87		

C-96-027-10

STATE OF ILLINOIS
DEPARTMENT OF TRANSPORTATION
DIVISION OF HIGHWAYS

**PROPOSED
HIGHWAY PLANS**

VARIOUS ROUTES
SECTION D6 REHAB BDGE PAINTING 2011
BRIDGE PAINTING
MONTGOMERY, SANGAMON AND SCHUYLER COUNTIES

FOR INDEX OF SHEETS, SEE SHEET NO. 2

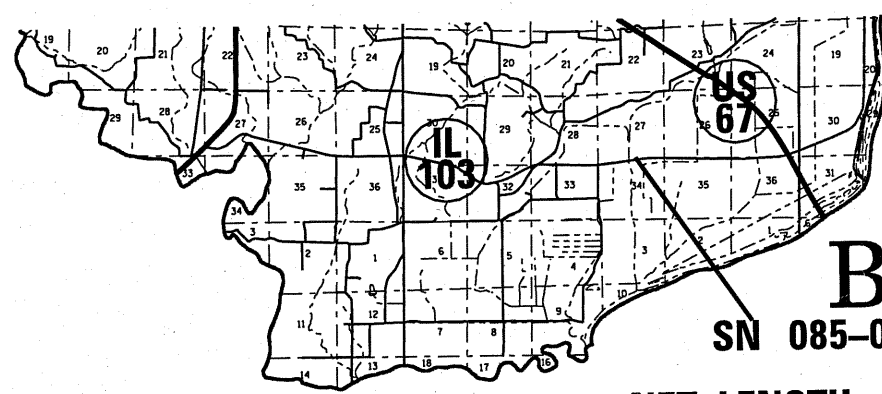
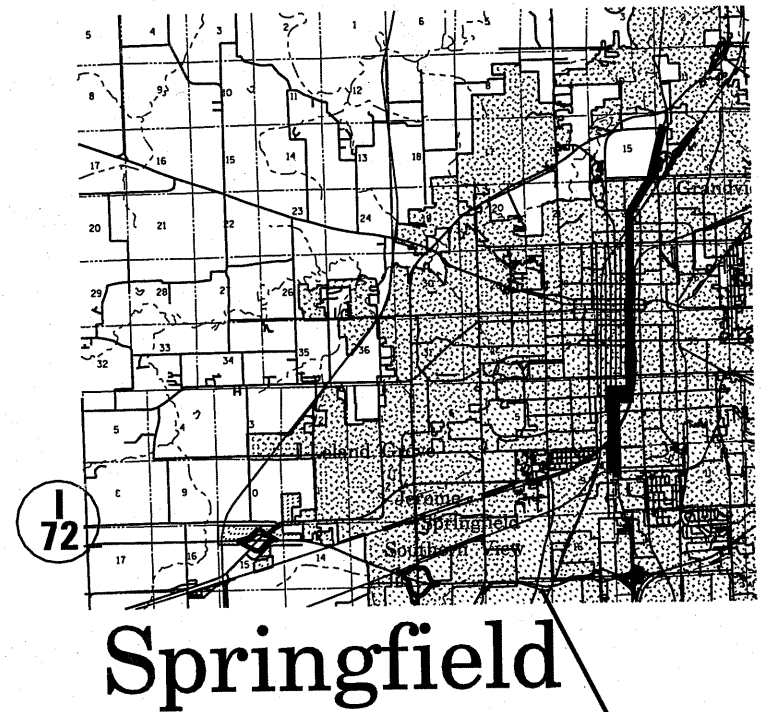
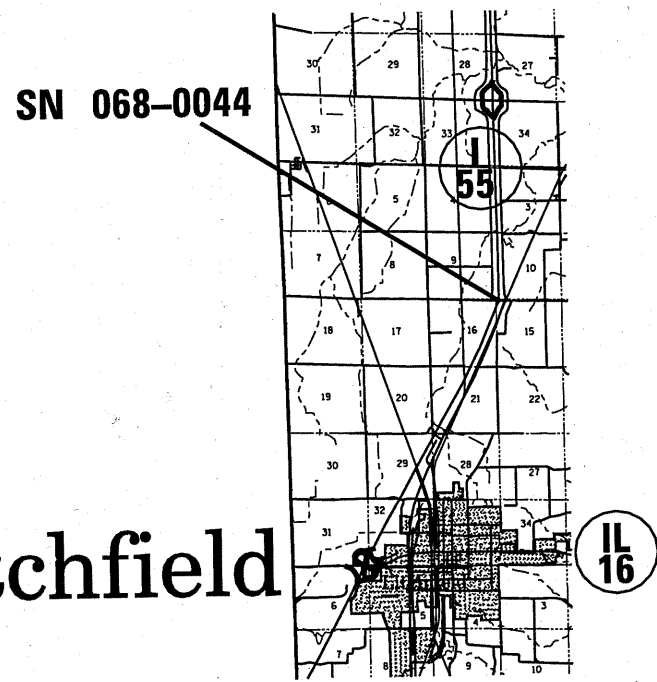

SN 084-0074,0075

SN 085-0005

NET LENGTH = 940 FT. = 0.18 MILE

J.U.L.I.E.
JOINT UTILITY LOCATION INFORMATION FOR EXCAVATION
1-800-892-0123
OR 811

D6 BRIDGE MAINTENANCE ENGINEER -
STEVE BERAN (217) 785-9290
D6 BRIDGE INSPECTION ENGINEER -
DAVE COPENBARGER (217) 785-5306

CONTRACT NO. 72D87

STATE OF ILLINOIS
DEPARTMENT OF TRANSPORTATION
DIVISION OF HIGHWAYS

SUBMITTED August 26 2010
Rogin Z. Dineen
DEPUTY DIRECTOR OF HIGHWAYS, REGION ENGINEER

October 1 2010
Scott E. Still P.E. /a
acting ENGINEER OF DESIGN AND ENVIRONMENT

October 1 2010
Christine M. Reed /a
DIRECTOR OF HIGHWAYS, CHIEF ENGINEER

PRINTED BY THE AUTHORITY
OF THE STATE OF ILLINOIS