

NOTES

1. DETOUR SIGNS REQUIRED WILL BE SUPPLIED TO THE CONTRACTOR BY I.D.O.T.
2. THE CONTRACTOR SHALL FURNISH THE POSTS AND ERECT THE SIGNS AT THE LOCATIONS SHOWN ON THIS SHEET, AS DIRECTED BY THE R.E./R.T. THE POSTS SHALL REMAIN THE PROPERTY OF THE CONTRACTOR.
3. THE CONTRACTOR SHALL GIVE ILLINOIS DEPARTMENT OF TRANSPORTATION, BUREAU OF OPERATIONS TWO WEEKS NOTICE FOR SIGNS. THE CONTRACTOR SHALL PICK UP THE SIGNS AT THE T.M. BUILDING IN FAIRVIEW HGTS., AND RETURN THEM UPON COMPLETION OF THE CONTRACT. CONTACT JEAN SLAPE (618) 346-3289.
4. THE ABOVE NOTED WORK SHALL BE PAID FOR AT THE CONTRACT UNIT PRICE, LUMP SUM, FOR "DETOUR SIGNING" AND NO OTHER COMPENSATION WILL BE ALLOWED.
5. SIGN SPACING WILL BE 400' OR TO FIT FIELD CONDITIONS.
6. THE HEIGHT TO THE BOTTOM OF THE LOWEST SIGN SHALL NOT BE LESS THAN 6'.
7. CONTRACTOR SHALL FURNISH ADVANCE WARNING SIGNS, ROAD CLOSURE SIGNS, MESSAGE BOARD AND TYPE III BARRICADES.
8. ALL ADVANCE WARNING SIGNS SHALL BE 48" FLUORESCENT ORANGE WITH FLASHING LIGHTS.

SIGNS REQUIRED

TO BE PROVIDED BY IDOT

DETOUR (9)	DETOUR AHEAD (2)	DETOUR AHEAD (1)
ILLINOIS 3 (9)	ROAD CLOSED 1.5 MILES AHEAD LOCAL TRAFFIC ONLY (1)	
ROAD CLOSED AHEAD (3)	ROAD CLOSED AHEAD (1)	

TO BE PROVIDED BY CONTRACTOR

ROAD CLOSED AHEAD (2)	DETOUR AHEAD (2)	DETOUR AHEAD (1)
-----------------------	------------------	------------------

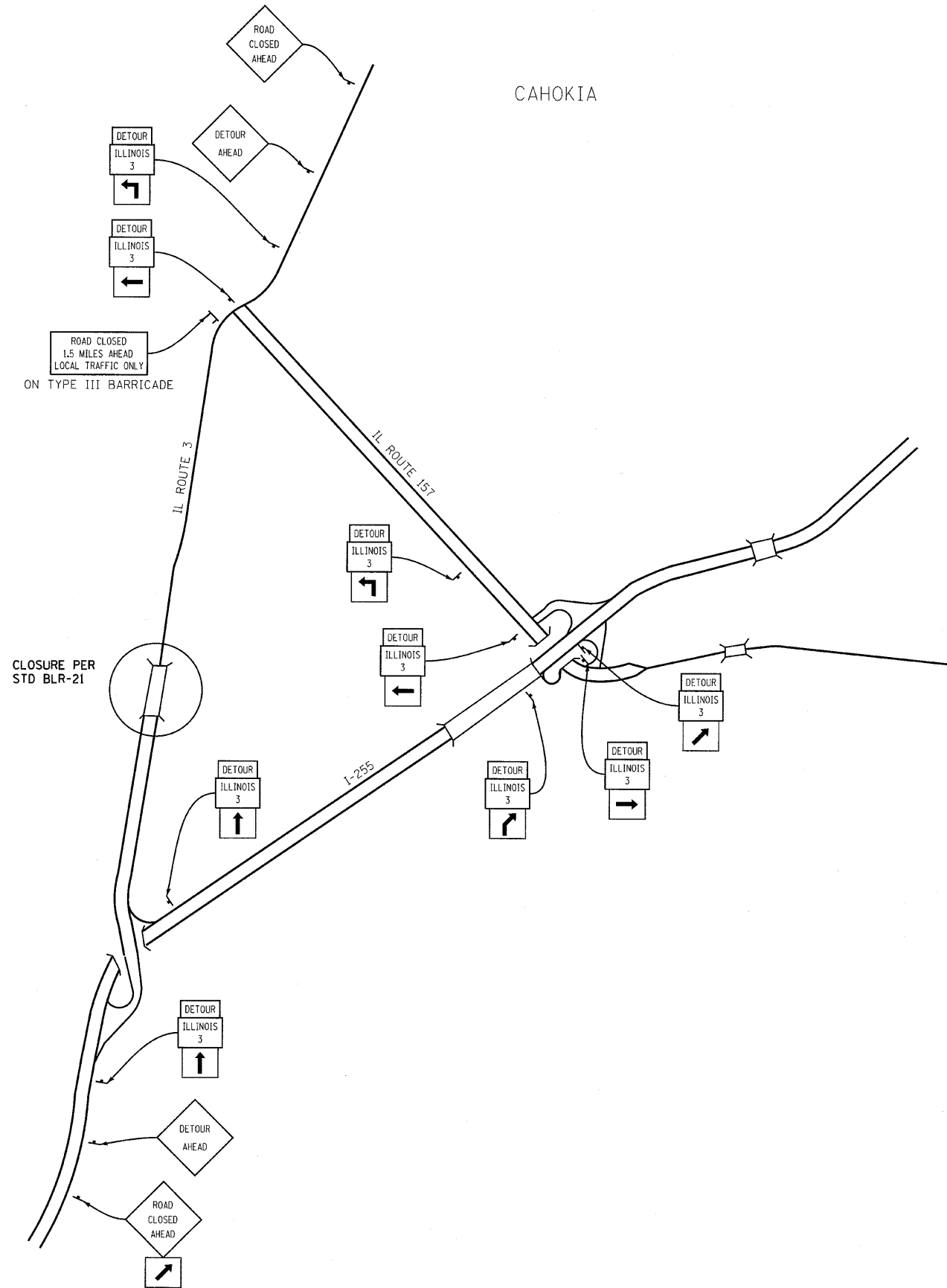

DUPO

CB Coombe-Bloxdorf P.C.
 - CIVIL ENGINEERS -
 - STRUCTURAL ENGINEERS -
 - LAND SURVEYERS -
 Design Firm License No. 184-002703

F.A.P. RTE.	SECTION	COUNTY	TOTAL SHEETS	SHEET NO.
312	64-1VBR	ST. CLAIR	259	23
FED. ROAD DIST. NO.			ILLINOIS FED. AID PROJECT	

FILE NAME = ... \023-0876882-Sht-detour-plan-IL3.dgn	USER NAME = CFC...	DESIGNED -	REVISED -
		DRAWN -	REVISED -
	PLOT SCALE = 10.0000' / IN.	CHECKED -	REVISED -
	PLOT DATE = 6/5/2010	DATE -	REVISED -

**STATE OF ILLINOIS
 DEPARTMENT OF TRANSPORTATION**

IL 3 DETOUR PLAN

SCALE: SHEET NO. OF SHEETS STA. TO STA.