

SHEET INDEX		
SHEET NO.	STATION TO STATION	DESCRIPTION
1		COVER
2		LEGEND/NOTES
3	267+00 TO 277+00	PARCELS: 8809021, 8809022, 8809023, 8809024 & 8809029
4	277+00 TO 291+00	PARCELS: 8809025, 8809026, 8809027 & 8809028
5	282+50 TO 284+00	DETAIL FOR PARCELS 8809022 & 8809028 COORDINATE TABLES
6	277+00 TO 277+50	PARCEL 8809021
7	277+00 TO 277+50	PARCELS 8809021 & 8809030
8	277+00 TO 277+50	DETAIL FOR PARCELS 8809021 & 8809030

STATE OF ILLINOIS
DEPARTMENT OF TRANSPORTATION
DIVISION OF HIGHWAYS

PLAT OF HIGHWAYS

FAP ROUTE 312 (IL ROUTE 3)
SECTION 64-1VBR
ST. CLAIR COUNTY
JOB NO.
R-98-009-08

SPACE RESERVED FOR RECORDING OFFICER

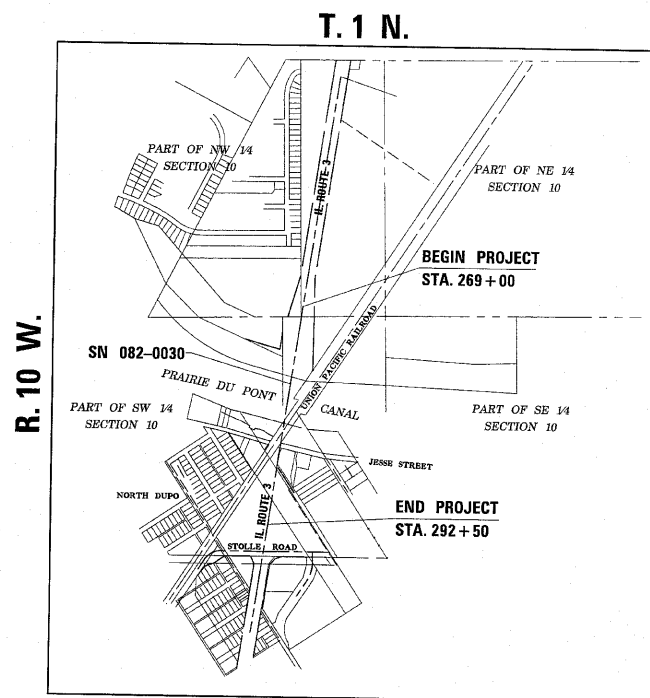

PROJECT LENGTH = 5800 LIN. FT. = 1.0984 MILES

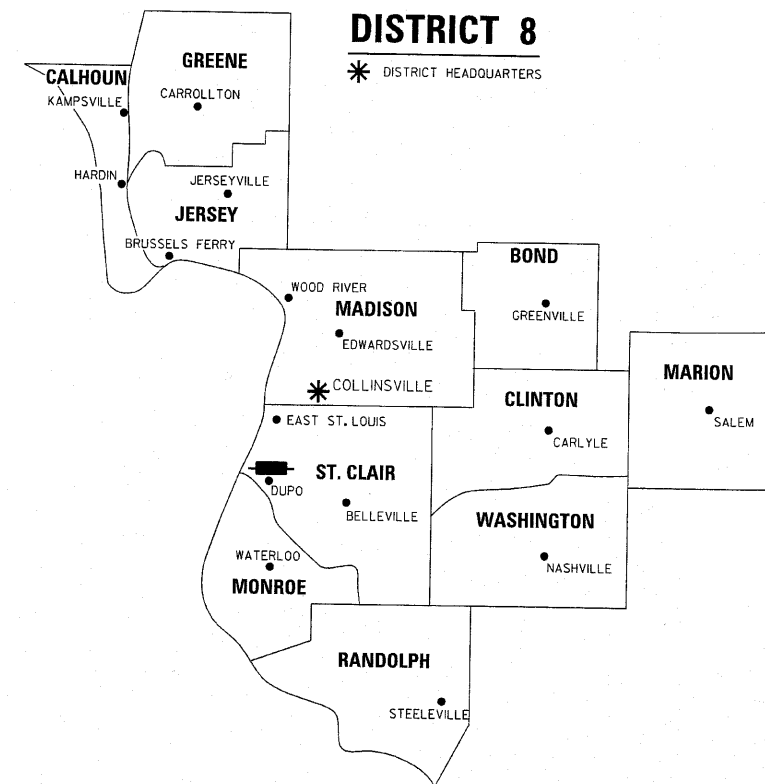

LOCATION OF SECTION INDICATED THUS:

PREPARED BY:

ASSOCIATED PROFESSIONALS, INC.
17625 Mockingbird Road, P.O. Box 311
Nashville, Illinois 62263
Ph. 618-478-9000 Fax 618-478-9001
web: www.apisurvey.com
IDPR Design Firm License No. 184-001303



GARY S. MUELLER, PLS NO. 3332
LICENSE EXPIRATION DATE: 11/30/2010

SHEET 1 OF

ILLINOIS DEPARTMENT OF TRANSPORTATION DIVISION OF HIGHWAYS/REGION 5/DISTRICT 8 1102 EASTPORT PLAZA DRIVE COLLINSVILLE, ILLINOIS 62234-6198				
F.A.P. RTE.	SECTION	COUNTY	TOTAL SHEETS	SHEET NO.
312	64-1VBR	ST. CLAIR	259	136
CONTRACT NO. 76882				
FED. ROAD DIST. NO. 8 ILLINOIS FED. AID PROJECT				