

STATE OF ILLINOIS
DEPARTMENT OF TRANSPORTATION

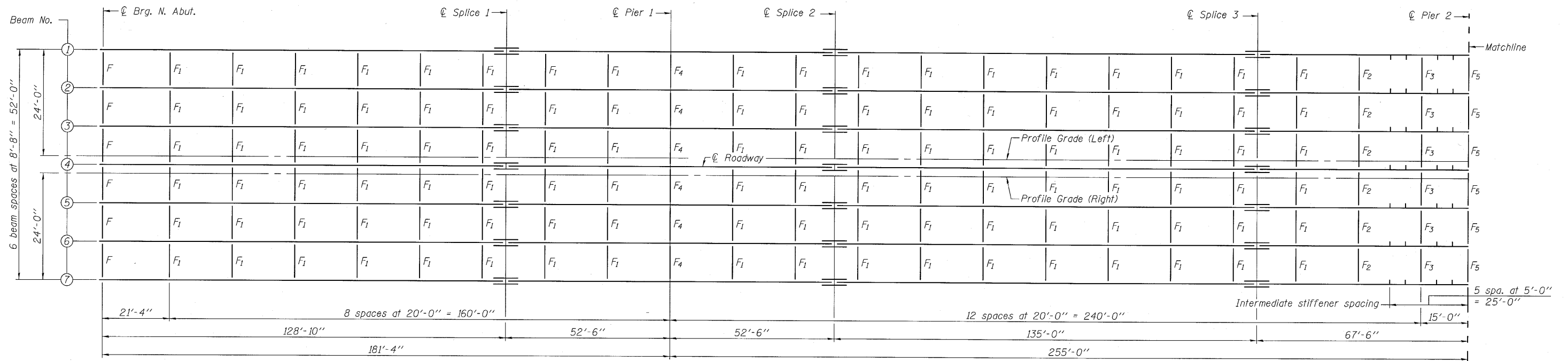

PARTIAL FRAMING PLAN

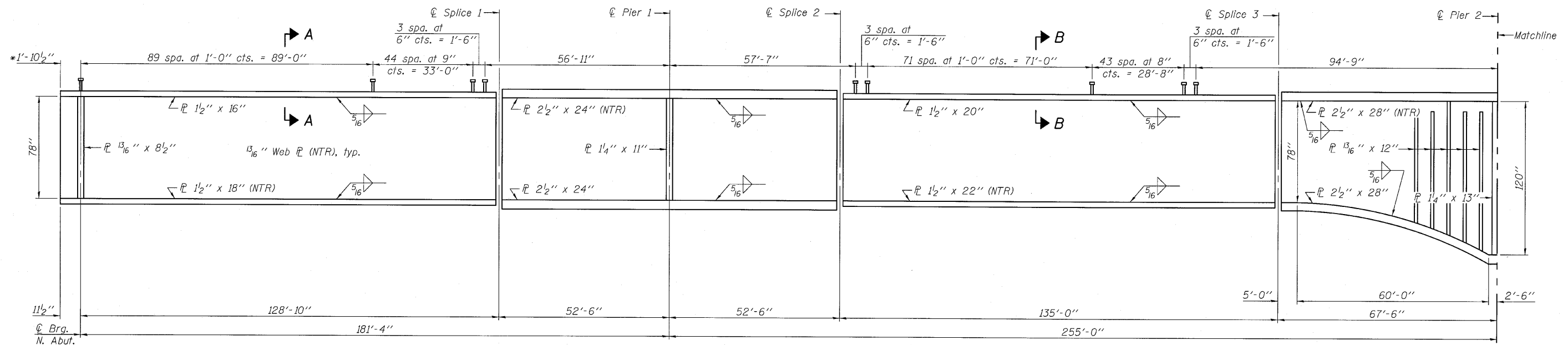

PARTIAL GIRDER ELEVATION

"NTR" denotes plates to which notch toughness requirements are applicable.

Notes:

- All flanges, web plates, bearing stiffeners, intermediate stiffeners, and splice plates shall be AASHTO M270 Grade 50.
- Load carrying components designated "NTR" shall conform to the Supplemental Requirements for Notch Toughness, Zone 2.
- Girder ends and bearing stiffeners at both Abuts. shall be fabricated parallel to the backwall in its final position.
- See sheet 30 of 48 for spans 3 and 4.
- See sheet 32 of 48 for parabolic haunch detail.

STRUCTURAL STEEL
SPANS 1 AND 2
STRUCTURE NO. 082-0038

DESIGNED	EML
CHECKED	KAK
DRAWN	AJF/EML
CHECKED	JJD

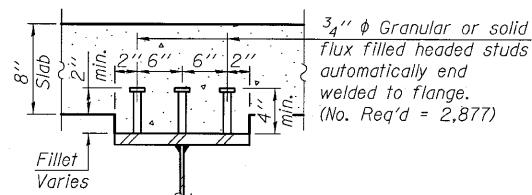

SECTION A-A

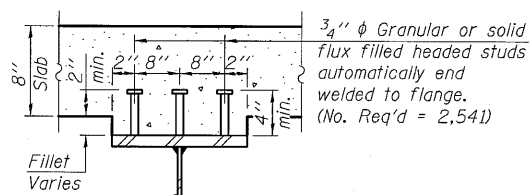

SECTION B-B



SHEET NO. 29 48 SHEETS	F.A.P. RTE.	SECTION	COUNTY	TOTAL SHEETS	SHEET NO.
	312	64-1VBR	ST. CLAIR	259	81
CONTRACT NO. 76882					
ILLINOIS FED. AID PROJECT					