

STATE OF ILLINOIS
DEPARTMENT OF TRANSPORTATION

DATE	SECTION	COUNTY	TOTAL SHEETS	SHEET NO.
7.3	64-IVBR	ST. CLAIR	17	18

SHEET NO. 8
18 SHEETS

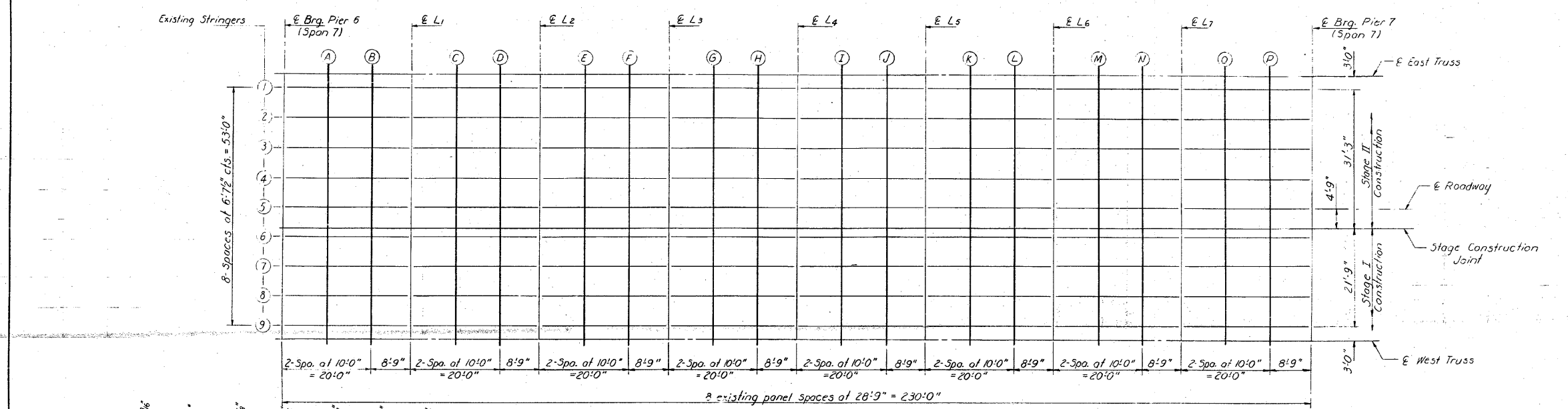

ELEVATIONS LOCATION PLAN
(SPAN 7)

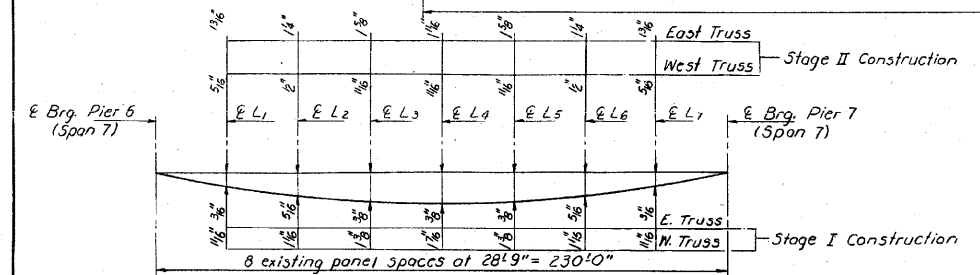

DEAD LOAD DEFLECTION DIAGRAM FOR TRUSS

(Includes weight of concrete only)
Note: The above deflections are not to be used in the field if the engineer is working from the grade elevations adjusted for dead load deflections as shown on sheets #5, #6 & #7.

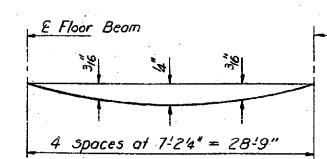

DEAD LOAD DEFLECTION DIAGRAM FOR STRINGERS

(Includes weight of concrete only)
(See Note)

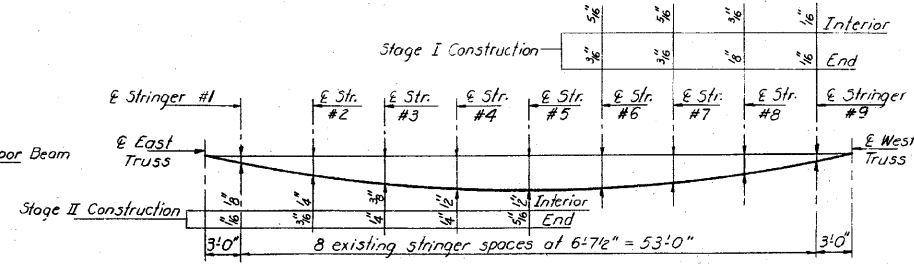

DEAD LOAD DEFLECTION DIAGRAM FOR FLOOR BEAMS

(Includes weight of concrete only)
(See Note)

Note 1: The top of stringer elevations at various stages of construction are estimated from the information given in existing plans and are subject to variations. The contractor shall assess the accuracy of these by taking elevations of representative locations when there is no live load in Span 7 and verify the fillet heights before proceeding with setting up of forms.

TOP OF SLAB ELEVATIONS DETAILS
SPAN 7
F.A. RT. 14 SEC. 64-IVB1
ST. CLAIR COUNTY
STA. 281+07.13

DESIGNED	<i>R. Doty</i>	EXAMINED	<i>James T. [Signature]</i>	1981
CHECKED	<i>David [Signature]</i>	P.A.S.	<i>James T. [Signature]</i>	
DRAWN	R. Doty	APPROVED	<i>James T. [Signature]</i>	
CHECKED	D.G.	DIRECTOR OF HIGHWAYS		

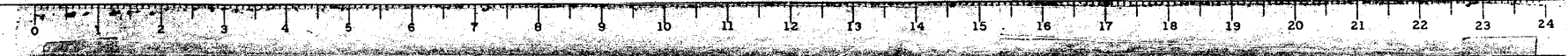

FOR INFORMATION ONLY

FILE NAME =	USER NAME = CFC...	DESIGNED -	REVISED -	STATE OF ILLINOIS DEPARTMENT OF TRANSPORTATION	SN 082-0030 PLANS (REHABILITATION PLANS)	SCALE:	SHEET NO.	OF SHEETS	STA.	TO STA.	F.A.P. RTE. 312	SECTION 64-IVBR	COUNTY ST. CLAIR	TOTAL SHEETS	SHEET NO.
...141-0876882-exist-bridge-repair-plans	ldgn	DRAWN -	REVISED -											259	141
PLOT SCALE = 40,000,000 / IN.		CHECKED -	REVISED -											CONTRACT NO. 76882	
PLOT DATE = 8/5/2010		DATE - / /	REVISED -											ILLINOIS FED. AID PROJECT	

CB Coombe-Bloxdorf P.C.
- CIVIL ENGINEERS-
- STRUCTURAL ENGINEERS-
- LAND SURVEYORS-
Design Firm License No. 184-002703