

Bench Mark: BM 23, Chiseled X on the top of SW wingwall of SN 028-0008, 65.15' Rt. Sta. 517+05.80, Elev. 481.68

Existing Structures: SN 028-0008 (SB) and 028-0009 (NB) were built in 1962 as F.A.I. Rte. 57, Section 28-3V(B,F)-1. Each 3-span structure is 234'-6" long bk. to bk. abuts. and 42'-0" wide o. to o. and consist of a reinforced concrete deck supported by steel WF beams on spill-thru pile bent abutments and multi-column piers. The existing structures are to be removed and replaced.

Traffic Control: Stage construction will be utilized.

Salvage: None

STATE OF ILLINOIS
DEPARTMENT OF TRANSPORTATION

Traffic Barrier Terminal
Std 631031 - Type 6 (Appr. Ends)
Std 631026 - Type 5 (Exit Ends)

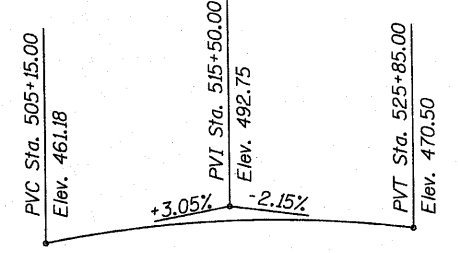
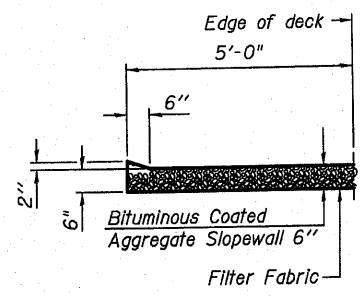

PROFILE GRADE FAI 57
(along \odot NB and \odot SB Lanes)

RAILROAD CURVE DATA
 $\Delta = 40^{\circ}-44'$
 $D = 1^{\circ}-20'$

SEISMIC DATA

Seismic Performance Category (SPC) = B
Bedrock Acceleration Coefficient (A) = 0.12g
Site Coefficient (S) = 1.0

TOP OF RAIL ELEVATIONS ⑤

Station	N. Rail	S. Rail
9+12	451.15	451.42
9+64	450.95	451.26
10+00	450.88	451.18
10+20	450.81	451.14
10+70	450.69	450.98

DESIGN STRESSES
FIELD UNITS

$f'_c = 3,500$ psi
 $f_y = 60,000$ psi (Reinforcement)
 $f_y = 50,000$ psi (AASHTO M270 Grade 50)
 $f_y = 36,000$ psi (AASHTO M270 Grade 36)

LOADING HS20-44 & ALT.
Allow 50#/sq. ft. for future wearing surface.

DESIGN SPECIFICATIONS
2002 AASHTO

- Notes:
- Mile Post 123 is located 1055.1' Southwest of Sta. 515+12.00 = Sta. 10+00.00 UPRR along tangent to UPRR at Sta. 10+00.00
 - No freefall deck drains will be permitted over tracks or within 10 feet of cross arms of a railroad pole line.
 - Dim. at right angles to \odot track.
 - See sheet 2 of 43 for Index of Sheets.
 - Elevations from survey on 2/28/2008
 - Tile proposed paved ditch into existing paved ditch 5'-0" outside of edge of deck.
 - See sheet 3 of 98 for Railroad General Notes

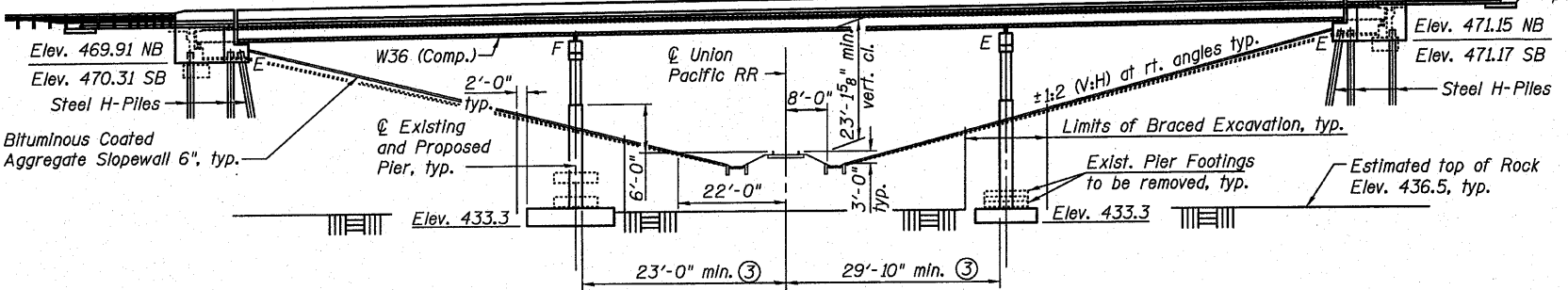

ELEVATION

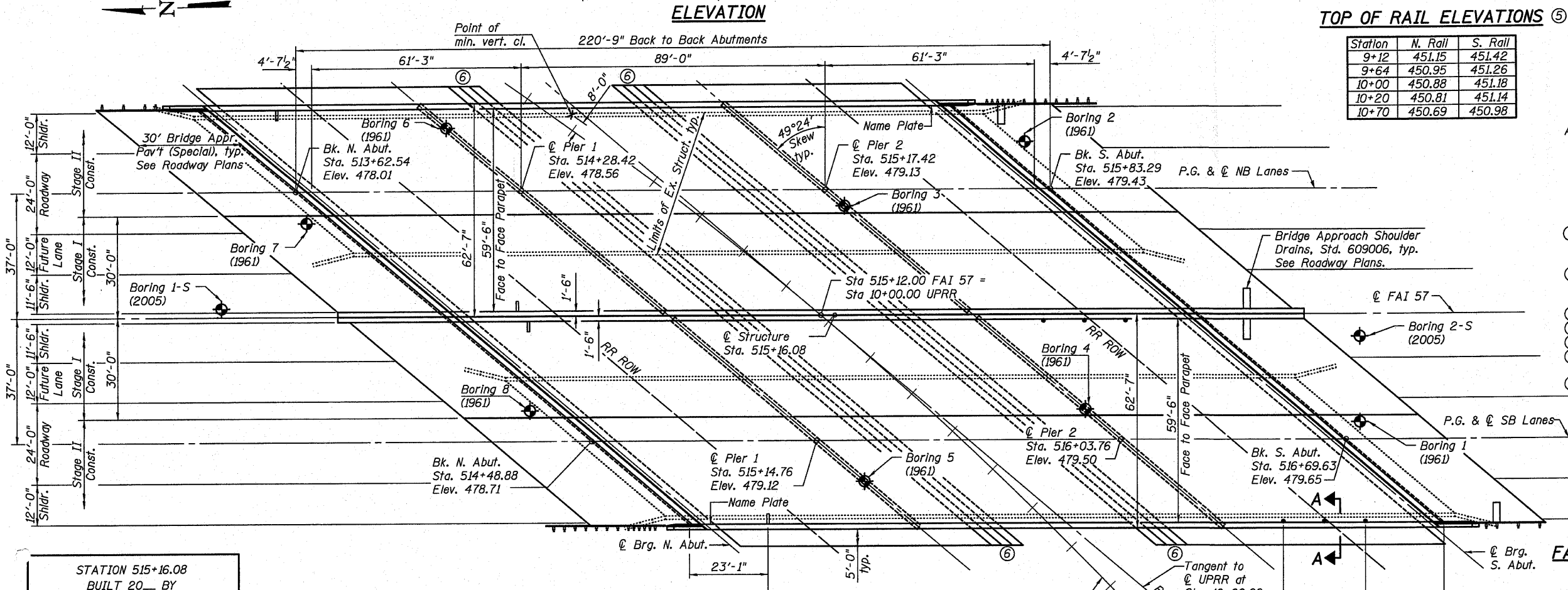

PLAN

GENERAL PLAN
I-57 OVER
UNION PACIFIC RAILROAD
FAI ROUTE 57 SECTION (28-3-DVB-1)
FRANKLIN COUNTY
STATION 515+16.08
STRUCTURE NO. 028-0081 (SB)
STRUCTURE NO. 028-0082 (NB)

STATION 515+16.08
BUILT 20__ BY
STATE OF ILLINOIS
FAI ROUTE 57 - SEC (28-3-DVB-1)
LOADING HS20-44 & ALT
STRUCTURE NO. 028-0081

STATION 515+16.08
BUILT 20__ BY
STATE OF ILLINOIS
FAI ROUTE 57 - SEC (28-3-DVB-1)
LOADING HS20-44 & ALT
STRUCTURE NO. 028-0082

NAME PLATE
See Std. 515001

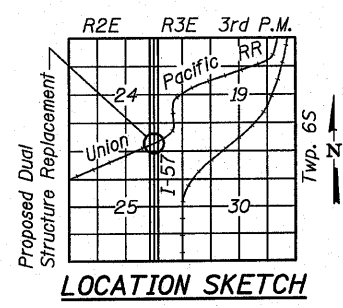

APPROVED
FOR STRUCTURAL ADEQUACY ONLY
Ralph E. Anderson (TJD)
ENGINEER OF BRIDGES AND STRUCTURES

Plans prepared by
Oates Associates, Inc.
Sheets 1-3 & 29-43 of 43

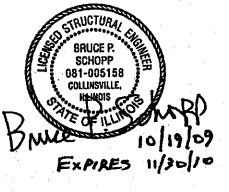

Plans prepared by
Coombe-Bloxdorf P.C.
Sheets 4-28 of 43

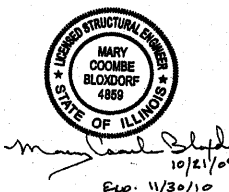

SHEET NO. 1 43 SHEETS	F.A.I. RTE. 57	SECTION (28-3-DVB-1)	COUNTY FRANKLIN	TOTAL SHEETS 98	SHEET NO. 25
	CONTRACT NO. 78068				
FED. ROAD DIST. NO. 7 ILLINOIS FED. AID PROJECT					

DESIGNED -
CHECKED -
DRAWN -
CHECKED -

Eastport Business Center 1
100 Lanter Court, Suite 1
Collinsville, Illinois 62234
618-345-2200
Design Firm License No. 184.001115

OATES ASSOCIATES
Consulting Engineers