

STATE OF ILLINOIS
DEPARTMENT OF TRANSPORTATION

NB SOUTH ABUTMENT
BILL OF MATERIAL

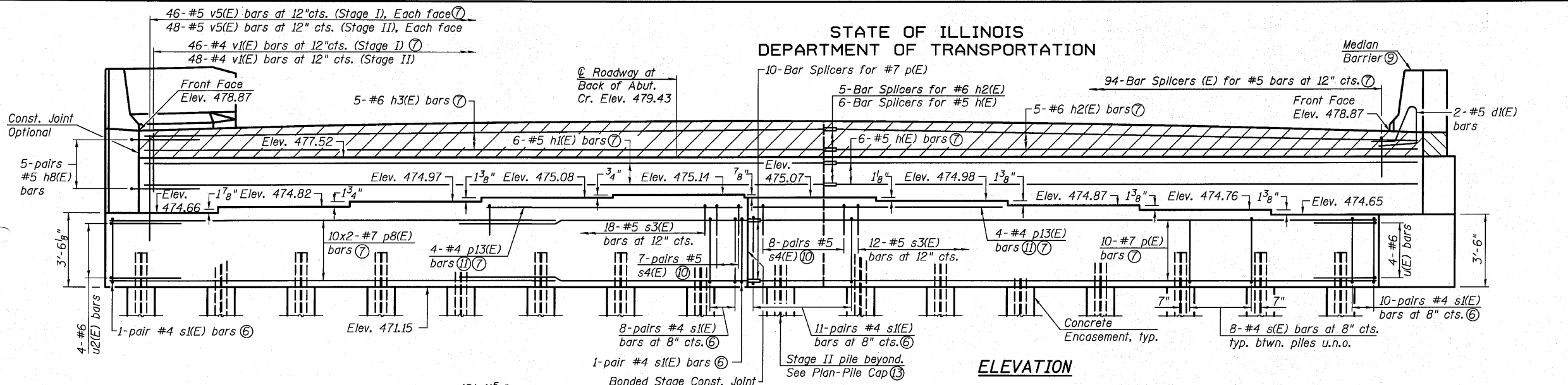

Bar	No.	Size	Length	Shape
d1(E)	2	#5	7'-9"	
h(E)	6	#5	45'-8"	
h1(E)	6	#5	47'-3"	
h2(E)	5	#6	45'-8"	
h3(E)	5	#6	47'-3"	
h8(E)	10	#5	9'-0"	
h9(E)	8	#4	10'-11"	
h10(E)	6	#4	9'-4"	
h11(E)	2	#4	10'-4"	
n(E)	7	#6	11'-0"	
n1(E)	6	#6	5'-6"	
p(E)	10	#7	45'-8"	
p8(E)	20	#7	27'-4"	
p9(E)	6	#7	11'-2"	
p13(E)	4	#4	37'-5"	
s(E)	104	#4	15'-11"	
s1(E)	62	#4	11'-4"	
s2(E)	17	#4	9'-5"	
s3(E)	30	#5	7'-9"	
s4(E)	30	#5	5'-11"	
u(E)	4	#6	13'-10"	
u2(E)	4	#6	9'-7"	
v(E)	94	#4	3'-0"	
v5(E)	188	#5	5'-9"	
v6(E)	12	#6	6'-11"	
v7(E)	7	#6	7'-4"	
v8(E)	3	#6	6'-2"	
Structure Excavation		Cu. Yd.	37	
Concrete Structures		Cu. Yd.	84.1	
Concrete Encasement		Cu. Yd.	5.9	
Reinforcement Bars, Epoxy Coated		Pound	7,750	
Furnishing Steel Piles HP12x53		Foot	720	
Driving Piles		Foot	720	
Test Pile Steel HP12x53		Each	1	
Concrete Sealer		Sq. Ft.	742	

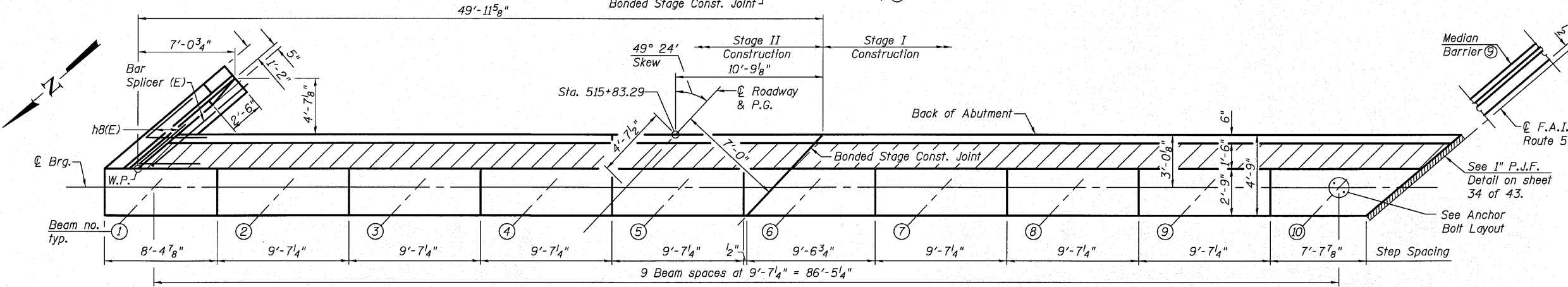

TOP VIEW

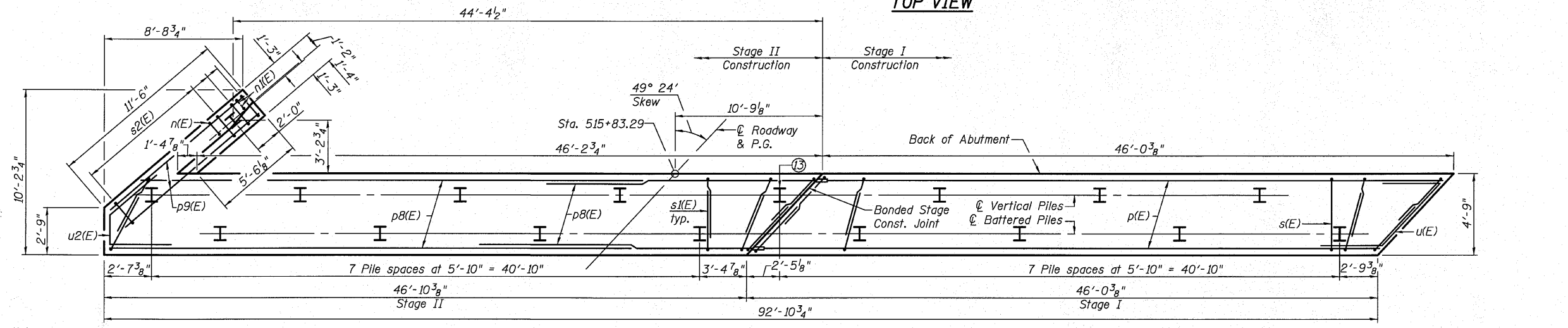

PLAN-PILE CAP

- Notes:
- For details of Bar Splicers, see sheet 40 of 43.
 - For details of piles and Concrete Encasement, See sheet 39 of 43.
 - For wingwall reinforcing locations and details. See sheet 34 of 43.
 - All edges shall have standard 3/4" chamfer.
 - Space reinforcement in cap to miss anchor bolts.
 - Fan s1(E) bars as required. Lap length varies to accommodate skew. Minimum lap length is 1'-4".
 - See Sec. Thru. Abut. on sheet 34 of 43 for bar locations.
 - Min. bar lap; #7 bars = 4'-10".
 - Median barrier to be poured with approach pavement.
 - Fan s4(E) bars as required. Lap length varies to accommodate skew. Minimum lap length is 1'-8".
 - See Field Cutting Diagram on sheet 34 of 43.
 - Bars indicated thus 10 x 2-#7 etc., indicates 10 lines of bars with 2 lengths per line.
 - Contractor may drive during Stage I Construction if clearance allows or may move as approved by the Engineer.

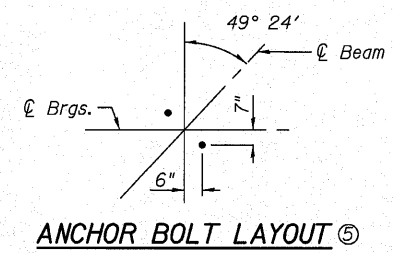

ANCHOR BOLT LAYOUT ⑤

PILE DATA
Type: HP12x53
Nominal Required Bearing: 419 Kip
Factored Resistance Available: 139 Kip
Est. Length: 45'
No. Production Piles: 16
No. Test Piles: 1

SOUTH ABUTMENT DETAILS
NB STRUCTURE
STRUCTURE NO. 028-0082

SHEET NO.	F.A.I. RTE.	SECTION	COUNTY	TOTAL SHEETS	SHEET NO.
32	57	(28-3-1)VB-1	FRANKLIN	98	56
43 SHEETS CONTRACT NO. 78068					
FED. ROAD DIST. NO. 7 ILLINOIS FED. AID PROJECT					
 Eastport Business Center 1 100 Lanter Court, Suite 1 Collinsville, Illinois 62234 618-345-2200 Design Firm License No. 184.001115			DESIGNED JAD CHECKED MJP DRAWN JAD CHECKED MJP		