

DATE	
BY	
REVISIONS	
NO.	
FINAL SURVEY	
NOTE BOOK	
AREAS CHECKED	

DATE	
BY	
REVISIONS	
NO.	
ORIGINAL SURVEY	
NOTE BOOK	
AREAS CHECKED	

FILE NAME = P:\CIRBEL WEST Projects\2009\1212100\_W09 IL 40 OVER ELKHORN CREEK\SHA\10284854.dwg

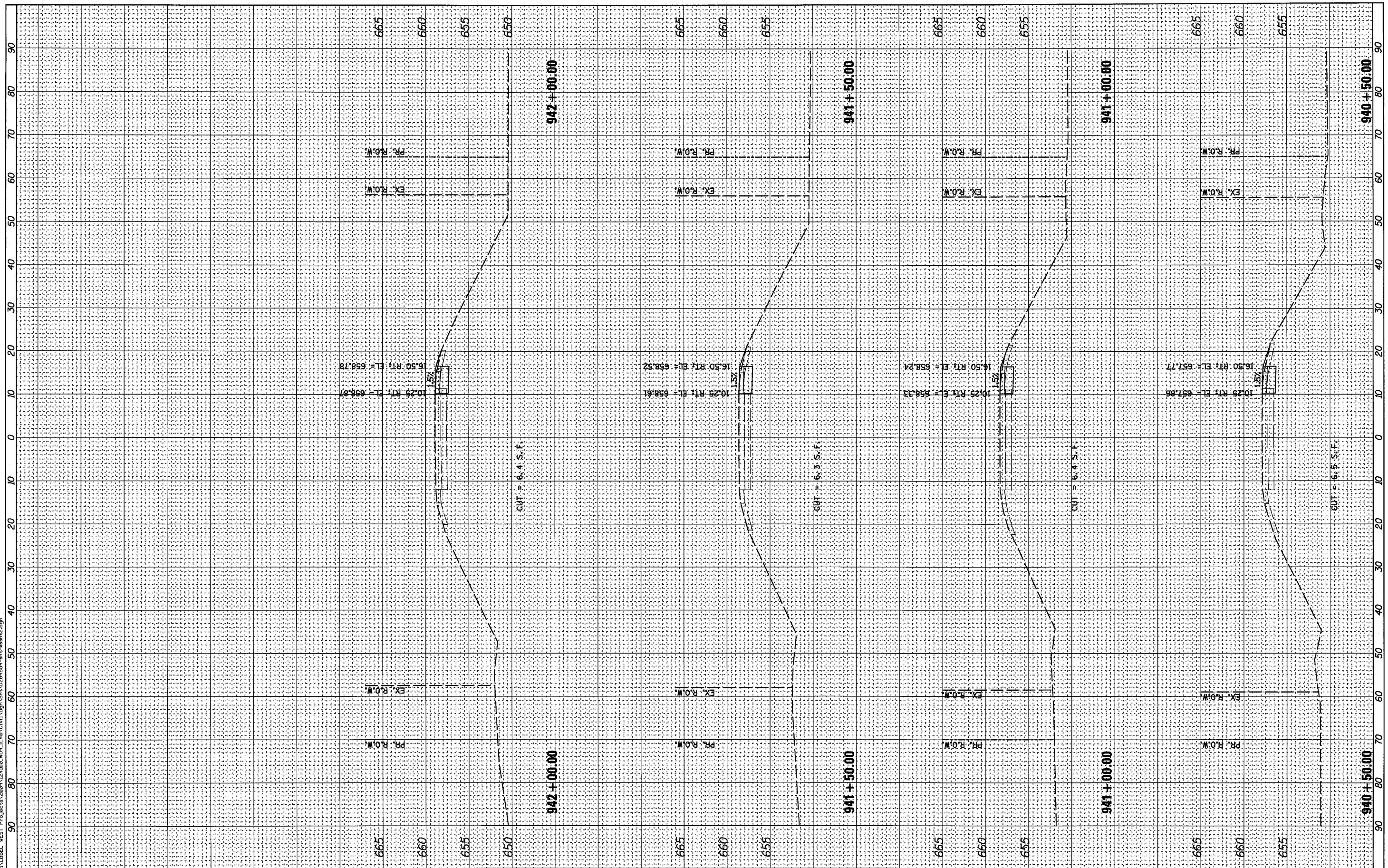

**WILLS BURKE KELSEY ASSOCIATES LTD.**  
 116 West Main Street, Suite 201  
 St. Charles, Illinois 60174  
 (630) 443-7755

USER NAME = #USER#	DESIGNED - KMA	REVISED -
PLOT SCALE = 1"=10'H, 1"=5'V	DRAWN - KMA	REVISED -
PLOT DATE = 8/2/2010	CHECKED - PJF	REVISED -
	DATE - 8/6/10	REVISED -

**STATE OF ILLINOIS  
 DEPARTMENT OF TRANSPORTATION**

**CROSS SECTIONS - STAGE 1  
 ILLINOIS ROUTE 40 OVER ELKHORN CREEK**

SCALE: 1"=10'H, 1"=5'V SHEET NO. OF 90 SHEETS STA. 940+50.00 TO STA. 942+00.00

F.A.P. RTE. 646	SECTION 8BR-1	COUNTY WHITESIDE	TOTAL SHEETS 90	SHEET NO. 80
CONTRACT NO. 84854				
FED. ROAD DIST. NO. 2 ILLINOIS FED. AID PROJECT				