

STATE OF ILLINOIS  
DEPARTMENT OF TRANSPORTATION

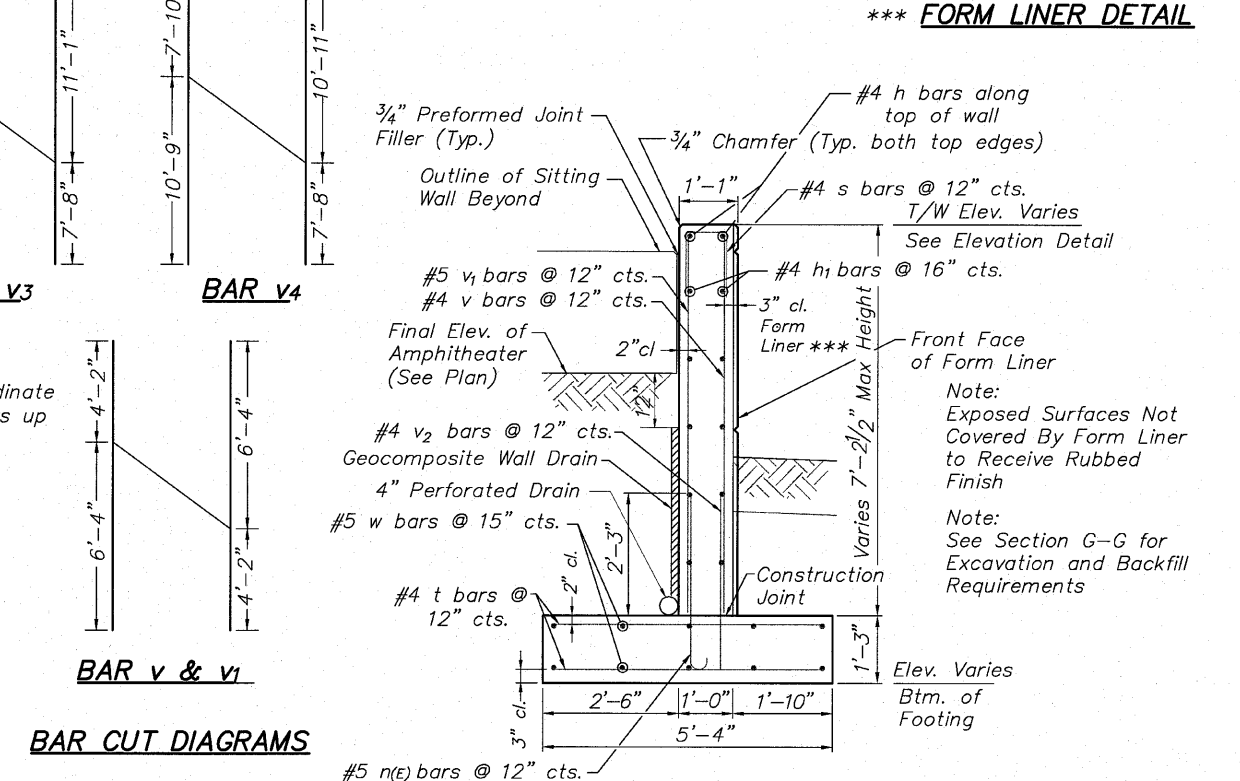
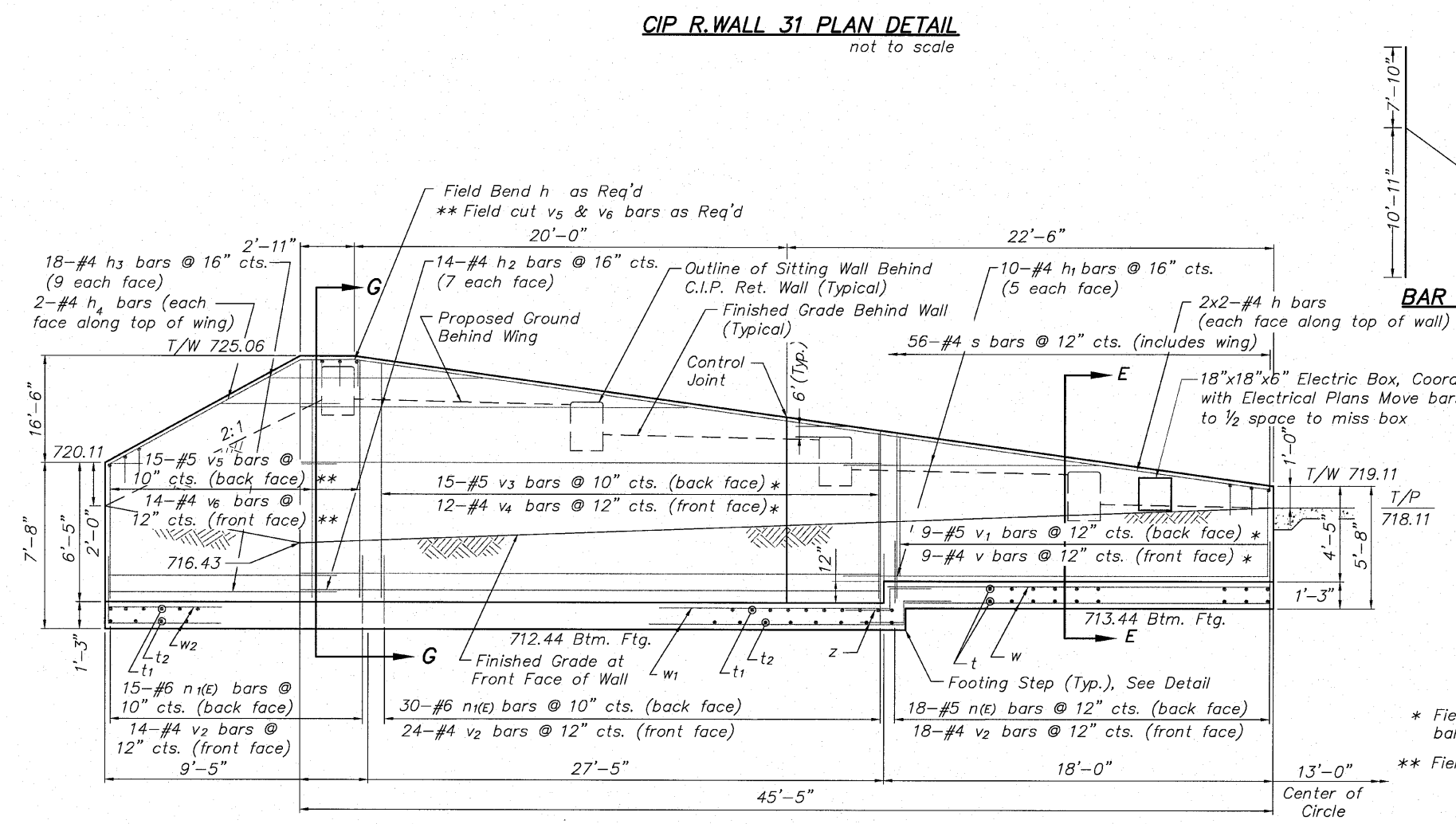
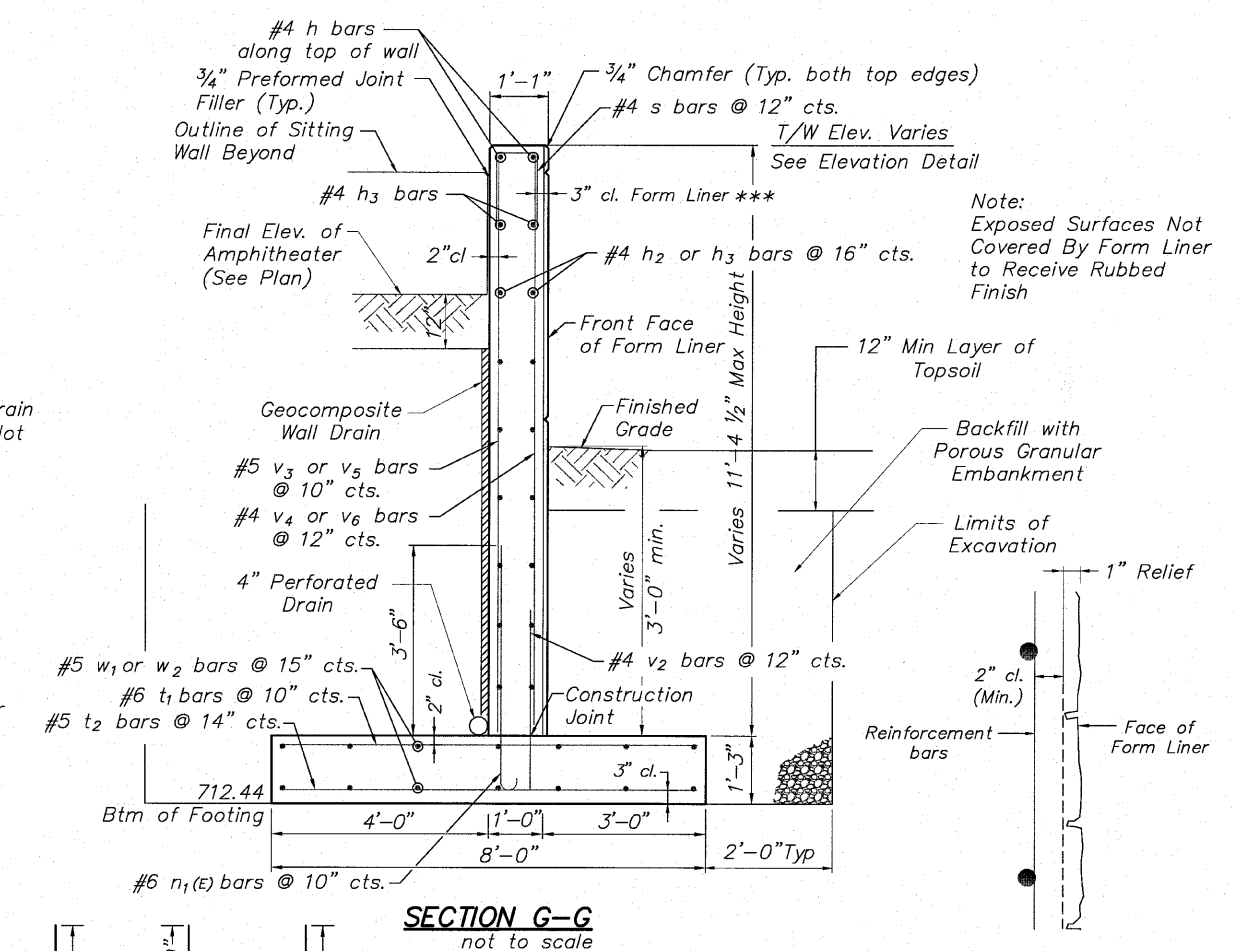
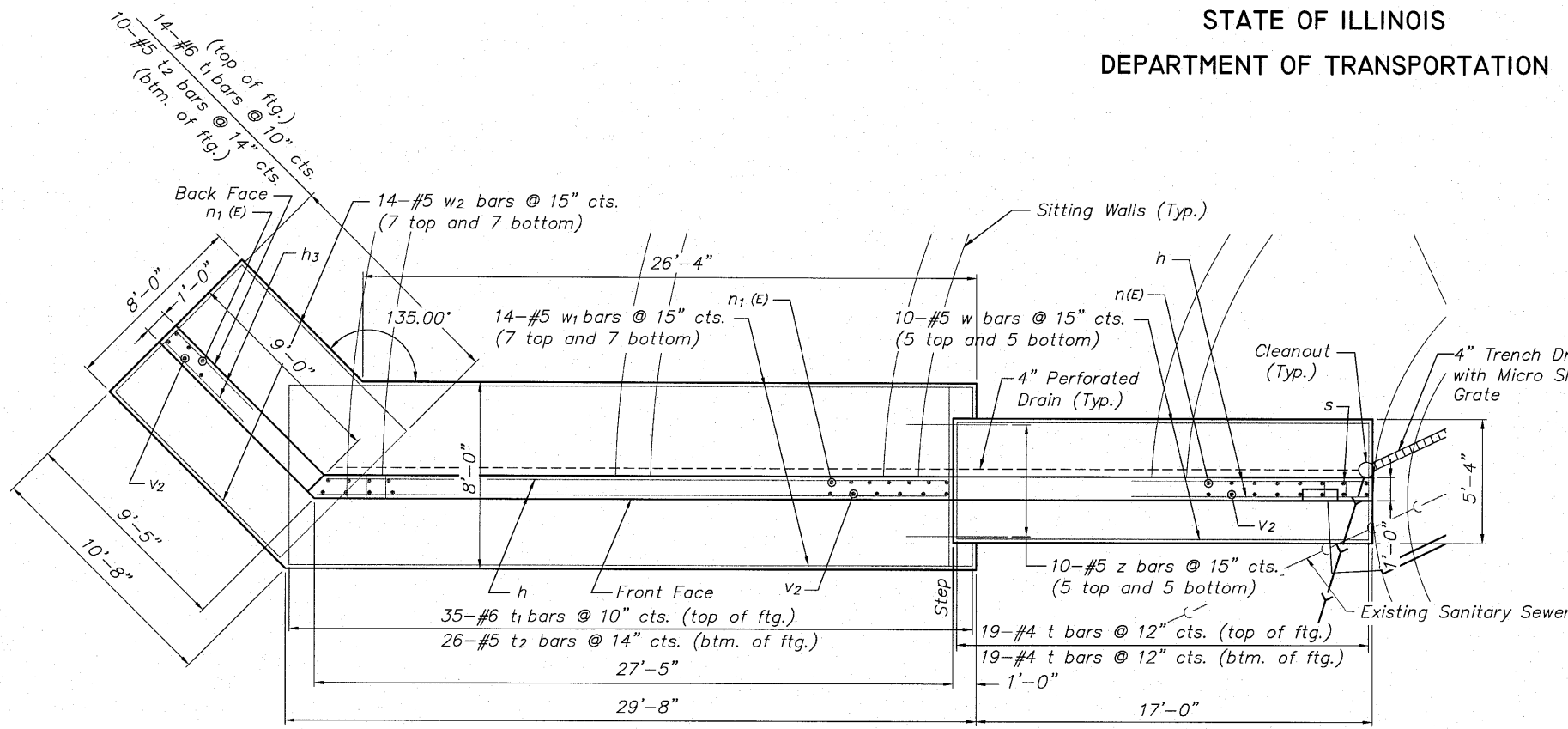

\* Field cut bars & use remaining balance in opposite end.  
 \*\* Field cut bar(s) to fit

**BILL OF MATERIAL**  
Refer to Next Sheet

**C.I.P. WALL No. 31  
ELEVATION & DETAILS  
RIVERWALK AMPHITHEATER  
WINNEBAGO COUNTY  
SECTION NO. 06-00543-00-BT  
STATION 305+38.64**

DESIGNED	CTB
CHECKED	AAG
DRAWN	JAW
CHECKED	JWH

**McClure**  
Engineering Associates, Inc.  
7282 Argus Drive  
Rockford, Illinois 61107-5837  
(815) 398-2332 Fax (815) 398-2456  
Design Firm License: Illinois #194-000816

SHEET NO. 2 5 SHEETS	F.A. RTE.	SECTION	COUNTY	TOTAL SHEETS	SHEET NO.
		06-00543-00-BT	WINNEBAGO	148	52
FED. ROAD DIST. NO.			ILLINOIS	FFD. AID PROJECT	
			CONTRACT NO.	85521	