

BENCH MARK: North Bonnet Bolt on Fire Hydrant South of Museum Entrance on the East side of N. Main Street Elev.=736.60

EXISTING STRUCTURE: None

STATE OF ILLINOIS
DEPARTMENT OF TRANSPORTATION

TOTAL BILL OF MATERIALS

ITEM	UNIT	SUPER	SUB	TOTAL
Prefabricated Cable-Stayed Pedestrian Bridge	Sq. Ft.	2,740		2,740
Structure Excavation	Cu. Yd.			
Rock Excavation for Structures	Cu. Yd.		101	101
Concrete Structures	Cu. Yd.		179.9	179.9
Reinforcement Bars (Epoxy Coated)	Pound		19,636	19,636
Furnishing Soldier Pile W Section W27x178	Foot		156	156
Setting Piles in Rock	Each		8	8
PCC Pavement, 7 1/2"	Sq. Yd.	304.4		304.4
Geocomposite Wall Drain	Sq. Yd.		68.0	68.0
Form Liner Textured Surface	Sq. Ft.		71.5	71.5

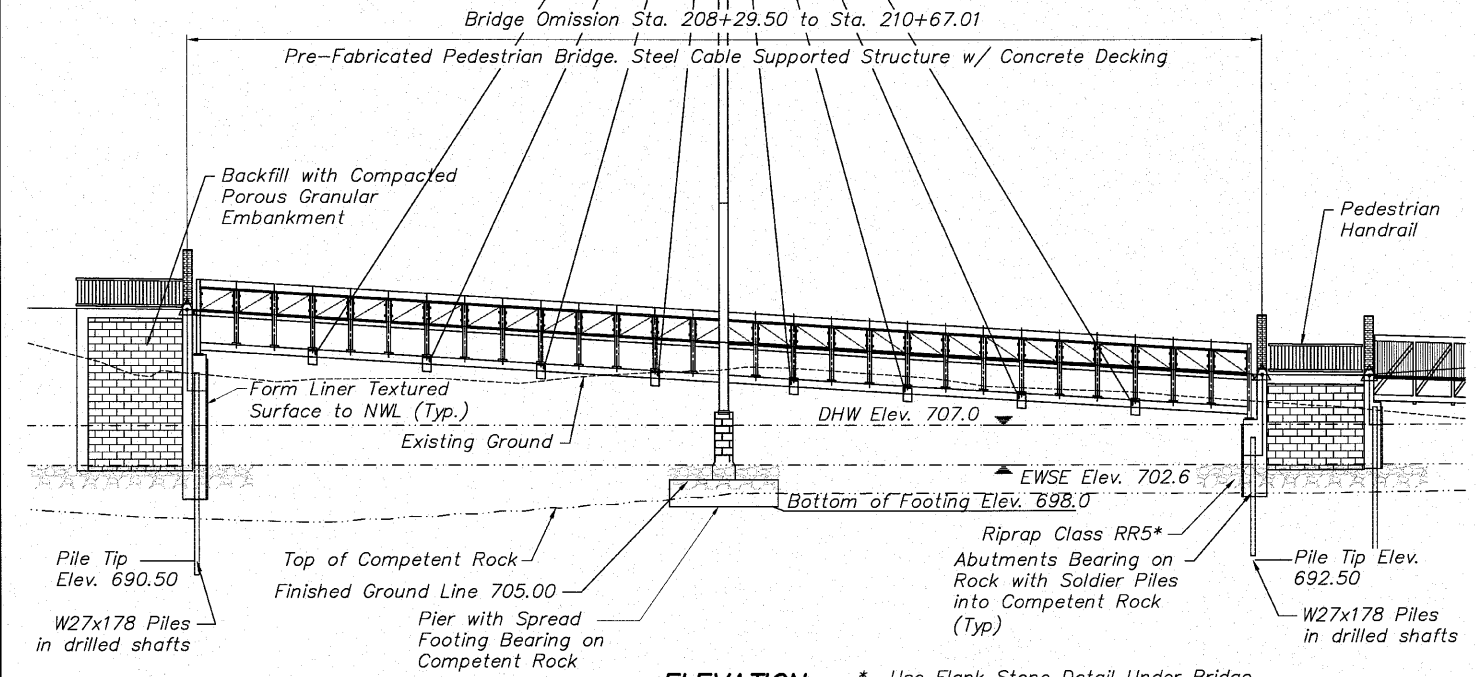

HIGHWAY CLASSIFICATION

Rockford Pedestrian Riverwalk
Functional Class: Pedestrian

DESIGN STRESSES

FIELD UNITS

$f'_c = 3,500$ psi
 $f_y = 60,000$ psi (Reinforcement)
 $f_y = 50,000$ psi (M270 Grade 50) - Soldier Pile

PREFABRICATED BRIDGE UNITS

$f_y = 50,000$ psi (M270 Grade 50)
See Special Provisions for "Pedestrian Truss Superstructure"

LOADING

Pedestrian/Bicycle Design Loading: 85 psf
Vehicular: H-10

DESIGN SPECIFICATIONS

Americans with Disabilities Act (ADA)
2002 AASHTO "Standard Specifications for Highway Bridges"
17th Edition, AASHTO "Guide Specifications for Design of Pedestrian Bridges"

SEISMIC DATA

Seismic Performance Category (SPC) = A
Horizontal Bedrock Acceleration Coefficient (A) = 0.0325g
Site Coefficient (S) = 1.0

REFER TO SHEET 11 FOR GENERAL NOTES

WATERWAY INFORMATION

Drainage Area = 6400 Sq.Mi. Low Grade Elev. 712.57 @ Sta 210+67.0

Flood	Frea. Yr.	Q C.F.S.	Opening Sq.Ft.		Nat H.W.E.	Head - Ft.		Headwater El.	
			Exist.	Prop.		Exist.	Prop.	Exist.	Prop.
Design	100	41,500	N/A	905	707.0	N/A	N/A	N/A	N/A
Base	100	41,500	N/A	905	707.0	N/A	N/A	N/A	N/A
Max. Calc.	500		N/A	1,493	709.6	N/A	N/A	N/A	N/A

ELEVATION

* Use Flank Stone Detail Under Bridge in Front of Retaining Wall. Use Toe Stone Detail at Pier and Overlooks., See Details, Sht 2 of 11

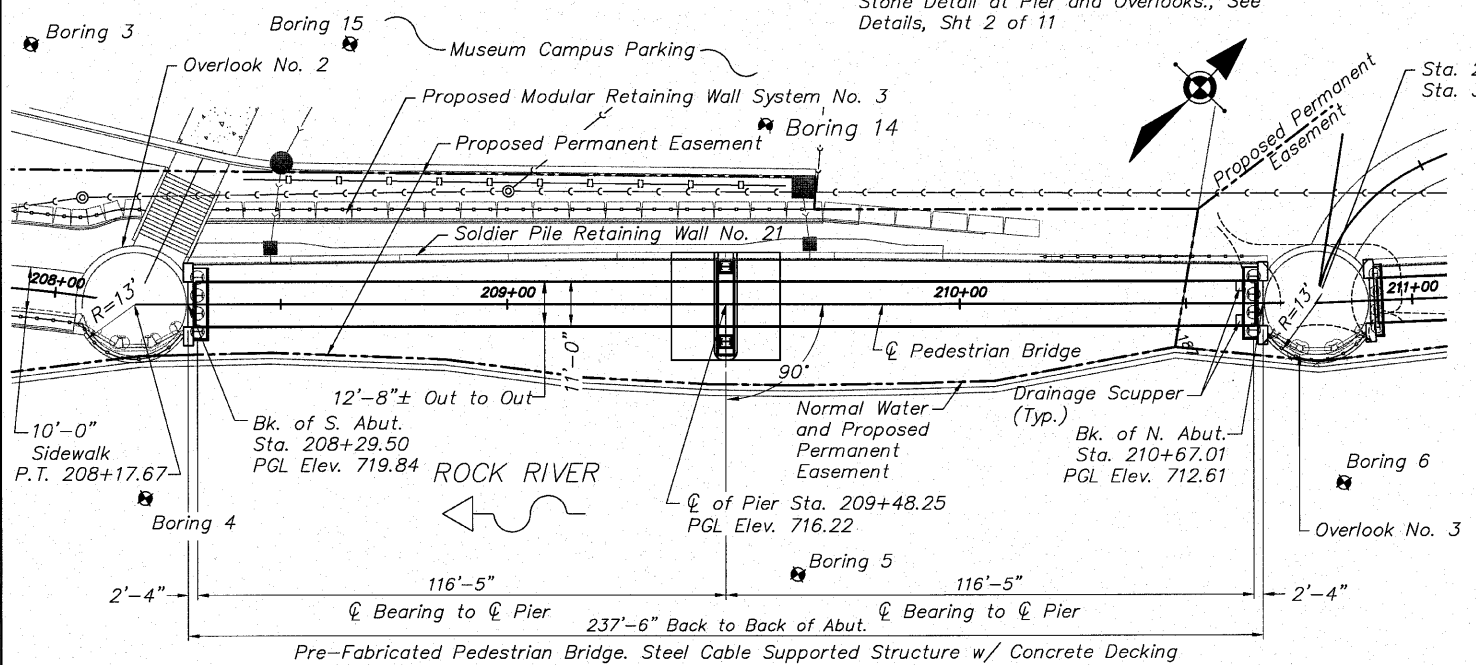

PLAN

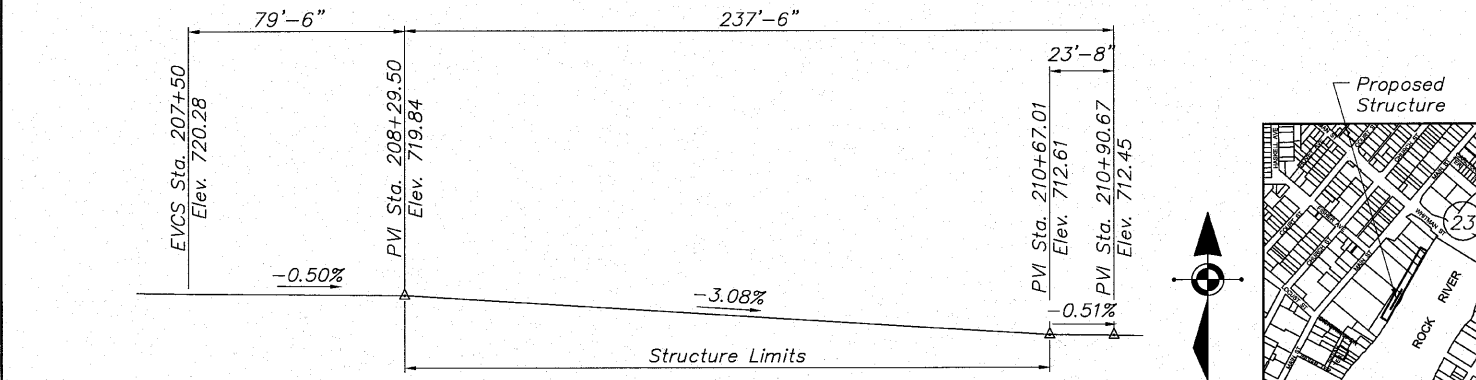

Profile Grade

(Along ϕ Walkway)

DESIGNED	CTB	2010
CHECKED	AAG	EXAMINED
DRAWN	JAW	PASSED
PEER REVIEWED		ENGINEER OF BRIDGES AND STRUCTURES

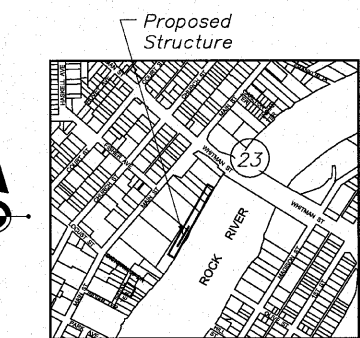

LOCATION SKETCH

INDEX OF BRIDGE SHEETS

1. General Plan & Elevation
2. Substructure Layout
3. Superstructure Details
4. Superstructure Details
5. South Abutment Details
6. South Abutment Details
7. North Abutment Details
8. North Abutment Details
9. Pier Details
10. Pier Details
11. Typical Abutment Details and General Notes

DESIGN SCOUR ELEVATIONS

South Abutment	Pier	North Abutment
700.0	700.0	700.0

STATION 209+48.25
BUILT 2011 BY
CITY OF ROCKFORD
SECTION No. 06-00543-00-BT
LOADING H-10
STR No. 101-6350

NAME PLATE

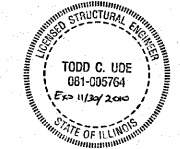

REVIEWED AND APPROVED FOR STRUCTURAL ADEQUACY ONLY EXCLUDING PRE-FABRICATED SUPERSTRUCTURE

Todd C. Ude 9/19/10

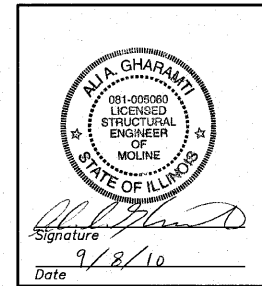

GENERAL PLAN & ELEVATION
CABLE-STAYED PEDESTRIAN BRIDGE
PEDESTRIAN RIVERWALK
ALONG THE ROCK RIVER
WINNEBAGO COUNTY
SECTION NO. 06-00543-00-BT
STATION 209+48.25
STRUCTURE NO. 101-6350

McClure
Engineering Associates, Inc.
7282 Argus Drive
(815) 398-2332
Rockford, Illinois 61107-5037
Fax (815) 398-2496
Design Firm License: Illinois #184-000816
Copyright 2010 By McClure Engineering Associates, Inc.

SHEET NO. I
II SHEETS

F.A. RTE.	SECTION	COUNTY	TOTAL SHEETS	SHEET NO.
	06-00543-00-BT	WINNEBAGO	148	56
FED. ROAD DIST. NO.	ILLINOIS	FED. AID PROJECT	CONTRACT NO. 85521	

11-108-008 RIVERWALK MUSEUM DESIGN DRAWINGS STRUCTURAL GP&E 108-008 BRIDGES-6350 SUPER-DWG. GP&E STR6350, 9/18/2010 7:11:40 AM, -1, JWH