

PLAN SURVEYED BY DATE
 PLOTTED BY DATE
 CHECKED BY DATE
 NOTE BOOK NO. _____
 RT. OF WAY CHECKED BY _____
 FILE NAME _____

PROFILE SURVEYED BY DATE
 PLOTTED BY DATE
 CHECKED BY DATE
 NOTE BOOK NO. _____
 STRUCTURE NOTATIONS CHFD _____

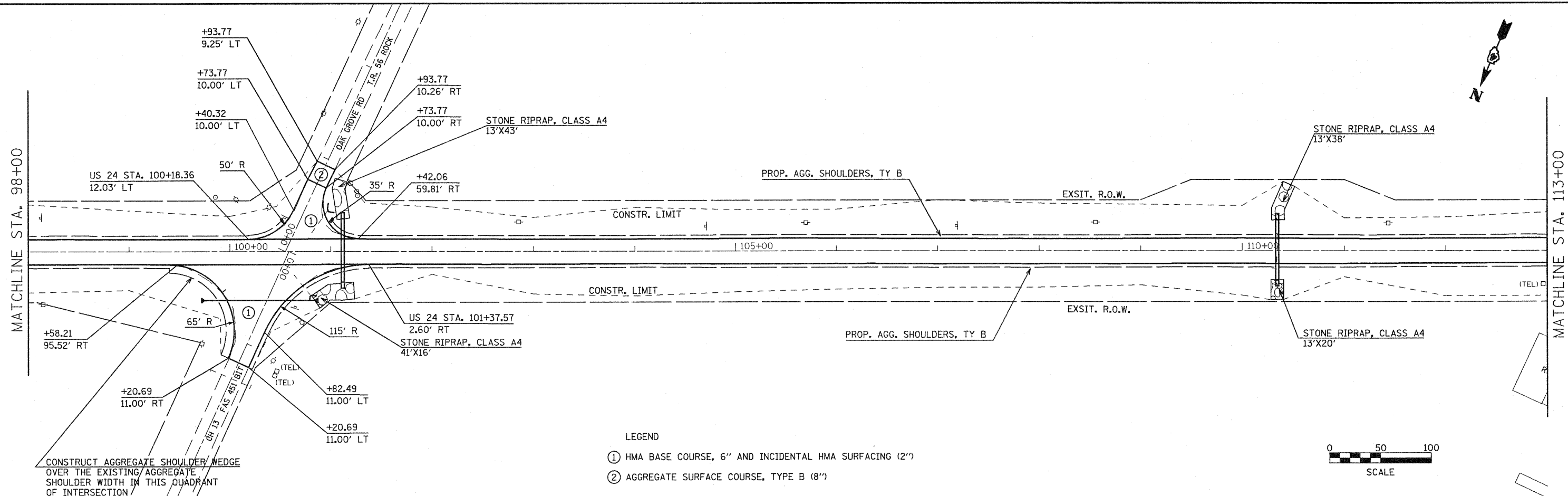

- LEGEND
- ① HMA BASE COURSE, 6" AND INCIDENTAL HMA SURFACING (2")
 - ② AGGREGATE SURFACE COURSE, TYPE B (8")

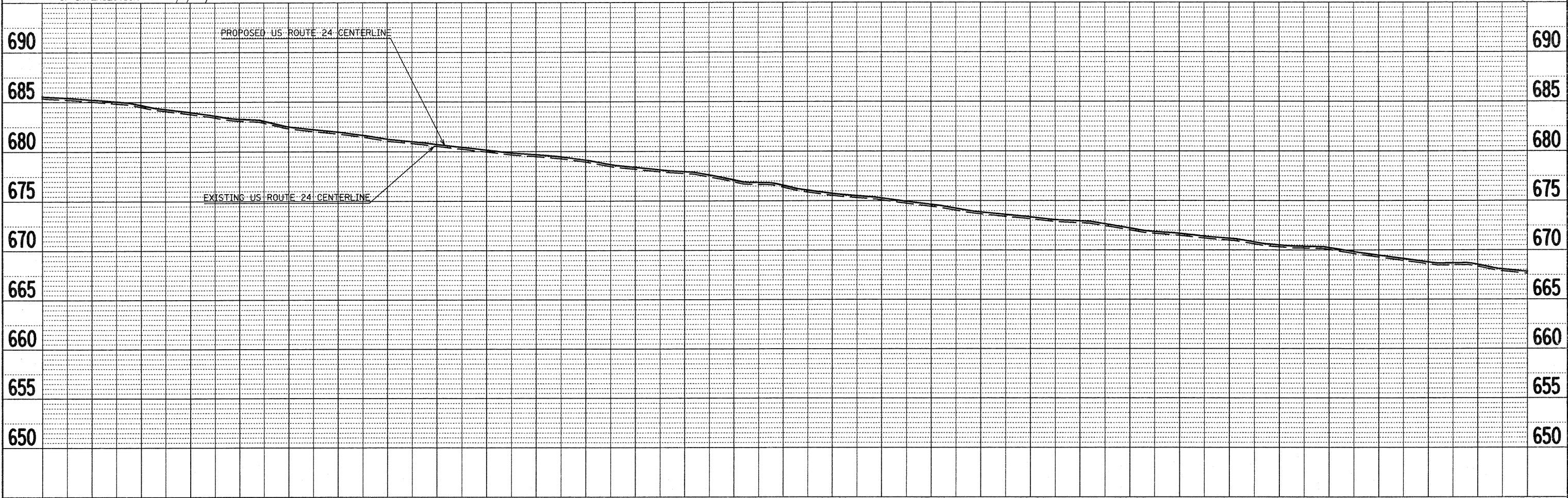
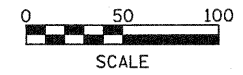

FILE NAME = plan21.dgn	USER NAME = horsthj	DESIGNED -	REVISED -	STATE OF ILLINOIS DEPARTMENT OF TRANSPORTATION	PLAN & PROFILE	F.A.P. RTE. 317	SECTION 15W-2,RS-3;16W-3,RS-5	COUNTY FULTON	TOTAL SHEETS 171	SHEET NO. 48	
PLOT SCALE = 1/8" = 100.0000' / IN.	DATE -	DRAWN - JGJ	REVISED -			SCALE:	SHEET NO. 6 OF 14 SHEETS	STA. 98+00	TO STA. 113+00	CONTRACT NO. 88098	
PLOT DATE = 8/18/2010	DATE -	CHECKED - KJH	REVISED -			FED. ROAD DIST. NO. ILLINOIS FED. AID PROJECT					
		DATE -	REVISED -								