

F.A. RTE.	SECTION	COUNTY	TOTAL SHEETS	SHEET NO.
00-P4002-03-BT		PEORIA	53	24
STA. 178+00.00		TO STA. 194+00.00		
FED. ROAD DIST. NO. ILLINOIS		FED. AID PROJECT		

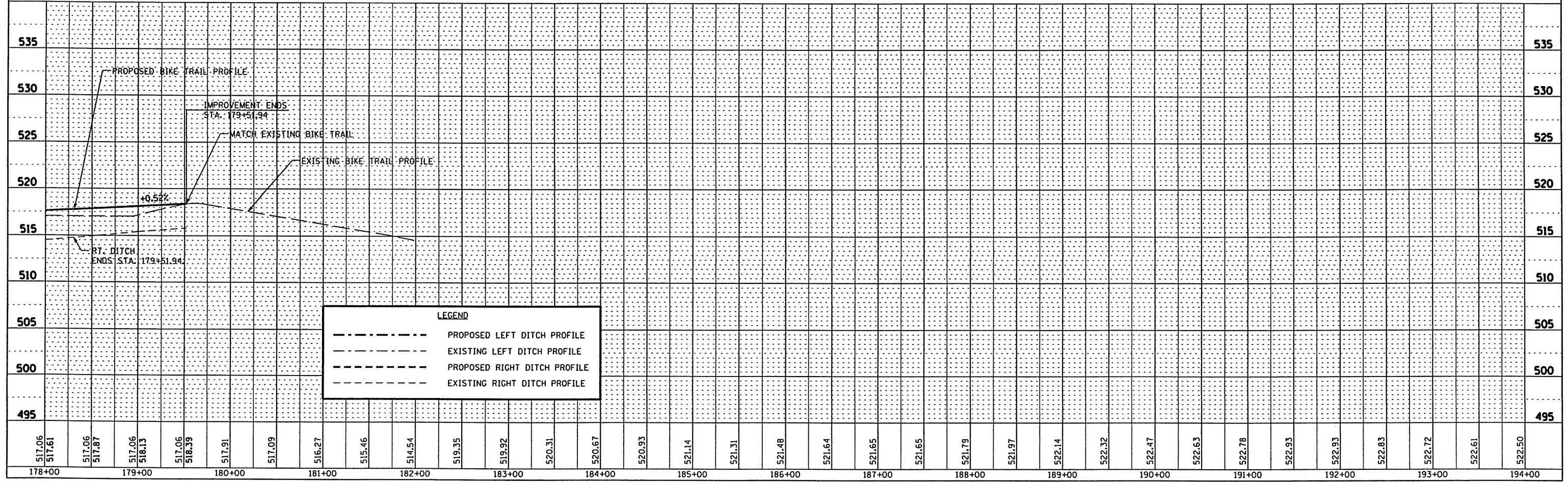
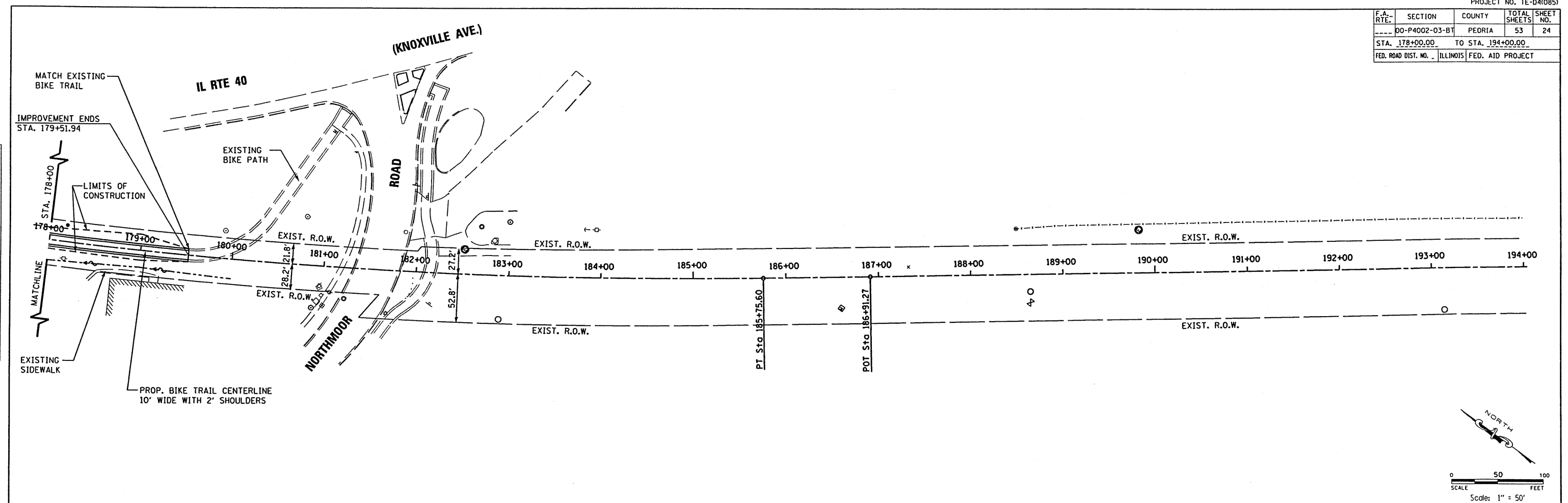

DATE	BY
DATE	BY

MAUER & STUTZ, INC.
ENGINEERS
SURVEYORS

DATE	BY
DATE	BY

517.06	517.61	517.06	517.87	517.06	516.13	517.06	518.39	517.91	517.09	516.27	515.46	514.54	519.35	519.92	520.31	520.67	520.93	521.14	521.31	521.48	521.64	521.65	521.65	521.79	521.97	522.14	522.32	522.47	522.63	522.78	522.93	522.93	522.83	522.72	522.61	522.50
178+00	179+00	180+00	181+00	182+00	183+00	184+00	185+00	186+00	187+00	188+00	189+00	190+00	191+00	192+00	193+00	194+00																				