

F.A. RTE.	SECTION	COUNTY	TOTAL SHEETS	SHEET NO.
00-P4002-03-BT	PEORIA	ILLINOIS	53	38
STA. _____ TO STA. _____		FED. ROAD DIST. NO. _____		
FED. ROAD DIST. NO. _____		FED. AID PROJECT _____		

UNLESS ELEVATIONS ARE SHOWN  
ALL UTILITY LOCATIONS SHOWN ON THE CROSS SECTIONS  
ARE BASED ON THE APPROXIMATE DEPTH SUPPLIED BY  
THE UTILITY COMPANY

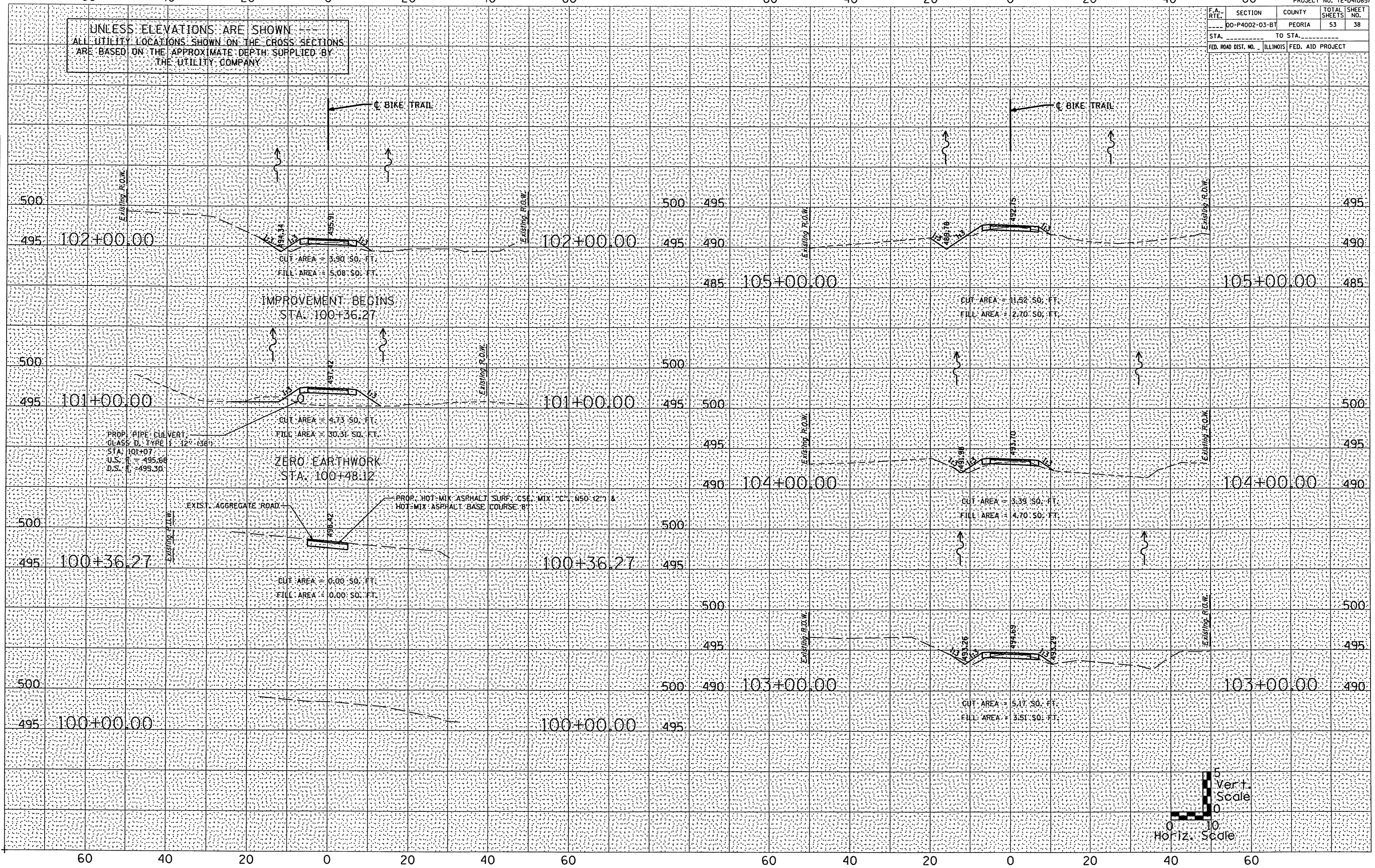

PROP. PIPE CULVERT,  
GLASS D. TYPE 1 - 12" (36")  
STA. 101+07  
U.S. = 495.66  
D.S. = 495.50

ZERO EARTHWORK  
STA. 100+48.12

EXIST. AGGREGATE ROAD  
PROP. HOT-MIX ASPHALT SURF. CSE. MIX "C" N50 12" &  
HOT-MIX ASPHALT BASE COURSE 8"

BY \_\_\_\_\_ DATE \_\_\_\_\_

ORIGINAL SURVEY \_\_\_\_\_  
SURVEY \_\_\_\_\_  
PLOTTED \_\_\_\_\_  
NOTE BOOK \_\_\_\_\_  
TEMPLATE \_\_\_\_\_  
AREAS CHECKED \_\_\_\_\_

BY \_\_\_\_\_ DATE \_\_\_\_\_

ORIGINAL SURVEY \_\_\_\_\_  
SURVEY \_\_\_\_\_  
PLOTTED \_\_\_\_\_  
NOTE BOOK \_\_\_\_\_  
TEMPLATE \_\_\_\_\_  
AREAS CHECKED \_\_\_\_\_

