

STATE OF ILLINOIS
DEPARTMENT OF TRANSPORTATION
DIVISION OF HIGHWAYS
CITY OF BREESE
ITEP SHARED-USE TRAIL PLANS

F.A. RTE.	SECTION	COUNTY	TOTAL SHEETS	SHEET NO.
	06-00016-00-BT	CLINTON	25	1
FEDERAL AID PROJECT	ILLINOIS	CONTRACT NO. 97416		

INDEX OF SHEETS

- 1 COVER
- 2 SUMMARY OF QUANTITIES, LIST OF STANDARDS AND GENERAL NOTES
- 3-4 TYPICAL SECTIONS
- 5-6 SCHEDULES OF QUANTITIES
- 7-9 PLAN AND PROFILE
- 10 EXISTING TOPOGRAPHY AND REMOVALS
- 11 EROSION CONTROL PLAN
- 12-13 PLAT OF HIGHWAYS
- 14 MISCELLANEOUS DETAILS
- 15-19 STRUCTURE PLANS
- 20-25 CROSS-SECTIONS

SECTION: 06-00016-00-BT
PROJECT: ARA-00D8(124)
JOB #: C-98-308-07
CLINTON COUNTY
ENHANCEMENT FUNDS

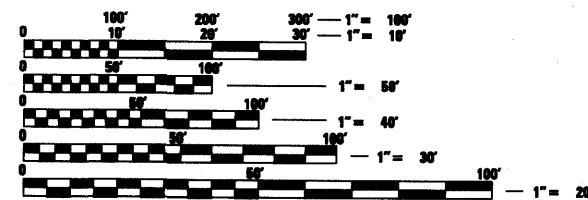
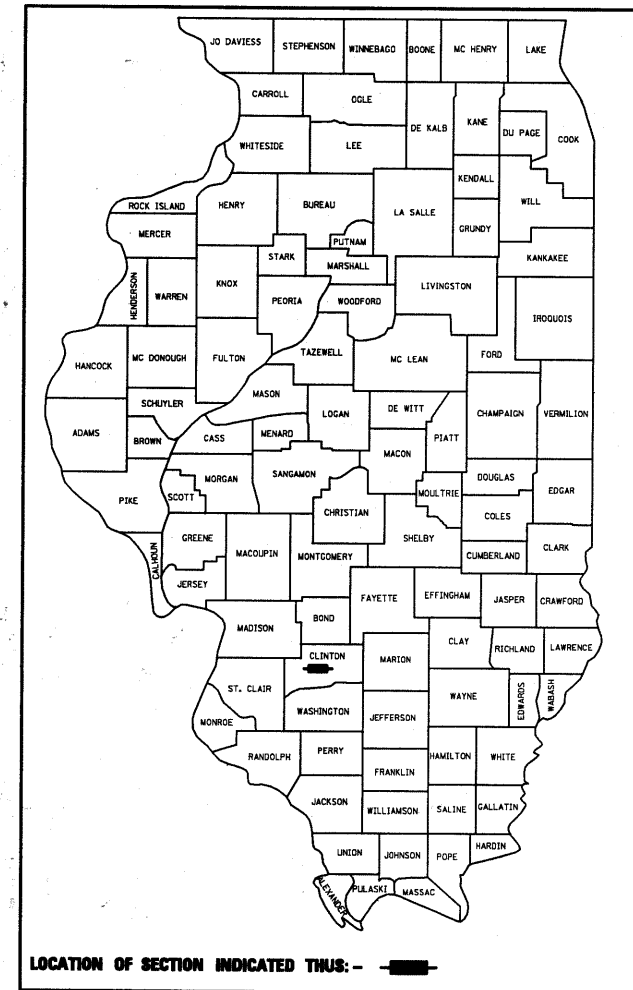

FULL SIZE PLANS HAVE BEEN PREPARED USING STANDARD ENGINEERING SCALES. REDUCED SIZED PLANS WILL NOT CONFORM TO STANDARD SCALES. IN MAKING MEASUREMENTS ON REDUCED PLANS, THE ABOVE SCALES MAY BE USED.

J.U.L.I.E.
 JOINT UTILITY LOCATION INFORMATION FOR EXCAVATION
 1-800-892-0123 OR 811

PRINTED BY THE AUTHORITY OF THE STATE OF ILLINOIS

PROJECT ENGINEER: SCOTT A. RAKERS
PROJECT MANAGER: DON VOSS

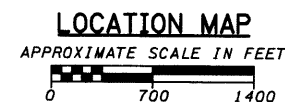
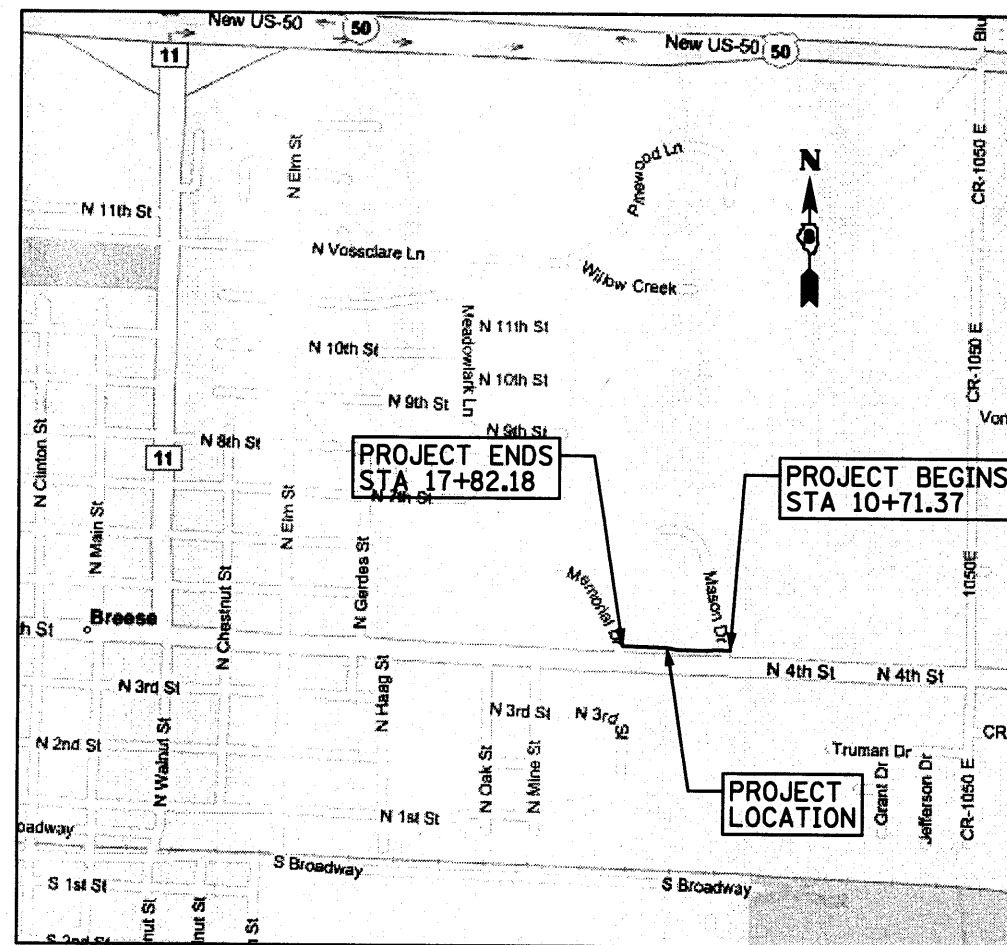

LENGTH OF IMPROVEMENTS = 710.81 FEET = 0.135 MILES

STATE OF ILLINOIS
DEPARTMENT OF TRANSPORTATION
DIVISION OF HIGHWAYS

SUBMITTED 1/17 2010
Charles E. Hilmes
 MAYOR OF THE CITY OF BREESE - CHARLES E. HILMES

PASSED January 15 2010
Lora Rensing
 ACTING DISTRICT ENGINEER OF LOCAL ROADS AND STREETS - LORA RENSING

RELEASING FOR BID BASED ON LIMITED REVIEW January 15 2010
Mary C. Lamine
 DEPUTY DIRECTOR OF HIGHWAYS, REGION 5 ENGINEER - MARY C. LAMINE

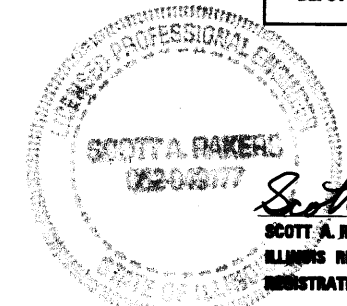

Scott A. Rakers 01/12/10
SCOTT A. RAKERS, P.E.
 ILLINOIS REGISTERED ENGINEER NO. 062-048177
 REGISTRATION EXPIRES NOV. 30, 2011