

NOTES

1. DURING IMPROVEMENTS TO U.S. ROUTE 50, THE END OF THE EXISTING SIDEWALK WAS MOVED WEST TO ACCOMMODATE VEHICULAR TURNING MOVEMENTS FROM MEMORIAL DRIVE. HOWEVER, THE ALIGNMENT OF THE SIDEWALK WAS UNCHANGED.

PROPERTY OWNER:
EVELYN J. SCHNEIDEWIND REVOCABLE TRUST

PLAN	DATE
BY	
NO.	
NO.	
NO.	
NO.	
NO.	
NO.	

PROFILE	DATE
BY	
NO.	
NO.	
NO.	
NO.	
NO.	
NO.	

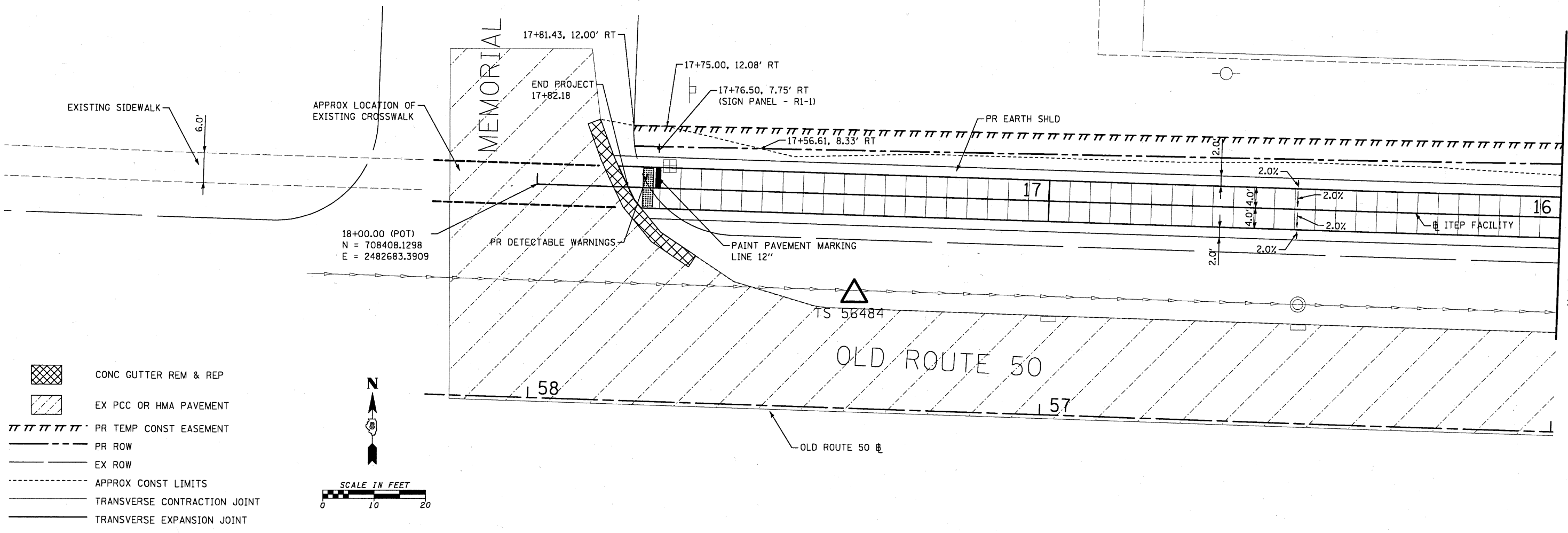

- CONC GUTTER REM & REP
- EX PCC OR HMA PAVEMENT
- PR TEMP CONST EASEMENT
- PR ROW
- EX ROW
- APPROX CONST LIMITS
- TRANSVERSE CONTRACTION JOINT
- TRANSVERSE EXPANSION JOINT

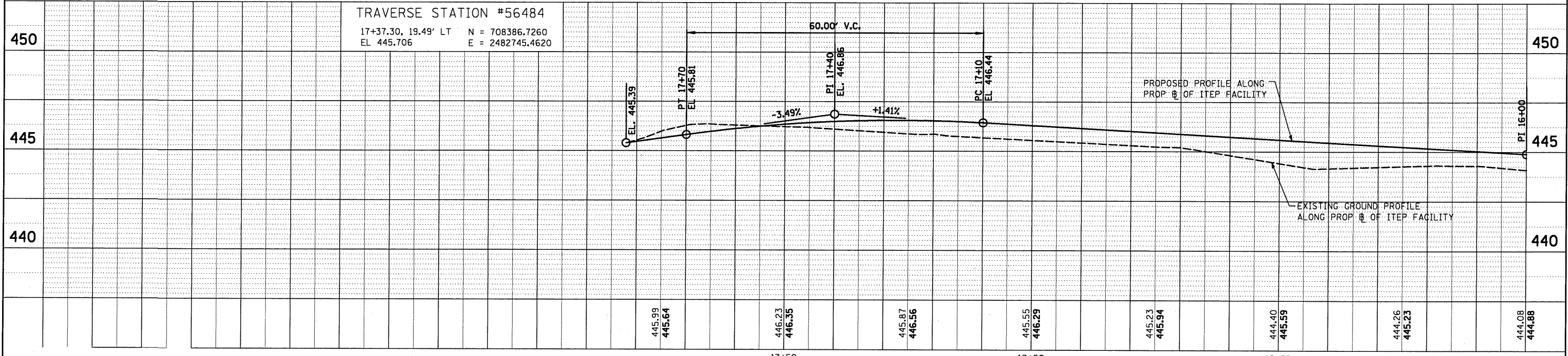
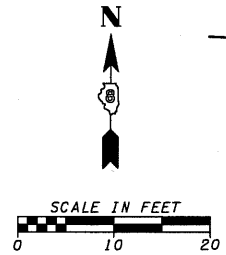

FILE NAME =	USER NAME = #USER#	DESIGNED - KJS	REVISED -	STATE OF ILLINOIS DEPARTMENT OF TRANSPORTATION	BREESE ITEP SHARED-USE FACILITY PLAN AND PROFILE	F.A. RTE.	SECTION	COUNTY	TOTAL SHEETS	SHEET NO.
#FILEL#		DRAWN - KOJ	REVISED -			06-00016-00-BT	CLINTON	25	9	
PLOT SCALE = #SCALE#		CHECKED - SAR	REVISED -			CONTRACT NO. 97416				
PLOT DATE = #DATE#		DATE - 1/11/2010	REVISED -			SCALE: 1" = 10'		SHEET NO. 3 OF 3 SHEETS		