

STATE OF ILLINOIS
DEPARTMENT OF TRANSPORTATION

F.A.P. RTE.	SECTION	COUNTY	TOTAL SHEETS	SHEET NO.
066	2021-023-RS	MCHENRY	17	1
		ILLINOIS	CONTRACT NO. 62N46	

FOR INDEX OF SHEETS, SEE SHEET NO. 2

PROJECT LOCATED IN
CITY OF HARVARD
AND
CHEMUNG TOWNSHIP

PROPOSED
HIGHWAY PLANS

F.A.P. ROUTE 066: U.S. ROUTE 14
CROWLEY ROAD TO OAK GROVE ROAD
SECTION: 2021-023-RS
PROJECT: NHPP-0K21(009)
ULTRA-THIN BONDED WEARING COURSE
MCHENRY COUNTY

D-91-096-21



TRAFFIC DATA

2019 ADT: 6,650 VPD

POSTED SPEED LIMIT: 55 MPH

C-91-119-21

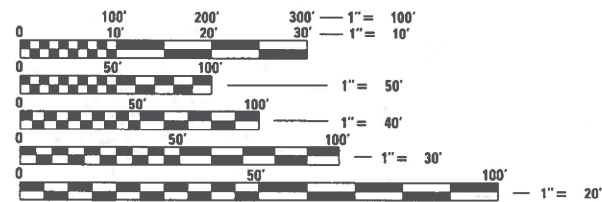

FULL SIZE PLANS HAVE BEEN PREPARED USING STANDARD ENGINEERING SCALES. REDUCED SIZED PLANS WILL NOT CONFORM TO STANDARD SCALES. IN MAKING MEASUREMENTS ON REDUCED PLANS, THE ABOVE SCALES MAY BE USED.

J.U.L.I.E.
JOINT UTILITY LOCATION INFORMATION FOR EXCAVATION
1-800-892-0123
OR 811

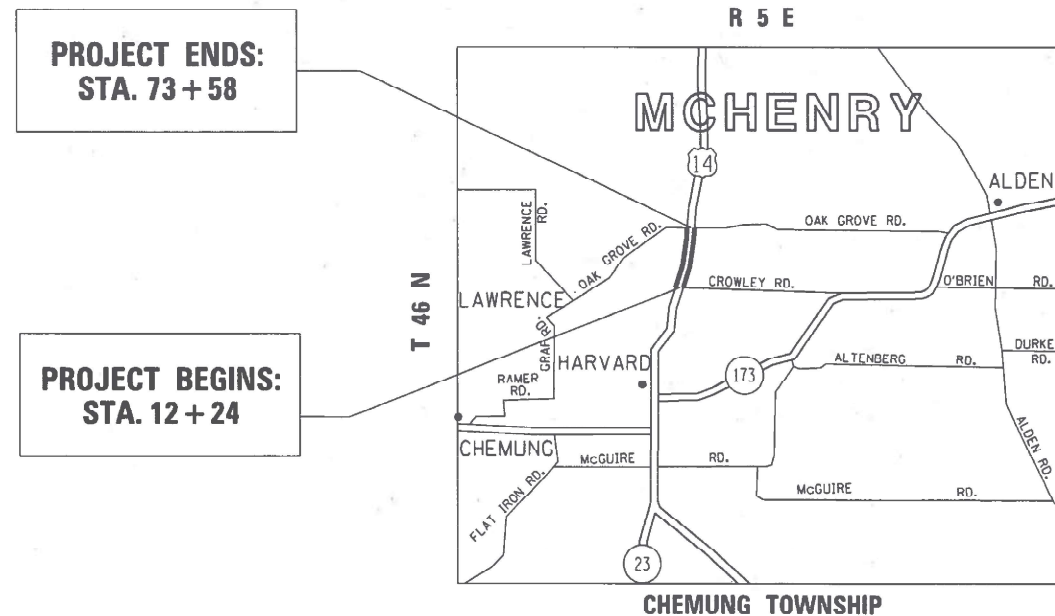

PROJECT ENDS:
STA. 73 + 58

PROJECT BEGINS:
STA. 12 + 24



GROSS LENGTH = 6,134 FT. = 1.16 MILE
NET LENGTH = 6,134 FT. = 1.16 MILE

TRANSMART
SRIJAN ADHIKARI, P.E.
#062-069784

8/13/2021

DATE:

EXPIRATION DATE: 11-30-2021

STATE OF ILLINOIS
DEPARTMENT OF TRANSPORTATION

SUBMITTED August 5, 2021
Gate Prio 1003

October 1, 2021
REGIONAL ENGINEER

October 21, 2021
ENGINEER OF DESIGN AND ENVIRONMENT

October 21, 2021
DIRECTOR OF HIGHWAYS PROJECT IMPLEMENTATION

PROJECT ENGINEER: DANIEL WILGREEN (847) 705-4240
PROJECT MANAGER: FAWAD AQUEEL (847) 705-4247

CONTRACT NO. 62N46

Transmart
411 South Wells Street Suite 1000
Chicago, Illinois 60607

CONTACT: SRIJAN ADHIKARI (312) 922-1700 EXT. 107

PRINTED BY THE AUTHORITY
OF THE STATE OF ILLINOIS

INDEX OF SHEETS

LIST OF STATE STANDARDS

GENERAL NOTES

SHEET NO.	DESCRIPTION	STANDARD NO.	DESCRIPTION
1	COVER SHEET	000001-08	STANDARD SYMBOLS, ABBREVIATIONS, AND PATTERNS
2	INDEX OF SHEETS, STANDARDS, AND GENERAL NOTES	442201-03	CLASS C AND D PATCHES
3-4	SUMMARY OF QUANTITIES	604001-05	FRAME AND LIDS, TYPE 1
5	EXISTING & PROPOSED TYPICAL SECTIONS	606001-07	CONCRETE CURB TYPE B AND COMBINATION CONCRETE CURB AND GUTTER
6 - 8	ROADWAY & PAVEMENT MARKING PLANS	701006-05	OFF-RD OPERATIONS, 2L, 2W, 15' (4.5 m) TO 24" (600 mm) FROM PAVEMENT EDGE
9	PAVEMENT PATCHING FOR HMA SURFACED PAVEMENT (BD-22)	701011-04	OFF ROAD MOVING OPERATIONS, 2L, 2W, DAY ONLY
10	BUTT JOINT AND HMA TAPER DETAILS	701301-04	LANE CLOSURE, 2L, 2W, SHORT TIME OPERATIONS
11	TRAFFIC CONTROL AND PROTECTION FOR SIDE ROADS, INTERSECTIONS, AND DRIVEWAYS (TC-10)	701306-04	LANE CLOSURE, 2L, 2W, SLOW MOVING OPERATION - DAY ONLY
12	TYPICAL APPLICATIONS RAISED REFLECTIVE PAVEMENT MARKERS (SNOW-PLOW RESISTANT) (TC-11)	701311-03	LANE CLOSURE, 2L, 2W, MOVING OPERATIONS - DAY ONLY
13	DISTRICT ONE TYPICAL PAVEMENT MARKINGS (TC-13)	701336-07	LANE CLOSURE, 2L, 2W, WORK AREA IN SERIES - 45 MPH OR MORE
14	TRAFFIC CONTROL AND PROTECTION AT TURN BAYS (TO REMAIN OPEN TO TRAFFIC) (TC-14)	701501-06	URBAN LANE CLOSURE, 2L, 2W, UNDIVIDED
15	SHORT TERM PAVEMENT MARKING LETTERS AND SYMBOLS (TC-16)	701701-10	URBAN LANE CLOSURE, MULTILANE INTERSECTION
16	ARTERIAL ROAD INFORMATION SIGN (TC-22)	701901-08	TRAFFIC CONTROL DEVICES
17	DRIVEWAY ENTRANCE SIGNING (TC-26)		

- BEFORE STARTING ANY EXCAVATION, THE CONTRACTOR SHALL CALL "J.U.L.I.E." AT (800) 892-0123 OR 811 FOR FIELD LOCATIONS OF BURIED ELECTRIC, TELEPHONE, AND GAS FACILITIES. (48 HOUR NOTIFICATION IS REQUIRED).
- THE CONTRACTOR SHALL COORDINATE CONSTRUCTION ACTIVITIES WITH UTILITY COMPANIES, THE CITY OF HARVARD, CHEMUNG TOWNSHIP AND McHENRY COUNTY DIVISION OF TRANSPORTATION.
- THE CONTRACTOR WILL NOT BE ALLOWED TO SET UP A YARD OR FIELD OFFICE ON STATE PROPERTY WITHOUT WRITTEN PERMISSION FROM THE DEPARTMENT.
- BEFORE BEGINNING ANY WORK, THE CONTRACTOR SHALL RETAIN AND RECORD FOR FUTURE REFERENCE ALL EXISTING PAVEMENT MARKING LINES AND RAISED REFLECTIVE PAVEMENT MARKERS IN ORDER THAT THESE LOCATIONS CAN BE RE-ESTABLISHED FOR STRIPING. EXACT LOCATIONS OF ALL PAVEMENT MARKINGS SHALL BE AS DIRECTED BY THE ENGINEER.
- THE CONTRACTOR SHALL CONTACT THE IDOT ARTERIAL DISTRICT ONE TRAFFIC CONTROL SUPERVISOR KALPANA KANNAN-HOSADURGA AT KALPANA.KANNAN-HOSADURGA@ILLINOIS.GOV A MINIMUM OF 72 HOURS IN ADVANCE OF BEGINNING WORK.
- THE RESIDENT ENGINEER SHALL CONTACT WALTER CZARNY, ARTERIAL TRAFFIC FIELD ENGINEER VIA EMAIL AT WALTER.CZARNY@ILLINOIS.GOV A MINIMUM OF TWO (2) WEEKS PRIOR TO THE PLACEMENT OF PERMANENT PAVEMENT MARKINGS.
- FRAMES AND GRATES ADJUSTMENT OF PRIVATE UTILITIES WITHIN THE LIMITS OF THE IMPROVEMENTS SHALL BE DONE BY THEIR RESPECTIVE OWNERS AND ARE NOT PART OF THIS CONTRACT.
- IT SHALL BE THE CONTRACTOR'S RESPONSIBILITY TO VERIFY ALL DIMENSIONS AND CONDITIONS EXISTING IN THE FIELD PRIOR TO CONSTRUCTION AND ORDERING OF MATERIALS.
- ALL DAMAGE TO EXISTING PAVEMENT MARKINGS OR RAISED REFLECTIVE PAVEMENT MARKERS OUTSIDE THE REMOVAL LINE SHOWN ON THE PLANS SHALL BE REPLACED AT THE CONTRACTOR'S EXPENSE.
- ALL PAVEMENT PATCHING, CURB AND GUTTER REMOVAL AND REPLACEMENT, AND DRAINAGE ADJUSTMENT LOCATIONS WILL BE DETERMINED IN THE FIELD BY THE ENGINEER.
- THE CONTRACTOR SHALL BE REQUIRED TO PROVIDE ACCESS TO ABUTTING PROPERTY AT ALL TIMES DURING THE CONSTRUCTION OF THIS PROJECT.
- DO NOT SCALE PLANS FOR CONSTRUCTION DIMENSIONS.
- WHEN MILLED PAVEMENT IS OPEN TO TRAFFIC, THE MAXIMUM GRADE DIFFERENTIAL BETWEEN PASSES OF THE MILLING MACHINE SHALL NOT EXCEED 1 1/2 INCHES WHERE THE SPEED LIMIT IS 45 MPH OR LESS AND 1 INCH WHERE THE SPEED LIMIT IS OVER 45 MPH. WITH WRITTEN APPROVAL FROM THE RESIDENT ENGINEER, A MAXIMUM GRADE DIFFERENTIAL OF 3 INCHES MAY BE ALLOWED IF THE EDGE OF THE MILLING IS SLOPED A MINIMUM OF 1:3 (V:H).
- DOUBLE LANE MARKERS ARE TO BE USED AS SHOWN ON THE DISTRICT ONE DETAIL "TYPICAL APPLICATIONS - RAISED REFLECTIVE PAVEMENT MARKERS (SNOW-PLOW RESISTANT)" SHOWN IN THE PLANS.
- PAINT PAVEMENT MARKING SHALL BE USED FOR SHORT TERM PAVEMENT MARKINGS ON ALL SURFACES FOLLOWING SURFACE CORRECTION. PAVEMENT MARKING TAPE, TYPE III SHALL BE USED FOR SHORT TERM PAVEMENT MARKINGS ON ALL FINAL SURFACES.
- BUTT JOINTS WILL BE INSTALLED AT THE ENDS OF RESURFACING (WHERE RESURFACING MEETS EXISTING PAVEMENT) IN ACCORDANCE WITH THE "BUTT JOINT AND HMA TAPER DETAILS" SHEET INCLUDED IN THE PLANS, UNLESS OTHERWISE SPECIFIED.
- UNLESS OTHER CONDITIONS WARRANT EXTENDED LANE CLOSURE AS DETERMINED AND APPROVED IN WRITING BY THE ENGINEER OR AS PROVIDED FOR IN THE CONTRACT SPECIFICATIONS, OVERNIGHT CLOSURES SHALL NOT BE ALLOWED FOR REHABILITATION PROJECTS INVOLVING DAYTIME MILLING AND RESURFACING OPERATIONS AND CLASS D PATCHING.
- EXISTING BROKEN FRAMES AND LIDS SHALL BE REMOVED AND DISPOSED OF BY THE CONTRACTOR AND SHALL BE REPLACED AS DIRECTED BY THE ENGINEER. REPLACEMENT FRAMES AND LIDS WILL BE PAID FOR ACCORDING TO ARTICLE 109.04 OF THE STANDARD SPECIFICATIONS UNLESS A SEPARATE PAY ITEM HAS BEEN PROVIDED.

MODEL: Default
FILE NAME: S:\projects\2015 - IDOT PTB - 1964016 - Infrastructure Engineer\Project Work\CADD\CADD Sheets\109621-sh-cen-mat-c1.dwg



USER NAME = wjeuter	DESIGNED - JJT	REVISED -
	DRAWN - JJT	REVISED -
PLOT SCALE = 1.0000' / in.	CHECKED - SA	REVISED -
PLOT DATE = 8/16/2021	DATE - 8/16/2021	REVISED -

**STATE OF ILLINOIS
DEPARTMENT OF TRANSPORTATION**

**U.S. ROUTE 14 (OAK GROVE RD. TO CROWLEY RD.)
INDEX OF SHEETS & STATE STANDARDS**

SCALE: SHEET OF SHEETS STA. TO STA.

F.A.P. RTE.	SECTION	COUNTY	TOTAL SHEETS	SHEET NO.
066	2021-023-R5	MCHEMRY	17	2
			CONTRACT NO. 62N46	
		ILLINOIS	FED. AID PROJECT	

SUMMARY OF QUANTITIES				CONSTRUCTION TYPE CODE			
SPECIALTY ITEM	CODE NO	ITEM	UNIT	TOTAL QUANTITIES URBAN	0005 ROADWAY 80% FED 20% STATE		
	40400001	FIBER-MODIFIED ASPHALT CRACK SEALING	FOOT	7,054	7,054		
	40600250	RAPID SETTING POLYMER MODIFIED EMULSION	POUND	9,084	9,084		
	40600400	MIXTURE FOR CRACKS, JOINTS, AND FLANGEWAYS	TON	10	10		
	40600901	HOT-MIX ASPHALT BINDER COURSE (HAND METHOD), N70	TON	3	3		
	40600982	HOT-MIX ASPHALT SURFACE REMOVAL - BUTT JOINT	SQ YD	454	454		
	44000690	HOT-MIX ASPHALT SURFACE CORRECTION	SQ YD	21,629	21,629		
	44201670	CLASS D PATCHES, TYPE I, 2 INCH	SQ YD	50	50		
	44201672	CLASS D PATCHES, TYPE II, 2 INCH	SQ YD	500	500		
	44201674	CLASS D PATCHES, TYPE III, 2 INCH	SQ YD	250	250		
	44201676	CLASS D PATCHES, TYPE IV, 2 INCH	SQ YD	100	100		
	67000400	ENGINEER'S FIELD OFFICE, TYPE A	CAL MO	6	6		
	67100100	MOBILIZATION	LSUM	1	1		
	70100460	TRAFFIC CONTROL AND PROTECTION, STANDARD 701306	LSUM	1	1		
	70100600	TRAFFIC CONTROL AND PROTECTION, STANDARD 701336	LSUM	1	1		
	70102635	TRAFFIC CONTROL AND PROTECTION, STANDARD 701701	LSUM	1	1		
	70300100	SHORT TERM PAVEMENT MARKING	FOOT	5,140	5,140		

SUMMARY OF QUANTITIES				CONSTRUCTION TYPE CODE			
SPECIALTY ITEM	CODE NO	ITEM	UNIT	TOTAL QUANTITIES URBAN	0005 ROADWAY 80% FED 20% STATE		
	70300150	SHORT TERM PAVEMENT MARKING REMOVAL	SQ FT	857	857		
	70300210	TEMPORARY PAVEMENT MARKING LETTERS AND SYMBOLS	SQ FT	219	219		
	70300220	TEMPORARY PAVEMENT MARKING - LINE 4"	FOOT	27,047	27,047		
	70300240	TEMPORARY PAVEMENT MARKING - LINE 6"	FOOT	1,222	1,222		
	70300260	TEMPORARY PAVEMENT MARKING - LINE 12"	FOOT	374	374		
	70300280	TEMPORARY PAVEMENT MARKING - LINE 24"	FOOT	47	47		
*	78000100	THERMOPLASTIC PAVEMENT MARKING - LETTERS AND SYMBOLS	SQ FT	438	438		
*	78000200	THERMOPLASTIC PAVEMENT MARKING - LINE 4"	FOOT	54,094	54,094		
*	78000400	THERMOPLASTIC PAVEMENT MARKING - LINE 6"	FOOT	2,444	2,444		
*	78000600	THERMOPLASTIC PAVEMENT MARKING - LINE 12"	FOOT	748	748		
*	78000650	THERMOPLASTIC PAVEMENT MARKING - LINE 24"	FOOT	94	94		
*	78100100	RAISED REFLECTIVE PAVEMENT MARKER	EACH	226	226		
	78300200	RAISED REFLECTIVE PAVEMENT MARKER REMOVAL	EACH	226	226		
	X0300031	ULTRA-THIN BONDED WEARING COURSE, IL-9.5 UTB, MIX "D"	SQ YD	21,629	21,629		
	X2020110	GRADING AND SHAPING SHOULDERS	UNIT	235	235		
	X7030005	TEMPORARY PAVEMENT MARKING REMOVAL	SQ FT	10,312	10,312		

MODEL: Default
 FILE NAME: 317103011 - IDOT_PTB_196-016 - Infrastructure Engineering\Project Work\CADD\CADD_Sheets\196B1-016-S0001.dgn



USER NAME = wdeuter	DESIGNED - JJT	REVISED -
	DRAWN - JJT	REVISED -
PLOT SCALE = 1.0000' / in.	CHECKED - SA	REVISED -
PLOT DATE = 8/16/2021	DATE - 8/16/2021	REVISED -

**STATE OF ILLINOIS
DEPARTMENT OF TRANSPORTATION**

**U.S. ROUTE 14 (OAK GROVE RD. TO CROWLEY RD.)
SUMMARY OF QUANTITIES (SHEET 1 OF 2)**

SCALE: SHEET 1 OF 2 SHEETS STA. TO STA.

F.A.P. RTE.	SECTION	COUNTY	TOTAL SHEETS	SHEET NO.
066	2021-023-R5	MCHENRY	17	3
ILLINOIS FED. AID PROJECT			CONTRACT NO. 62N46	

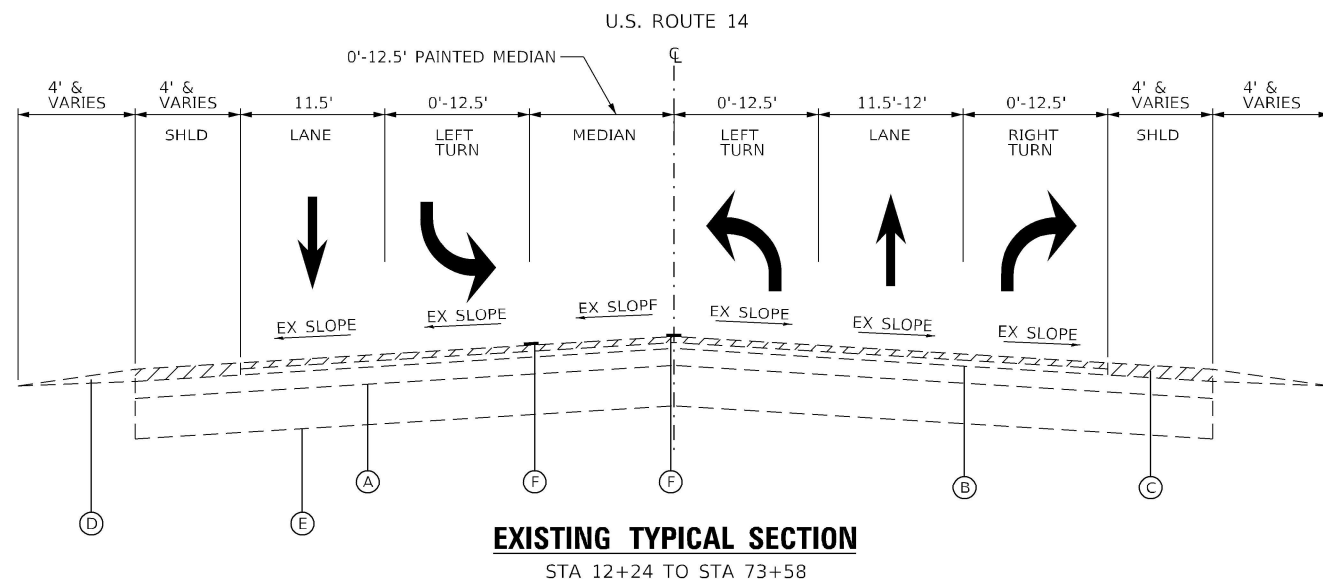

EXISTING TYPICAL SECTION

STA 12+24 TO STA 73+58

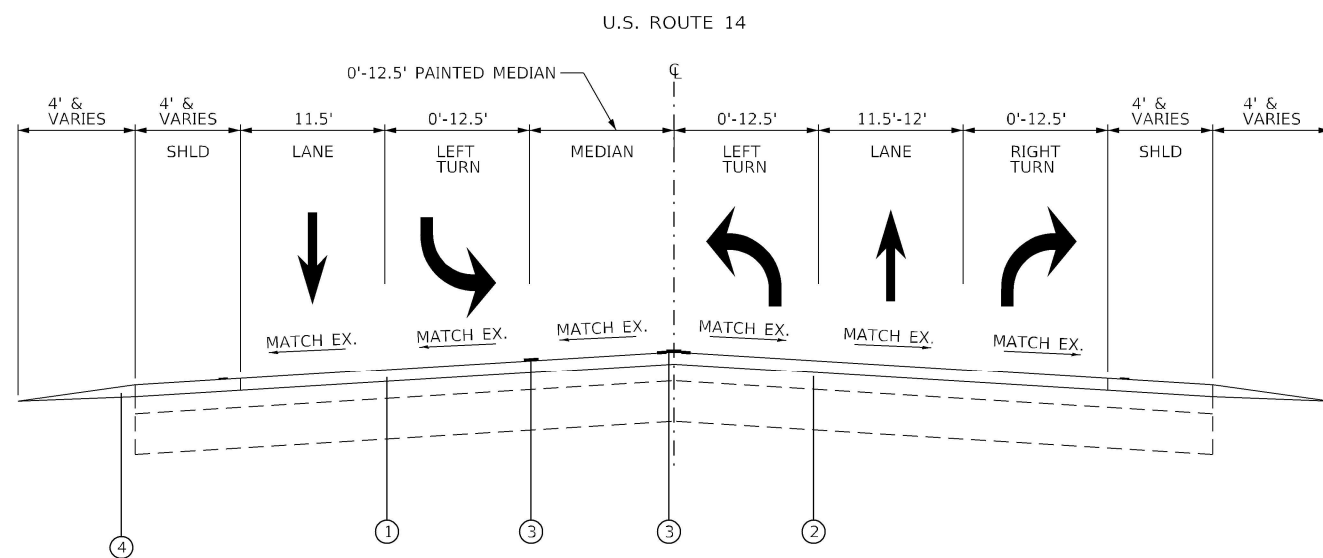

PROPOSED TYPICAL SECTION

STA 12+24 TO STA 73+58

LEGEND – EXISTING:

- (A) PCC BASE COURSE, 9"±
- (B) HOT-MIX ASPHALT SURFACE, 3"±
- (C) HOT MIX ASPHALT SHOULDER
- (D) AGGREGATE SHOULDER, TYPE B
- (E) SUBBASE

LEGEND – REMOVAL:

- (F) EXISTING RAISED REFLECTIVE PAVEMENT MARKINGS (SEE NOTE 2)
- ▨ HOT-MIX ASPHALT SURFACE CORRECTION, 1/2"

LEGEND – PROPOSED

- (1) ULTRA-THIN BONDED WEARING COURSE, IL-9.5 UTB, MIX "D", 3/4"
- (2) RAPID SETTING POLYMER MODIFIED EMULSION
- (3) RAISED REFLECTIVE PAVEMENT MARKINGS
- (4) GRADING AND SHAPING OF SHOULDERS

NOTES

1. PATCHING SHALL BE PERFORMED BEFORE HMA SURFACE CORRECTION OPERATIONS. HMA REMOVAL AND REPLACEMENT OVER PATCHES IS NOT REQUIRED, THE CLASS D PATCH SHALL MATCH THE EXISTING PAVEMENT SURFACE.
2. HOLE ON PAVEMENT FORMED DUE TO REMOVAL OF RAISED REFLECTIVE PAVEMENT MARKING SHALL BE FILLED WITH HMA BINDER N70 (HAND METHOD) AND COMPACTED BEFORE APPLYING RAPID SETTING POLYMER MODIFIED EMULSION AND ULTRA-THIN HMA SURFACE COURSE.
3. THE UNIT WEIGHT USED TO CALCULATE ALL HMA SURFACE MIXTURE QUANTITIES IS 112 LBS/SQYD/IN. THE UNIT WEIGHT USED TO CALCULATE ALL ULTRA THIN HMA SURFACE MIXTURE QUANTITIES IS 100 LBS/SQYD/IN. RESIDUAL ASPHALT RATE OF RAPID SETTING POLYMER MODIFIED CALCULATED AT 0.14 LB/SF.
4. THE "AC TYPE" FOR NON-POLYMERIZED HMA SHALL BE "PG 64 -22" UNLESS MODIFIED BY DISTRICT ONE SPECIAL PROVISIONS.
5. FOR USE OF RECYCLED MATERIALS SEE SPECIAL PROVISIONS.
6. QUALITY MANAGEMENT PROGRAM (QMP) IDENTIFIES THE PARTICULAR QUALITY CONTROL SPECIFICATION THAT APPLIES TO THE HMA MIXTURE.

HOT-MIX ASPHALT MIXTURE REQUIREMENTS		QUALITY MANAGEMENT PROGRAM (QMP)
MIXTURE TYPE	AIR VOIDS @ Ndes	
PATCHING		
CLASS D PATCHES (HMA SURFACE COURSE, MIX D, IL-9.5, N70)	4% AT 70 GYR.	QC/QA
HMA BINDER COURSE (HAND METHOD), IL-9.5, N70	4% AT 70 GYR.	QC/QA
QMP DESIGNATION: QUALITY CONTROL/QUALITY ASSURANCE (QC/QA); QUALITY CONTROL FOR PERFORMANCE (QCP)		

MODEL Path: \\... Infrastructure Engineer\Project Work\CADD\CADD Sheets\108621-shc-tp-secal.dgn

USER NAME = wjeuter	DESIGNED - JJT	REVISED -
PLOT SCALE = 1.0000' / in.	DRAWN - JJT	REVISED -
PLOT DATE = 8/16/2021	CHECKED - SA	REVISED -
	DATE - 8/16/2021	REVISED -

F.A.P. RTE.	SECTION	COUNTY	TOTAL SHEETS	SHEET NO.
066	2021-023-RS	MCHENRY	17	5
CONTRACT NO. 62N46			ILLINOIS FED. AID PROJECT	

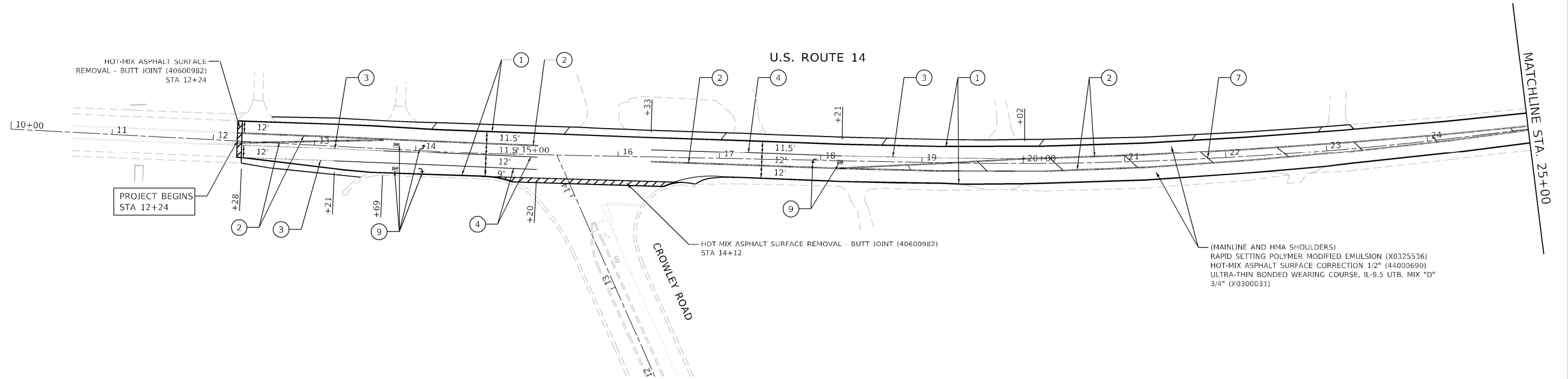

- PAVEMENT MARKING LEGEND:**
- ① PROPOSED THERMOPLASTIC PAVEMENT MARKING - LINE 4", WHITE SOLID LINE
 - ② PROPOSED THERMOPLASTIC PAVEMENT MARKING - LINE 4", DOUBLE YELLOW SOLID LINE
 - ③ PROPOSED THERMOPLASTIC PAVEMENT MARKING - LINE 6", WHITE 6' SKIP - 2' DASH
 - ④ PROPOSED THERMOPLASTIC PAVEMENT MARKING - LINE 6", WHITE SOLID LINE
 - ⑤ PROPOSED THERMOPLASTIC PAVEMENT MARKING - LINE 8", WHITE SOLID LINE
 - ⑥ PROPOSED THERMOPLASTIC PAVEMENT MARKING - LINE 12", WHITE SOLID LINE
 - ⑦ PROPOSED THERMOPLASTIC PAVEMENT MARKING - LINE 12", YELLOW SOLID LINE
 - ⑧ PROPOSED THERMOPLASTIC PAVEMENT MARKING - LINE 24", WHITE SOLID LINE
 - ⑨ PROPOSED THERMOPLASTIC PAVEMENT MARKING - LETTERS AND SYMBOLS

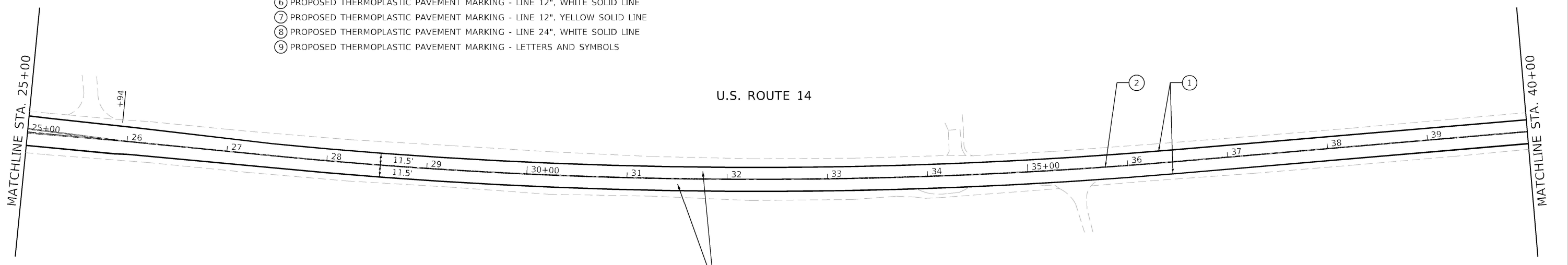

(MAINLINE AND HMA SHOULDERS)
 RAPID SETTING POLYMER MODIFIED EMULSION (X0325536)
 HOT-MIX ASPHALT SURFACE CORRECTION 1/2" (44000690)
 ULTRA-THIN BONDED WEARING COURSE, IL-9.5 UTB, MIX "D" 3/4"
 (X0300031)

MODEL: Default
 FILE NAME: S:\projects\2015 - IDOT_PTB_196\016 - Infrastructure_Engineering\Project Work\CADD\CADD_Sheets\108621-shr-tabr-01.dgn

TranSmart
 411 South Wells Street Suite 1000
 Chicago, Illinois 60607

USER NAME = wjeuter	DESIGNED - JJT	REVISED -
DRAWN - JJT	REVISIONS -	
PLOT SCALE = 100.0000' / in.	CHECKED - SA	REVISED -
PLOT DATE = 8/16/2021	DATE - 8/16/2021	REVISED -

**STATE OF ILLINOIS
 DEPARTMENT OF TRANSPORTATION**

**U.S. ROUTE 14 (OAK GROVE RD. TO CROWLEY RD.)
 ROADWAY PLAN (SHEET 1 OF 3)**

SCALE: 1"=50' SHEET 1 OF 3 SHEETS STA. 14+66 TO STA. 40+00

F.A.P. RTE.	SECTION	COUNTY	TOTAL SHEETS	SHEET NO.
066	2021-023-RS	MCHENRY	17	6
CONTRACT NO. 62N46				
ILLINOIS FED. AID PROJECT				

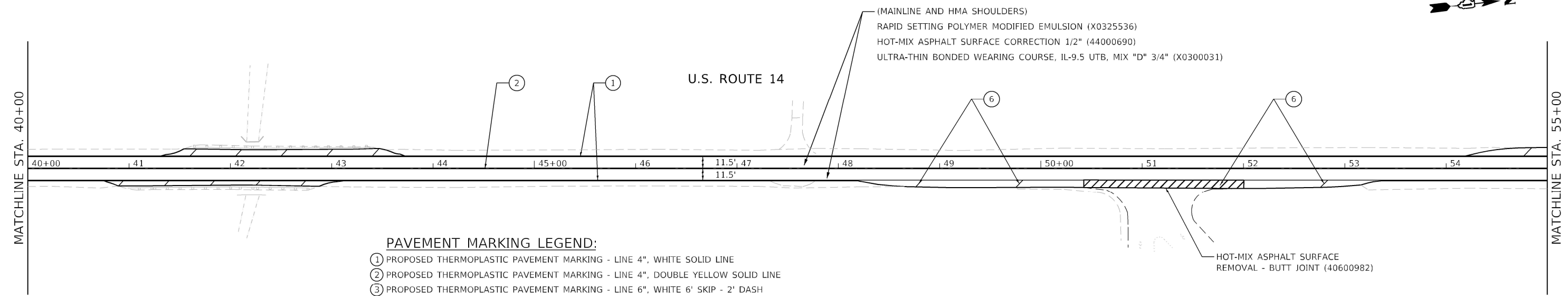

PAVEMENT MARKING LEGEND:

- ① PROPOSED THERMOPLASTIC PAVEMENT MARKING - LINE 4", WHITE SOLID LINE
- ② PROPOSED THERMOPLASTIC PAVEMENT MARKING - LINE 4", DOUBLE YELLOW SOLID LINE
- ③ PROPOSED THERMOPLASTIC PAVEMENT MARKING - LINE 6", WHITE 6' SKIP - 2' DASH
- ④ PROPOSED THERMOPLASTIC PAVEMENT MARKING - LINE 6", WHITE SOLID LINE
- ⑤ PROPOSED THERMOPLASTIC PAVEMENT MARKING - LINE 8", WHITE SOLID LINE
- ⑥ PROPOSED THERMOPLASTIC PAVEMENT MARKING - LINE 12", WHITE SOLID LINE
- ⑦ PROPOSED THERMOPLASTIC PAVEMENT MARKING - LINE 12", YELLOW SOLID LINE
- ⑧ PROPOSED THERMOPLASTIC PAVEMENT MARKING - LINE 24", WHITE SOLID LINE
- ⑨ PROPOSED THERMOPLASTIC PAVEMENT MARKING - LETTERS AND SYMBOLS

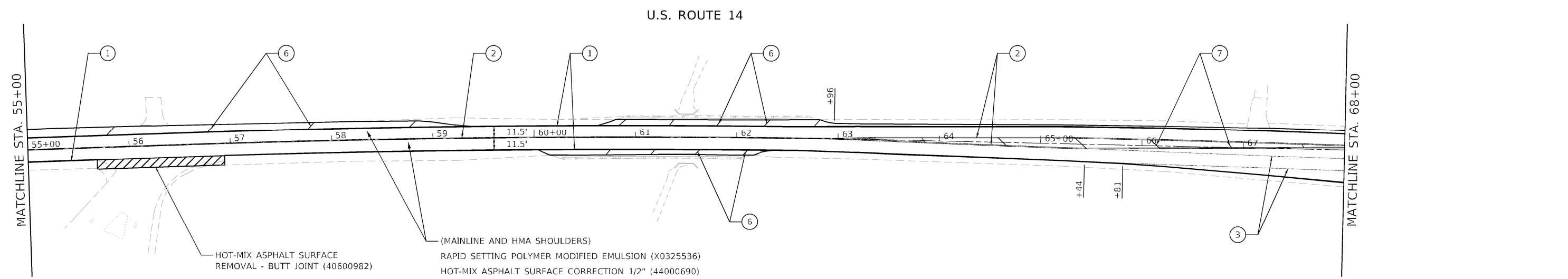

(MAINLINE AND HMA SHOULDERS)
 RAPID SETTING POLYMER MODIFIED EMULSION (X0325536)
 HOT-MIX ASPHALT SURFACE CORRECTION 1/2" (44000690)
 ULTRA-THIN BONDED WEARING COURSE, IL-9.5 UTB, MIX "D" 3/4" (X0300031)

HOT-MIX ASPHALT SURFACE
 REMOVAL - BUTT JOINT (40600982)

MODEL: Default
 FILE NAME: S:\projects\2015 - IDOT PTB_196\016 - Infrastructure Engineer\Project Work\CADD\CADD Sheets\108621-shc-pln-02.dgn



USER NAME = wdeuter	DESIGNED - JJT	REVISED -
	DRAWN - JJT	REVISED -
PLOT SCALE = 100.0000' / in.	CHECKED - SA	REVISED -
PLOT DATE = 8/16/2021	DATE - 8/16/2021	REVISED -

**STATE OF ILLINOIS
 DEPARTMENT OF TRANSPORTATION**

**U.S. ROUTE 14 (OAK GROVE RD. TO CROWLEY RD.)
 ROADWAY PLAN (SHEET 2 OF 3)**

SCALE: 1"=50' SHEET 2 OF 3 SHEETS STA. 40+00 TO STA. 68+00

F.A.P. RTE.	SECTION	COUNTY	TOTAL SHEETS	SHEET NO.
066	2021-023-RS	MCHENRY	17	7
CONTRACT NO. 62N46			ILLINOIS FED. AID PROJECT	

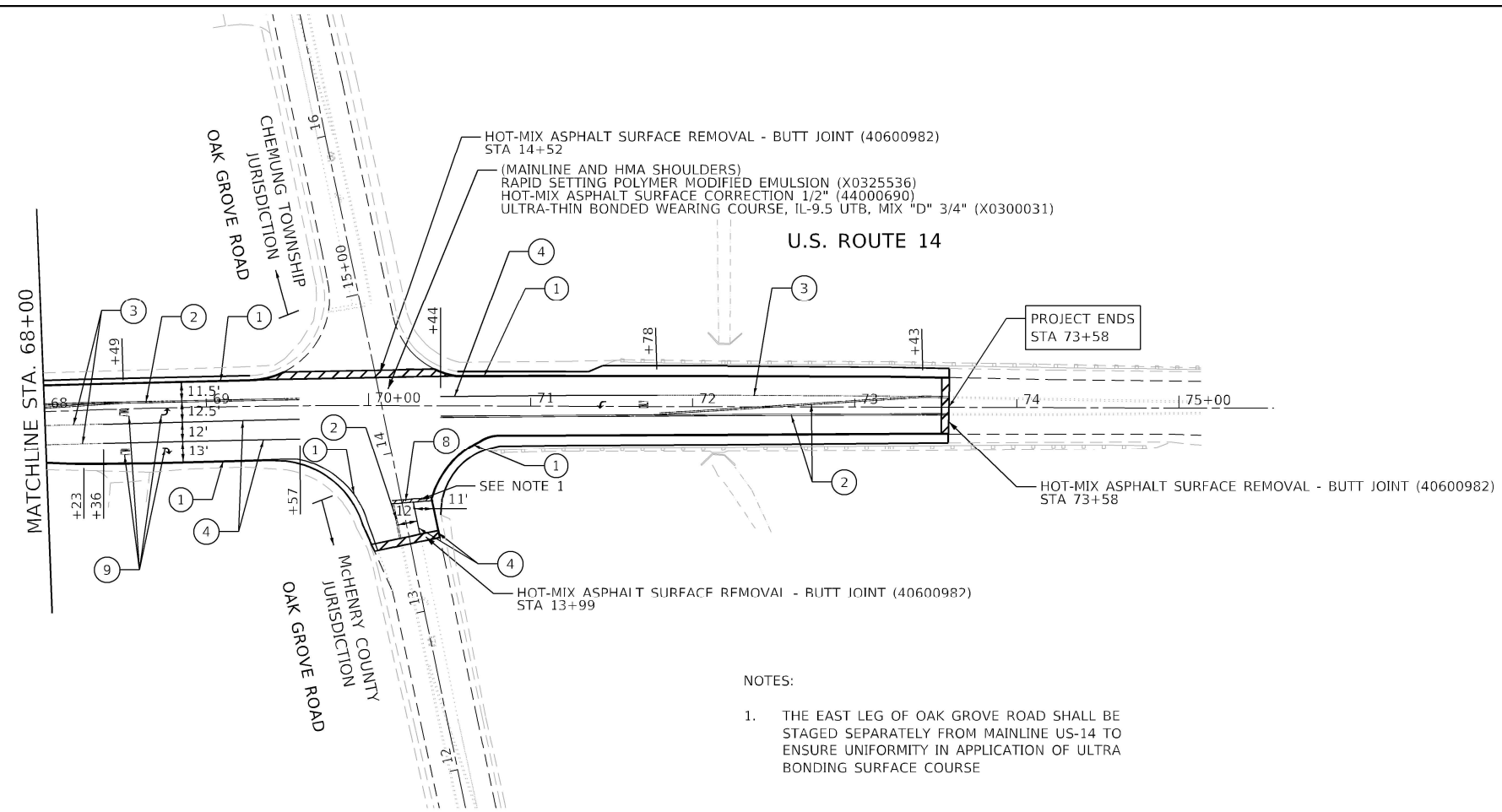

PAVEMENT MARKING LEGEND:

- ① PROPOSED THERMOPLASTIC PAVEMENT MARKING - LINE 4", WHITE SOLID LINE
- ② PROPOSED THERMOPLASTIC PAVEMENT MARKING - LINE 4", DOUBLE YELLOW SOLID LINE
- ③ PROPOSED THERMOPLASTIC PAVEMENT MARKING - LINE 6", WHITE 6' SKIP - 2' DASH
- ④ PROPOSED THERMOPLASTIC PAVEMENT MARKING - LINE 6", WHITE SOLID LINE
- ⑤ PROPOSED THERMOPLASTIC PAVEMENT MARKING - LINE 8", WHITE SOLID LINE
- ⑥ PROPOSED THERMOPLASTIC PAVEMENT MARKING - LINE 12", WHITE SOLID LINE
- ⑦ PROPOSED THERMOPLASTIC PAVEMENT MARKING - LINE 12", YELLOW SOLID LINE
- ⑧ PROPOSED THERMOPLASTIC PAVEMENT MARKING - LINE 24", WHITE SOLID LINE
- ⑨ PROPOSED THERMOPLASTIC PAVEMENT MARKING - LETTERS AND SYMBOLS

NOTES:

1. THE EAST LEG OF OAK GROVE ROAD SHALL BE STAGED SEPARATELY FROM MAINLINE US-14 TO ENSURE UNIFORMITY IN APPLICATION OF ULTRA BONDING SURFACE COURSE

MODEL: Default
 FILE NAME: S:\projects\2015 - IDOT PTB_196\016 - Infrastructure Engineer\Project Work\CADD\CADD Sheets\108621-shr-shr-03.dgn



USER NAME = wleuter	DESIGNED - JJT	REVISED -
	DRAWN - JJT	REVISED -
PLOT SCALE = 100,0000' / in.	CHECKED - SA	REVISED -
PLOT DATE = 8/16/2021	DATE - 8/16/2021	REVISED -

**STATE OF ILLINOIS
DEPARTMENT OF TRANSPORTATION**

**U.S. ROUTE 14 (OAK GROVE RD. TO CROWLEY RD.)
ROADWAY PLAN (SHEET 3 OF 3)**

SCALE: 1"=50' SHEET 3 OF 3 SHEETS STA. 68+00 TO STA. 70+79

F.A.P. RTE.	SECTION	COUNTY	TOTAL SHEETS	SHEET NO.
066	2021-023-RS	MCHENRY	17	8
CONTRACT NO. 62N46			ILLINOIS FED. AID PROJECT	

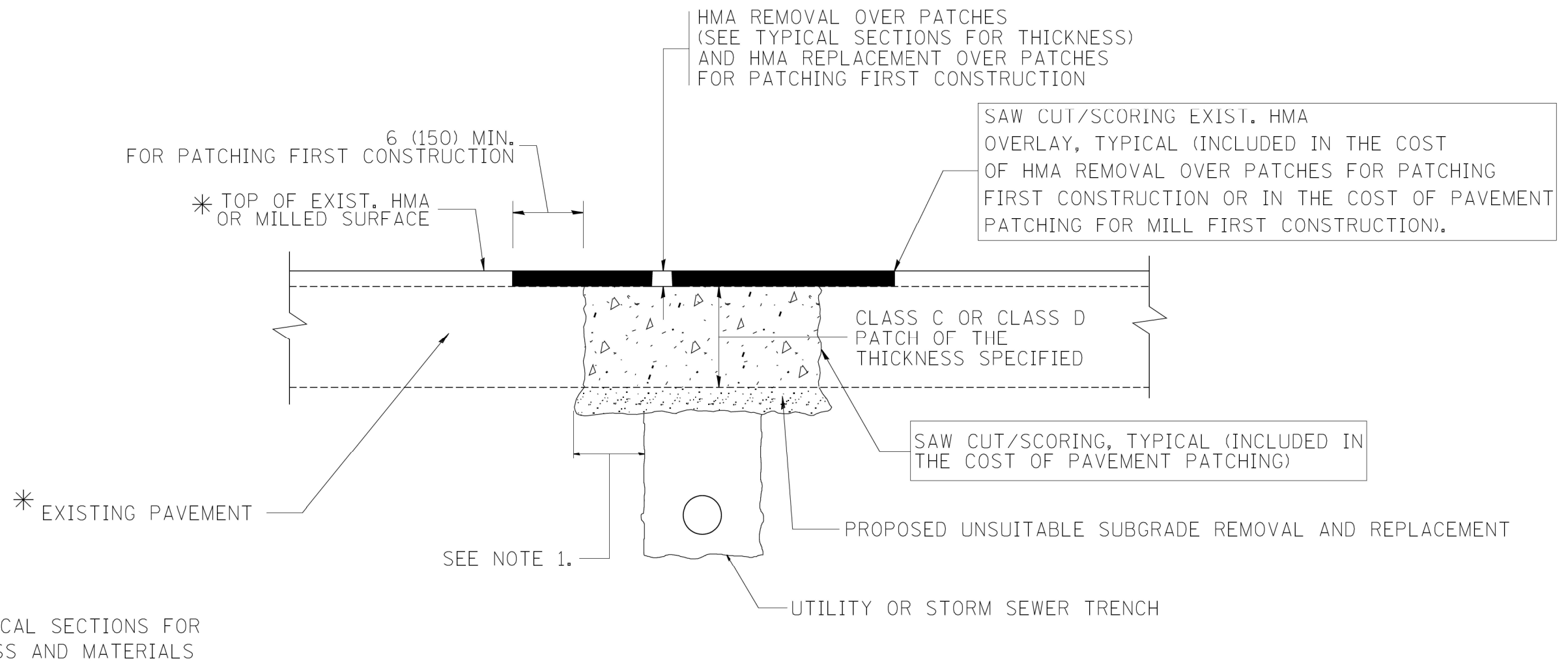

* SEE TYPICAL SECTIONS FOR THICKNESS AND MATERIALS

NOTES:

1. THE WIDTH OF THE FULL DEPTH PATCH OVER A TRENCH SHALL BE 12 (300) WIDER ON EACH SIDE OF THE TRENCH.
2. FOR METHOD OF MEASUREMENT AND BASIS OF PAYMENT, SEE RECURRING SPECIAL PROVISION "PATCHING WITH HOT-MIX ASPHALT OVERLAY REMOVAL".

SEQUENCE OF CONSTRUCTION (PATCHING FIRST)

1. REMOVE THE EXISTING HMA MATERIAL OVER THE AREA TO BE PATCHED.
2. REMOVE AND REPLACE WITH CLASS C OR D PATCH.
3. REPLACE HMA MATERIAL OVER THE AREA TO BE PATCHED.

SEQUENCE OF CONSTRUCTION (MILLING FIRST)

1. MILL HMA FIRST IF THERE IS AT LEAST 4 1/2 INCHES OR MORE OF HMA MATERIAL ON TOP OF THE EXISTING PAVEMENT OR IF THE PAVEMENT IS FULL DEPTH HMA. A MINIMUM OF 2 INCHES OF HMA MATERIAL SHALL BE IN PLACE AFTER MILLING.
2. REMOVE AND REPLACE WITH FULL DEPTH CLASS D PATCHES TO TOP OF MILLED SURFACE.

ALL DIMENSIONS ARE IN INCHES (MILLIMETERS) UNLESS OTHERWISE SHOWN.

MODEL Path: \\... Infrastructure\Engineering\Project\Work\CADD\CADD_Sheets\108621-shc-dtbl\108621.dwg
FILE NAME: 108621.dwg
DATE: 8/16/2021

TranSmart
411 South Wells Street Suite 1000
Chicago, Illinois 60607

USER NAME = wjeuter	DESIGNED - JJI	REVISED -
	DRAWN - JJT	REVISED -
PLOT SCALE = 1.0000' / in.	CHECKED - SA	REVISED -
PLOT DATE = 8/16/2021	DATE - 8/16/2021	REVISED -

**STATE OF ILLINOIS
DEPARTMENT OF TRANSPORTATION**

**PAVEMENT PATCHING FOR
HMA SURFACED PAVEMENT (BD-22)**

SCALE: SHEET OF SHEETS STA. TO STA.

F.A.P. RTE.	SECTION	COUNTY	TOTAL SHEETS	SHEET NO.
066	2021-023-R5	MCHENRY	17	9
			CONTRACT NO. 62N46	
		ILLINOIS	FED. AID PROJECT	

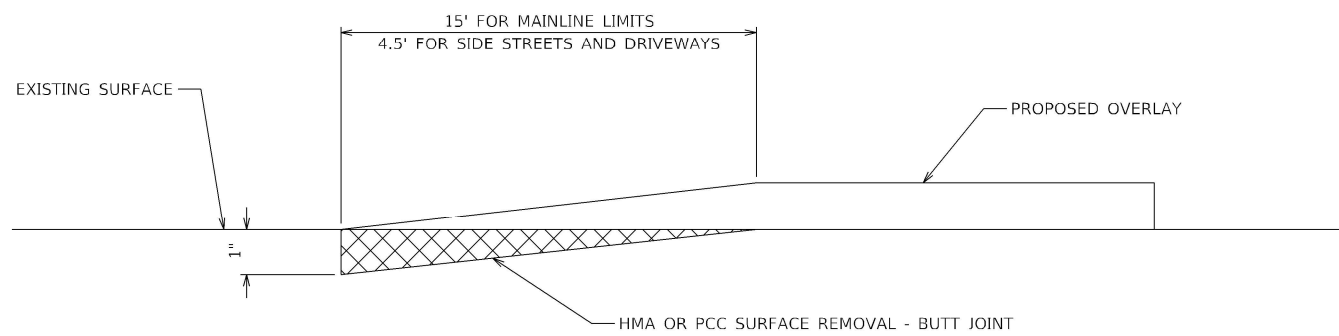

BUTT JOINT TAPER DETAIL

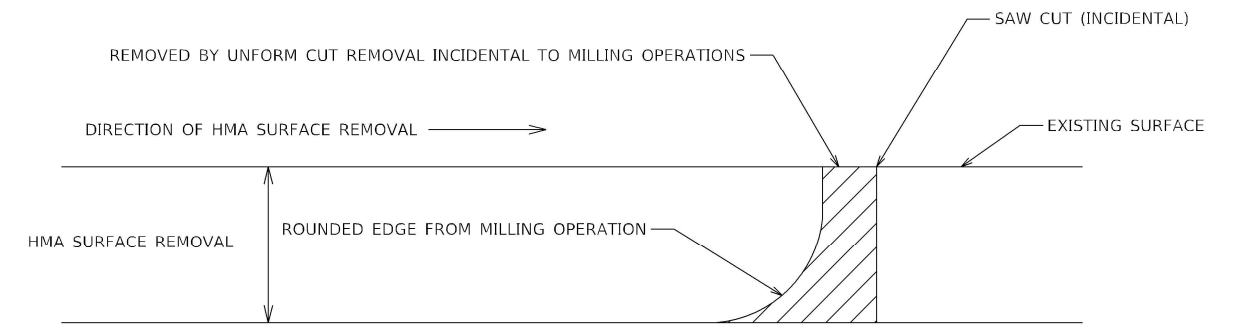

NOTE: WHEN MILLING OPERATION PRODUE A ROUNDED EDGE, THEN SAW CUT SHALL BE USED TO MANUFACTURE A PERPENDICULAR EDGE AS SHOWN IN THE DETAIL. THE NENGINEER SHALL BE THE SOLE JUDGE CONCERNING THE USE OF THIS DETAIL

HMA DETAIL AT BUTT JOINTS

MODEL: Default
FILE NAME: S:\projects\2015 - IDOT PTB - 1964016 - Infrastructure Engineer\Project Work\CADD\CADD Sheets\BD-32-1-shk-ctc-hh\BD32.dwg

TranSmart
411 South Wells Street Suite 1000
Chicago, Illinois 60607

USER NAME = wjeuter	DESIGNED - JJT	REVISED -
	DRAWN - JJT	REVISED -
PLOT SCALE = 1.0000' / in.	CHECKED - SA	REVISED -
PLOT DATE = 8/16/2021	DATE - 8/16/2021	REVISED -

STATE OF ILLINOIS
DEPARTMENT OF TRANSPORTATION

BUTT JOINT AND HMA TAPER DETAILS (BD-32)

SCALE: SHEET OF SHEETS STA. TO STA.

F.A.P. RTE.	SECTION	COUNTY	TOTAL SHEETS	SHEET NO.
066	2021-023-R5	MCHENRY	17	10
CONTRACT NO. 62N46				
ILLINOIS FED. AID PROJECT				

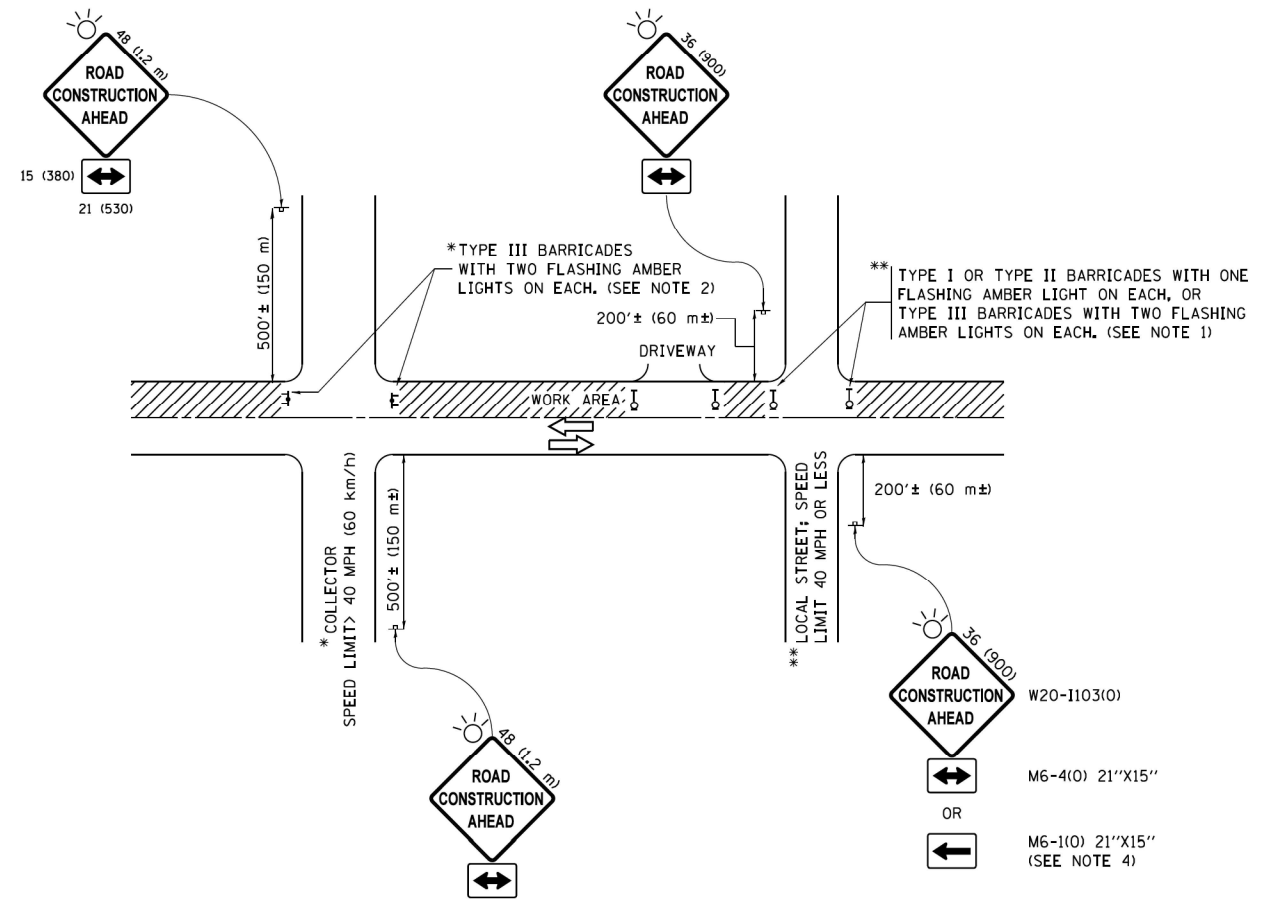

NOTES:

1. SIDE ROAD WITH A SPEED LIMIT OF 40 MPH (60 km/h) OR LESS AS SHOWN ON THE DRAWING AND AS DIRECTED BY THE ENGINEER:
 - a) ONE "ROAD CONSTRUCTION AHEAD" SIGN 36 x 36 (900x900) WITH A FLASHER MOUNTED ON IT APPROXIMATELY 200' (60 m) IN ADVANCE OF THE MAIN ROUTE.
 - b) THE CLOSED PORTION OF THE MAIN ROUTE SHALL BE PROTECTED BY BLOCKING WITH TYPE I, TYPE II OR TYPE III BARRICADES, 1/3 OF THE CROSS SECTION OF THE CLOSED PORTION.
2. SIDE ROAD WITH A SPEED LIMIT GREATER THAN 40 MPH (60 km/h) AS SHOWN ON THE DRAWING AND AS DIRECTED BY THE ENGINEER:
 - a) ONE "ROAD CONSTRUCTION AHEAD" SIGN 48 x 48 (1.2 m x 1.2 m) WITH A FLASHER MOUNTED ON IT APPROXIMATELY 500' (150 m) IN ADVANCE OF THE MAIN ROUTE.
 - b) THE CLOSED PORTION OF THE MAIN ROUTE SHALL BE PROTECTED BY BLOCKING WITH TYPE III BARRICADES, 1/2 OF THE CROSS SECTION OF THE CLOSED PORTION.
3. CONES MAY BE SUBSTITUTED FOR BARRICADES OR DRUMS AT HALF THE SPACING DURING DAY OPERATIONS. CONES SHALL BE A MINIMUM OF 28 (710) IN HEIGHT.
4. WHEN THE SIDE ROAD LIES BETWEEN THE BEGINNING OF THE MAINLINE SIGNING AND THE WORK ZONE, A SINGLE HEADED ARROW (M6-1) SHALL BE USED IN LIEU OF THE DOUBLE HEADED ARROW (M6-4).
5. WHEN WORK IS BEING PERFORMED ON A SIDE ROAD OR DRIVEWAY, FOLLOW THE APPLICABLE STANDARD(S). THE DIRECTIONAL ARROW (M6-1 OR M6-4) SHALL BE COVERED OR REMOVED WHEN NO LONGER CONSISTENT WITH THE TRAFFIC CONTROL SET-UP.
6. ADVANCE WARNING SIGNS ARE TO BE OMITTED ON DRIVEWAYS UNLESS OTHERWISE SPECIFIED IN THE PLANS OR BY THE ENGINEER.
7. THE TRAFFIC CONTROL AND PROTECTION FOR SIDE ROADS, INTERSECTIONS, AND DRIVEWAYS SHALL BE INCLUDED IN THE COST OF SPECIFIED TRAFFIC CONTROL STANDARDS OR ITEMS.

All dimensions are in inches (millimeters) unless otherwise shown.

MODEL Path: \\... Infrastructure - Engineer\Project Work\CADD\CADD Sheets\109821-shc-dtblh-TC10.dgn



USER NAME = wjeuter	DESIGNED - JJJ	REVISED -
	DRAWN - JJT	REVISED -
PLOT SCALE = 1.0000' / in.	CHECKED - SA	REVISED -
PLOT DATE = 8/16/2021	DATE - 8/16/2021	REVISED -

**STATE OF ILLINOIS
DEPARTMENT OF TRANSPORTATION**

**TRAFFIC CONTROL AND PROTECTION FOR
SIDE ROADS, INTERSECTIONS, AND DRIVEWAYS (TC-10)**

F.A.P. RTE.	SECTION	COUNTY	TOTAL SHEETS	SHEET NO.
066	2021-023-R5	MCHENRY	17	11
CONTRACT NO. 62N46				
ILLINOIS FED. AID PROJECT				

SCALE: SHEET OF SHEETS STA. TO STA.

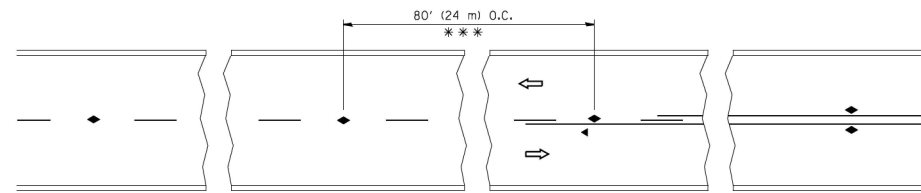

*** REDUCE TO 40' (12 m) O.C. ON CURVES WITH POSTED OR ADVISORY SPEED 45 M.P.H. (70 km/h) OR LESS.

TWO-LANE/TWO-WAY

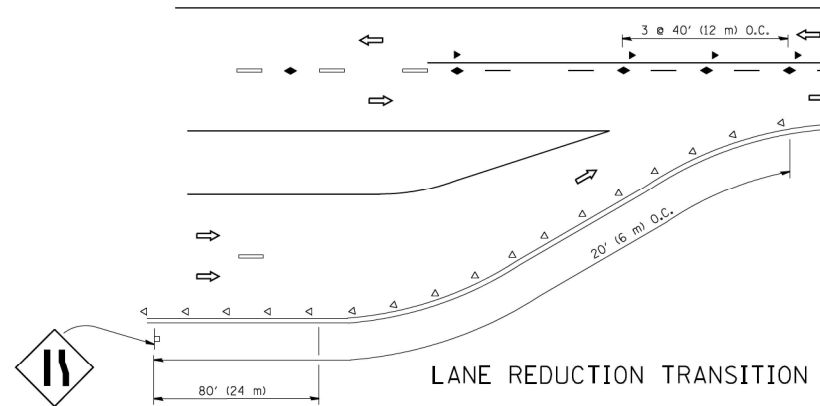

LANE REDUCTION TRANSITION

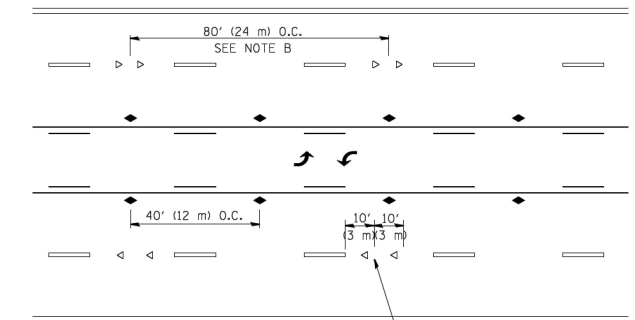

TWO-WAY LEFT TURN

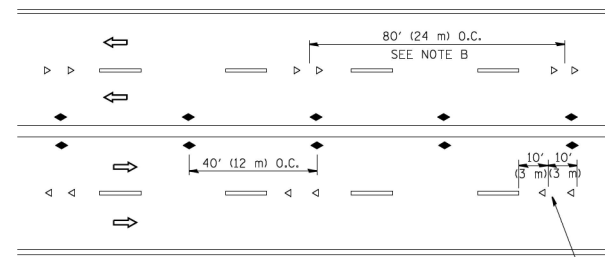

MULTI-LANE/UNDIVIDED

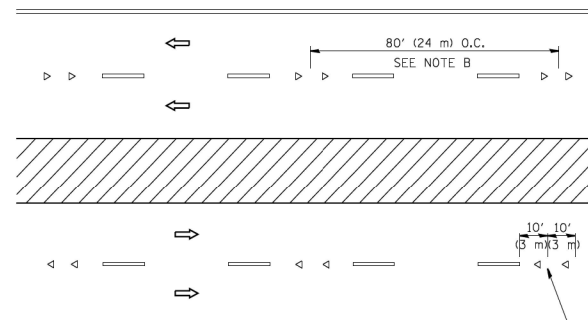

MULTI-LANE/DIVIDED

GENERAL NOTES

1. MARKERS USED WITH DASHED LINES SHALL BE CENTERED IN THE GAP BETWEEN SEGMENTS.
2. MARKERS USED ADJACENT TO SOLID LINES SHALL BE OFFSET 2 TO 3 (50 TO 75) TOWARD TRAFFIC AS SHOWN.
3. MARKERS THROUGH TANGENTS LESS THAN 500' (150 m) IN LENGTH BETWEEN CURVES SHALL BE INSTALLED AT THE LESSER OF THE TWO CURVE SPACINGS.

SYMBOLS

- YELLOW STRIPE
- WHITE STRIPE
- ◀ ONE-WAY AMBER MARKER
- ◁ ONE-WAY CRYSTAL MARKER (W/O)
- ◆ TWO-WAY AMBER MARKER

LANE MARKER NOTES

- A. USE DOUBLE LANE LINE MARKERS SPACED AS SHOWN.
- B. REDUCE TO 40' (12 m) O.C. ON CURVES WHERE ADVISORY SPEEDS ARE 10 M.P.H (20 km/h) LOWER THAN POSTED SPEEDS.

DESIGN NOTES

1. DOUBLE LANE LINE MARKERS SHALL BE USED UNLESS SPECIFIED OTHERWISE.
2. EXCEPT AS SHOWN ON THE LANE REDUCTION TRANSITION AND FREEWAY EXIT RAMP DETAIL, MARKERS ARE NOT TO BE SPECIFIED ON RIGHT EDGE LINES.
3. THE EXACT MARKER LIMITS, SPACING, AND COLOR SHALL BE INCLUDED IN THE PLANS WHEN STANDARD SPECIFICATIONS ARE NOT BEING USED.
4. MARKERS SHOULD NOT BE USED ALONGSIDE CURBS EXCEPT FOR EXTREMELY SHORT SECTIONS OF CURBS WHERE NOT MORE THAN TWO MARKERS WOULD BE INVOLVED.

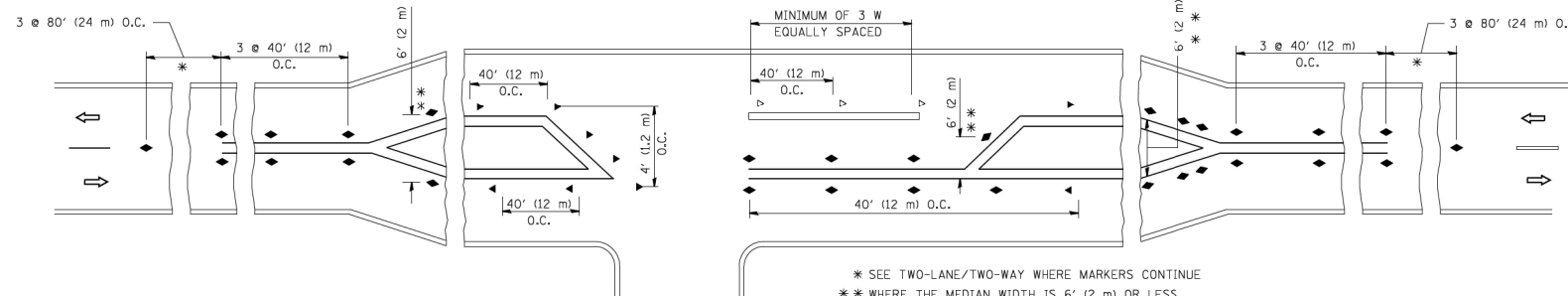

LEFT TURN

* SEE TWO-LANE/TWO-WAY WHERE MARKERS CONTINUE
 ** WHERE THE MEDIAN WIDTH IS 6' (2 m) OR LESS USE TWO-WAY MARKERS.

All dimensions are in inches (millimeters) unless otherwise shown.

MODEL Path: \\s01\projects\2015 - IDOT PTB - Infrastructure\Engineering\Project Work\CADD\CADD Sheets\108621-shc\det\ah\TC11.dgn
 FILE NAME: S:\projects\2015 - IDOT PTB - Infrastructure\Engineering\Project Work\CADD\CADD Sheets\108621-shc\det\ah\TC11.dgn

USER NAME = videuter	DESIGNED - JJJ	REVISED -
	DRAWN - JJT	REVISED -
PLOT SCALE = 1:1000' / in.	CHECKED - SA	REVISED -
PLOT DATE = 8/16/2021	DATE - 8/16/2021	REVISED -

F.A.P. RTE.	SECTION	COUNTY	TOTAL SHEETS	SHEET NO.
066	2021-023-R5	MCHENRY	17	12
CONTRACT NO. 62N46				
ILLINOIS		FED. AID PROJECT		

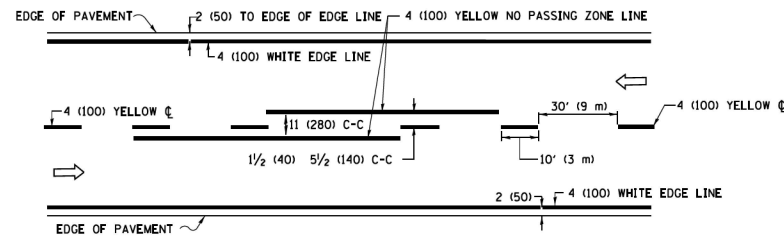

2-LANE ROADWAY

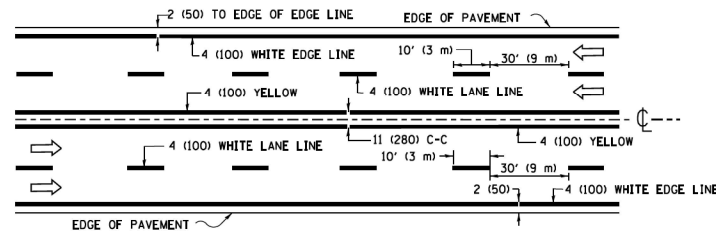

MULTI-LANE UNDIVIDED

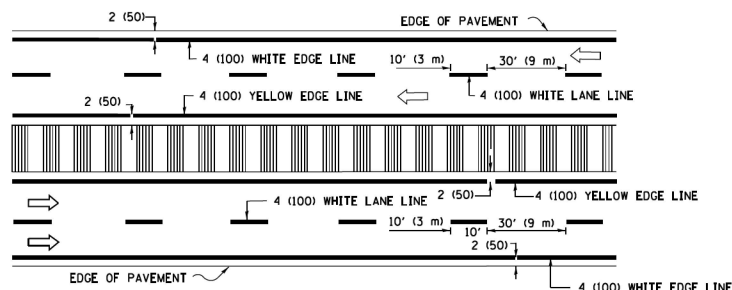

MULTI-LANE DIVIDED WITH MEDIAN

TYPICAL LANE AND EDGE LINE MARKING

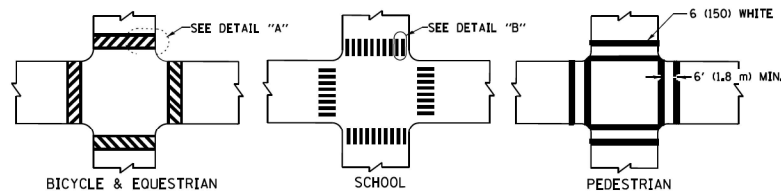

DETAIL "A"

DETAIL "B"

TYPICAL CROSSWALK MARKING

* MARKINGS SHALL BE INSTALLED PARALLEL TO THE CENTERLINE OF THE ROAD WHICH IT CROSSES

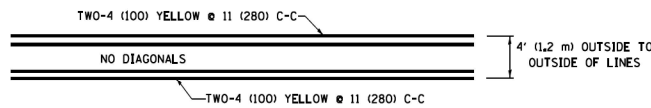

4' (1.2 m) WIDE MEDIANS ONLY

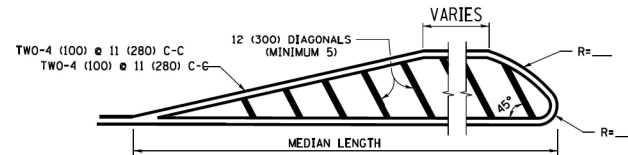

MEDIANS OVER 4' (1.2 m) WIDE

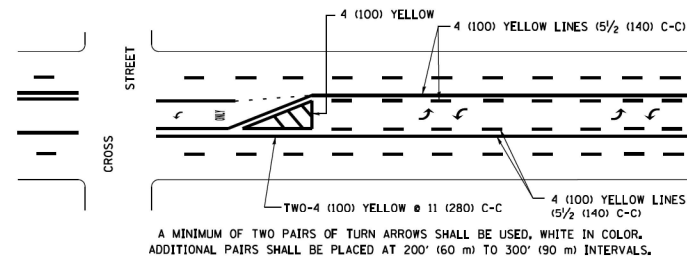

MEDIAN WITH TWO-WAY LEFT TURN LANE

TYPICAL PAINTED MEDIAN MARKING

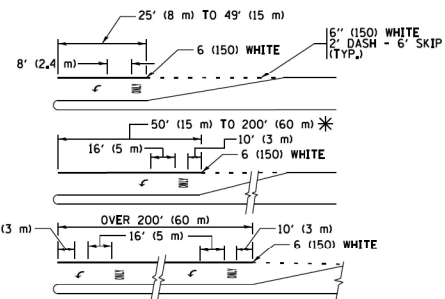

TYPICAL LEFT (OR RIGHT) TURN LANE

TYPICAL TURN LANE MARKING

FULL SIZE LETTERS 8' (2.4 m) AND ARROWS SHALL BE USED.
 AREA = 15.6 SQ. FT. (1.5 m²) AREA = 20.8 SQ. FT. (1.9 m²)
 * TURN LANES IN EXCESS OF 400' (120 m) IN LENGTH MAY HAVE AN ADDITIONAL SET OF ARROW - "ONLY" INSTALLED MIDWAY BETWEEN THE OTHER TWO SETS OF ARROW - "ONLY".

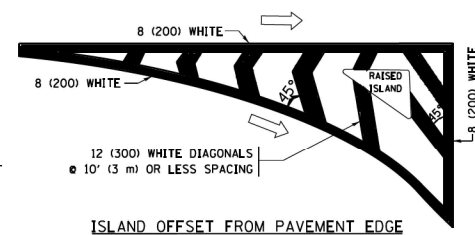

ISLAND OFFSET FROM PAVEMENT EDGE

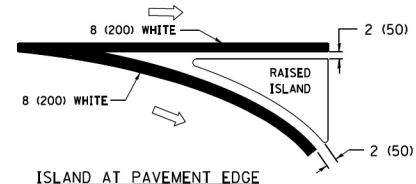

ISLAND AT PAVEMENT EDGE

TYPICAL ISLAND MARKING

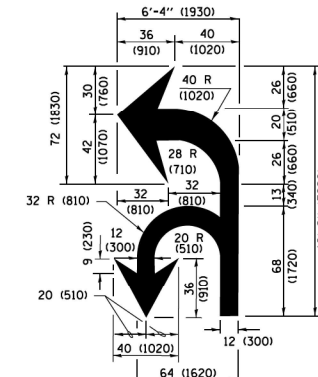

COMBINATION LEFT AND U-TURN

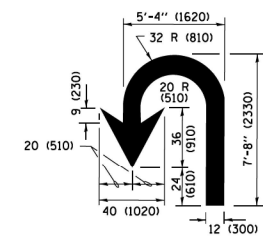

U-TURN

D(FT)	SPEED LIMIT
345	30
425	35
500	40
580	45
665	50
750	55

LANE REDUCTION TRANSITION

* LANE REDUCTION ARROWS REQUIRED AT SPEEDS OF 45 MPH OR GREATER OR WHEN SPECIFIED IN PLANS.

TYPE OF MARKING	WIDTH OF LINE	PATTERN	COLOR	SPACING /REMARKS
CENTERLINE ON 2 LANE PAVEMENT	4 (100)	SKIP-DASH	YELLOW	10' (3 m) LINE WITH 30' (9 m) SPACE
CENTERLINE ON MULTI-LANE UNDIVIDED PAVEMENT	2 @ 4 (100)	SOLID	YELLOW	11 (280) C-C
NO PASSING ZONE LINES FOR ONE DIRECTION	4 (100)	SOLID	YELLOW	5 1/2 (140) C-C FROM SKIP-DASH CENTERLINE
NO PASSING ZONE LINES FOR BOTH DIRECTIONS	2 @ 4 (100)	SOLID	YELLOW	11 (280) C-C OMIT SKIP-DASH CENTERLINE BETWEEN
LANE LINES	4 (100) 5 (125) ON FREEWAYS	SKIP-DASH SKIP-DASH	WHITE WHITE	10' (3 m) LINE WITH 30' (9 m) SPACE
DOTTED LINES (EXTENSIONS OF CENTER, LANE OR TURN LANE MARKINGS)	SAME AS LINE BEING EXTENDED	SKIP-DASH	SAME AS LINE BEING EXTENDED	2' (600) LINE WITH 6' (1.8 m) SPACE
EDGE LINES	4 (100)	SOLID	YELLOW-LEFT WHITE-RIGHT	OUTLINE MEDIANS IN YELLOW
TURN LANE MARKINGS	6 (150) LINE; FULL SIZE LETTERS & SYMBOLS (8' (2.4m))	SOLID	WHITE	SEE TYPICAL TURN LANE MARKING DETAIL
TWO WAY LEFT TURN MARKING	2 @ 4 (100) EACH DIRECTION 8' (2.4m) LEFT ARROW	SKIP-DASH AND SOLID IN PAIRS	YELLOW WHITE	10' (3 m) LINE WITH 30' (9 m) SPACE FOR SKIP-DASH; 5 1/2 (140) C-C BETWEEN SOLID LINE AND SKIP-DASH LINE SEE TYPICAL TWO-WAY LEFT TURN MARKING DETAIL
CROSSWALK LINES (PEDESTRIAN) A. DIAGONALS (BIKE & EQUESTRIAN) B. LONGITUDINAL BARS (SCHOOL)	2 @ 6 (150) 12 (300) @ 45° 12 (300) @ 90°	SOLID SOLID SOLID	WHITE WHITE WHITE	NOT LESS THAN 6' (1.8 m) APART 2' (600) APART SEE TYPICAL CROSSWALK MARKING DETAILS.
STOP LINES	24 (600)	SOLID	WHITE	PLACE 4' (1.2 m) IN ADVANCE OF AND PARALLEL TO CROSSWALK, IF PRESENT. OTHERWISE, PLACE AT DESIRED STOPPING POINT. PARALLEL TO CROSSWALK CENTERLINE, WHERE POSSIBLE
PAINTED MEDIANS	2 @ 4 (100) WITH 12 (300) DIAGONALS @ 45° NO DIAGONALS USED FOR 4' (1.2 m) WIDE MEDIANS	SOLID	YELLOW TWO WAY TRAFFIC WHITE ONE WAY TRAFFIC	11 (280) C-C FOR THE DOUBLE LINE SEE TYPICAL PAINTED MEDIAN MARKING.
GORE MARKING AND CHANNELIZING LINES	8 (200) WITH 12 (300) DIAGONALS @ 45°	SOLID	WHITE	DIAGONALS: 15' (4.5 m) C-C (LESS THAN 30MPH (50 km/h)) 20' (6 m) C-C (30MPH (50 km/h) TO 45MPH (70 km/h)) 30' (9 m) C-C (OVER 45MPH (70 km/h))
RAILROAD CROSSING	24 (600) TRANSVERSE LINES; "RR" IS 6' (1.8 m) LETTERS; 16 (400) LINE FOR "X"	SOLID	WHITE	SEE STATE STANDARD 780001 AREA OF: "R"=3.6 SQ. FT. (0.33 m ²) EACH "X"=54.0 SQ. FT. (5.0 m ²)
SHOULDER DIAGONALS (REQUIRED FOR SHOULDERS ≥ 8')	12 (300) @ 45°	SOLID	WHITE - RIGHT YELLOW - LEFT	50' (15 m) C-C (LESS THAN 30MPH (50 km/h)) 75' (25 m) C-C (30 MPH (50 km/h) TO 45MPH (70 km/h)) 150' (45 m) C-C (OVER 45MPH (70 km/h))
U TURN ARROW	SEE DETAIL	SOLID	WHITE	16.3 SF
2 ARROW COMBINATION LEFT AND U TURN	SEE DETAIL	SOLID	WHITE	30.4 SF

FOR FURTHER DETAILS ON PAVEMENT MARKING REFER TO STANDARD SPECIFICATIONS FOR ROAD AND BRIDGE CONSTRUCTION AND STATE STANDARD 780001.

All dimensions are in inches (millimeters) unless otherwise shown.

MODEL Path: \\idot\p1b\196-316 - Infrastructure\Engineering\Project Work\CADD\CADD Sheets\0108621-shk-detai-TC13.dgn
 FILE NAME: S:\projects\2015 - IDOT P1B - Infrastructure\Engineering\Project Work\CADD\CADD Sheets\0108621-shk-detai-TC13.dgn

TranSmart
 411 South Wells Street Suite 1000
 Chicago, Illinois 60607

USER NAME = wbeuter	DESIGNED - JJI	REVISED -
PLOT SCALE = 1:0000' / in.	DRAWN - JJT	REVISED -
PLOT DATE = 8/16/2021	CHECKED - SA	REVISED -
	DATE - 8/16/2021	REVISED -

**STATE OF ILLINOIS
 DEPARTMENT OF TRANSPORTATION**

**DISTRICT ONE
 TYPICAL PAVEMENT MARKINGS (TC-13)**

SCALE: SHEET OF SHEETS STA. TO STA.

F.A.P. RTE.	SECTION	COUNTY	TOTAL SHEETS	SHEET NO.
066	2021-023-R5	MCHENRY	17	13
CONTRACT NO. 62N46			ILLINOIS FED. AID PROJECT	

TURN BAY ENTRANCE AT START OF LANE CLOSURE TAPER

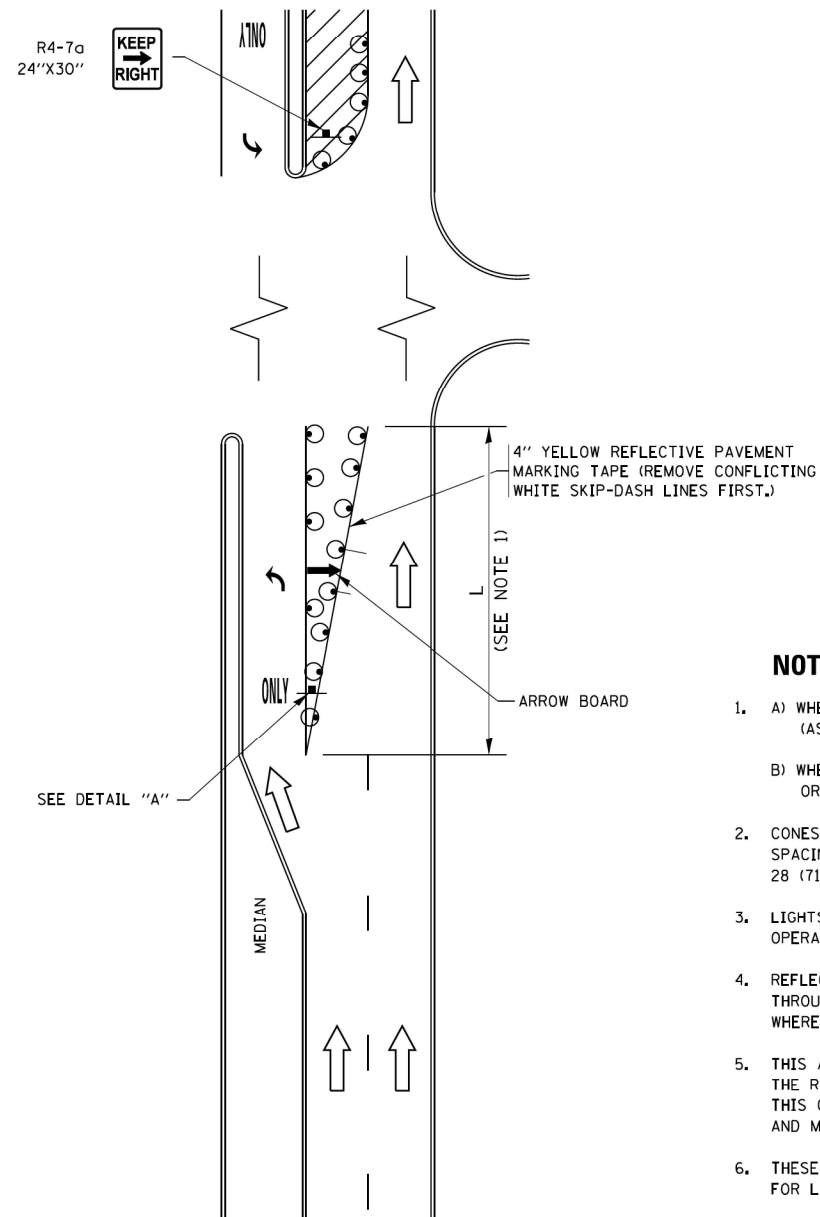

FIGURE 1

TURN BAY ENTRANCE WITHIN A LANE CLOSURE

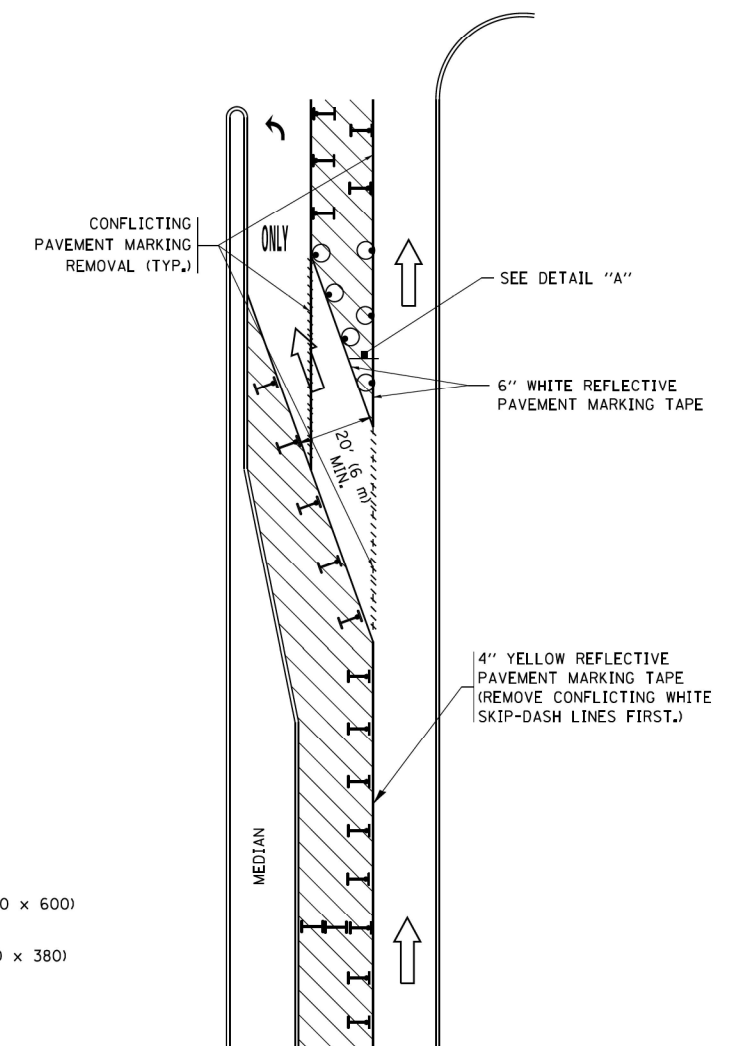
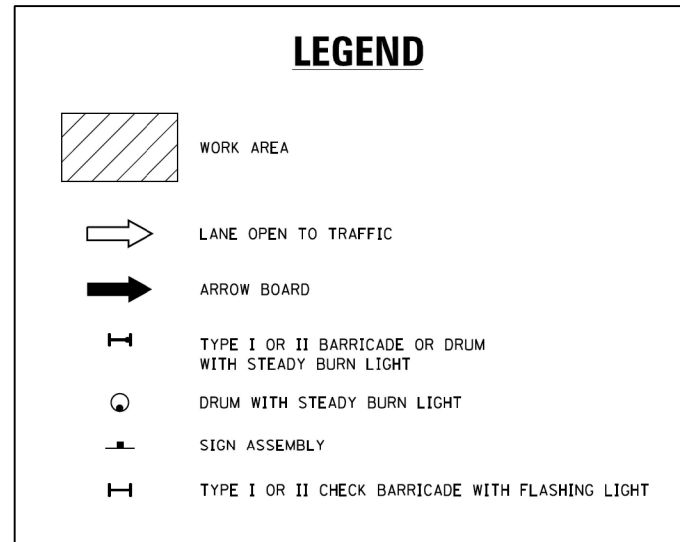
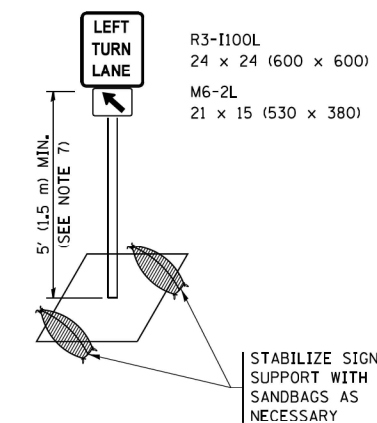

FIGURE 2



NOTES:

- A) WHEN "L" IS \leq THE STORAGE LENGTH OF THE TURN LANE (AS SHOWN IN FIG. 1), USE FIGURE 1.
- B) WHEN "L" IS $>$ THE STORAGE LENGTH OF THE TURN LANE OR THE TURN LANE IS WITHIN THE LANE CLOSURE, USE FIGURE 2.
- CONES MAY BE SUBSTITUTED FOR BARRICADES OR DRUMS AT HALF THE SPACING DURING DAY OPERATIONS. CONES SHALL BE A MINIMUM OF 28 (710) IN HEIGHT.
- LIGHTS WILL NOT BE REQUIRED ON BARRICADES OR DRUMS FOR DAY OPERATIONS. ALL LIGHTS SHALL BE MONODIRECTIONAL.
- REFLECTIVE TEMPORARY PAVEMENT MARKINGS SHALL BE PLACED THROUGHOUT THE BARRICADED AREAS OF EACH TURN BAY AS SHOWN WHERE THE CLOSURE TIME IS GREATER THAN FOURTEEN (14) DAYS.
- THIS APPLICATION ALSO APPLIES WHEN WORK IS BEING PERFORMED IN THE RIGHT LANE(S) AND THE RIGHT TURN BAY IS TO REMAIN OPEN. UNDER THIS CONDITION, "RIGHT TURN LANE" R3-I100R 24 x 24 (600 x 600) AND M6-2R 21 x 15 (530 x 380) SHALL BE USED.
- THESE CONTROLS SHALL SUPPLEMENT MAINLINE TRAFFIC CONTROL FOR LANE CLOSURES.
- THE SIGNS SHALL BE MOUNTED ABOVE THE BARRICADES/DRUMS ON SEPARATE SIGN SUPPORTS THAT MEET NCHRP 350 OR MASH PREQUIREMENTS.
- TRAFFIC CONTROL AND PROTECTION AT TURN BAYS (TO REMAIN OPEN TO TRAFFIC) SHALL BE INCLUDED IN THE COST OF SPECIFIED TRAFFIC CONTROL STANDARDS OR ITEMS.



DETAIL A

All dimensions are in inches (millimeters) unless otherwise shown.

MODEL Path: \\... Infrastructure: Engineer\Project Work\CADD\CADD Sheets\108621-shc-detail-TC14.dgn
FILE NAME: S:\projects\2015 - IDOT PTB 196-316 - Infrastructure: Engineer\Project Work\CADD\CADD Sheets\108621-shc-detail-TC14.dgn

TranSmart
411 South Wells Street Suite 1000
Chicago, Illinois 60607

USER NAME = wjeuter	DESIGNED - JJI	REVISED -
PLOT SCALE = 1.0000' / in.	DRAWN - JJT	REVISED -
PLOT DATE = 8/16/2021	CHECKED - SA	REVISED -
	DATE - 8/16/2021	REVISED -

**STATE OF ILLINOIS
DEPARTMENT OF TRANSPORTATION**

**TRAFFIC CONTROL AND PROTECTION AT TURN BAYS
(TO REMAIN OPEN TO TRAFFIC) (TC-14)**

SCALE: SHEET OF SHEETS STA. TO STA.

F.A.P. RTE.	SECTION	COUNTY	TOTAL SHEETS	SHEET NO.
066	2021-023-R5	MCHENRY	17	14
			CONTRACT NO. 62N46	
		ILLINOIS	FED. AID PROJECT	

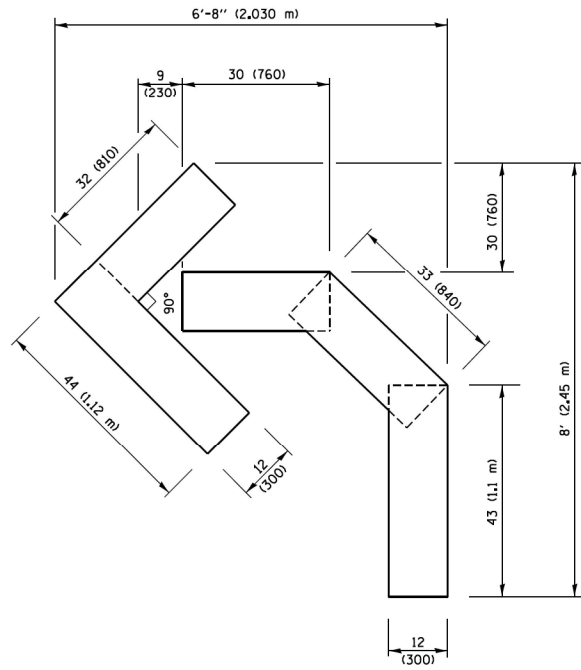

QUANTITY

4 (100) LINE = 45.5 ft. (13.9 m)
15.2 sq. ft. (1.41 sq. m)

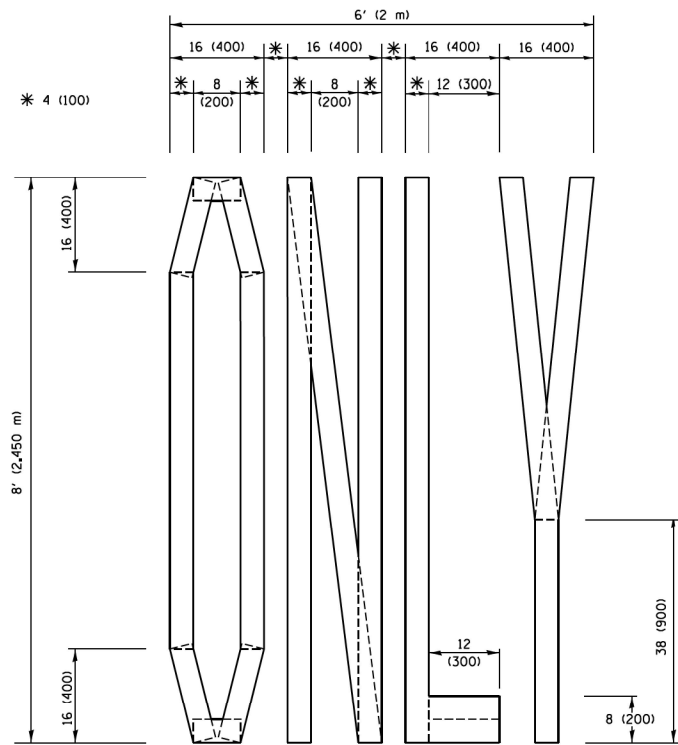

QUANTITY

4 (100) LINE = 64.1 ft. (19.5 m)
21.4 sq. ft. (1.99 sq. m)

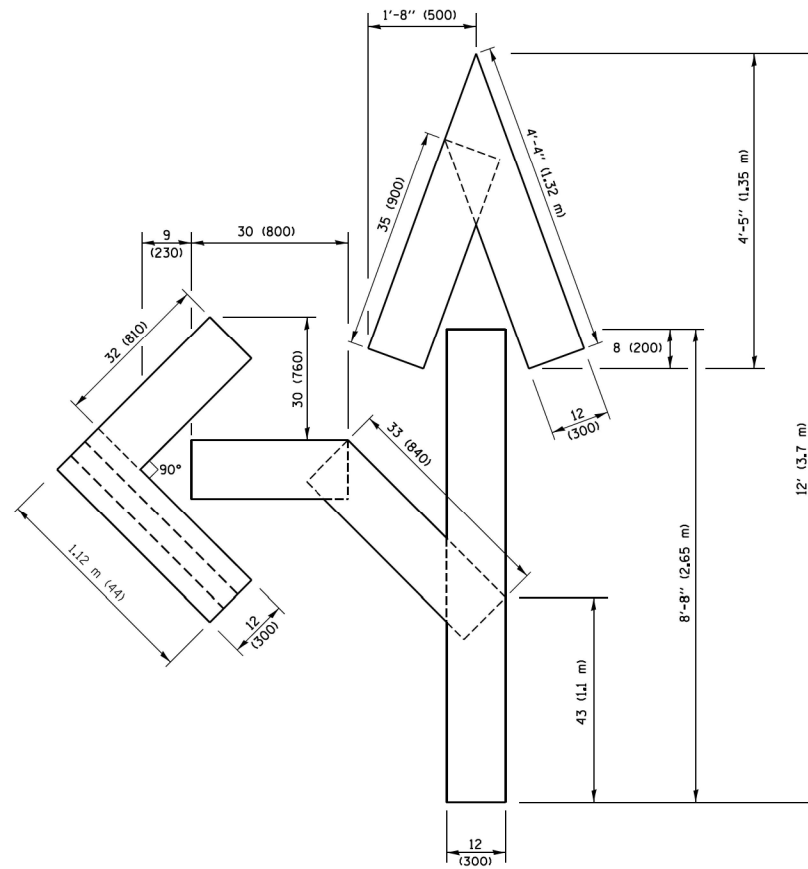

QUANTITY

4 (100) LINE = 82.5 ft. (25.1 m)
27.5 sq. ft. (2.53 sq. m)

NOTE:

ALL QUANTITIES OF PLACEMENT ARE REPRESENTED IN LINEAR FEET OF 4" LINES TO MATCH THE 4" TEMPORARY TAPE PAY ITEM AND REPRESENTS THE TOTAL QUANTITY OF 4" TAPE REQUIRED.

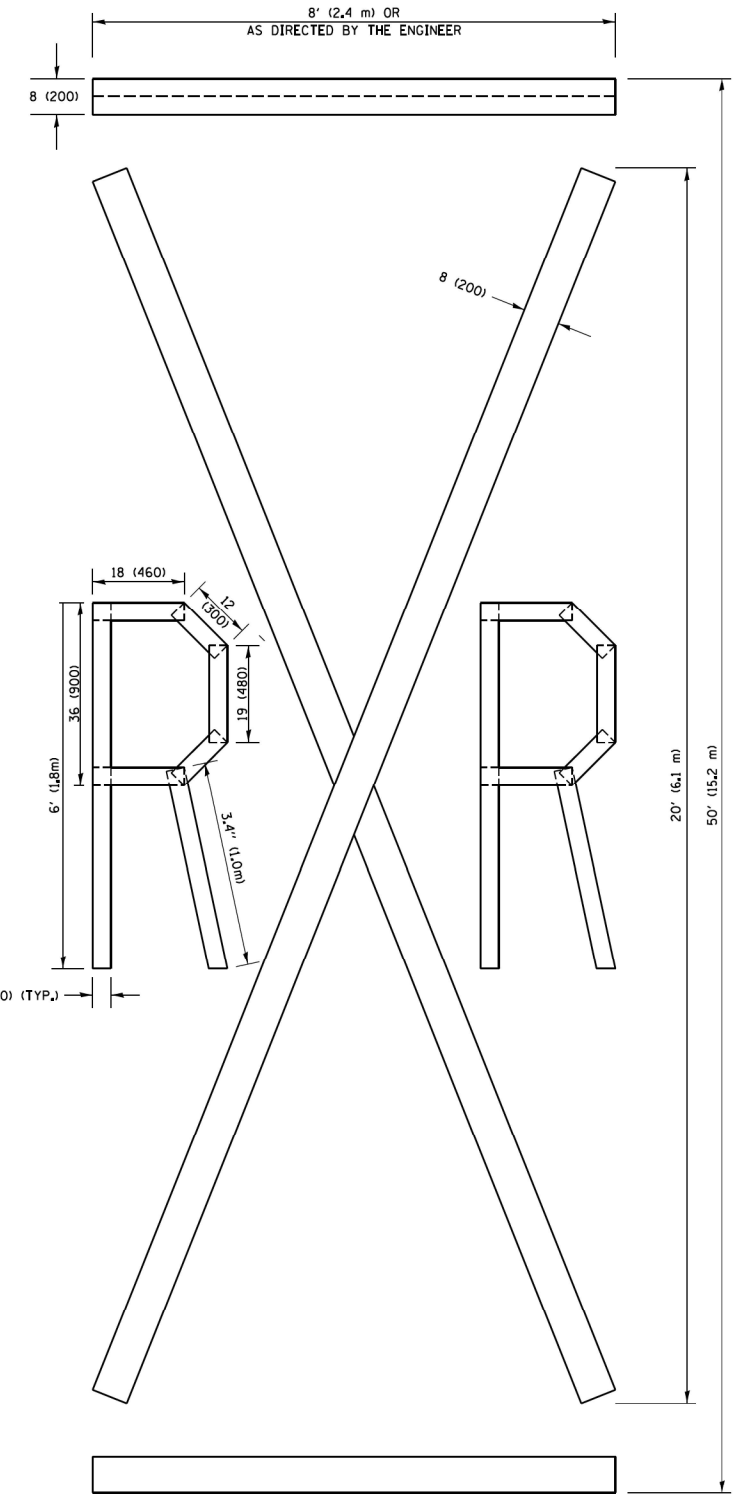

QUANTITY

4 (100) LINE = 225.9 ft. (68.9 m)
75.3 sq. ft. (6.99 sq. m)

All dimensions are in inches (millimeters) unless otherwise shown.

MODEL Path: \\... Infrastructure: Engineer\Project Work\CADD\CADD Sheets\108621-shc-detai-TC16.dgn
FILE NAME: S:\projects\2015 - IDOT PTB 196-316 - Infrastructure: Engineer\Project Work\CADD\CADD Sheets\108621-shc-detai-TC16.dgn



USER NAME = wjeuter	DESIGNED - JJI	REVISED -
PLOT SCALE = 1.0000' / in.	DRAWN - JJT	REVISED -
PLOT DATE = 8/16/2021	CHECKED - SA	REVISED -
	DATE - 8/16/2021	REVISED -

**STATE OF ILLINOIS
DEPARTMENT OF TRANSPORTATION**

**SHORT TERM PAVEMENT MARKING
LETTERS AND SYMBOLS (TC-16)**

SCALE: SHEET OF SHEETS STA. TO STA.

F.A.P. RTE.	SECTION	COUNTY	TOTAL SHEETS	SHEET NO.
066	2021-023-RS	MCHENRY	17	15
CONTRACT NO. 62N46			ILLINOIS FED. AID PROJECT	

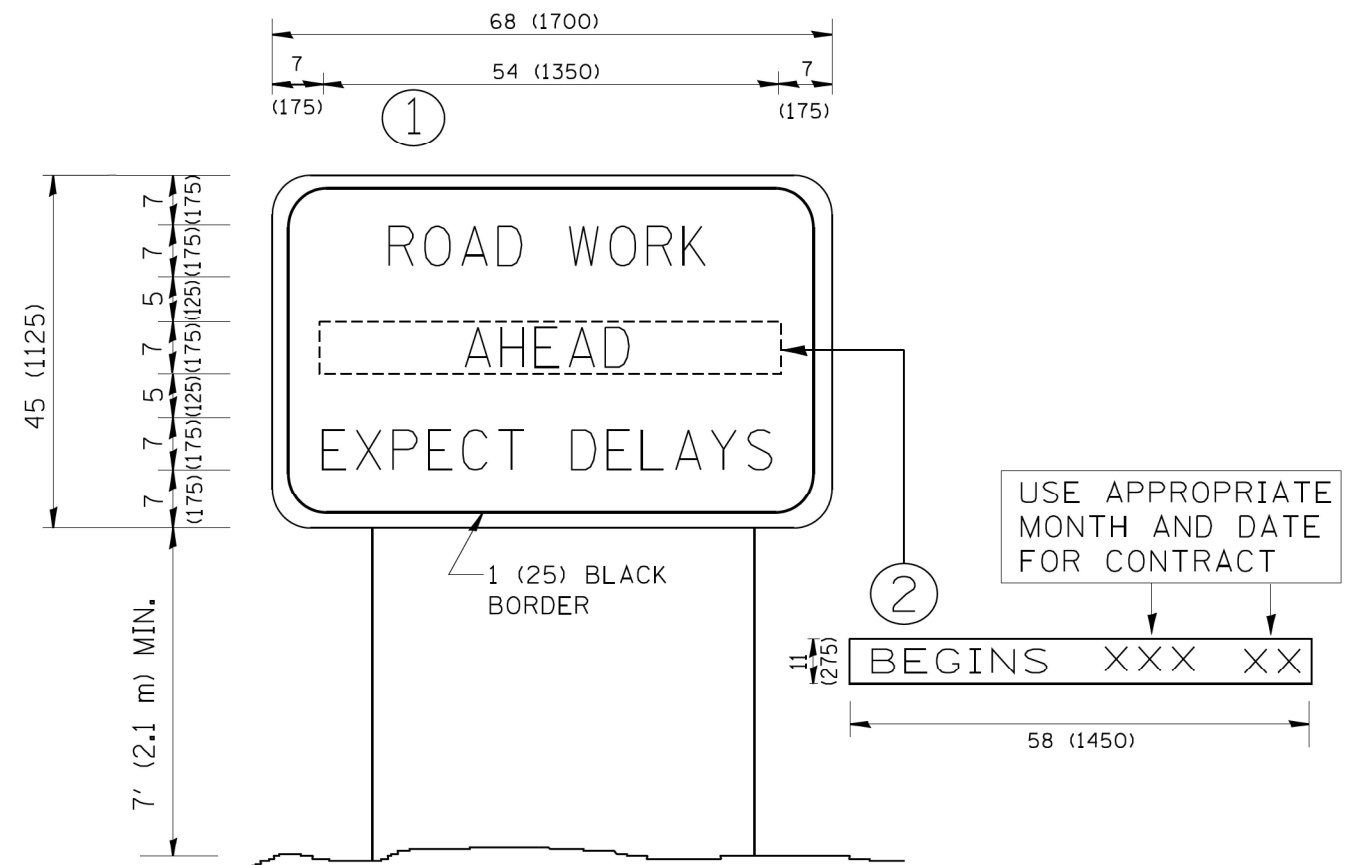

NOTES:

1. USE BLACK LETTERING ON ORANGE BACKGROUND.
2. ERECT SIGNS IN ADVANCE OF THE LOCATION FOR THE "ROAD CONSTRUCTION AHEAD" SIGN AT LOCATIONS AS DIRECTED BY THE ENGINEER.
3. ERECT SIGN ① WITH INSTALLED PANEL ② ONE WEEK PRIOR TO THE START OF CONSTRUCTION.
4. REMOVE PANEL ② SOON AFTER THE START OF CONSTRUCTION.
5. SEE SPECIAL PROVISION FOR "TEMPORARY INFORMATION SIGNING" FOR ADDITIONAL INFORMATION.
6. ONE SIGN ASSEMBLY EQUALS 25.70 SQ. FT. (2.3 SQ. M.)
7. SHALL BE PAID FOR AS TEMPORARY INFORMATION SIGNING.

ALL DIMENSIONS ARE IN INCHES (MILLIMETERS) UNLESS OTHERWISE SHOWN.

MODEL: P:\6416... INFRASTRUCTURE: Engineer\Project Work\CADD\CADD_Sheets\0108621-shc-dtblh-TC22.dgn



USER NAME = wjeuter	DESIGNED - JJI	REVISED -
	DRAWN - JJT	REVISED -
PLOT SCALE = 1.0000' / in.	CHECKED - SA	REVISED -
PLOT DATE = 8/16/2021	DATE - 8/16/2021	REVISED -

**STATE OF ILLINOIS
DEPARTMENT OF TRANSPORTATION**

ARTERIAL ROAD INFORMATION SIGN (TC-22)			
SCALE:	SHEET	OF SHEETS	STA. TO STA.

F.A.P. RTE.	SECTION	COUNTY	TOTAL SHEETS	SHEET NO.
066	2021-023-R5	MCHENRY	17	16
CONTRACT NO. 62N46			ILLINOIS FED. AID PROJECT	

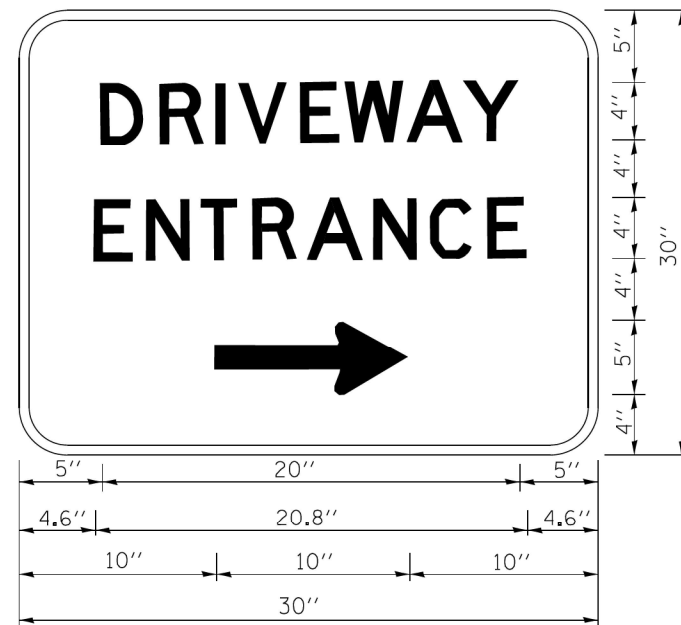

3.0" RADIUS, 0.5" BORDER, WHITE ON GREEN; REFLECTORIZED
 "DRIVEWAY" D; "ENTRANCE" D; STANDARD ARROW CUSTOM 12.0" x 5.0"

NOTES:

1. HALF OF THE SIGNS WILL REQUIRE A LEFT HAND FACING ARROW.
2. TWO SIGNS SHALL BE USED AT EACH COMMERCIAL ENTRANCE PLACED BACK-TO-BACK; ONE WITH A RIGHT HAND ARROW (SHOWN) SHALL BE PLACED ON THE NEAR RIGHT SIDE THE DRIVEWAY AND ONE WITH A LEFT HAND ARROW SHALL BE PLACED ON THE FAR LEFT SIDE OF THE DRIVEWAY.
3. SIGNS TO BE PAID FOR AS ITEM "TEMPORARY INFORMATION SIGNING".

MODEL Path: \\s01063032015 - IDOT_PTB_196-316 - Infrastructure_Engineer\Project_Work\CADD\CADD_Sheets\108631-shc\shc\shc\TC26.dgn
 FILE NAME: S:\0863032015 - IDOT_PTB_196-316 - Infrastructure_Engineer\Project_Work\CADD\CADD_Sheets\108631-shc\shc\shc\TC26.dgn

USER NAME = wjeuter	DESIGNED - JJJ	REVISED -
	DRAWN - JJT	REVISED -
PLOT SCALE = 1.0000' / in.	CHECKED - SA	REVISED -
PLOT DATE = 8/16/2021	DATE - 8/16/2021	REVISED -

F.A.P. RTE.	SECTION	COUNTY	TOTAL SHEETS	SHEET NO.
066	2021-023-R5	MCHENRY	17	17
CONTRACT NO. 62N46				
ILLINOIS		FED. AID PROJECT		