

STATE OF ILLINOIS
DEPARTMENT OF PUBLIC WORKS & BUILDINGS
DIVISION OF HIGHWAYS

ROUTE NO.	SECTION	COUNTY	TOTAL SHEETS	SHEET NO.
S. B. I. 1	12VR2B	WABASH	19	11
SHEET NO. 1 9 SHEETS				

B. M. N.H. Cor. N. End Conc. Base of Gas Pump 30'-0" x 4'-5" x 2'-4" E.L. 444.15
Existing Structure: Conc. Deck on Conc. Substructure. 141'-6" Bl. to Bl. 5 Spans
18'-0" Rdwy. Plus 2 Sidewalks @ 3'-6" with Pipe Rail.
Bridge shall be removed and disposed of by the Bridge Contractor

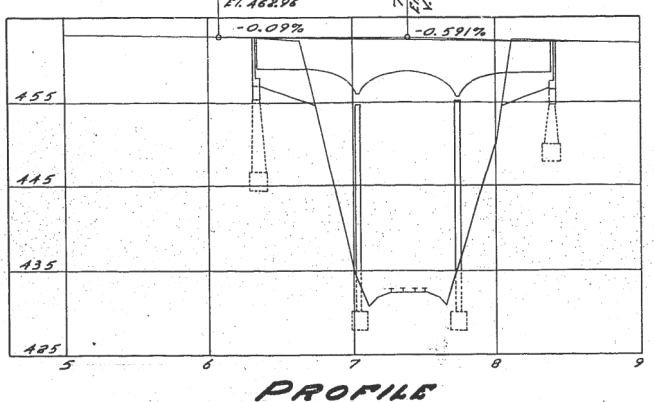
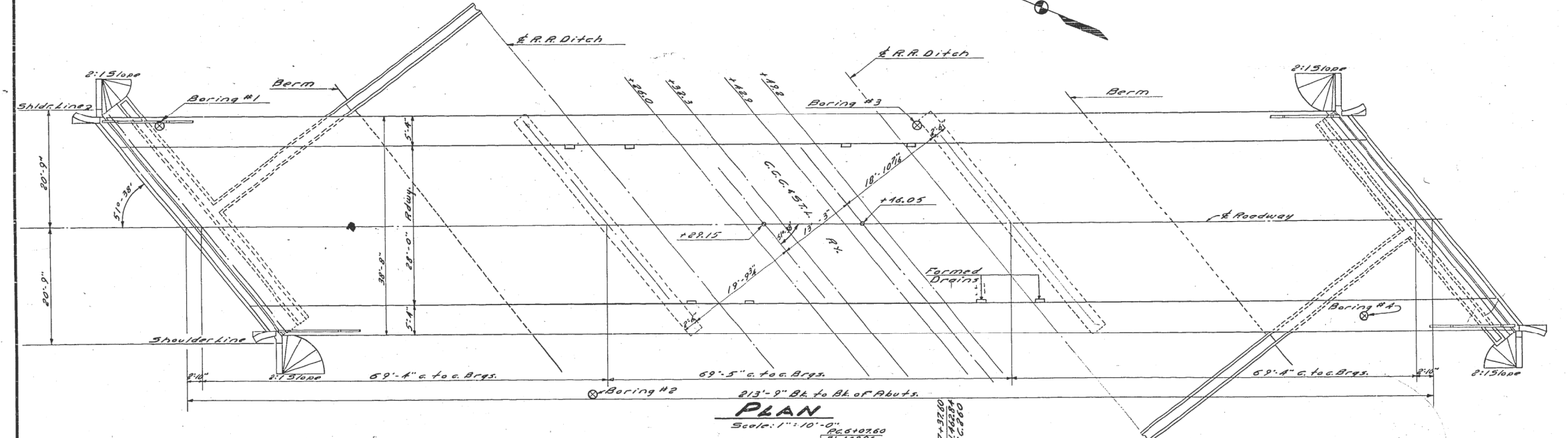
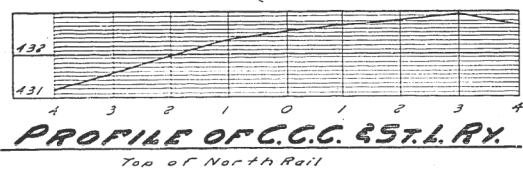
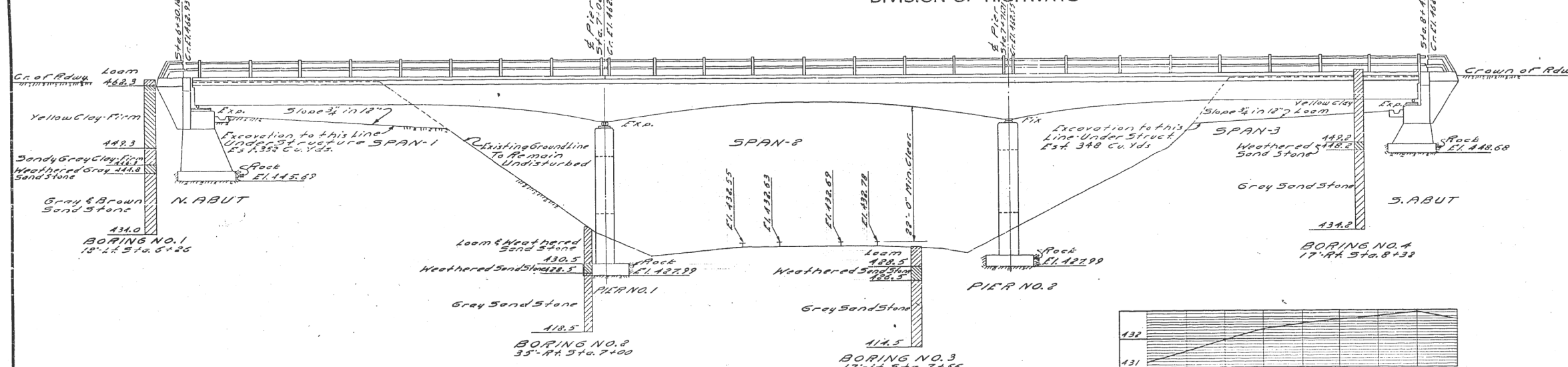

GENERAL NOTES

Standard Specifications adopted July 2, 1924, Part 1 to Part 10 of the Standard Specifications for Class X Concrete shall be used throughout except in Rail Posts. Handrail Concrete shall be used in Rail Posts. The Concrete Floor Slab and Girders shall be poured in one continuous operation between joints. The Concrete Floor Slab shall be finished in accordance with Art. 51.18(c) of the Standard Specifications. All Rollers, Rollers, Bearing Plates, Lead Plates, and Anchor Bolts shall be lead finished and set in accordance with Art. 51.14 of the Standard Specifications and are included for payment as Structural Steel. Estimated Weight 11500 lbs. All Metal Handrail, including Rail Post Anchors, is included for payment as Metal Handrail. The Contract Unit Price per lineal foot of Metal Handrail includes the furnishing, installing and painting of the Handrail. The number of lineal feet is measured on the outside of concrete parts. Metal Handrail and Structural Steel shall receive one shop coat of red lead paint after inspection and two field coats of aluminum paint. All paint shall be furnished and applied by the Contractor. Expansion Guards shall be fabricated and erected in accordance with Art. 52.14(c) of the Standard Specifications. The surfaces of outside girders shall be finished in accordance with Art. 52.14(c) of the Standard Specifications. Boring Data are shown only as a guide to Bidders in estimating soil conditions which may be encountered in the work. Structural Steel shall receive one field coat of red lead paint and two field coats of aluminum paint. See Art. 51.1 to 51.5 of the S.S. Specs. All paint shall be furnished and applied by the Contractor.

TOTAL BILL OF MATERIAL

ITEM	SUPER	SUB	TOTAL
Class X Concrete Cu. Yds.	560.9	354.0	914.9
Handrail Concrete Cu. Yds.	1.6		1.6
Reinforcement Bars Lbs.	15840	34980	193480
Structural Steel Lbs.	13550		13550
Metal Handrail Lin. Ft.	426.6		426.6
Name Plates Ea.	1		1
Class A Excav. for Structure Cu. Yds.		754	754
Rock Excav. for Structure Cu. Yds.		58	58
Earth Excavation Cu. Yds.		700	700
Removal of Exist. Struct. Ea.		1	1

GENERAL PLAN & ELEVATION

C. C. C. & ST. L. RY. OVERHEAD
CHERRY ST. MT. CARMEL
S. B. I. RT. 1-SEC. 12VR-2B
WABASH COUNTY

DESIGNED *W. N. Sommer*
CHECKED *J. Kellogg*
DRAWN *G. K. C. Pulley*
CHECKED *W. B.*

EXAMINED *W. E. Hanson*
PASSED *E. J. Hanson*
APPROVED *E. J. Knight*
Acting CHIEF HIGHWAY ENGINEER

Nov 9 1953

MODEL: SMODEL.MAMT5
FILE NAME: STILES

USER NAME = SUSERS	DESIGNED -	REVISED -
PLOT SCALE = 5SCALES	DRAWN -	REVISED -
PLOT DATE = SDATES	CHECKED -	REVISED -
	DATE -	REVISED -

STATE OF ILLINOIS
DEPARTMENT OF TRANSPORTATION

F.A.P. RTE.	SECTION	COUNTY	TOTAL SHEETS	SHEET NO.
332	(12VR, 28)B	Wabash	32	25
CONTRACT NO. 74320				
SCALE:	SHEET OF SHEETS	STA.	TO STA.	ILLINOIS FED. AID PROJECT