

F.A.P. RTE.	SECTION	COUNTY	TOTAL SHEETS	SHEET NO.
330	465 VB-R-1	COOK	103	7
STA.	TO STA.			
FED. ROAD DIST. NO. 1 ILLINOIS FED. AID PROJECT				
CONTRACT NO. 60407				

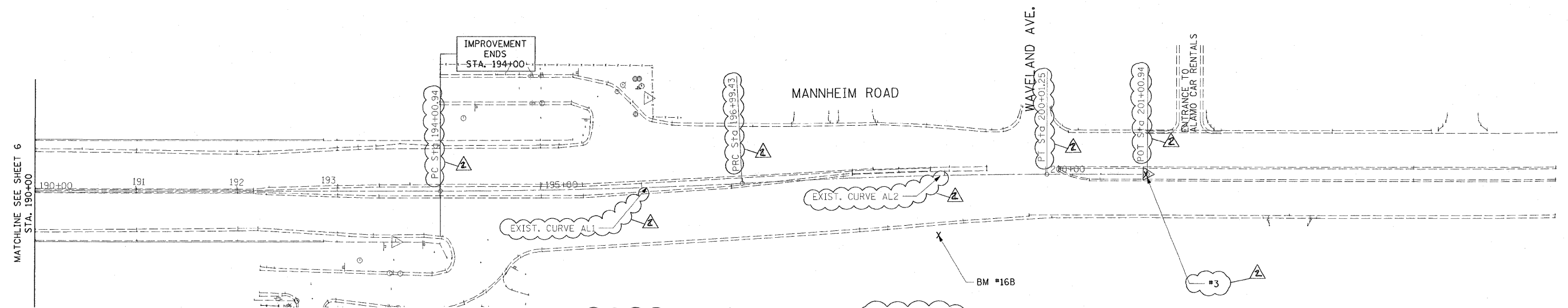
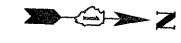

EXIST. CURVE AL1
 PI STA. = 195+50.23
 N=1922980.816
 E=1106080.685
 $\Delta = 3^\circ 14' 15''$ (LT)
 $D = 1^\circ 05' 05''$
 $R = 5,282.70'$
 $T = 149.28'$
 $L = 298.49'$
 $E = 2.11'$
 P.C. STA. = 194+00.94
 N=1922832.326
 E=1106085.272
 P.R.C. STA. = 196+99.43
 N=1932130.248
 E=1106067.552

EXIST. CURVE AL2
 PI STA. = 198+50.38
 N=192382.273
 E=1106054.244
 $\Delta = 3^\circ 14' 02''$ (RT)
 $D = 1^\circ 04' 17''$
 $R = 5,347.43'$
 $T = 150.95'$
 $L = 301.82'$
 $E = 2.13'$
 P.R.C. STA. = 196+99.43
 N=1932130.248
 E=1106067.552
 P.T. STA. = 200+01.25
 N=1923431.504
 E=1106049.729

BENCHMARK

- BM#8: "X" CUT ON CRASHWALL SW CORNER OF 5th PIER SOUTH OF NORTH ABUTMENT ELEV. 648.97
- BM#12B: "X" CUT ON NW BOLT (TOP ROW) FH WEST SIDE MANNHEIM RD. FIRST FH SOUTH OF BRIDGE OVER RR TRACKS & FRANKLIN AVE. ELEV. 650.81
- BM#16: "X" CUT IN SW CORNER OF CRASHWALL, 2nd PIER NORTH OF SOUTH ABUTMENT OF BRIDGE OVER RR ELEV. 649.76
- BM#16B: "X" CUT ON SE BOLT ON FH EAST SIDE OF MANNHEIM RD., SOUTH OF WAVELAND AVE. ELEV. 644.15

NOTE:
 NORTHINGS & EASTINGS AS SHOWN ON PLAN ARE PROJECT SPECIFIC AND SHALL BE USED FOR THIS PROJECT ONLY

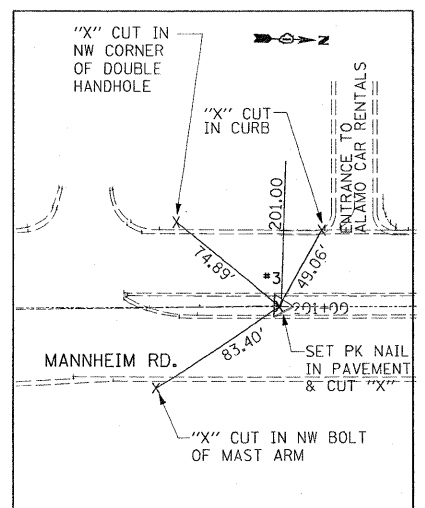

#3
 N=1923529.9813
 E=1106047.2742
 SEE NOTE

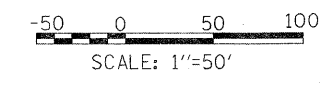

AT-02

REVISIONS	
NAME	DATE
ADDENDUM 2	10-19-09

ILLINOIS DEPARTMENT OF TRANSPORTATION
 FAP 330 US 12/45 (MANNHEIM RD.) OVER
 500 LINE RR & FRANKLIN AVE.

ALIGNMENT, TIES AND BENCHMARKS

SCALE: 1"=50'
 DATE: JULY 8, 2009
 DRAWN BY: MD
 CHECKED BY: PWK

EARTH TECH | AECOM

L:\WORK\53346\cadd\drawings\Roadway\07.align.dgn 10/21/2009