

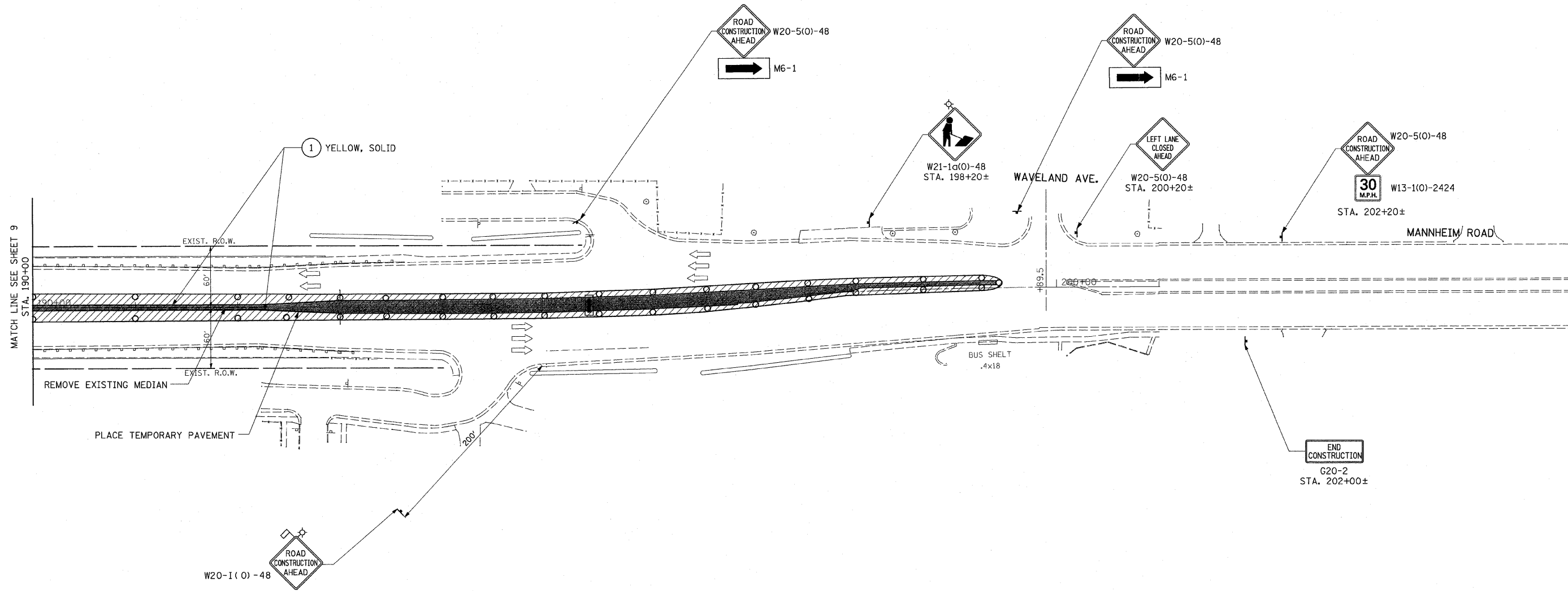

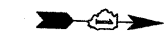

F.A.P. RTE.	SECTION	COUNTY	TOTAL SHEETS	SHEET NO.
330	465 VB-R-1	COOK	103	10
STA.		TO STA.		
FED. ROAD DIST. NO. 1		ILLINOIS	FED. AID PROJECT	
CONTRACT NO. 60407				

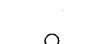

**LEGEND**

-  TEMPORARY PAVEMENT
  - 1" HMA SURFACE COURSE, MIX D, N50,
  - 8" PCC BASE COURSE
  - OR
  - 1" HMA SURFACE COURSE, MIX D, N50,
  - 11" HMA BASE COURSE
-  ARROW BOARD
-  DRUM OR TYPE II PLASTIC BARRICADE WITH STEADY BURNING LIGHT, 50' C-C ON CURVE/TAPER 100' C-C ON TANGENT
-  WORK ZONE
-  DIRECTION OF TRAFFIC
-  TEMPORARY PAVEMENT MARKING-LINE 4"

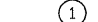
**NOTE:**  
PAVEMENT MARKINGS SHALL BE INSTALLED AT ALL MEDIAN REMOVAL AND TEMPORARY PAVEMENT LOCATIONS. THE PAVEMENT MARKING SHALL CONSIST OF A 4" SOLID YELLOW EDGE LINE ALONG THE LEFT EDGE OF THE INNER LANE

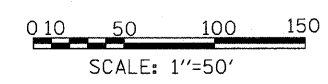

**EARTH TECH | AECOM**

REVISIONS	
NAME	DATE

ILLINOIS DEPARTMENT OF TRANSPORTATION  
FAP 330 US 12/45 (MANNHEIM RD.) OVER  
S00 LINE RR & FRANKLIN AVE.  
**MAINTENANCE OF TRAFFIC  
PRE-STAGE**  
SCALE: 1" = 50'  
DATE: JULY 8, 2009  
DRAWN BY: CJO  
CHECKED BY: PWK

MOT-3

L:\WORK\53346\cadd\drawings\Roadway\10MOT\pr-stg.dgn 7/8/2009