

F.A.P. RTE.	SECTION	COUNTY	TOTAL SHEETS	SHEET NO.
330	465 VB-R-1	COOK	103	26
STA.	TO STA.			
FED. ROAD DIST. NO. 1 ILLINOIS FED. AID PROJECT				
CONTRACT NO. 60407				

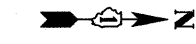
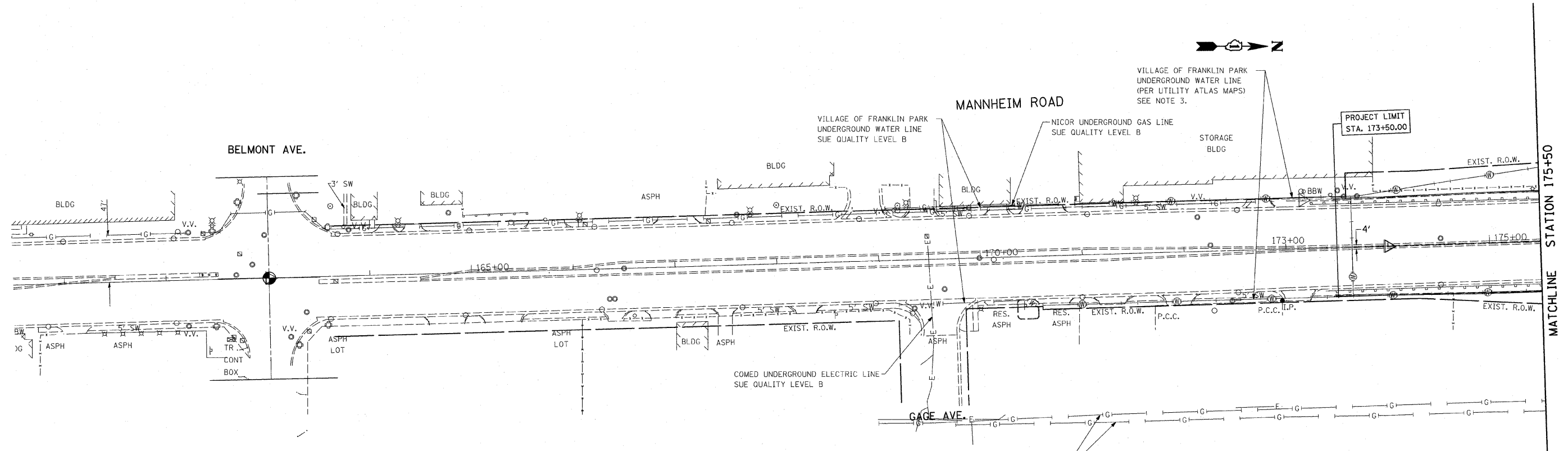

VILLAGE OF FRANKLIN PARK UNDERGROUND WATER LINE (PER UTILITY ATLAS MAPS) SEE NOTE 3.

PROJECT LIMIT STA. 173+50.00

STATE OF ILLINOIS)
COUNTY OF COOK) S.S.

UTILITY(IES) SHOWN HEREON HAVE BEEN INVESTIGATED BY ASE IN ACCORDANCE WITH SUE INDUSTRY STANDARDS QUALITY LEVEL B (QLB). ALL OTHER INFORMATION SHOWN HAS BEEN PROVIDED BY OTHERS.

FIELD WORK WAS PERFORMED BETWEEN THE 29TH OF JULY AND 4TH DAY OF SEPTEMBER, A.D., 2008.

IN WITNESS WHEREOF, I HAVE HEREUNTO SET MY HAND AND SEAL THIS 9TH DAY OF SEPTEMBER A.D., 2008. CHICAGO, IL.



STEVEN M. RIENKS - ILLINOIS PROFESSIONAL ENGINEER NUMBER 62-044619 MY LICENSE EXPIRES 11/30/2009

LEGEND

—T—	EXISTING UNDERGROUND TELEPHONE
—E—	EXISTING UNDERGROUND ELECTRIC
—G—	EXISTING UNDERGROUND GAS
—CTV—	EXISTING UNDERGROUND CABLE TV
—W—	EXISTING UNDERGROUND WATER
—(W)—	EXISTING UNDERGROUND WATER (PER UTILITY ATLAS MAPS)

NOTES:

- HORIZONTAL CONTROL, VERTICAL CONTROL, CENTERLINE ALIGNMENT, AND TOPOGRAPHIC FEATURES WERE SUPPLIED BY ILLINOIS DEPARTMENT OF TRANSPORTATION, CONTRACT NUMBER 60407 DATED MAY 27, 2008.
- RAILROAD UTILITIES WERE MARKED BY THE OWNER OF THE RAILROAD COMPANY.
- SOME WATER MAINS WERE INDETERMINABLE. THEY ARE DRAWN USING THE ATLAS PROVIDED BY THE VILLAGE OF FRANKLIN PARK. THE FOLLOWING PAGES WERE USED: 20NE, 20SE, 21NW, AND 21SW.
- AS OF SEPTEMBER 4, 2008, ASE HAS NOT RECEIVED AT&T UTILITY MAPS. THEREFORE, THEY ARE NOT SHOWN.

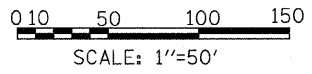

REVISIONS	
NAME	DATE

ILLINOIS DEPARTMENT OF TRANSPORTATION
FAP 330 US 12/45 (MANNHEIM RD.) OVER
S00 LINE RR & FRANKLIN AVE.
**SUE INVESTIGATION
OF UNDERGROUND UTILITIES
STA. 161+00 TO STA. 175+00**
SCALE: DATE: JULY 8, 2009
DRAWN BY: CJO
CHECKED BY: PWK

L:\WORK\53346\cadd\drawings\Roadway\26\rt1.dgn 7/8/2009

SUE-1