

**REMOVAL PLAN**

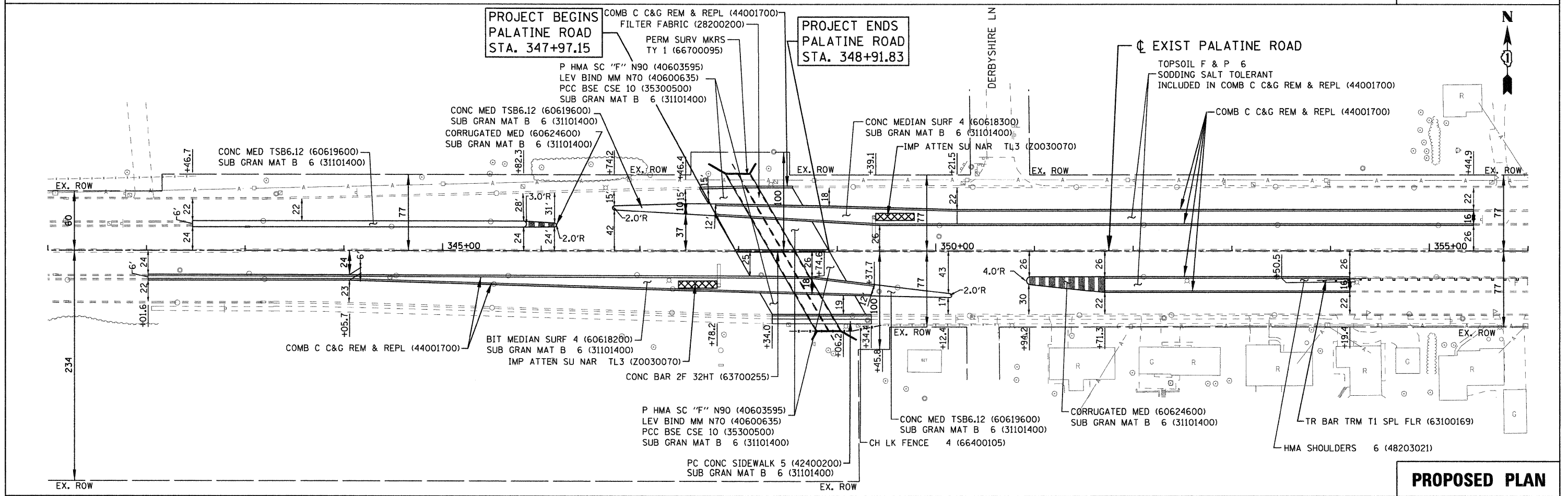

**PROPOSED PLAN**

FILE NAME =	USER NAME = 2kujawa	DESIGNED - DLP	REVISED - 10/09/09	<b>STATE OF ILLINOIS DEPARTMENT OF TRANSPORTATION</b>	<b>McDONALD CREEK CULVERT EXISTING AND PROPOSED ROADWAY PLAN</b>			F.A.P. RTE. 305	SECTION 0913.1-T	COUNTY COOK	TOTAL SHEETS 39	SHEET NO. 12
G:\PROJECT\2882305\CADD\Civil\Sheet\02\02PLMLPR_01.dgn	PLOT SCALE = 50.00' / IN.	DRAWN - ENTRAN	REVISED -		SCALE: 1" = 50'	SHEET NO. OF SHEETS STA. TO STA.	FED. ROAD DIST. NO. 1 ILLINOIS FED. AID PROJECT					
	PLOT DATE = 10/09/2009	CHECKED - TMH	REVISED -		CONTRACT NO. 60E53							
		DATE - 03/09	REVISED -									