

F.A.P. RTE.	SECTION	COUNTY	TOTAL SHEETS	SHEET NO.
332/876	2002-113R	WILL	242	31
STA. 4+100 TO STA. 4+311				
FED. ROAD DIST. NO. 1		ILLINOIS	FED. AID PROJECT	

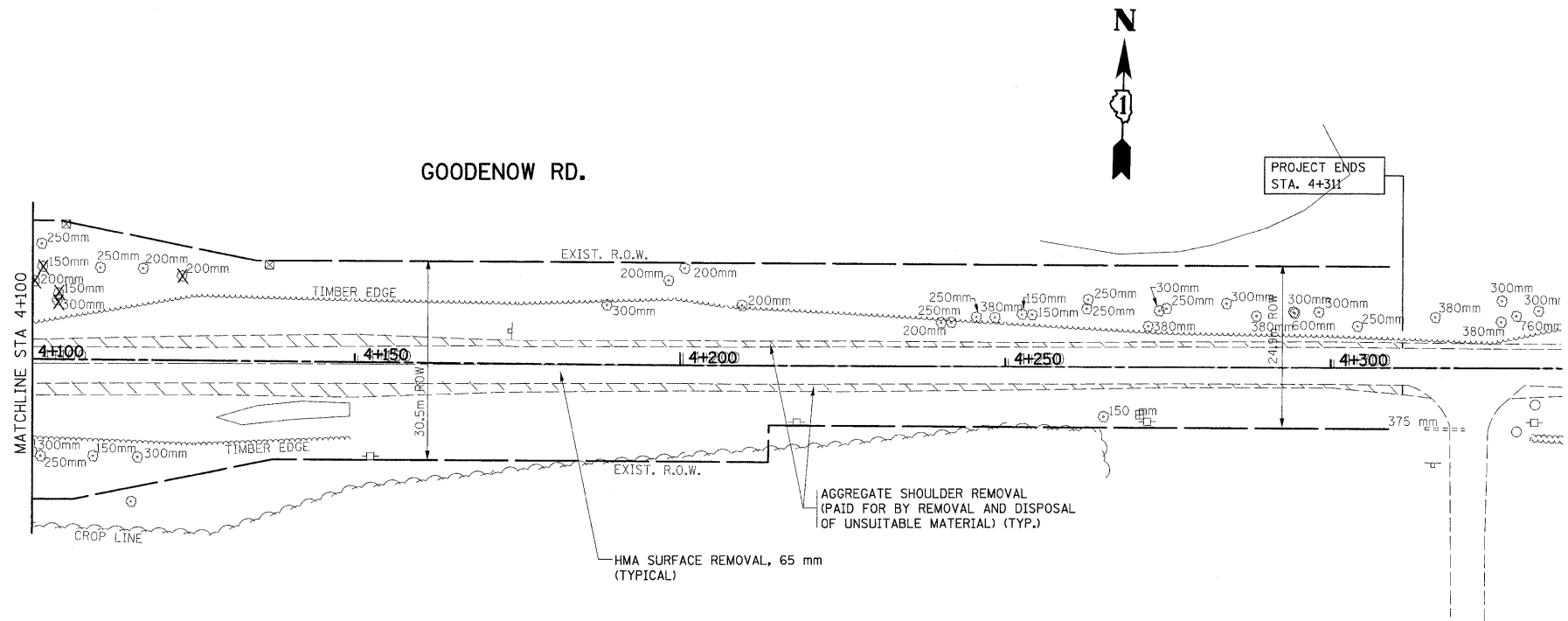

EXISTING  
PROPOSED

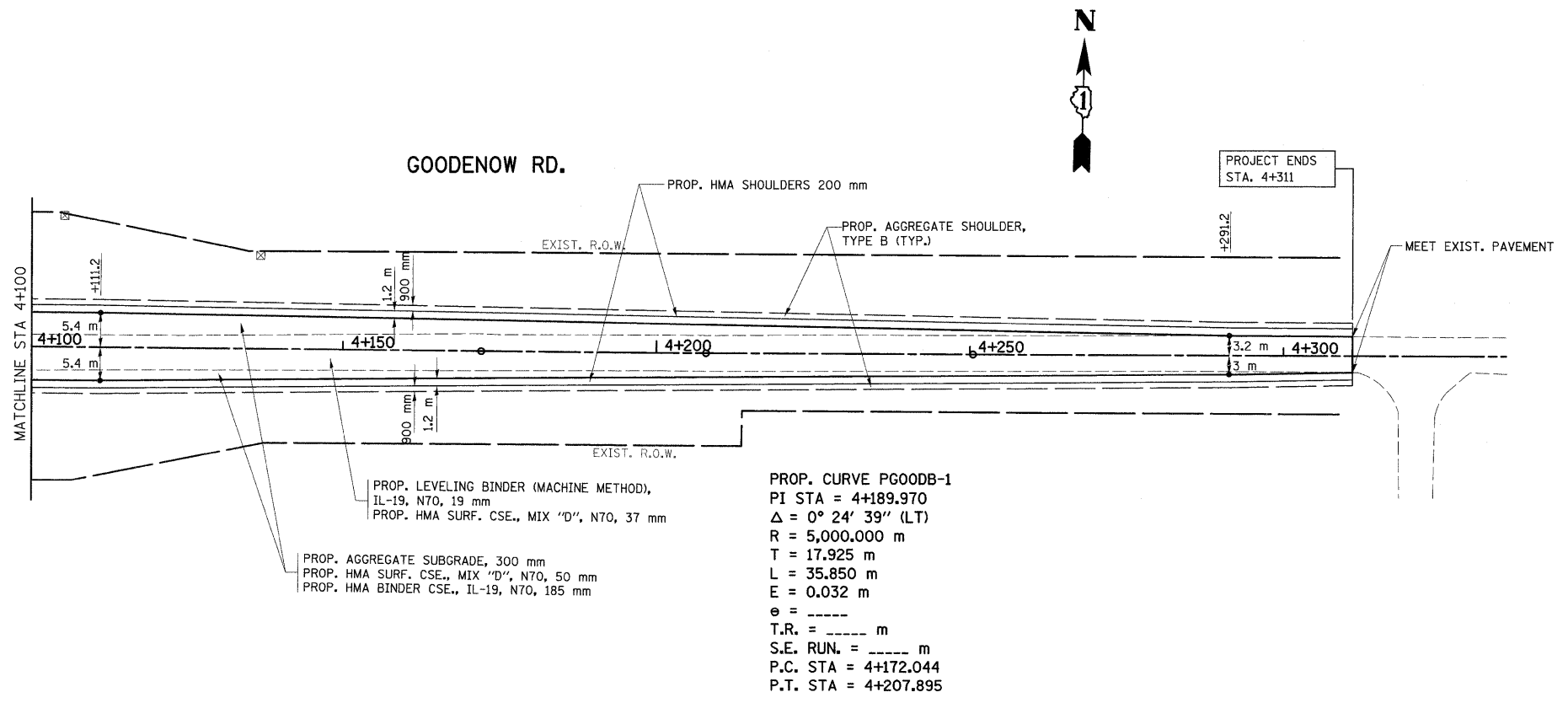

REVISIONS	
NAME	DATE

ILLINOIS DEPARTMENT OF TRANSPORTATION  
 IL. RTE. 394 AT IL. 1  
 EXISTING AND PROPOSED  
 ROADWAY PLAN  
 SCALE 1:500  
 DATE 8/26/2009  
 DRAWN BY  
 CHECKED BY