

F.A.P. RTE.	SECTION	COUNTY	TOTAL SHEETS	SHEET NO.
332/876	2002-113R	WILL	242	35
STA. 61+325 TO STA. 61+650				
FED. ROAD DIST. NO. 1			ILLINOIS FED. AID PROJECT	

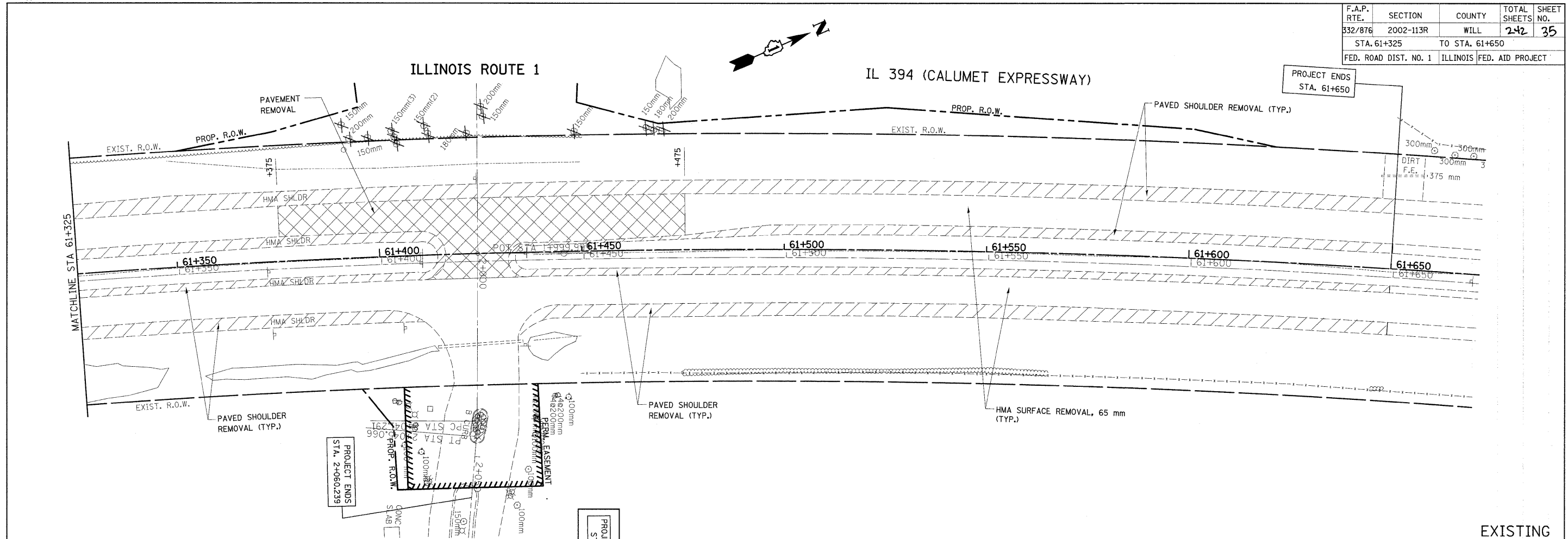

EXISTING  
PROPOSED

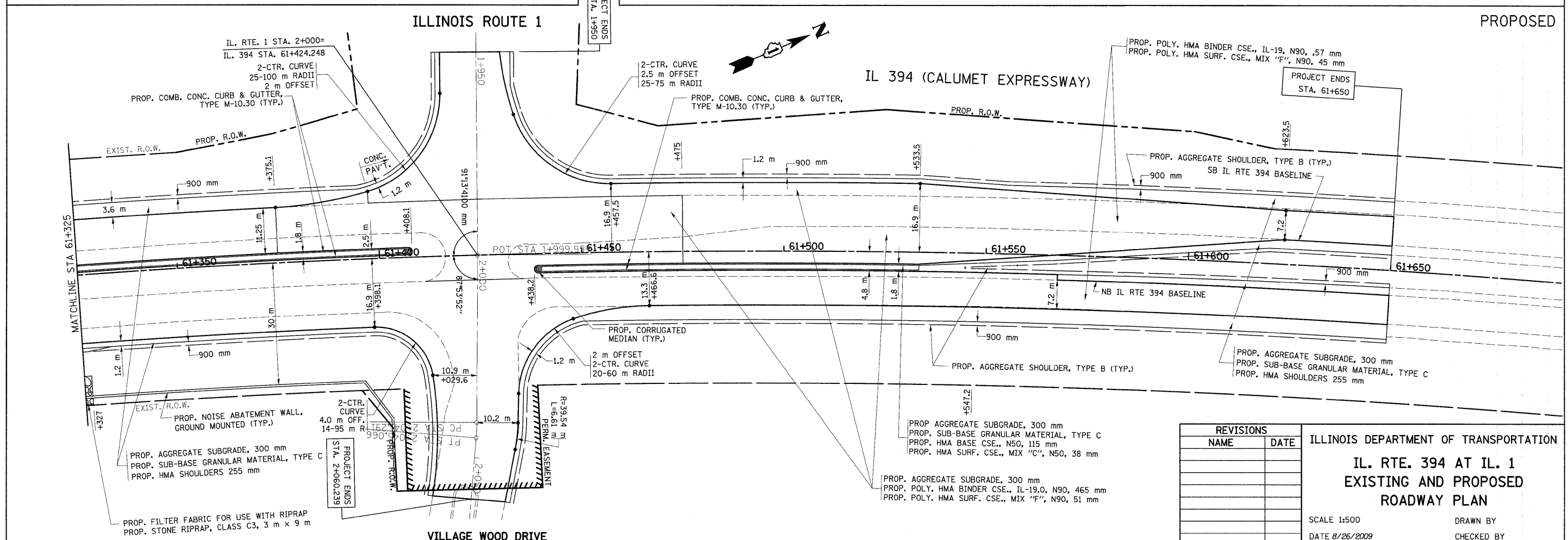

REVISIONS	
NAME	DATE

ILLINOIS DEPARTMENT OF TRANSPORTATION  
**IL. RTE. 394 AT IL. 1**  
**EXISTING AND PROPOSED**  
**ROADWAY PLAN**  
SCALE 1:500  
DATE 8/26/2009  
DRAWN BY  
CHECKED BY