

F.A.P. RTE.	SECTION	COUNTY	TOTAL SHEETS	SHEET NO.
332/876	2002-113R	WILL	242	63
STA. 3+892		TO STA. 4+300		
FED. ROAD DIST. NO. 1		ILLINOIS FED. AID PROJECT		

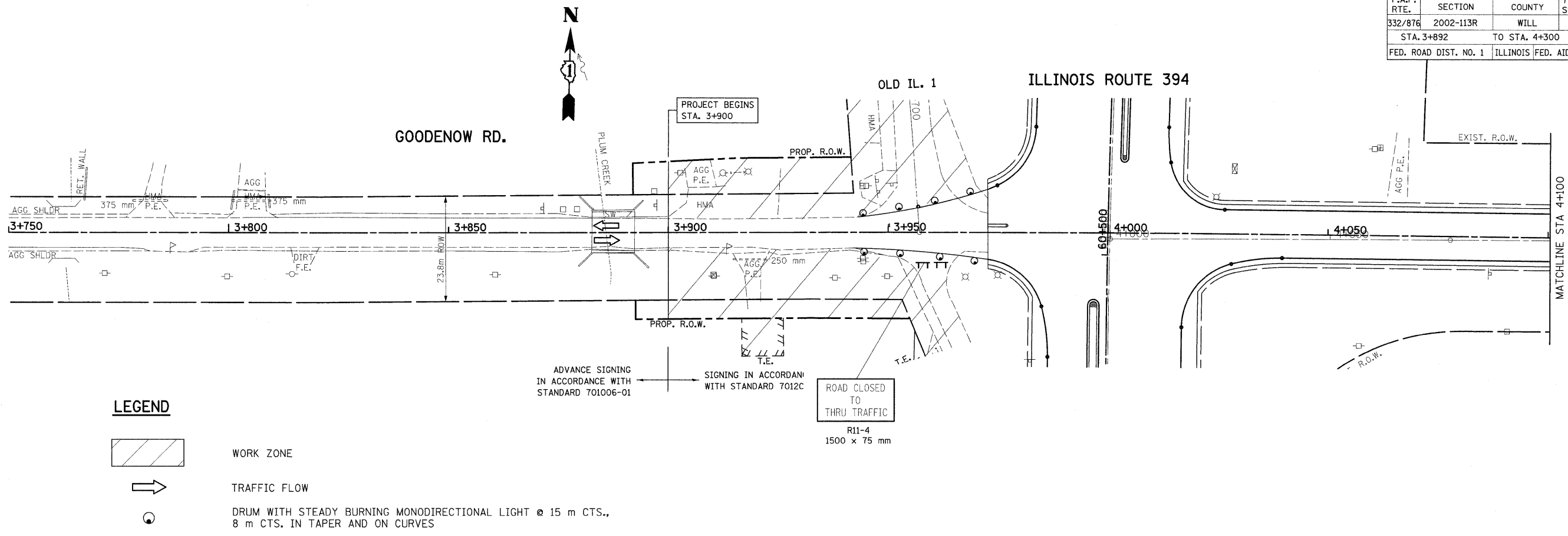

NOTE: GOODENOW RD. WILL BE WIDENED ALONG THE NORTH SIDE FIRST, FOLLOWED BY THE SOUTH SIDE.

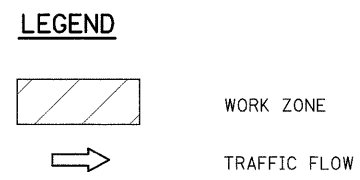
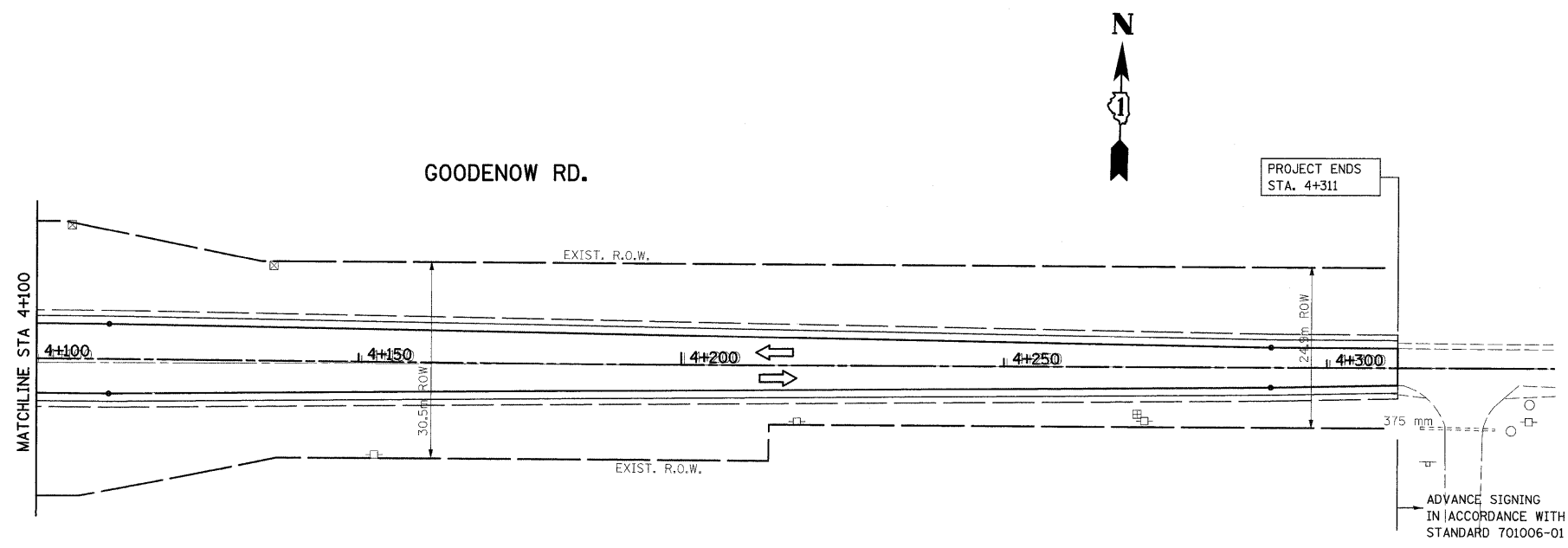

REVISIONS	
NAME	DATE

ILLINOIS DEPARTMENT OF TRANSPORTATION
SUGGESTED MAINTENANCE OF TRAFFIC
IL. RTE. 394 AT IL. 1
STAGE III

SCALE 1:500
 DATE 8/27/2009

DRAWN BY
 CHECKED BY