

STATE OF ILLINOIS
DEPARTMENT OF TRANSPORTATION

Notes:
See sheet 23 of 23 for Sections C-C & D-D and View E-E.
a(E), a₁(E), and w(E) bar spacings measured perpendicular to ϕ Rdwy.

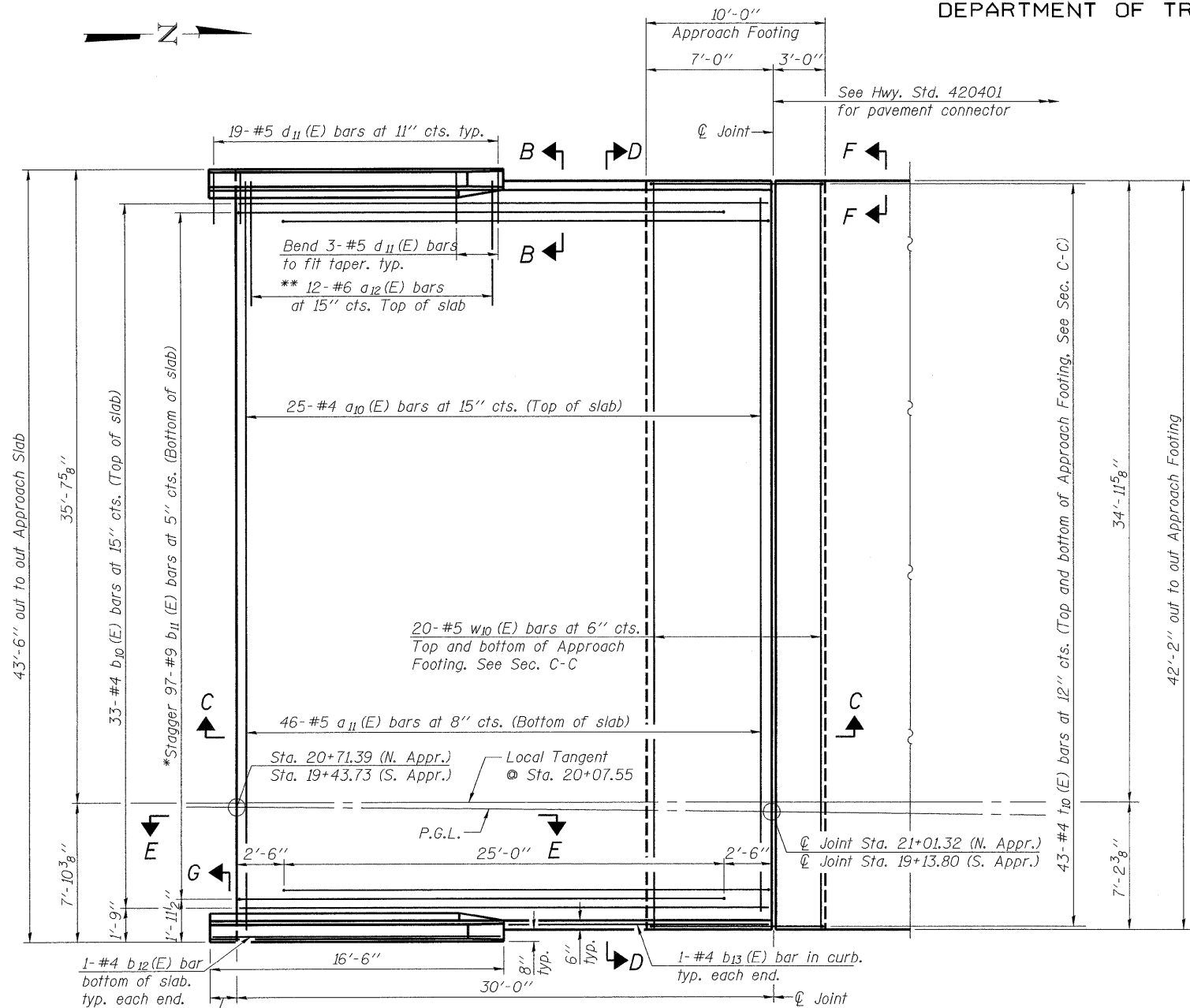

PLAN
(North Approach Slab Shown,
South Approach Slab Similar)

* Tilt #9 b₁₁(E) bars as required to maintain clearance.
** Alternate with a₁₀(E) bars, typ. ea. parapet.

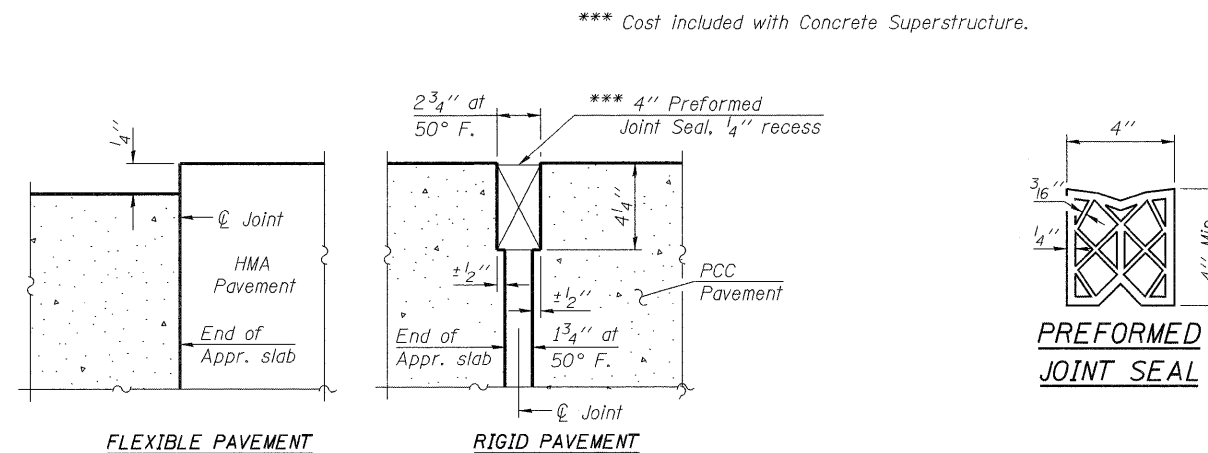

DETAIL A

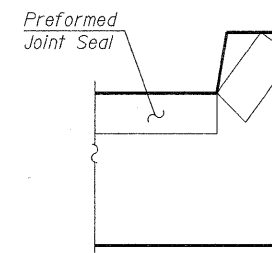

VIEW F-F

Angle Preformed Joint Seal at 45°
at curbs when req'd for drainage.

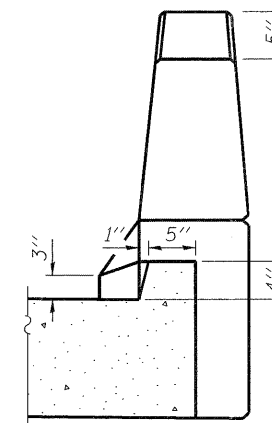

VIEW B-B

DESIGNED	SK/GMK/LCM
CHECKED	GBC/GMK/SMK
DRAWN	RR/LCM/SK
CHECKED	GBC/GMK/SMK

BA-0

10-31-08

BRIDGE APPROACH SLAB DETAILS-1
SOUTHBOUND ILLINOIS ROUTE 394 OVER PLUM CREEK
STATION 20+07.55

SHEET NO. 22	F.A.P. RTE.	SECTION	COUNTY	TOTAL SHEETS	SHEET NO.
	332	2002-113R	WILL	242	193
23 SHEETS	SN-099-0183		CONTRACT NO. 62542		
FED. ROAD DIST. NO. 1 ILLINOIS FED. AID PROJECT					

