

| F.A.P. RTE. | SECTION | COUNTY | TOTAL SHEETS | SHEET NO. |
|---|---------|----------------|--------------|-----------|
| 350 00-00242-00-CH | | COOK | 129 | 15 |
| STA. 100+00 | | TO STA. 112+00 | | |
| FED. ROAD DIST. NO. 7 ILLINOIS FED. AID PROJECT | | | | |

LEGEND

| | | | |
|--|------------------|--|---|
| | PAVEMENT REMOVAL | | HOT-MIX ASPHALT SURFACE REMOVAL, 2 1/2" |
| | MEDIAN REMOVAL | | TREE REMOVAL |
| | SIDEWALK REMOVAL | | RELOCATE UTILITY POLE (BY OTHERS) |
| | DRIVEWAY REMOVAL | | COMBINATION CURB AND GUTTER REMOVAL |

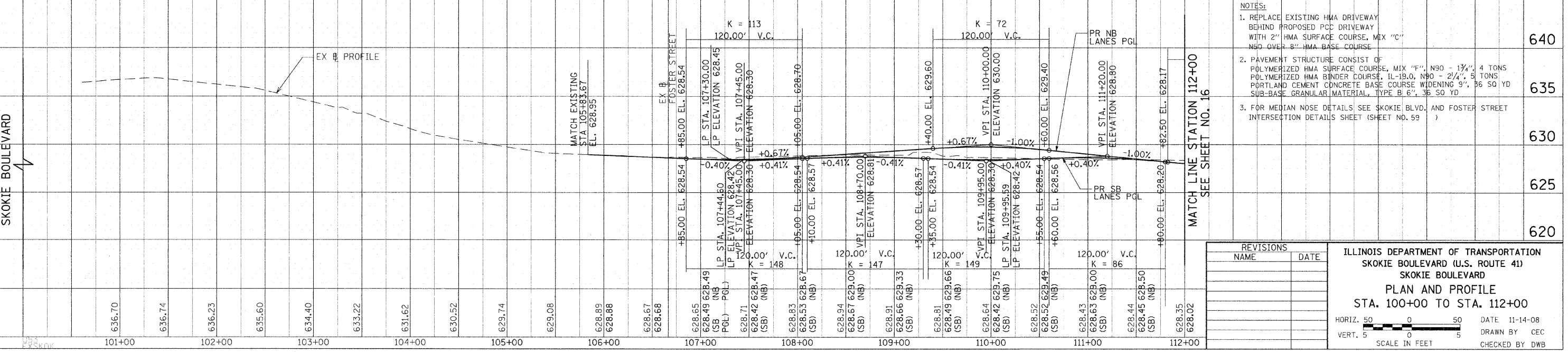
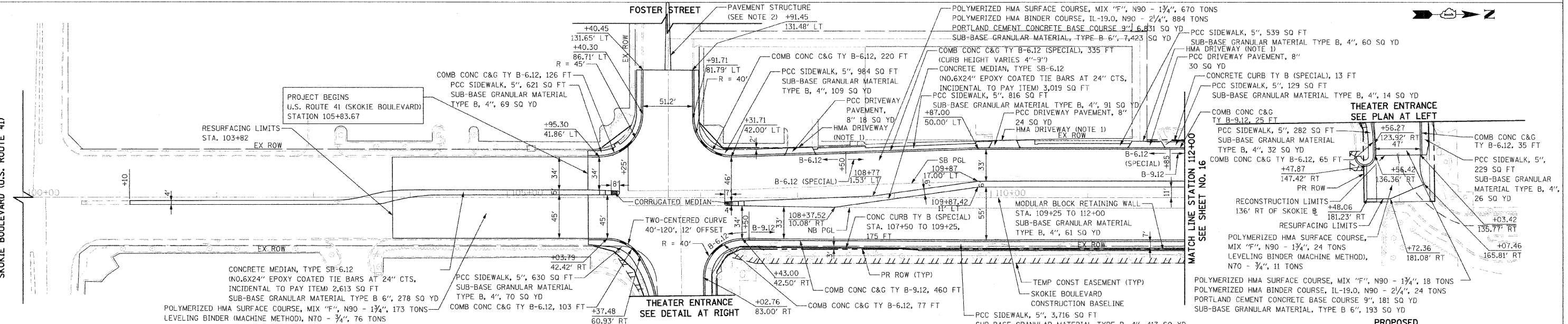
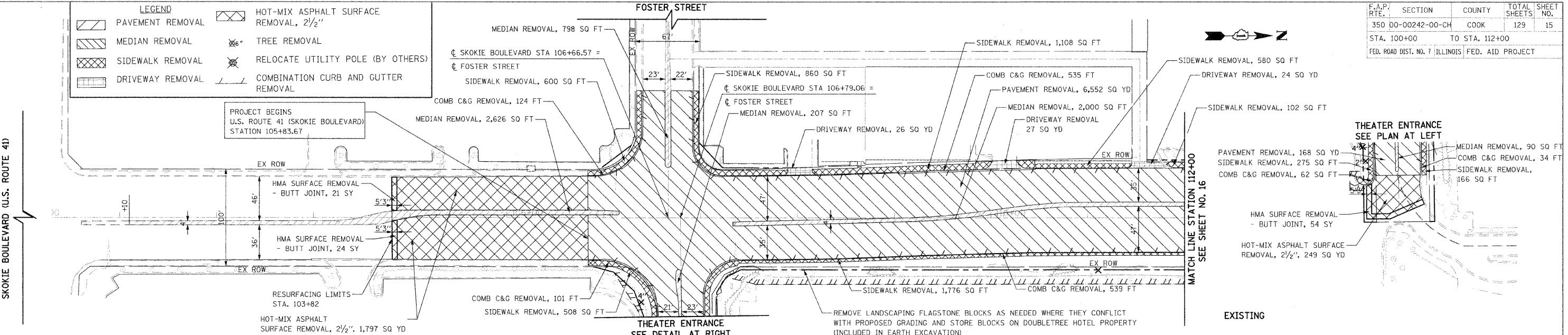

- NOTES:**
- REPLACE EXISTING HMA DRIVEWAY BEHIND PROPOSED PCC DRIVEWAY WITH 2" HMA SURFACE COURSE, MIX "C" N90 OVER 8" HMA BASE COURSE
 - PAVEMENT STRUCTURE CONSIST OF POLYMERIZED HMA SURFACE COURSE, MIX "F", N90 - 1 3/4", 4 TONS POLYMERIZED HMA BINDER COURSE, IL-19.0, N90 - 2 1/4", 5 TONS PORTLAND CEMENT CONCRETE BASE COURSE WIDENING 9", 36 SQ YD SUB-BASE GRANULAR MATERIAL, TYPE B 6", 36 SQ YD
 - FOR MEDIAN NOSE DETAILS SEE SKOKIE BLVD. AND FOSTER STREET INTERSECTION DETAILS SHEET (SHEET NO. 59)

REVISIONS

| NO. | NAME | DATE |
|-----|------|------|
| | | |
| | | |
| | | |

ILLINOIS DEPARTMENT OF TRANSPORTATION
 SKOKIE BOULEVARD (U.S. ROUTE 41)
 SKOKIE BOULEVARD
 PLAN AND PROFILE
 STA. 100+00 TO STA. 112+00

HORIZ. 50 0 50
 VERT. 5 0 5
 SCALE IN FEET

DATE 11-14-08
 DRAWN BY CEC
 CHECKED BY DWB

DATE: 11/13/2008
 PLOT SCALE: 1" = 40'
 USER NAME: #105878

DATE: 11/13/2008
 PLOT SCALE: 1" = 40'
 USER NAME: #105878

DATE: 11/13/2008
 PLOT SCALE: 1" = 40'
 USER NAME: #105878