

F.A.P. RTE.	SECTION	COUNTY	TOTAL SHEETS	SHEET NO.
350	00-00242-00-CH	COOK	129	91
STA.	TO STA.			
FED. ROAD DIST. NO. 7 ILLINOIS FED. AID PROJECT				

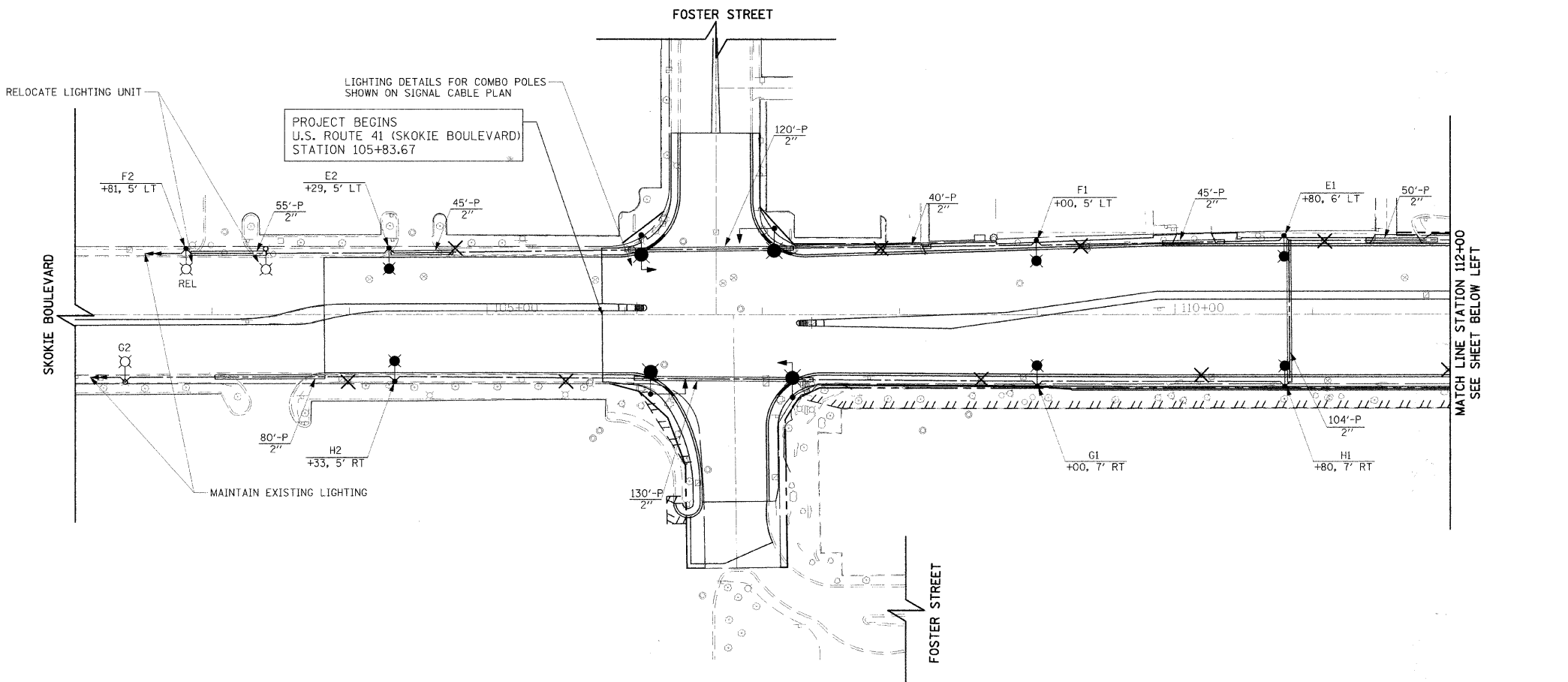
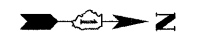

- LEGEND**
- PROPOSED COMBINATION LIGHTING AND TRAFFIC SIGNAL UNIT
POLE: ALUMINUM, 45' M.H., 15' TRUSS MAST ARM (IDOT HWY STD 877011, 877012)
LUMINAIRE: 400W HPS, CUTOFF, FLAT GLASS, AE 325 SERIES OR APPROVED EQUAL
 - RELOCATED EXISTING ROADWAY LIGHTING UNIT WITH NEW CONCRETE FOUNDATION
 - PROPOSED ROADWAY LIGHTING UNIT
POLE: ALUMINUM, 45' M.H., 15' TRUSS MAST ARM (IDOT DI DETAIL BE-40)
LUMINAIRE: 400W HPS, CUTOFF, FLAT GLASS, AE 325 SERIES OR APPROVED EQUAL
 - EXISTING ROADWAY LIGHTING UNIT (ORIGINAL LOCATION)
 - EXISTING LUMINAIRE ON COMED POLE TO REMAIN
 - EXISTING SERVICE INSTALLATION, 240/480V, 1Ø, 3 WIRE
 - PROPOSED SERVICE INSTALLATION, 240/480V, 1Ø, 3 WIRE
 - EXISTING LIGHTING CONTROLLER CABINET
 - PROPOSED LIGHTING CONTROLLER CABINET, 240/480V, 1Ø, 3 WIRE
 - PROPOSED HANDHOLE
 - EXISTING HANDHOLE
 - GROUND ROD, 5/8 INCH x 10 FEET
 - UNIT DUCT
 - "P" PUSHED
 - "T" TRENCHED
 - CONDUIT PUSHED (P), 2.5" DIA. GALVANIZED STEEL (UNLESS OTHERWISE NOTED)
 - LIGHT POLE CIRCUIT
XXX, XXX' LT/RT STATION OFFSET FROM BACK-OF-CURB
 - X REMOVAL OF EXISTING LIGHTING UNIT

GENERAL NOTES

1. IT SHALL BE THE CONTRACTOR'S RESPONSIBILITY TO MARK THE PROPOSED LOCATIONS OF ALL LIGHT POLES FOR EXAMINATION AND CONFIRMATION WITH THE RESIDENT ENGINEER. THE CONTRACTOR SHALL VERIFY ALL UTILITY LOCATIONS PRIOR TO AUGURING FOR LIGHT POLE FOUNDATIONS. THE EXACT LOCATIONS OF ALL ITEMS SHALL BE CONFIRMED WITH THE RESIDENT ENGINEER PRIOR TO STARTING WORK.
2. PROPOSED ROADWAY LIGHT POLES SHALL HAVE A SET-BACK OF 2.0 FEET (MIN) FROM THE BACK OF CURB TO THE CENTER OF POLE, UNLESS OTHERWISE INDICATED ON THE PLANS OR AS DIRECTED BY THE ENGINEER.
3. A GROUND ROD SHALL BE PROVIDED FOR EACH CONCRETE FOUNDATION. GROUNDING CONNECTIONS MADE TO THE FOUNDATION SHALL BE EXOTHERMICALLY WELDED, AS SPECIFIED IN THE PLAN DETAILS.
4. THE CONTRACTOR SHALL NOTE THE REQUIREMENTS FOR THE ELECTRICAL SERVICE FOR THE PROPOSED ROADWAY LIGHTING. IT IS THE CONTRACTOR'S RESPONSIBILITY FOR TIMELY NOTIFICATION AND COORDINATION WITH THE ELECTRIC UTILITY COMPANY.
5. PARALLEL UNIT DUCT RUNS SHOWN ON THE PLANS SHALL BE PLACED IN A COMMON TRENCH.
6. THE CONTRACTOR SHALL MAKE SPECIAL NOTE OF THE SPECIFIED REQUIREMENTS FOR BURIED WARNING TAPE, SPECIFIED AS PART OF "TRENCH AND BACKFILL FOR ELECTRICAL WORK". THE INSTALLATION OF THE TAPE SHALL BE INSPECTED BY THE ENGINEER PRIOR TO BACKFILLING OR DURING PLOWING OPERATIONS, AS APPLICABLE.
7. ALL CONDUIT IS PUSHED UNLESS OTHERWISE NOTED. CONDUIT LENGTHS SHOWN ON THE PLANS ARE APPROXIMATE. THE CONTRACTOR SHALL VERIFY THE ACTUAL DISTANCE REQUIREMENTS IN THE FIELD.
8. THE EXISTING LIGHT POLES SHALL BE DISPOSED OR SALVAGED AS DIRECTED BY THE ENGINEER. THE POLE SHALL BE DISPOSED BY THE CONTRACTOR AT NO COST TO THE VILLAGE. THE SALVAGED POLES AND LUMINAIRES SHALL BE DELIVERED TO THE VILLAGE OF SKOKIE PUBLIC WORKS DEPARTMENT AT 9050 GROSS POINT ROAD.

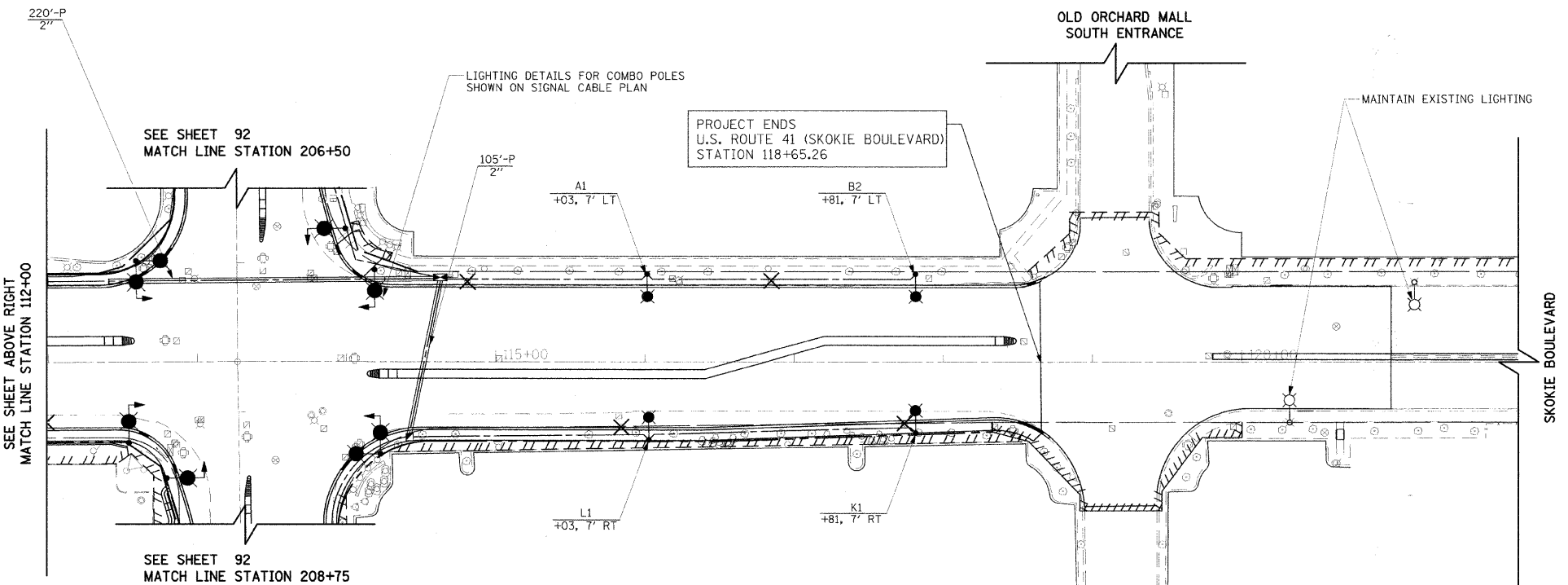

REVISIONS		DATE
NAME		

ILLINOIS DEPARTMENT OF TRANSPORTATION

**LIGHTING PLAN
SKOKIE BOULEVARD**

50' 0 50'
HORIZ. 1"=50'

DATE 11-14-08
DRAWN BY SRS
CHECKED BY KMM

PLOT DATE = 11/14/2008
 FILE NAME = 111408.LSP
 PLOT SCALE = 1"=50'
 USER NAME = JUSER