

BENCHMARK NO 7323 ELEV = 849.135

DESCRIPTION:  
 SURVEY DISK SET IN TOP OF CONCRETE MONUMENT STATION LOCATED 356 FEET WEST OF CENTERLINE OF VERMONT ROAD ON THE SOUTHEASTERLY SIDE OF KISHWAUKEE VALLEY ROAD WITHIN THE TRIANGLE CREATED BY THE ROADS.

NOTES:  
 1. ALL ELEVATIONS SHOWN ARE BASED ON THE NORTH AMERICAN VERTICAL DATUM OF 1988 (NAVD 88).

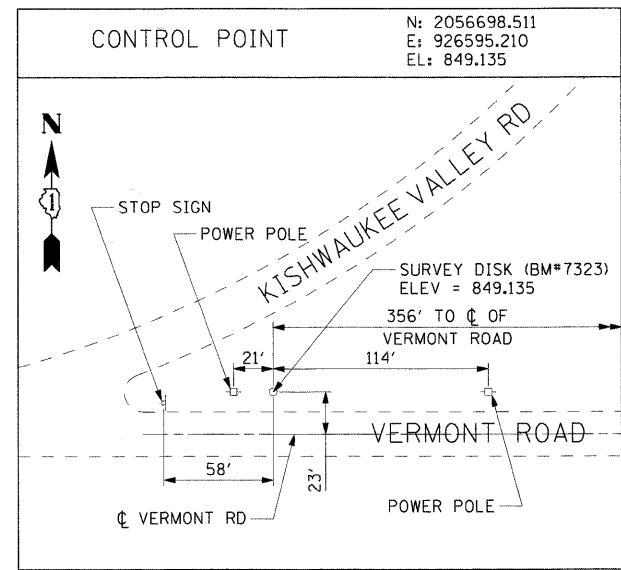

FILE NAME = P:\P\600P5873\102\_CAD\981\_Drawing\Sheets\General\10600P5873-int-ATB.dgn

<b>AECOM</b>	USER NAME = holmann	DESIGNED - NJH	REVISED -	<b>MCHENRY COUNTY DIVISION OF TRANSPORTATION</b>	<b>ALIGNMENT, CONTROL POINTS AND BENCHMARKS</b>			F.A.S. RTE. 0031	SECTION 06-00323-00-BR	COUNTY MCHENRY	TOTAL SHEETS 53	SHEET NO. 10
	PLOT SCALE = 50.00' / IN.	DRAWN - NJH	REVISED -		SCALE: 1"=50'	SHEET NO. 1 OF 1 SHEETS	STA. 147+15.85 TO STA. 151+90.03	CONTRACT NO. 63218				
	PLOT DATE = 9/1/2009	CHECKED - RMG	REVISED -					FED. ROAD DIST. NO. 1 [ILLINOIS] FED. AID PROJECT				
		DATE - MARCH 20, 2009	REVISED -									