

STATE OF ILLINOIS  
 DEPARTMENT OF TRANSPORTATION  
 DIVISION OF HIGHWAYS  
**PLANS FOR PROPOSED  
 FEDERAL AID HIGHWAY**

FAU 2757 (ROBERTS ROAD) - 83RD ST TO ARCHER AVE  
 FAU 1537 (71ST STREET) - ROBERTS RD TO RR TRACKS  
 FAU 1548 (79TH STREET) - ROBERTS RD TO HARLEM AVE  
 FAU 1558 (87TH STREET) - 78TH AVE TO 78TH CT  
 SIDEWALK IMPROVEMENTS  
 SECTION NO.: 09-00060-00-SW  
 PROJECT NO.: M-9003(325)  
 JOB NO. C-91-634-09  
 VILLAGE of BRIDGEVIEW

F.A. U. REC.	SECTION	COUNTY	TOTAL SHEETS	SHEET NO.
2757/1537	09-00060-00-SW	COOK	35	1
STA.	TO STA.			
FED. ROAD DIST. NO. 1	ILLINOIS	FED. AID PROJECT M-	9003(325)	

CONTRACT #63228

INDEX OF SHEETS  
 SEE SHEET NO. 2

HIGHWAY STANDARDS  
 SEE SHEET NO. 2

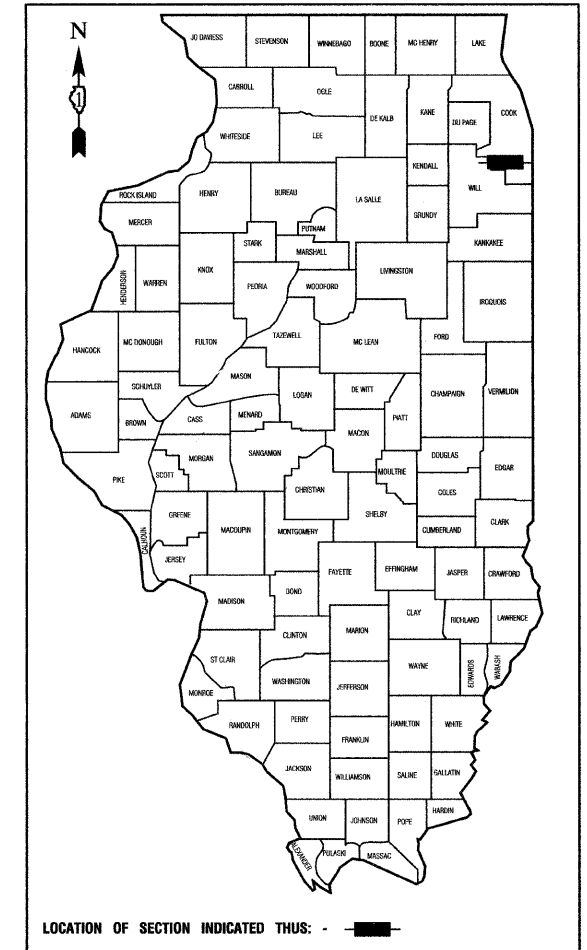

STATE OF ILLINOIS DEPARTMENT OF TRANSPORTATION  
 DIVISION OF HIGHWAYS

Approved: \_\_\_\_\_  
 Passed: August 31, 2009  
 Released for Bid Based on Limited Review: SEPTEMBER 1, 2009

PRINTED BY THE AUTHORITY OF  
 THE STATE OF ILLINOIS

PREPARED BY OR UNDER THE  
 DIRECT SUPERVISION OF:  
 [Signature]  
 8/26/09

PROFESSIONAL ENGINEER  
 LICENSE EXPIRES: 11/30/09

I.D.O.T. FEDERAL AID DESIGN ENGINEER: MELCHOR MANGOBA (847) 705-4408  
 CONSULTANTS: ROBINSON ENGINEERING, LTD. 708-331-6700

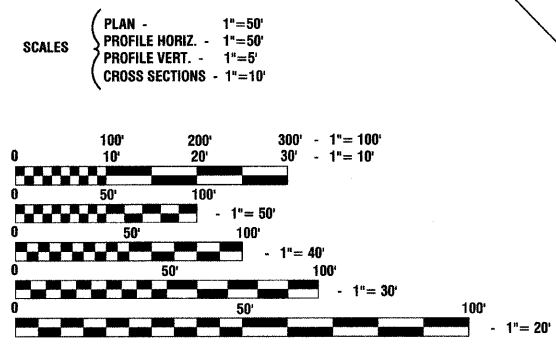

FULL SIZE PLANS HAVE BEEN PREPARED USING STANDARD  
 ENGINEERING SCALES, REDUCED SIZED PLANS WILL NOT  
 CONFORM TO STANDARD SCALES, IN MAKING MEASUREMENTS  
 ON REDUCED PLANS, THE ABOVE SCALES MAY BE USED.

J. U. L. I. E.  
 JOINT UTILITY LOCATION INFORMATION FOR EXCAVATION  
 1-800-892-0123 or 811

CONTRACT NO. 63228

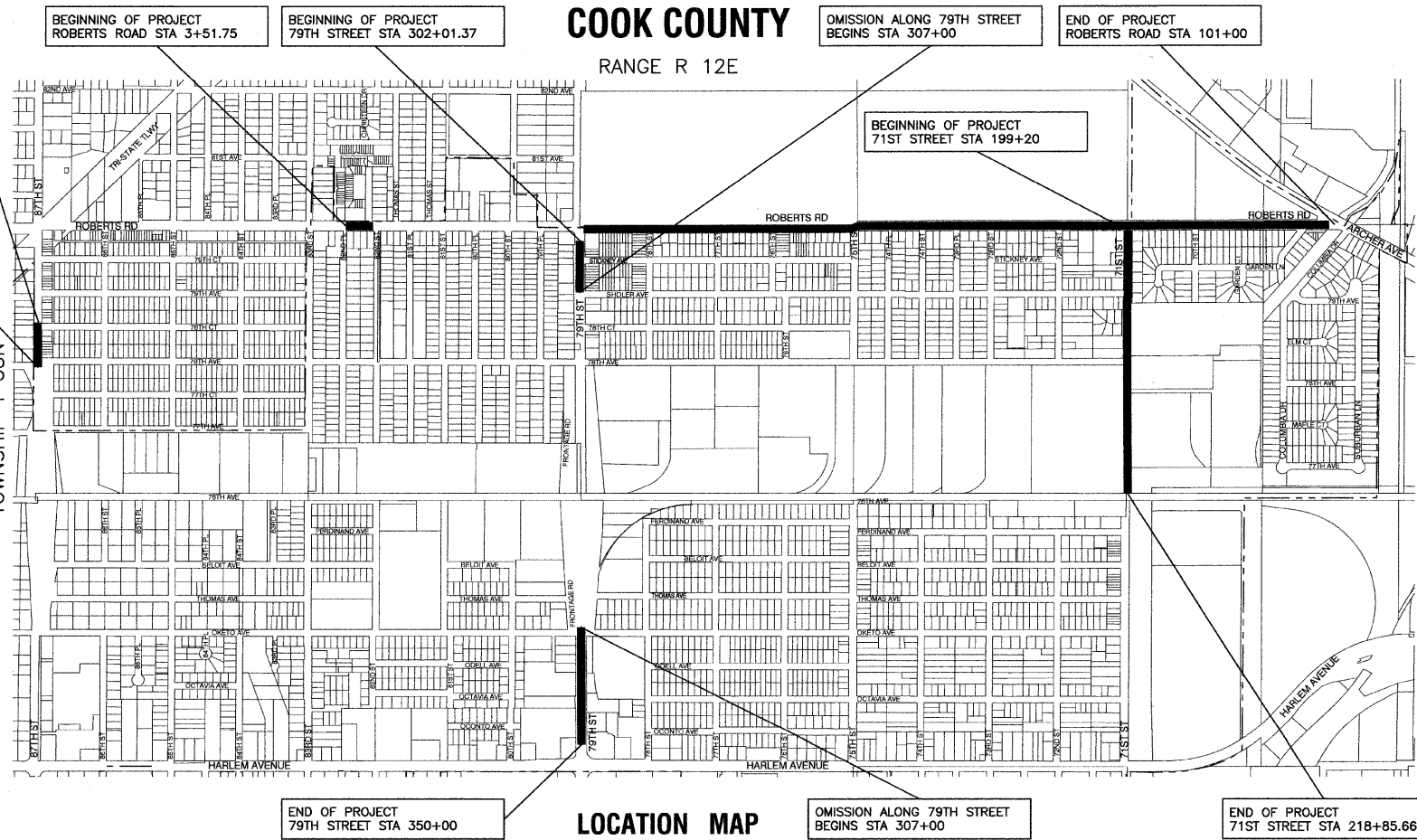

LOCATION MAP  
 GROSS LENGTH=16,808.30 FEET=3.18 MILES  
 NET LENGTH=15,209.67 FEET=2.88 MILES