

INDEX OF SHEETS

SHEET #	TITLE
1	COVER/INDEX
2	GENERAL NOTES, LEGEND AND QUANTITIES
3	TYPICAL SECTION
4	PLAN AND PROFILE (NEAR PLAINFIELD RD), STA. 0+00 -10+00
5	PLAN AND PROFILE (NEAR LONGWOOD DR), STA. 10+00 -12+92
6	PLAN AND PROFILE (NEAR 91st ST), STA. 12+43 -17+49
7	DETAILS
8	DRIVEWAY DETAILS - DISTANCE BETWEEN ROW AND FACE OF CURB < 15' (4.5M)
9	TRAFFIC CONTROL AND PROTECTION FOR SIDE ROADS, INTERSECTIONS, & DRIVEWAYS
10	DISTRICT ONE TYPICAL PAVEMENT MARKINGS
11	OUTLET FOR CONCRETE CURB AND GUTTER
12	CROSS SECTIONS STATION 5+50.00 TO 9+00.00
13	CROSS SECTIONS STATION 9+50.00 TO 12+50.00
14	CROSS SECTIONS STATION 12+50.00 TO 14+00.00
15	CROSS SECTIONS STATION 14+50.00 TO 15+00.00
16	CROSS SECTIONS STATION 16+00.00 TO 17+00.00

CONTACT

VILLAGE OF BURR RIDGE
ENGINEERING DIVISION
CONTACT: DAVID PREISSIG, P.E.
OFFICE: 630-323-4733
FAX: 630-323-4798

BURNS & MCDONNELL
CONTACT: ANTHONY BRYANT, P.E.
OFFICE: 630-724-3200
FAX: 630-724-3201

IDOT
CONTACT: MARILIN SOLOMON
OFFICE: 847-705-4407
FAX: 847-705-4203

COOK COUNTY
CONTACT: BHANU VYAS, P.E.
OFFICE: 312-603-1607
FAX: 312-603-9945

STATE STANDARDS

000001-05	STANDARD SYMBOLS, ABBREVIATIONS AND PATTERNS
424001-05	CURB RAMPS FOR SIDEWALKS
701301-03	LANE CLOSURE, 2L, 2W, SHORT TIME OPERATIONS
701501-05	URBAN LANE CLOSURE, 2L, 2W, UNDIVIDED
701606-06	URBAN LANE CLOSURE, MULTILANE, 2W WITH MOUNTABLE MEDIAN
701701-06	URBAN LANE CLOSURE, MULTILANE INTERSECTION
701801-04	LANE CLOSURE, MULTILANE 1W OR 2W CROSSWALK OR SIDEWALK CLOSURE
701901-01	TRAFFIC CONTROL DEVICES

LENGTH OF PROJECT

PROJECT LENGTH GROSS = 0.35 MILES (1838 FT)
 NET = 0.31 MILES (1619 FT)

DESIGN DESIGNATION - SIDEWALK

TRAFFIC DATA

COUNTY LINE ROAD ADT = 12,000
 SPEED LIMIT = 35

BENCHMARKS

VILLAGE OF BURR RIDGE BENCHMARK #110. SEE SHEET G002 FOR LOCATION AND DESCRIPTION.
 1. STA. 5+65 ON IRON TIE ON OVERHEAD LINE POLE, ELEVATION: 691.51
 2. 445 FT NORTH OF THE END OF CONSTRUCTION ON OVERHEAD LINE POLE, ELEVATION: 702.09

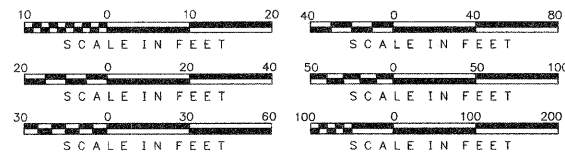

FULL SIZE PLANS HAVE BEEN PREPARED USING STANDARD ENGINEERING SCALES. REDUCED SIZED PLANS WILL NOT CONFORM TO STANDARD SCALES, IN MAKING MEASUREMENT ON REDUCED PLANS, THE ABOVE SCALES MAY BE USED.

CONTRACT NO.: 63253

STATE OF ILLINOIS
 DEPARTMENT OF TRANSPORTATION
 DIVISION OF HIGHWAYS

**PLANS FOR PROPOSED
 FEDERAL AID HIGHWAY**

COUNTY LINE ROAD FAU (2684) (CH W19) SIDEWALK
 PLAINFIELD ROAD (CH B37) TO LONGWOOD DRIVE

91ST STREET TO ASHTON DRIVE

PROJECT NO.: ARA-9003(515)

SECTION NO.: 09-00040-00-SW

VILLAGE OF BURR RIDGE

COOK COUNTY

JOB NO.: C-91-744-09

WARNING



CALL
J.U.L.I.E.
 BEFORE YOU DIG
1-800-892-0123

F.A.P. RTE.	SECTION	COUNTY	TOTAL SHEETS	SHEET NO.
09-00040-00-SW	COOK	16	1	
FEDERAL RD. DIST. NO.		ILLINOIS	FEDERAL AID PROJECT	
CONTRACT: 63253				



LOCATION OF SECTION INDICATED THUS: - [Symbol] -

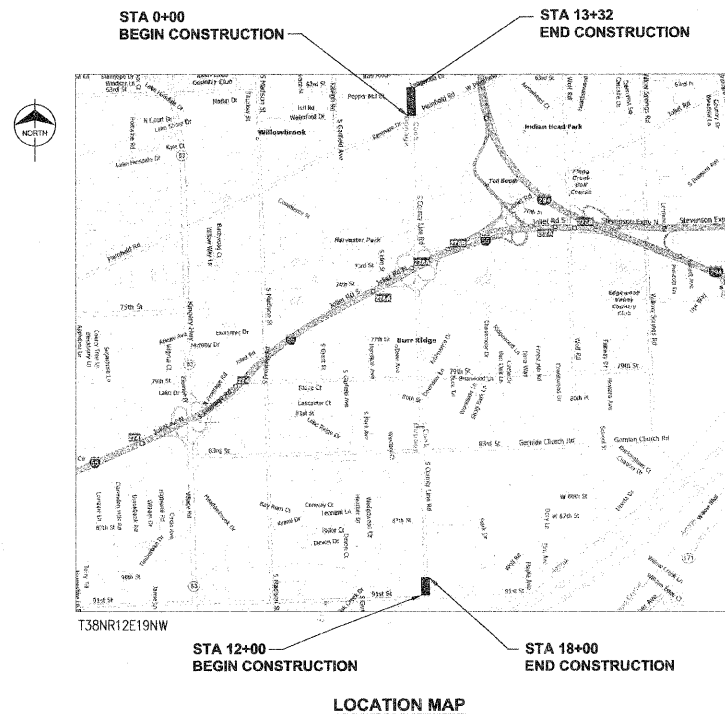

STATE OF ILLINOIS
 DEPARTMENT OF TRANSPORTATION
 DIVISION OF HIGHWAYS

Approved: [Signature]
 DIRECTOR OF PUBLIC WORKS
 Local Agency Position

Passed: SEPTEMBER 1, 2009
 [Signature]
 District Engineer of Local Roads & Streets

Releasing for Bid
 Based on Limited
 Review: SEPTEMBER 1, 2009
 [Signature]
 Deputy of Highways, Region # Engineer



ANTHONY J. BRYANT, P.E.
 NO. 062-056612
 EXP. DATE: 11/30/2009

**PRINTED BY THE AUTHORITY
 OF THE STATE OF ILLINOIS**

IL DESIGN FIRM
 NO. 184-001310



EXPIRES:
 04-30-11