

STATE OF ILLINOIS
DEPARTMENT OF TRANSPORTATION
DIVISION OF HIGHWAYS

PLANS FOR PROPOSED FEDERAL AID HIGHWAY

FAU 1029 (76TH AVENUE)
95TH STREET (FAP 29) TO 103RD STREET (FAU 1573)
LOCAL AGENCY PRESERVATION PROGRAM

STREET RESURFACING
SECTION NO.: 09-00058-00-RS

PROJECT NO.: M-9003 (339)

JOB NO. C-91-655-09

LEAD LOCAL AGENCY : VILLAGE of BRIDGEVIEW

CITY of HICKORY HILLS

COOK COUNTY

RANGE R 12E

F. A. U. NO.	SECTION	COUNTY	TOTAL SHEETS	SHEET NO.
1029	09-00058-00-RS	COOK	15	1
STA. TO STA.				
FED. ROAD DIST. NO. 1		ILLINOIS	FED. AID PROJECT M-9003 (339)	

CONTRACT #63259

INDEX OF SHEETS

- COVER SHEET, INDEX OF SHEETS, & STATE STANDARDS
- SUMMARY OF QUANTITIES, & GENERAL NOTES
- TYPICAL CROSS SECTIONS
- 5. PAVEMENT PLAN
- 7. STRIPING PLAN
- 15. IDOT DISTRICT 1 STANDARD DETAILS

HIGHWAY STANDARDS

000001-05	STANDARD SYMBOLS, ABBREVIATIONS AND PATTERNS
424001-05	CURB RAMPS FOR SIDEWALKS
442201-03	CLASS C AND D PATCHES
602001-01	CATCH BASIN, TYPE A
606001-04	CONCRETE CURB TYPE B AND COMBINATION CONCRETE CURB AND GUTTER
606301-04	PC CONCRETE ISLANDS AND MEDIAN
701606-06	URBAN LANE CLOSURE, MULTILANE, 2W WITH MOUNTABLE MEDIAN
701701-06	URBAN LANE CLOSURE, MULTILANE, INTERSECTION
701801-04	LANE CLOSURE, MULTILANE 1W OR 2W CROSSWALK OR SIDEWALK CLOSURE
701901-01	TRAFFIC CONTROL DEVICES
780001-02	TYPICAL PAVEMENT MARKINGS
781001-03	TYPICAL APPLICATIONS RAISED REFLECTIVE PAVEMENT MARKERS
886001-01	DETECTOR LOOP INSTALLATIONS
886006-01	TYPICAL LAYOUT FOR DETECTION LOOPS

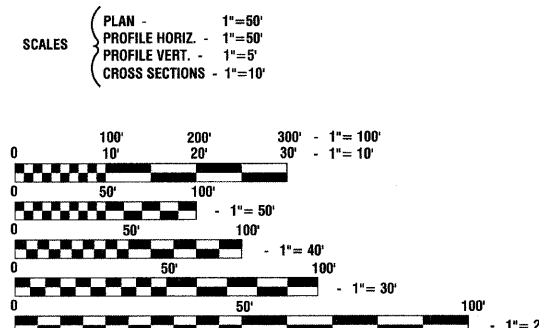
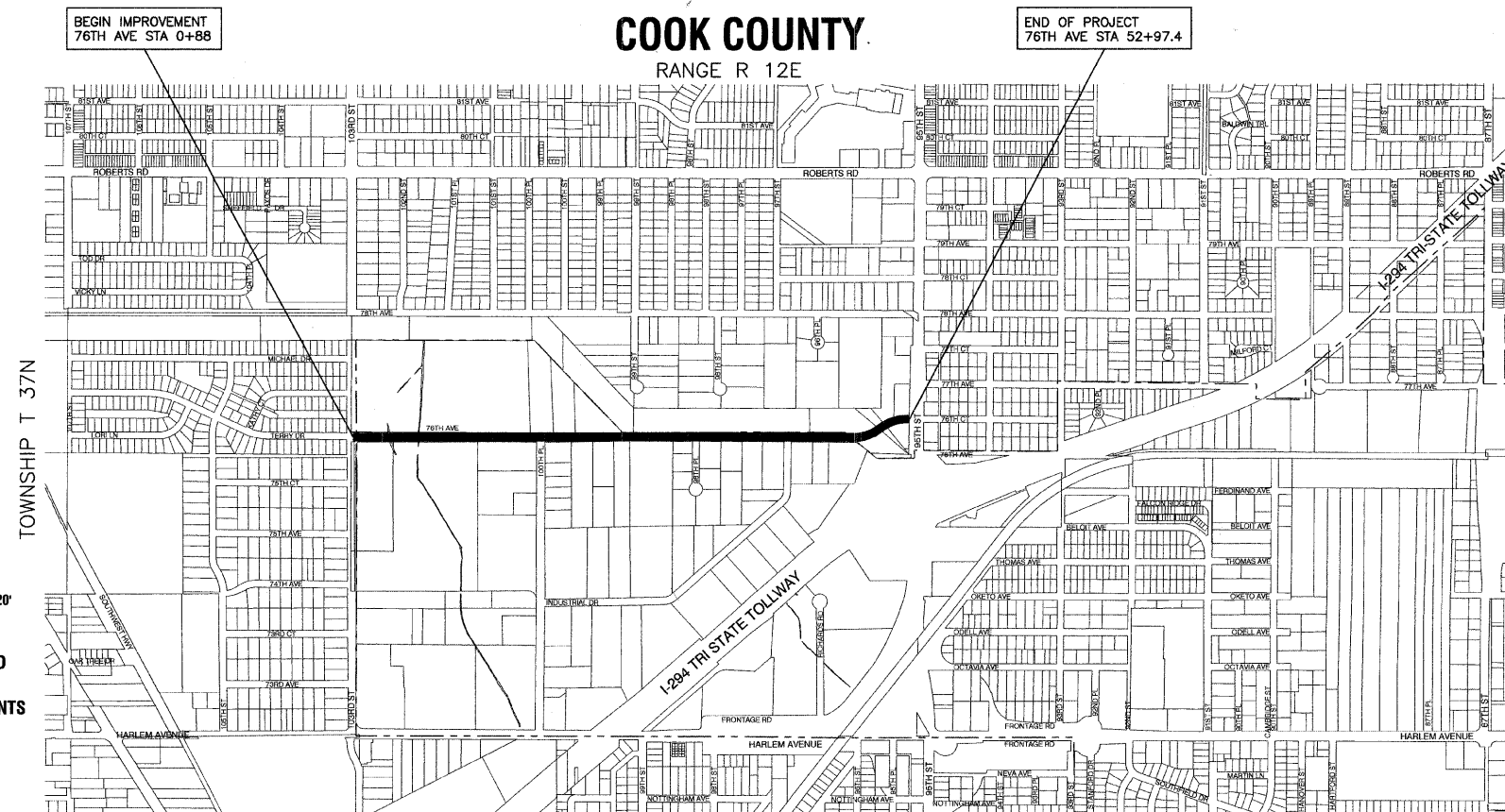
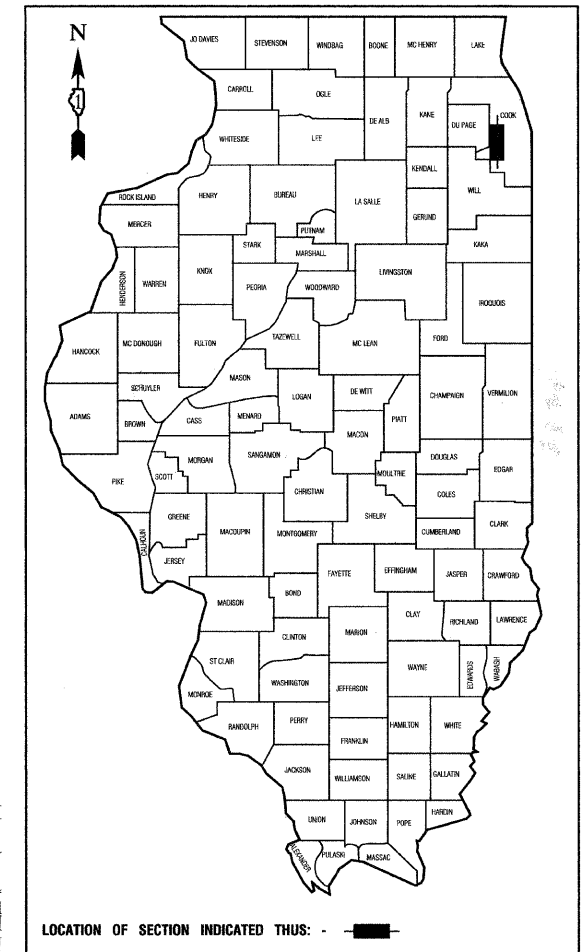

FULL SIZE PLANS HAVE BEEN PREPARED USING STANDARD ENGINEERING SCALES, REDUCED SIZED PLANS WILL NOT CONFORM TO STANDARD SCALES, IN MAKING MEASUREMENTS ON REDUCED PLANS, THE ABOVE SCALES MAY BE USED.

J. U. L. I. E.
JOINT UTILITY LOCATION INFORMATION FOR EXCAVATION
1-800-892-0123 or 811

CONTRACT NO. 63259

LOCATION MAP
GROSS LENGTH=5,209.4 FEET=0.97 MILES
NET LENGTH=5,209.4 FEET=0.97 MILES

76TH AVENUE
ADT=6,000 (2008)
=6,250 (2030)
DESIGN SPEED=30 MPH
SPEED LIMIT=30 MPH

STATE OF ILLINOIS DEPARTMENT OF TRANSPORTATION
DIVISION OF HIGHWAYS

Approved: *[Signature]* 7/28/09
President, Village of Bridgeview

Passed: *[Signature]* SEPTEMBER 1, 2009
District 1 Engineer of Local Roads & Streets

Released for Bid Based on Limited Review: *[Signature]* SEPTEMBER 1, 2009
Deputy Director of Highways, Region 9 Engineer

PRINTED BY THE AUTHORITY OF THE STATE OF ILLINOIS

PREPARED BY OR UNDER THE DIRECT SUPERVISION OF:
[Signature] 7/17/09

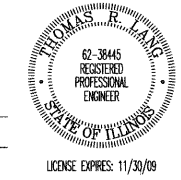

I.D.O.T. FEDERAL AID DESIGN ENGINEER: MELCHOR MANGOBA (847) 705-4408
CONSULTANTS: ROBINSON ENGINEERING, LTD. 708-331-6700

SUMMARY OF QUANTITIES					PAVEMENT	MARKINGS	LANDSCAPE
S.I.	CODE NO.	PAY ITEM	UNIT	QUAN	CONSTRUCTION TYPE CODE		
					1000	SFTY-1D	Y003
	20101700	SUPPLEMENTAL WATERING	UNIT	4			4
	20200100	EARTH EXCAVATION	CU YD	73	73		
	20800150	TRENCH BACKFILL	CU YD	8	8		
	21101615	TOPSOIL, FURNISH AND PLACE, 4"	SQ YD	121			121
	25000400	NITROGEN FERTILIZER NUTRIENTS	POUND	2			2
	25000500	PHOSPHORUS FERTILIZER NUTRIENTS	POUND	2			2
	25000600	POTASSIUM FERTILIZER NUTRIENTS	POUND	2			2
	25200110	SODDING, SALT TOLERANT	SQ YD	121			121
	40201000	AGGREGATE FOR TEMPORARY ACCESS	TON	100	100		
	40600100	BITUMINOUS MATERIALS (PRIME COAT)	GALLON	5565	5565		
	40600300	AGGREGATE (PRIME COAT)	TON	25	25		
	40600625	LEVELING BINDER (MACHINE METHOD), N50	TON	1168	1168		
	40600982	HOT-MIX ASPHALT SURFACE REMOVAL - BUTT JOINT	SQ YD	152	152		
	40603335	HOT-MIX ASPHALT SURFACE COURSE, MIX "D", N50	TON	2407	2407		
	42300300	PORTLAND CEMENT CONCRETE DRIVEWAY PAVEMENT, 7 INCH	SQ YD	156	156		
	42400200	PORTLAND CEMENT CONCRETE SIDEWALK 5 INCH	SQ FT	537	537		
	42400800	DETECTABLE WARNINGS	SQ FT	24	24		
	44000156	HOT-MIX ASPHALT SURFACE REMOVAL, 1 3/4"	SQ YD	26387	26387		
	44000200	DRIVEWAY PAVEMENT REMOVAL	SQ YD	473	473		
	44000300	CURB REMOVAL	FOOT	31	31		
	44000500	COMBINATION CURB AND GUTTER REMOVAL	FOOT	576	576		
	44000600	SIDEWALK REMOVAL	SQ FT	537	537		
	44001700	COMBINATION CURB AND GUTTER REMOVAL AND REPLACEMENT	FOOT	3525	3525		
	44002020	CONCRETE MEDIAN SURFACE REMOVAL	SQ FT	1180	1180		
	44201725	CLASS D PATCHES, TYPE I, 7 INCHES	SQ YD	199	199		
	44201729	CLASS D PATCHES, TYPE II, 7 INCH	SQ YD	125	125		
	44201733	CLASS D PATCHES, TYPE III, 7 INCH	SQ YD	47	47		
	44201735	CLASS D PATCHES, TYPE IV, 7 INCH	SQ YD	1003	1003		
	44201759	CLASS D PATCHES, TYPE IV, 9 INCH	SQ YD	1436	1436		
	550A0330	STORM SEWERS, CLASS A, TYPE 2 10"	FOOT	14	14		
	550A0340	STORM SEWERS, CLASS A, TYPE 2 12"	FOOT	7	7		
	60202705	CATCH BASINS, TYPE A, 4'-DIAMETER, WITH SALVAGED FRAME AND GRATE	EACH	2	2		
	60250200	CATCH BASINS TO BE ADJUSTED	EACH	15	15		
	60252800	CATCH BASINS TO BE RECONSTRUCTED	EACH	3	3		
	60255500	MANHOLES TO BE ADJUSTED	EACH	1	1		
	60300310	FRAMES AND LIDS TO BE ADJUSTED (SPECIAL)	EACH	6	6		
	60500050	REMOVING CATCH BASINS	EACH	2	2		
	60619200	CONCRETE MEDIAN, TYPE SB-6.06	SQ FT	1180	1180		
	67100100	MOBILIZATION	L SUM	1	1		
	70101700	TRAFFIC CONTROL AND PROTECTION	L SUM	1	1		
	70300100	SHORT-TERM PAVEMENT MARKING	FOOT	2904		2904	
*	78000200	THERMOPLASTIC PAVEMENT MARKING - LINE 4"	FOOT	12754		12754	
*	78000600	THERMOPLASTIC PAVEMENT MARKING - LINE 12"	FOOT	15		15	
*	78000650	THERMOPLASTIC PAVEMENT MARKING - LINE 24"	FOOT	89		89	
*	78100100	RAISED REFLECTIVE PAVEMENT MARKER	EACH	400		400	
*	88600600	DETECTOR LOOP REPLACEMENT	FOOT	160	160		
	X0325702	NIGHTTIME WORK ZONE LIGHTING	L SUM	1	1		
	X4400220	CURB REMOVAL AND REPLACEMENT	FOOT	79	79		
	XX006806	HOT-MIX ASPHALT DRIVEWAY PAVEMENT	SQ YD	296	296		

GENERAL NOTES:

- BEFORE STARTING ANY EXCAVATION, THE CONTRACTOR SHALL CALL "J.U.L.I.E." AT (800) 892-0123 AND (312) 744-7000 FOR FIELD LOCATIONS OF BURIED ELECTRIC, TELEPHONE AND GAS UTILITIES. (48 HOUR NOTIFICATION IS REQUIRED).
- UTILITIES INDICATED ON THE PLANS ARE PROVIDED FOR THE CONTRACTORS USE AND ARE BASED UPON INFORMATION AVAILABLE AT THE TIME OF THE ADVERTISEMENT FOR BIDS. THE OWNER AND ENGINEER DO NOT GUARANTEE THE ACCURACY OF UTILITIES INFORMATION.
- IT SHALL BE THE CONTRACTOR'S RESPONSIBILITY TO VERIFY ALL DIMENSIONS AND CONDITIONS EXISTING IN THE FIELD PRIOR TO CONSTRUCTION AND ORDERING OF MATERIALS.
- SCHEDULES INCLUDED IN THE PLANS HAVE BEEN PREPARED FROM FIELD NOTES. EXACT LOCATIONS FOR PATCHING SHALL BE DETERMINED IN THE FIELD BY THE ENGINEER.
- ANY REFERENCE TO STANDARDS THROUGHOUT THE PLANS OR SPECIAL PROVISIONS SHALL BE INTERPRETED TO BE THE LATEST STANDARDS OF THE ILLINOIS DEPARTMENT OF TRANSPORTATION.
- THE THICKNESS OF HMA MIXTURE STATED IN THE SPECIFICATIONS IS THE NOMINAL THICKNESS. DEVIATIONS FROM THE NOMINAL THICKNESS WILL BE PERMITTED WHEN SUCH DEVIATIONS OCCUR DUE TO IRREGULARITIES IN THE EXISTING SURFACE OR BASE ON WHICH THE HMA SURFACE IS PLACED.
- ACCESS TO DRIVEWAYS SHALL BE MAINTAINED AT ALL TIMES BY LIMITING CURB AND GUTTER REPAIR TO ONE-HALF THE DRIVEWAY WIDTH AT ONE TIME AS WELL AS TEMPORARY AGGREGATE.

* - INDICATES SPECIALTY ITEMS

FILE NAME = 08214-QUAN-01 - P01	USER NAME =	DESIGNED -- TRL	REVISIONS --	STATE OF ILLINOIS DEPARTMENT OF TRANSPORTATION	76TH AVENUE STREET RESURFACING 95TH STREET(FAP 29) TO 103RD STREET(FAU 1573) SUMMARY OF QUANTITIES AND GENERAL NOTES			F.A.U. RTE.	SECTION	COUNTY	TOTAL SHEETS	SHEET NO.		
		CHECKED -- TRL	REVISIONS --		SCALE: NONE	SHEET NO. 2	OF 15 SHEETS	STA.	TO STA.	1029	09-00058-00-RS	COOK	15	2
	PLOT SCALE =	DRAWN -- PS	REVISIONS --		CONTRACT NO. 63259									
	PLOT DATE = 7/17/09	CHECKED -- AG	REVISIONS --		FED. ROAD DIST. NO. 1 ILLINOIS FED. AID PROJECT M-9003 (339)									

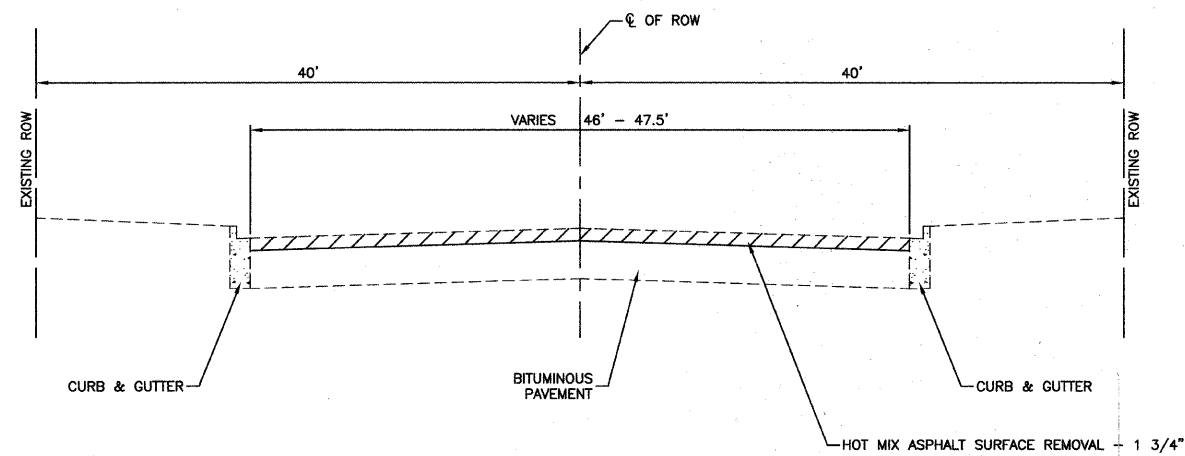

EXISTING TYPICAL SECTION
76TH AVENUE

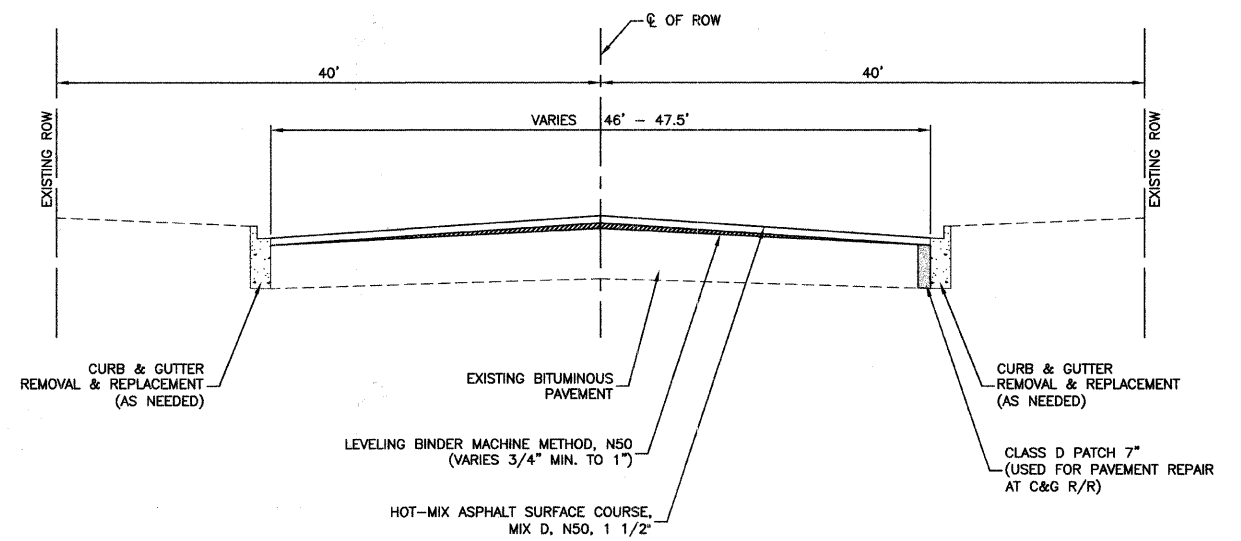

PROPOSED TYPICAL SECTION
76TH AVENUE

NOTE: CONTRACTOR SHALL MILL BEFORE PATCHING

HOT-MIX ASPHALT MIXTURE REQUIREMENTS

MIXTURE TYPE	AIR VOIDS
HOT MIX ASPHALT SURFACE COURSE, MIX "D", N50(IL-9.5mm); 1 1/2"	4% @ 50 Gyr.
LEVELING BINDER (MACHINE METHOD), N50 (IL-9.5mm), VARIES 3/4" MIN TO 1"	4% @ 50 Gyr.
DRIVEWAYS	
HOT MIX ASPHALT SURFACE COURSE, MIX "C", N50(IL-9.5mm); 2"	4% @ 50 Gyr.
HOT MIX ASPHALT BASE COURSE, (HMA BINDER IL-19.0mm); 6"	4% @ 50 Gyr.
PATCHING	
CLASS D PATCHES, TYPE I, II, III, IV (HMA BINDER IL-19.0mm), 7" OR 9"	4% @ 70 Gyr.

NOTE:
THE UNIT WEIGHT USED TO CALCULATE ALL HOT-MIX ASPHALT SURFACE MIXTURE QUANTITIES IS 112 LBS/SY/IN.
THE "AC TYPE" FOR POLYMERIZED HMA MIXES SHALL BE "SBS/SBR PG 70-22" AND FOR NON-POLYMERIZED HMA THE "AC TYPE" SHALL BE "PG 64-22" UNLESS MODIFIED BY DISTRICT ONE SPECIAL PROVISIONS. FOR "PERCENT OF RAP" SEE DISTRICT ONE SPECIAL PROVISIONS.

FILE NAME = 09214-TYPX-01 - IDOT P01	USER NAME =	DESIGNED -- TRL	REVISIONS --	STATE OF ILLINOIS DEPARTMENT OF TRANSPORTATION	76TH AVENUE STREET RESURFACING 95TH STREET (FAP 29) TO 103RD STREET (FAU 1573) TYPICAL CROSS SECTIONS		F.A.U. RTE. 1029	SECTION 09-00058-00-RS	COUNTY COOK	TOTAL SHEETS 15	SHEET NO. 3	
	PLOT SCALE =	DRAWN -- PS	REVISIONS --		SCALE: NONE	SHEET NO. 3	OF 15 SHEETS	STA.	TO STA.	FED. ROAD DIST. NO. 1	ILLINOIS	FED. AID PROJECT M-9003 (339)
	PLOT DATE = 7/17/09	CHECKED -- PS	REVISIONS --		CONTRACT NO. 63259							

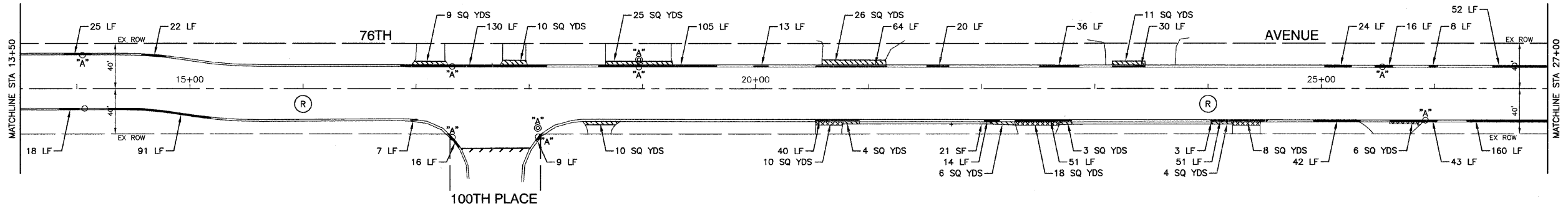
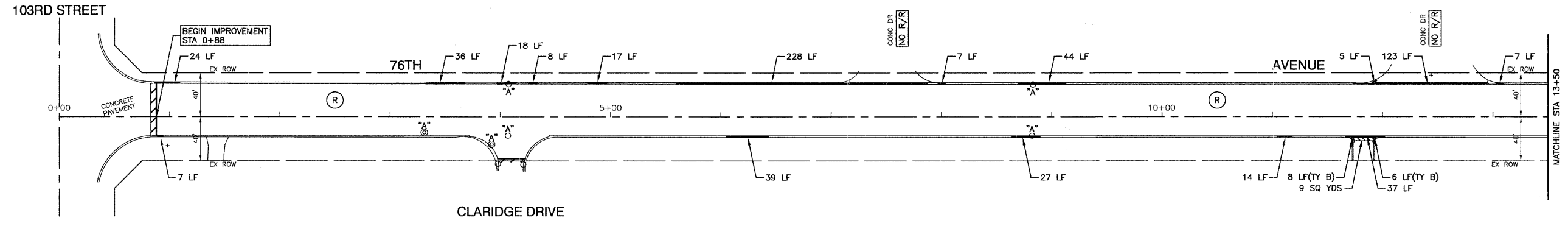
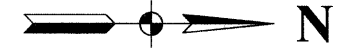

- LEGEND**
- CONCRETE DRIVEWAY REMOVAL AND REPLACEMENT
 - HOT-MIX ASPHALT DRIVEWAY REMOVAL AND REPLACEMENT (SEE SPECIAL PROVISIONS)
 - HOT-MIX ASPHALT SURFACE REMOVAL - BUTT JOINT (SEE SHEET 10 FOR BUTT JOINT DETAIL)
 - CONCRETE SIDEWALK REMOVAL AND REPLACEMENT
 - CONCRETE CURB, CONCRETE CURB AND GUTTER REMOVAL AND REPLACEMENT
 - HOT-MIX ASPHALT SURFACE REMOVAL, 1 3/4" LEVELING BINDER (MACHINE METHOD), N50 3/4" HOT-MIX ASPHALT SURFACE COURSE, MIX "D", N50 1 1/2"
 - STRUCTURE TO BE ADJUSTED
 - STRUCTURE TO BE RECONSTRUCTED

FILE NAME = 08214-PLAN 01 - 801 P01	USER NAME =	DESIGNED - TRL	REVISED -	STATE OF ILLINOIS DEPARTMENT OF TRANSPORTATION	76TH AVENUE STREET RESURFACING 95TH STREET (FAP 29) TO 103RD STREET (FAU 1573) PAVEMENT PLAN		F.A.U. RTE.	SECTION	COUNTY	TOTAL SHEETS	SHEET NO.
	PLOT SCALE =	CHECKED - TRL	REVISED -		1029	09-00058-00-RS	COOK	15	4		
	PLOT DATE = 7/17/09	DRAWN - PS	REVISED -		SCALE: 1"=50' SHEET NO. 4 OF 15 SHEETS STA. 0+00 TO STA. 27+00		CONTRACT NO. 63259		FED. ROAD DIST. NO. 1 ILLINOIS FED. AID PROJECT M-9003 (339)		
		CHECKED - AG	REVISED -								

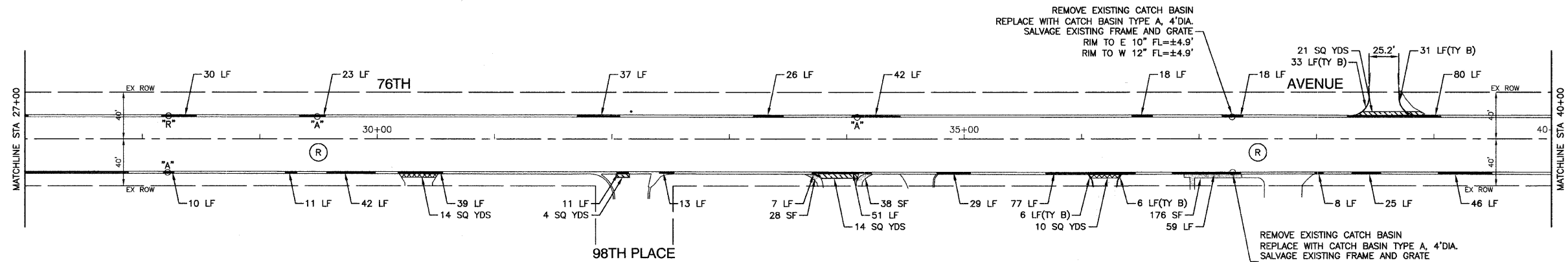
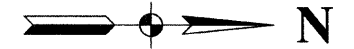

SUGGESTED TRAFFIC CONTROL FOR ISTHA RAMP AREA

1. REMOVE AND REPLACE CURB AND GUTTER ALONG WEST SIDE OF 76TH AVENUE.
2. IN ACCORDANCE W/ STANDARD 701606-06 RE-ROUTE TRAFFIC TO NB LANES, EXCAVATE SB LANES AND PLACE TWO LIFTS OF HMA BINDER (PAID UNDER CLASS D PATCHING TYPE IV, 9 INCH) UNDER NIGHT TIME ROADWAY LIGHTING.
3. IN ACCORDANCE W/ STANDARD 701606-06 RE-ROUTE TRAFFIC TO SB LANES, EXCAVATE NB LANES AND PLACE TWO LIFTS OF HMA BINDER UNDER NIGHT TIME ROADWAY LIGHTING.
4. REMOVE AND REPLACE EXISTING MEDIAN. FULL DEPTH SAWCUTS OF HMA PAVEMENT WILL BE REQUIRED ALONG THE WEST EDGE OF THE NEW MEDIAN AND CONSIDERED INCIDENTAL TO CONCRETE MEDIAN TYPE SB6.06.

NOTES

1. COORDINATION SHALL BE MADE WITH THE ILLINOIS TOLLWAY PRIOR TO WORK BEING DONE IN THE RAMP AREA. CALL (630)241-6800 FOR NOTIFICATION.
2. TOLLWAY RAMPS SHALL REMAIN OPEN AT ALL TIMES.

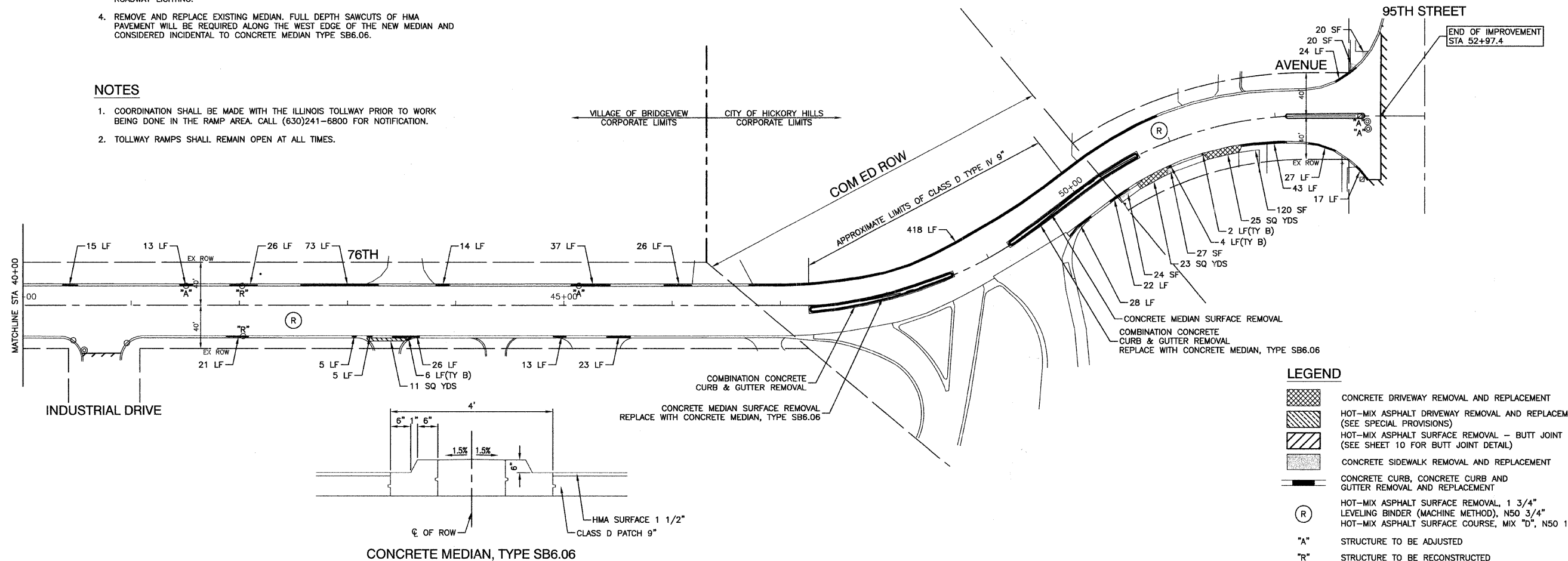

LEGEND

- CONCRETE DRIVEWAY REMOVAL AND REPLACEMENT
- HOT-MIX ASPHALT DRIVEWAY REMOVAL AND REPLACEMENT (SEE SPECIAL PROVISIONS)
- HOT-MIX ASPHALT SURFACE REMOVAL - BUTT JOINT (SEE SHEET 10 FOR BUTT JOINT DETAIL)
- CONCRETE SIDEWALK REMOVAL AND REPLACEMENT
- CONCRETE CURB, CONCRETE CURB AND GUTTER REMOVAL AND REPLACEMENT
- HOT-MIX ASPHALT SURFACE REMOVAL, 1 3/4\"/>

FILE NAME = 09214-PLAN-01 - IDOT P02	USER NAME =	DESIGNED -- TRL	REVISED --	STATE OF ILLINOIS DEPARTMENT OF TRANSPORTATION	76TH AVENUE STREET RESURFACING 95TH STREET (FAP 29) TO 103RD STREET (FAU 1573) PAVEMENT PLAN	F.A.U. RTE.	SECTION	COUNTY	TOTAL SHEETS	SHEET NO.	
	PLOT SCALE =	CHECKED -- TRL	REVISED --			1029	09-00058-00-RS	COOK	15	5	
PLOT DATE = 7/17/09	DRAWN -- PS	CHECKED -- AG	REVISED --	SCALE: 1"=50'	SHEET NO. 5 OF 15 SHEETS	STA. 27+00	TO STA. 53+38	CONTRACT NO. 63259			
						FED. ROAD DIST. NO. 1 ILLINOIS			FED. AID PROJECT M-9003 (339)		

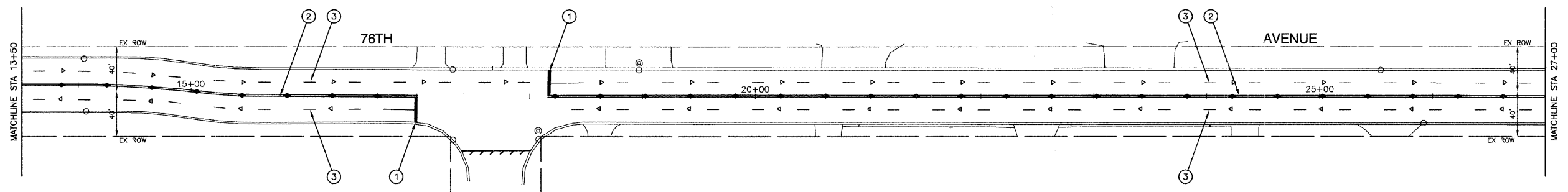
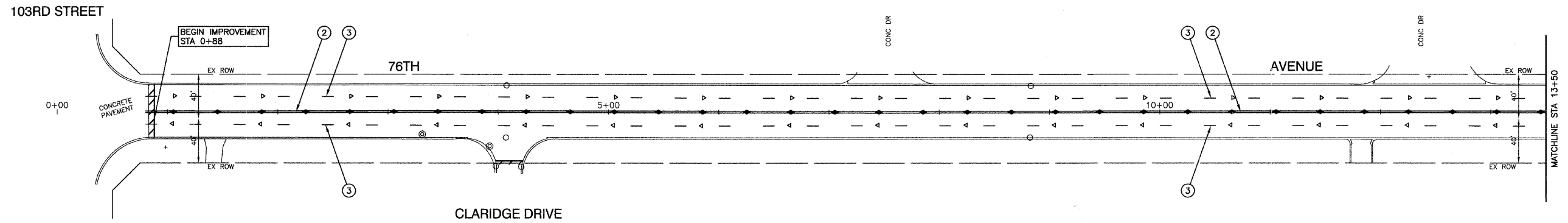
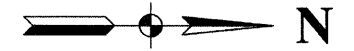

PAVEMENT MARKING LEGEND

- ① 24" WHITE STOP BAR
- ② 4" DOUBLE YELLOW CENTERLINE (11" C/C)
- ③ 4" WHITE SKIP - DASH LINE (10' LINE - 30' SPACE)
- ④ 4" YELLOW MEDIAN OUTLINE
- ⑤ 12" YELLOW DIAGONAL LINE (50' C/C)
- ▲ ONE-WAY AMBER MARKER
40' C/C UNLESS OTHERWISE INDICATED
- ◄ ONE-WAY CRYSTAL MARKER
80' C/C UNLESS OTHERWISE INDICATED
- ◆ TWO-WAY AMBER MARKER
40' C/C UNLESS OTHERWISE INDICATED

NOTE
SEE IDOT STANDARD TC-11 AND TC-13 FOR RAISED REFLECTIVE MARKER AND PAVEMENT MARKING DETAILS.
ALL PAVEMENT MARKING IS THERMOPLASTIC.

FILE NAME = 08214-PLAN-01 - IDOT PMKG01	USER NAME =	DESIGNED -- TRL	REVISION --
		CHECKED -- TRL	REVISION --
	PLOT SCALE =	DRAWN -- PS	REVISION --
	PLOT DATE = 7/17/09	CHECKED -- AG	REVISION --

STATE OF ILLINOIS
DEPARTMENT OF TRANSPORTATION

76TH AVENUE STREET RESURFACING 95TH STREET (FAP 29) TO 103RD STREET (FAU 1573) STRIPING PLAN		F.A.U. RTE. 1029	SECTION 09-00058-00-RS	COUNTY COOK	TOTAL SHEETS 15	SHEET NO. 6
SCALE: 1"=50'	SHEET NO. 6 OF 15 SHEETS	STA. 0+00	TO STA. 27+00	CONTRACT NO. 63259		
		FED. ROAD DIST. NO. 1	ILLINOIS	FED. AID PROJECT M-9003 (339)		

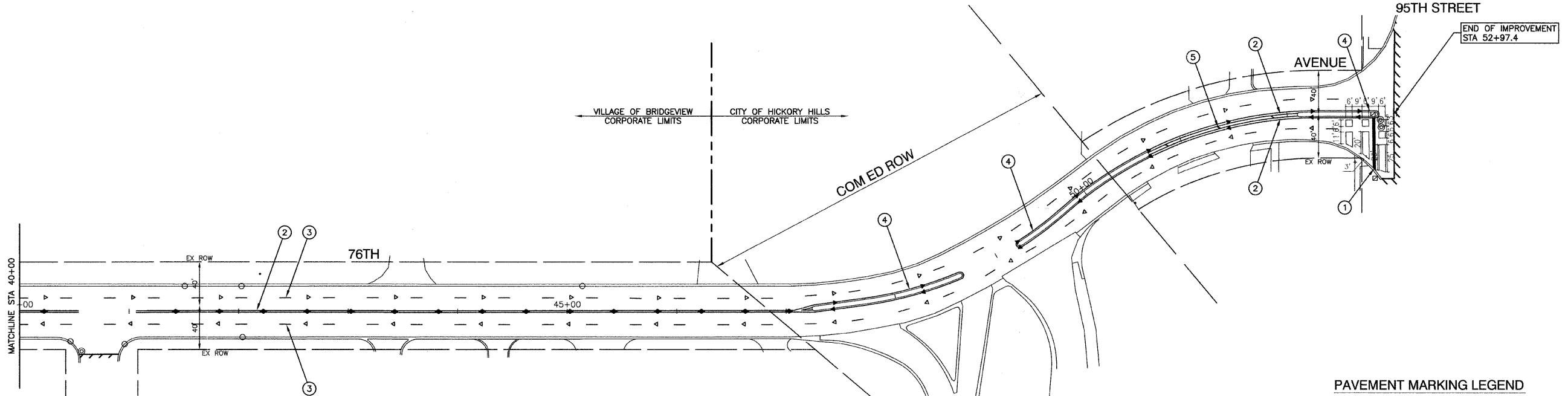
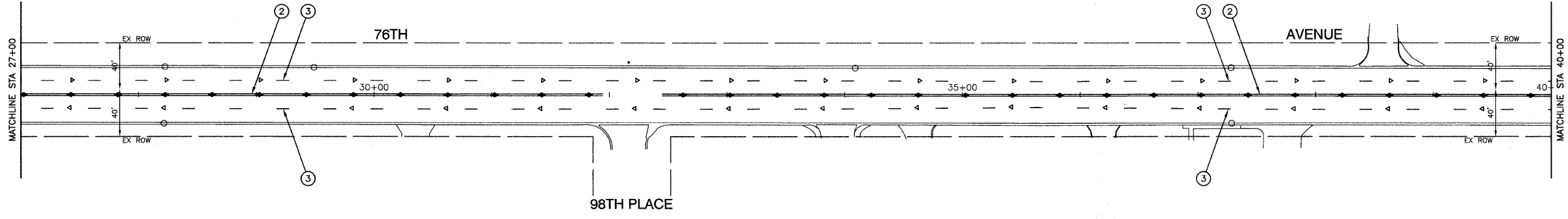

PAVEMENT MARKING LEGEND

- ① 24" WHITE STOP BAR
- ② 4" DOUBLE YELLOW CENTERLINE (11" C/C)
- ③ 4" WHITE SKIP - DASH LINE (10' LINE - 30' SPACE)
- ④ 4" YELLOW MEDIAN OUTLINE
- ⑤ 12" YELLOW DIAGONAL LINE (50' C/C)
- ◀ ONE-WAY AMBER MARKER
40' C/C UNLESS OTHERWISE INDICATED
- ◄ ONE-WAY CRYSTAL MARKER
80' C/C UNLESS OTHERWISE INDICATED
- ◆ TWO-WAY AMBER MARKER
40' C/C UNLESS OTHERWISE INDICATED

NOTE
SEE IDOT STANDARD TC-11 AND TC-13 FOR RAISED REFLECTIVE MARKER AND PAVEMENT MARKING DETAILS.
ALL PAVEMENT MARKING IS THERMOPLASTIC.

FILE NAME = 09214-PLAN-01 - IDOT PMKG02	USER NAME =	DESIGNED -- TRL	REVISED --
		CHECKED -- TRL	REVISED --
	PLOT SCALE =	DRAWN -- PS	REVISED --
	PLOT DATE = 7/17/09	CHECKED -- AG	REVISED --

**STATE OF ILLINOIS
DEPARTMENT OF TRANSPORTATION**

76TH AVENUE STREET RESURFACING 95TH STREET (FAP 29) TO 103RD STREET (FAU 1573) STRIPING PLAN			
SCALE: 1"=50'	SHEET NO. 7	OF 15 SHEETS	STA. 27+00 TO STA. 53+38

F.A.U. RTE. 1029	SECTION 09-00058-00-RS	COUNTY COOK	TOTAL SHEETS 15	SHEET NO. 7
CONTRACT NO. 63259				
FED. ROAD DIST. NO. 1 ILLINOIS FED. AID PROJECT M-9003 (339)				

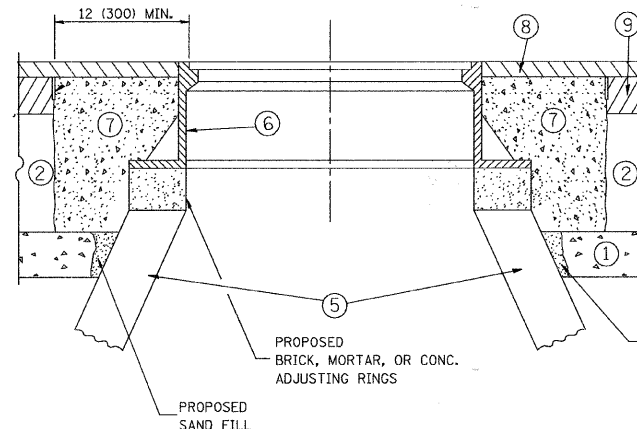
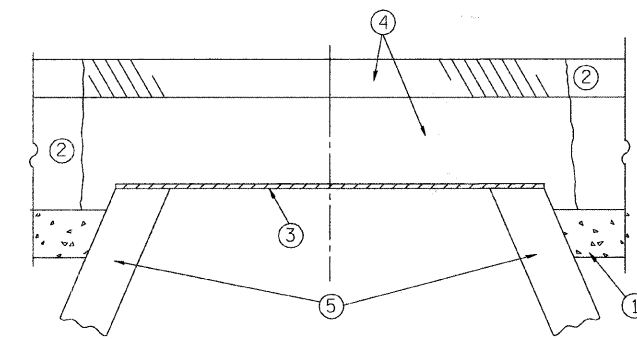

CONSTRUCTION PROCEDURES

STAGE 1 (BEFORE PAVEMENT MILLING)

- A) REMOVE A MINIMUM OF 12 (300) OF THE PAVEMENT FROM AROUND THE STRUCTURE.
- B) REMOVE THE EXISTING FRAME AND LID FROM THE STRUCTURE.
- C) COVER THE STRUCTURE OPENING WITH A 36 (900) DIAMETER METAL PLATE.
- D) BACKFILL WITH CRUSHED STONE AND A MINIMUM 1 1/2 (40) THICK HMA SURFACE MIX APPROVED BY THE ENGINEER.

STAGE 2 (AFTER PAVEMENT MILLING)

- A) REMOVE THE HMA SURFACE MIX AND CRUSHED STONE.
- B) INSTALL THE FRAME AND LID; ADJUST THE FRAME TO ITS FINAL SURFACE ELEVATION.
- C) THE SURROUNDING SPACE SHALL BE FILLED WITH CLASS SI CONCRETE, OR HMA SURFACE COURSE OR HMA BINDER COURSE TO THE ELEVATION OF THE SURFACE OF THE EXISTING BASE COURSE OR THE BINDER COURSE.

THE PROCEDURE EXPLAINED ABOVE SHALL CONFORM TO THE APPLICABLE PORTIONS OF SECTIONS 353, 406, 602, AND 603 OF THE STANDARD SPECIFICATIONS.

LEGEND

- ① SUB-BASE GRANULAR MATERIAL
- ② EXISTING PAVEMENT
- ③ 36 (900) DIAMETER METAL PLATE
- ④ PROPOSED CRUSHED STONE AND HMA SURFACE MIX
- ⑤ EXISTING STRUCTURE
- ⑥ FRAME AND LID (SEE NOTES)
- ⑦ CLASS SI CONCRETE, HMA SURFACE COURSE OR HMA BINDER COURSE
- ⑧ PROPOSED HMA SURFACE COURSE
- ⑨ PROPOSED HMA BINDER COURSE

LOCATION OF STRUCTURES:

THE CONTRACTOR WILL BE REQUIRED TO KEEP A RECORD OF THE LOCATIONS OF THE BURIED STRUCTURES ACCORDING TO THE STATION AND DISTANCE LEFT OR RIGHT OF THE CENTERLINE OF PAVEMENT. UPON COMPLETION OF THE WORK, THE CONTRACTOR WILL DELIVER THE RECORD TO THE ENGINEER.

BASIS OF PAYMENT: THIS WORK WILL BE PAID FOR AT THE CONTRACT UNIT PRICE PER EACH FOR "FRAMES AND LIDS TO BE ADJUSTED, SPECIAL"

NEW FRAMES AND LIDS, WHEN SPECIFIED, WILL BE PAID FOR SEPARATELY.

NOTES:

EXISTING BROKEN FRAMES AND LIDS SHALL BE REMOVED AND DISPOSED OF BY THE CONTRACTOR AND SHALL BE REPLACED AS DIRECTED BY THE ENGINEER. REPLACEMENT FRAMES AND LIDS WILL BE PAID FOR IN ACCORDANCE WITH ARTICLE 109.04 OF THE STANDARD SPECIFICATIONS UNLESS A SEPARATE PAY ITEM HAS BEEN PROVIDED.

IF THE EXISTING LIDS ARE OPEN, THE FRAME WILL BE ADJUSTED TO THE ELEVATION OF THE MILLED PAVEMENT SURFACE PRIOR TO THE MILLING OPERATION. THE FRAME WILL NOT BE REMOVED AND COVERED BY THE METAL PLATE.

CITY OF CHICAGO CASTINGS ARE THE PROPERTY OF THE CITY AND THE CONTRACTOR SHALL NOTIFY THE CITY FOR REMOVAL AND DISPOSITION OF THE CASTINGS.

THE METAL PLATE USED TO COVER THE STRUCTURE SHALL REMAIN THE PROPERTY OF THE CONTRACTOR.

WHEN STRUCTURES ARE TO BE ADJUSTED OR RECONSTRUCTED, THE LOWERING AND RAISING OF THE FRAMES AND LIDS WILL NOT BE PAID FOR SEPARATELY BUT WILL BE INCLUDED IN THE COST OF THE CORRESPONDING PAY ITEM.

DETAILS FOR FRAMES AND LIDS ADJUSTMENT WITH MILLING

ALL DIMENSIONS ARE IN INCHES (MILLIMETERS) UNLESS OTHERWISE SHOWN

FILE NAME = 09214-DTIS-05 - BD-08	USER NAME = geglienobt	DESIGNED — R. SHAH	REVISED —R. SHAH 03-10-95
		CHECKED —	REVISED — A. ABBAS 03-21-97
	PLOT SCALE = 50.0000' / IN.	DRAWN —	REVISED —R. WIEDEMAN 05-14-04
	PLOT DATE = 1/4/2008	CHECKED — 10-25-94	REVISED — R. BORO 01-01-07

STATE OF ILLINOIS
DEPARTMENT OF TRANSPORTATION

DETAILS FOR FRAMES AND LIDS ADJUSTMENT WITH MILLING			
SCALE:	SHEET NO. 8 OF 15 SHEETS	STA.	TO STA.

F.A.U. RTE.	SECTION	COUNTY	TOTAL SHEETS	SHEET NO.
1029	09-00058-00-RS	COOK	15	8
BD600-03 (BD-8)			CONTRACT NO. 63259	
FED. ROAD DIST. NO. 1	ILLINOIS	FED. AID PROJECT	M-9003 (339)	

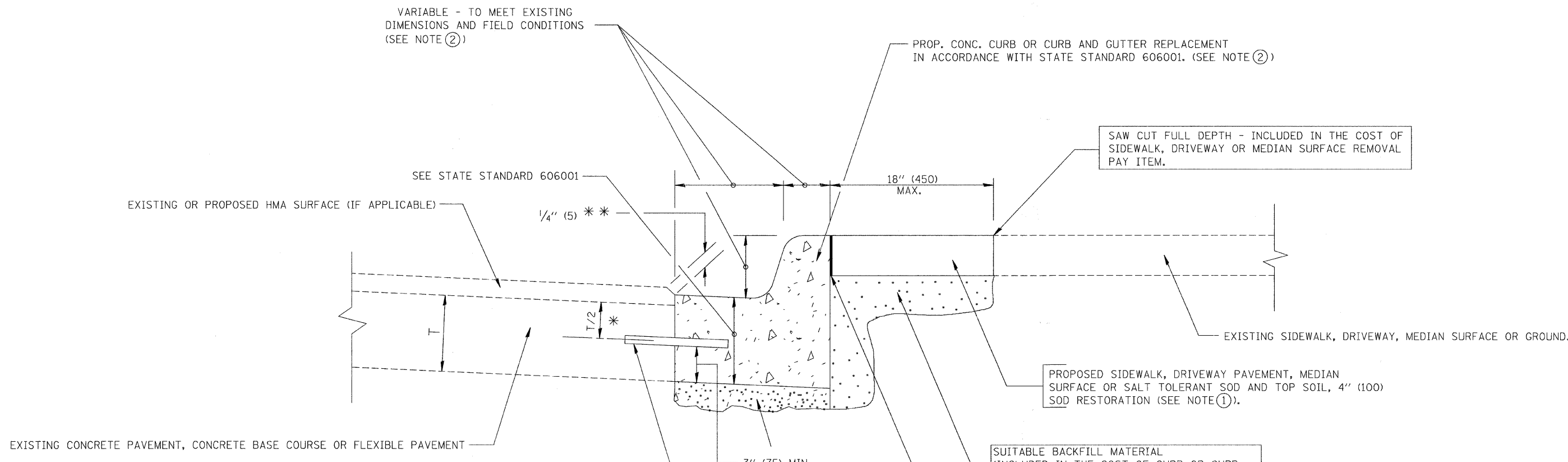

- * 3" (75) MINIMUM FROM TOP AND BOTTOM OF THE CONCRETE PAVEMENT OR BASE COURSE.
- ** IF THE FINAL SURFACE OF THE PAVEMENT IS CONCRETE, THE GUTTER IS TO BE FLUSH WITH THE PAVEMENT.

NOTE: ① SIDEWALK, DRIVEWAY PAVEMENT OR MEDIAN SURFACE SHALL BE SIMILAR TO THE MATERIAL BEING REMOVED AND WILL BE PAID FOR SEPARATELY.

SALT TOLERANT SOD AND TOP SOIL, 4" (100) RESTORATION WILL NOT BE PAID FOR SEPARATELY, BUT SHALL BE INCLUDED IN THE COST OF CURB OR CURB AND GUTTER REMOVAL AND REPLACEMENT.

- ② CURB OR CURB AND GUTTER REPLACEMENT SHALL MATCH THE SHAPE OF THE EXISTING CURB OR CURB AND GUTTER UNLESS OTHERWISE SPECIFIED.
- ③ FOR CURB OR CURB AND GUTTER REMOVAL AND REPLACEMENT ADJACENT TO FLEXIBLE PAVEMENT DELETE EPOXY COATED TIE BARS.
- ④ LONGITUDINAL BARS, IF ENCOUNTERED IN THE EXISTING CURB OR CURB AND GUTTER, ARE NOT TO BE REPLACED. CUTTING AND REMOVING LONGITUDINAL BARS SHALL BE INCLUDED IN THE COST OF CURB OR CURB AND GUTTER REMOVAL AND REPLACEMENT.
- ⑤ THE COST OF HMA SURFACE REMOVAL IN THE EXISTING GUTTER FLAG SHALL BE INCLUDED IN THE COST OF THE CURB AND GUTTER REMOVAL AND REPLACEMENT.
- ⑥ THE REMOVAL AND REPLACEMENT OF THE EXISTING CURB OR CURB AND GUTTER SHALL BE DONE IN ACCORDANCE WITH THE APPLICABLE PORTIONS OF SECTION 440 AND 606 OF THE STANDARD SPECIFICATIONS.
- ⑦ THE LOCATIONS OF REMOVAL AND REPLACEMENT OF EXISTING CURB OR CURB AND GUTTER SHALL BE DETERMINED BY THE RESIDENT ENGINEER AT THE TIME OF CONSTRUCTION.

UNSUITABLE SUB-BASE MATERIAL TO BE REMOVED, IF DIRECTED BY THE ENGINEER, SHALL BE REPLACED WITH EITHER SUB-BASE GRANULAR MATERIAL, TYPE B OR ADDITIONAL THICKNESS OF CONCRETE.

REMOVAL AND REPLACEMENT 4" (100) OR LESS IS INCLUDED IN THE COST OF CURB OR CURB AND GUTTER REMOVAL AND REPLACEMENT.

REMOVAL AND REPLACEMENT IN EXCESS OF 4" (100) WILL BE PAID FOR IN ACCORDANCE WITH ARTICLE 109.04 OF THE STANDARD SPECIFICATIONS.

PROPOSED #6 (20) EPOXY COATED TIE BARS 24" (600) LONG AT 24" (600) CENTERS WILL NOT BE PAID FOR SEPARATELY. DELETE EPOXY COATED TIE BARS IF EXISTING TIE BARS ARE USABLE AS DETERMINED BY THE ENGINEER. (SEE NOTE ③).

BASIS OF PAYMENT:
THIS WORK WILL BE PAID FOR AT THE CONTRACT UNIT PRICE PER FOOT (METER) FOR "CURB REMOVAL AND REPLACEMENT" OR "COMBINATION CONCRETE CURB AND GUTTER REMOVAL AND REPLACEMENT".

CURB OR CURB AND GUTTER REMOVAL AND REPLACEMENT

ALL DIMENSIONS ARE IN INCHES (MILLIMETERS) UNLESS OTHERWISE SHOWN.

FILE NAME = 08214-DTIS-03 - BD-24	USER NAME = geglianobt	DESIGNED - A. HOUSEH	REVISED - R. SHAH 10-03-96	STATE OF ILLINOIS DEPARTMENT OF TRANSPORTATION	CURB OR CURB AND GUTTER REMOVAL AND REPLACEMENT	F.A.U. RTE. 1029	SECTION 09-00058-00-RS	COUNTY COOK	TOTAL SHEETS 15	SHEET NO. 9
	PLOT SCALE = 50.000' / IN.	DRAWN -	REVISED - M. GOMEZ 01-22-01			BD600-06 (BD-24)		CONTRACT NO. 63259		
	PLOT DATE = 1/4/2008	CHECKED - 03-11-94	REVISED - R. BORO 01-01-07		SCALE:	SHEET NO. 9	OF 15 SHEETS	STA.	TO STA.	FED. ROAD DIST. NO. 1 ILLINOIS FED. AID PROJECT M-9003 (339)

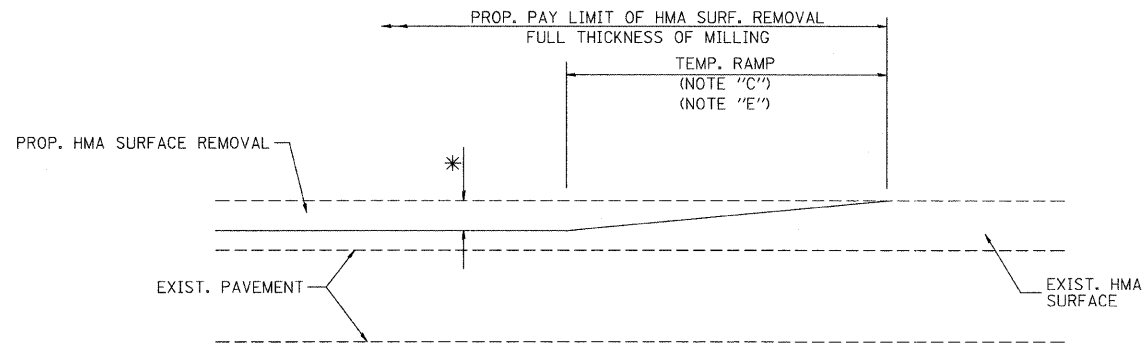

MILLED TEMPORARY RAMP
(FOR BUTT JOINT AND HMA TAPER SEE DETAIL BELOW)

OPTION 1

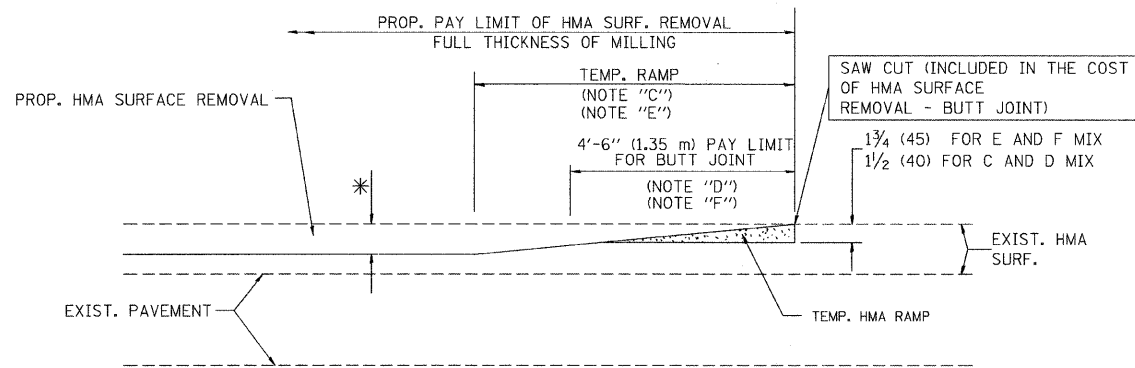

HMA CONSTRUCTED TEMPORARY RAMP
(FOR BUTT JOINT AND HMA TAPER SEE DETAIL BELOW)

OPTION 2

TYPICAL TEMPORARY RAMP

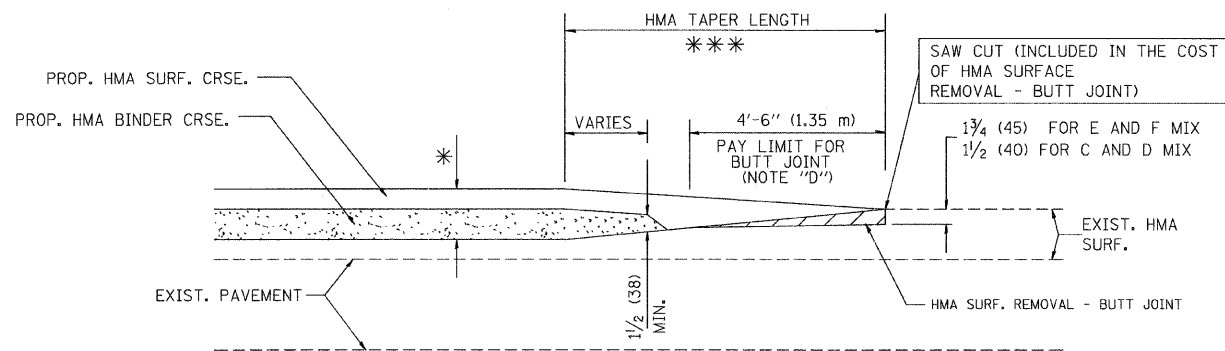

BUTT JOINT AND HMA TAPER

TYPICAL BUTT JOINT AND HMA TAPER
FOR MILLING AND RESURFACING

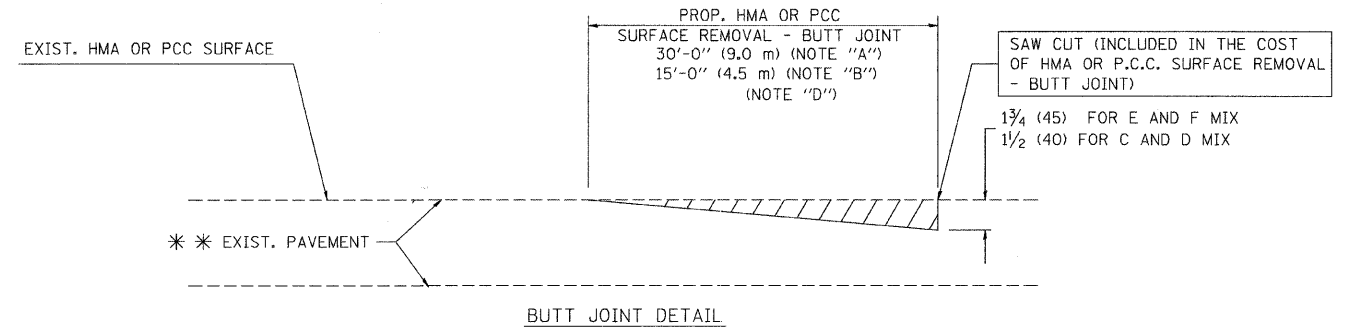

BUTT JOINT DETAIL

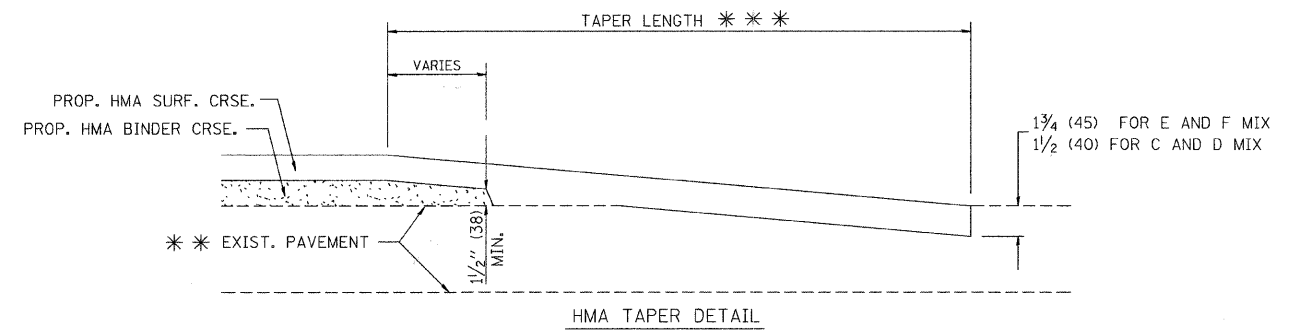

HMA TAPER DETAIL

TYPICAL BUTT JOINT AND HMA TAPER
FOR RESURFACING ONLY

* * * PC CONCRETE, HMA OR HMA RESURFACED PAVEMENT.

NOTES

- A: MAINLINE ROADWAYS AND MAJOR SIDE ROADS.
 - B: MINOR SIDE ROADS.
 - C: THE TEMP. RAMP SHALL BE CONSTRUCTED IMMEDIATELY UPON REMOVAL OF THE EXISTING HMA SURFACE.
 - D: THE BUTT JOINT SHALL BE CONSTRUCTED IMMEDIATELY PRIOR TO PLACING THE PROPOSED HMA COURSES.
 - E: TAPER THE TEMP. RAMP AT A RATE OF 3'-0" (900 mm) PER 1 INCH (25 mm) OF MILLING THICKNESS.
 - F: INSTALLATION AND REMOVAL OF THE 4'-6" (1.35 m) TEMP. RAMP IS INCLUDED IN COST OF HMA SURFACE REMOVAL - BUTT JOINT
 - G: SEE ARTICLE 406.08 AND 406.14 OF THE STANDARD SPECIFICATIONS FOR "HMA AND/OR PCC SURFACE REMOVAL, BUTT JOINT".
- * SEE TYPICAL SECTIONS FOR MILLING THICKNESS.
- * * * 20'-0" (6.1 m) PER 1 (25) RESURFACING (NOTE "A")
10'-0" (3.0 m) PER 1 (25) RESURFACING (NOTE "B")

BASIS OF PAYMENT:

THE BUTT JOINT WILL BE PAID FOR AT THE CONTRACT UNIT PRICE PER SQUARE YARD (SQUARE METER) FOR "HOT-MIX ASPHALT SURFACE REMOVAL - BUTT JOINT" OR FOR "PORTLAND CEMENT CONCRETE SURFACE REMOVAL - BUTT JOINT".

ALL DIMENSIONS ARE IN INCHES (MILLIMETERS) UNLESS OTHERWISE SHOWN.

FILE NAME = 00214-DTLS 04 - BD 32	USER NAME = geglennob	DESIGNED -- M. DE YONG	REVISED -- R. SHAH 10-25-94
		CHECKED --	REVISED -- A. ABBAS 03-21-97
PLOT SCALE = 50,0000' / IN.		DRAWN --	REVISED -- M. GOMEZ 04-06-01
PLOT DATE = 1/4/2008		CHECKED -- 06-13-90	REVISED -- R. BORO 01-01-07

STATE OF ILLINOIS
DEPARTMENT OF TRANSPORTATION

SCALE: SHEET NO. 10 OF 15 SHEETS STA. TO STA.		BUTT JOINT AND HMA TAPER DETAILS		F.A.U. RTE. 1029	SECTION 09-00058-00-RS	COUNTY COOK	TOTAL SHEETS 15	SHEET NO. 10
				BD400-05 BD32		CONTRACT NO. 63259		
				FED. ROAD DIST. NO. 1 ILLINOIS FED. AID PROJECT M-9003 (339)				

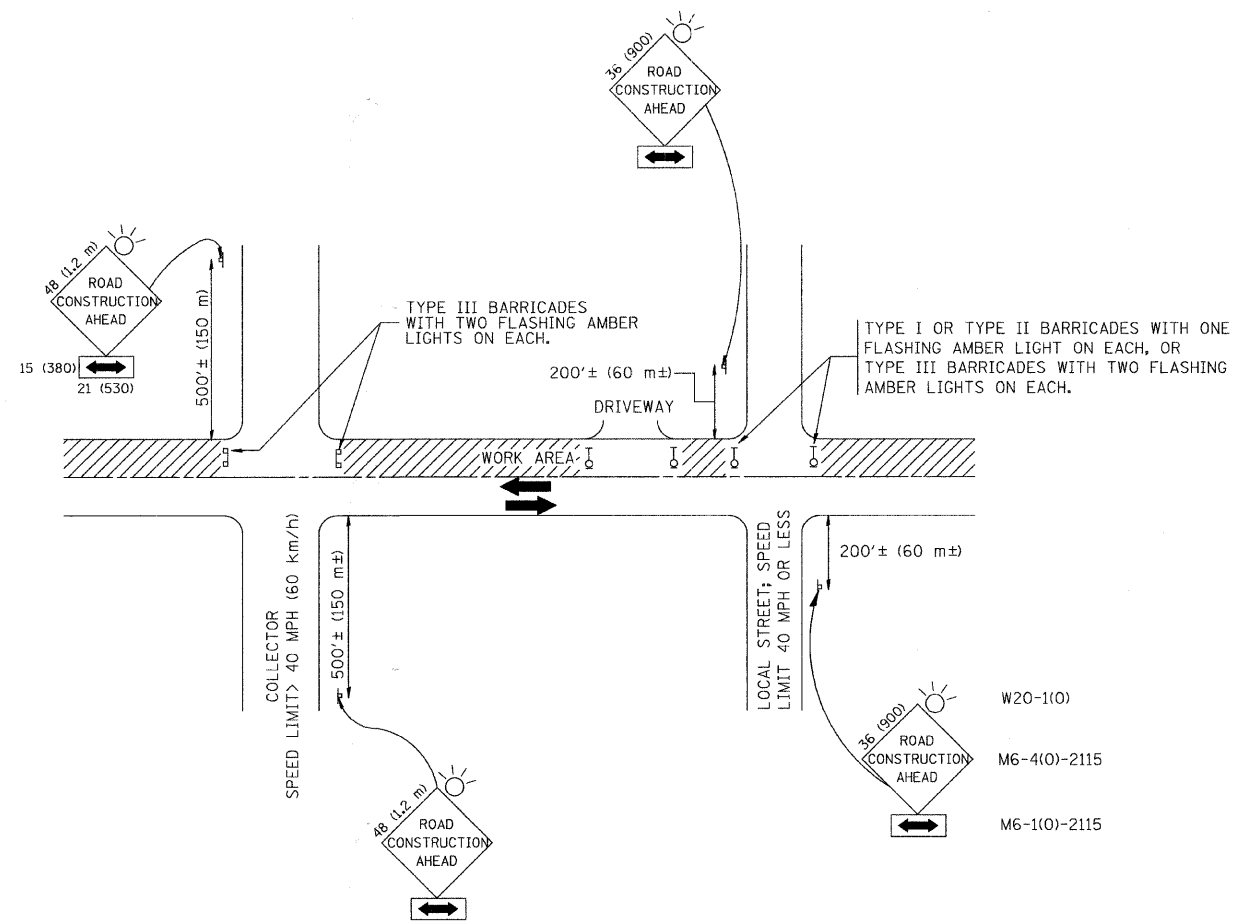

TRAFFIC CONTROL AND PROTECTION FOR SIDE ROADS, INTERSECTIONS, AND DRIVEWAYS

NOTES:

- A. FOR NO LANE RESTRICTION ON THE SIDE ROAD OR DRIVEWAYS
 1. SIDE ROAD WITH A SPEED LIMIT OF 40 MPH (60 km/h) OR LESS AS SHOWN ON THE DRAWING AND AS DIRECTED BY THE ENGINEER:
 - a) ONE **ROAD CONSTRUCTION AHEAD** SIGN 36 x 36 (900x900) WITH A FLASHER AND FLAG MOUNTED ON IT APPROXIMATELY 200' (60 m) IN ADVANCE OF THE MAIN ROUTE.
 - b) THE CLOSED PORTION OF THE MAIN ROUTE SHALL BE PROTECTED BY BLOCKING WITH TYPE I, TYPE II OR TYPE III BARRICADES, 1/3 OF THE CROSS SECTION OF THE CLOSED PORTION.
 2. SIDE ROAD WITH A SPEED LIMIT GREATER THAN 40 MPH (60 km/h) AS SHOWN ON THE DRAWING AND AS DIRECTED BY THE ENGINEER:
 - a) ONE **ROAD CONSTRUCTION AHEAD** SIGN 48 x 48 (1.2 m x 1.2 m) WITH A FLASHER MOUNTED ON IT APPROXIMATELY 500' (150 m) IN ADVANCE OF THE MAIN ROUTE.
 - b) THE CLOSED PORTION OF THE MAIN ROUTE SHALL BE PROTECTED BY BLOCKING WITH TYPE III BARRICADES, 1/2 OF THE CROSS SECTION OF THE CLOSED PORTION.
 3. WHEN THE SIDE ROAD LIES BETWEEN THE BEGINNING OF THE MAINLINE SIGNING AND THE WORK ZONE, A SINGLE HEADED ARROW (M6-1) SHALL BE USED IN LIEU OF THE DOUBLE HEADED ARROW (M6-4).
- B. FOR A LANE CLOSURE ON A SIDE ROAD OR DRIVEWAY:

USE APPLICABLE PORTIONS OF THE TYPICAL APPLICATION OF TRAFFIC CONTROL DEVICES (STD. 701501, STD. 701606 OR THE APPROPRIATE STANDARD). THE SPACING OF SIGNS AND BARRICADES SHALL BE ADJUSTED FOR FIELD CONDITIONS AS DIRECTED BY THE ENGINEER. THE DIRECTIONAL ARROW SHALL BE COVERED OR REMOVED WHEN NO LONGER CONSISTENT WITH THE SIDE ROAD LANE CLOSURE.
- C. ADVANCE WARNING SIGNS ARE TO BE OMITTED ON DRIVEWAY UNLESS OTHERWISE NOTED.
- D. THE TRAFFIC CONTROL AND PROTECTION FOR SIDE ROADS, INTERSECTIONS, AND DRIVEWAYS SHALL BE INCIDENTAL TO THE COST OF SPECIFIED TRAFFIC CONTROL STANDARDS OR ITEMS.

All dimensions are in millimeters (inches) unless otherwise shown.

FILE NAME = 00214-DTIS-01 - TC-10	USER NAME = geglanoht	DESIGNED -- LHA	REVISED -- J. OBERLE 10-18-95
		CHECKED --	REVISED -- A. HOUSEH 03-06-96
PLOT SCALE = 50,000 / IN.		DRAWN --	REVISED -- A. HOUSEH 10-15-96
PLOT DATE = 1/4/2008		CHECKED -- 06-89	REVISED -- T. RAMMACHER 01-06-00

STATE OF ILLINOIS
DEPARTMENT OF TRANSPORTATION

TRAFFIC CONTROL AND PROTECTION FOR SIDE ROADS, INTERSECTIONS, AND DRIVEWAYS		F.A.U. RTE.	SECTION	COUNTY	TOTAL SHEETS	SHEET NO.
		1029	09-00058-00-RS	COOK	15	11
SCALE:		SHEET NO. 11 OF 15 SHEETS		STA.	TO STA.	
		TC-10		CONTRACT NO. 63259		
		FED. ROAD DIST. NO. 1 ILLINOIS		FED. AID PROJECT M-9003 (339)		

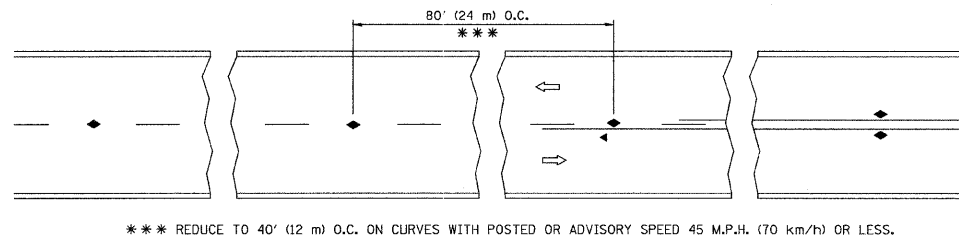

TWO-LANE/TWO-WAY

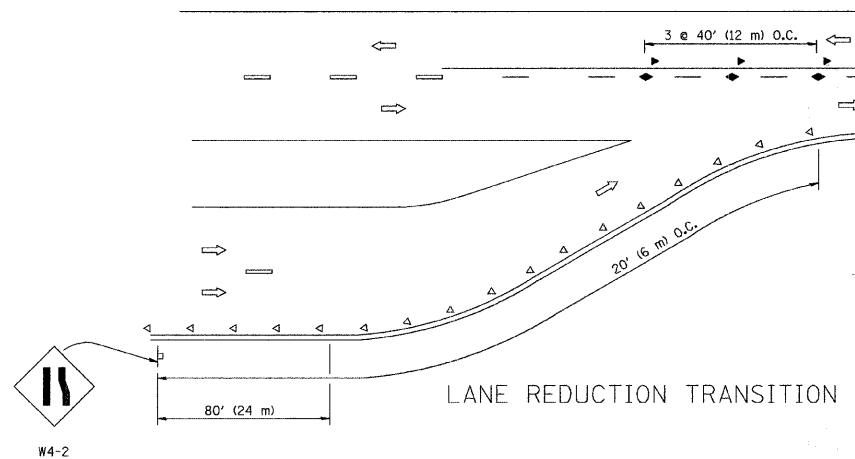

LANE REDUCTION TRANSITION

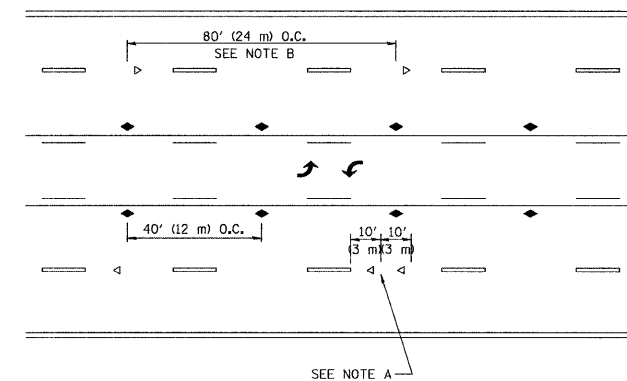

TWO-WAY LEFT TURN

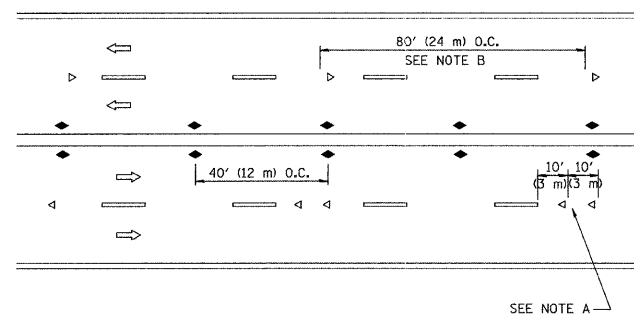

MULTI-LANE/UNDIVIDED

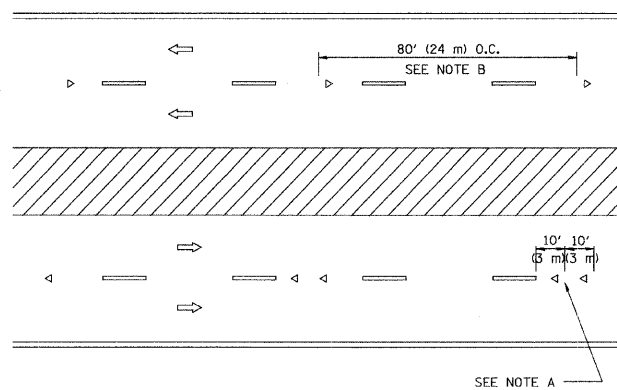

MULTI-LANE/DIVIDED

GENERAL NOTES

1. MARKERS USED WITH DASHED LINES SHALL BE CENTERED IN THE GAP BETWEEN SEGMENTS.
2. MARKERS USED ADJACENT TO SOLID LINES SHALL BE OFFSET 2 TO 3 (50 TO 75) TOWARD TRAFFIC AS SHOWN.
3. MARKERS THROUGH TANGENTS LESS THAN 500' (150 m) IN LENGTH BETWEEN CURVES SHALL BE INSTALLED AT THE LESSER OF THE TWO CURVE SPACINGS.

SYMBOLS

- YELLOW STRIPE
- WHITE STRIPE
- ◀ ONE-WAY AMBER MARKER
- ◁ ONE-WAY CRYSTAL MARKER (W/O)
- ◆ TWO-WAY AMBER MARKER

LANE MARKER NOTES

- B. REDUCE TO 40' (12 m) O.C. ON CURVES WHERE ADVISORY SPEEDS ARE 10 M.P.H. (20 km/h) LOWER THAN POSTED SPEEDS.
- A. USE DOUBLE LANE LINE MARKERS SPACED AS SHOWN.

DESIGN NOTES

1. DOUBLE LANE LINE MARKERS SHALL BE USED UNLESS SPECIFIED OTHERWISE.
2. EXCEPT AS SHOWN ON THE LANE REDUCTION TRANSITION AND FREEWAY EXIT RAMP DETAIL, MARKERS ARE NOT TO BE SPECIFIED ON RIGHT EDGE LINES.
3. THE EXACT MARKER LIMITS, SPACING, AND COLOR SHOULD BE INCLUDED IN THE PLANS.
4. MARKERS SHOULD NOT BE USED ALONGSIDE CURBS EXCEPT FOR EXTREMELY SHORT SECTIONS OF CURBS WHERE NOT MORE THAN TWO MARKERS WOULD BE INVOLVED.

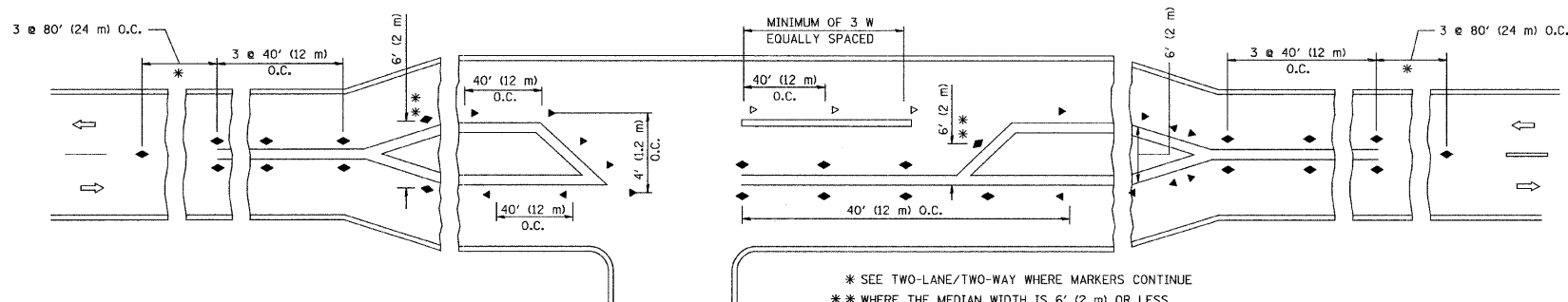

LEFT TURN

All dimensions are in inches (millimeters) unless otherwise shown.

FILE NAME = 08214-DTSL-07 - TC-11	USER NAME = goglienobt	DESIGNED —	REVISED —T. RAMMACHER 09-19-94	STATE OF ILLINOIS DEPARTMENT OF TRANSPORTATION	TYPICAL APPLICATIONS RAISED REFLECTIVE PAVEMENT MARKERS (SNOW-PLOW RESISTANT)	F.A.U. RTE.	SECTION	COUNTY	TOTAL SHEETS	SHEET NO.	
		CHECKED —	REVISED —T. RAMMACHER 03-12-99			1029	09-00058-00-RS	COOK	15	12	
		PLOT SCALE = 50.000' / IN.	REVISED —T. RAMMACHER 01-06-00			TC-11		CONTRACT NO. 63259			
		PLOT DATE = 1/4/2008	CHECKED —			REVISED —	SCALE:	SHEET NO. 12	OF 15 SHEETS	STA.	TO STA.

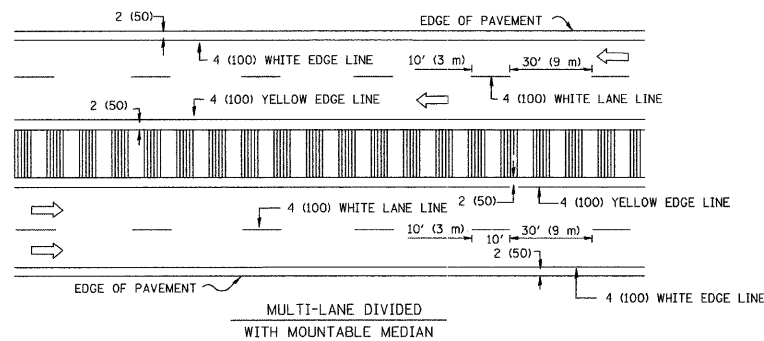
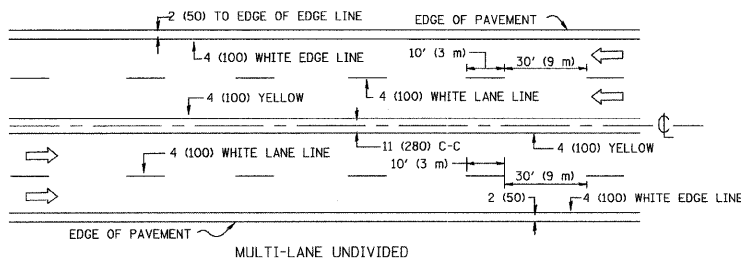
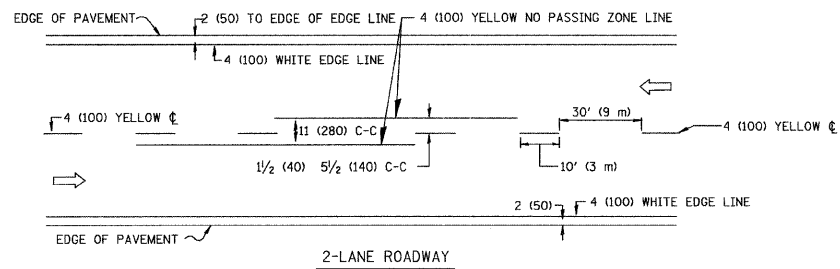

NOTE: MEDIANS WITH BARRIER CURB DO NOT REQUIRE AN EDGE LINE

TYPICAL LANE AND EDGE LINE MARKING

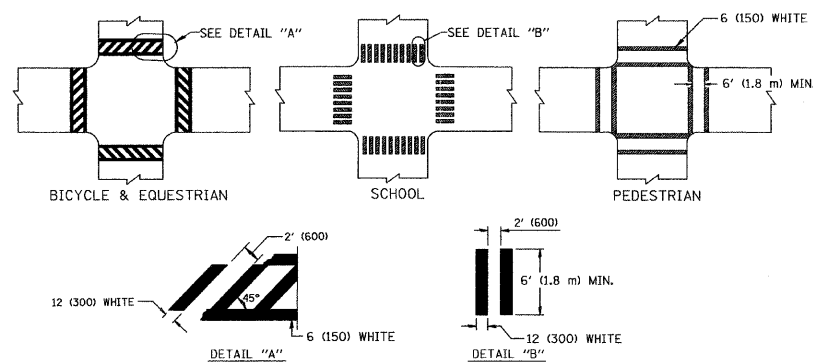

TYPICAL CROSSWALK MARKING

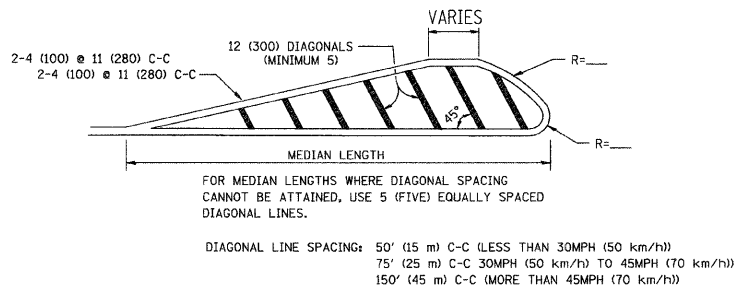
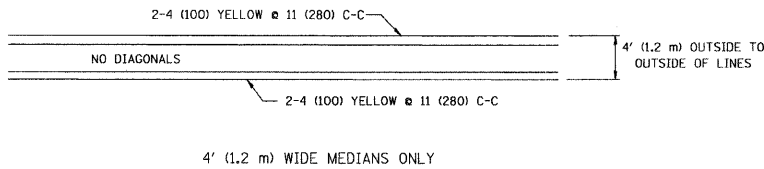

MEDIANS OVER 4' (1.2 m) WIDE

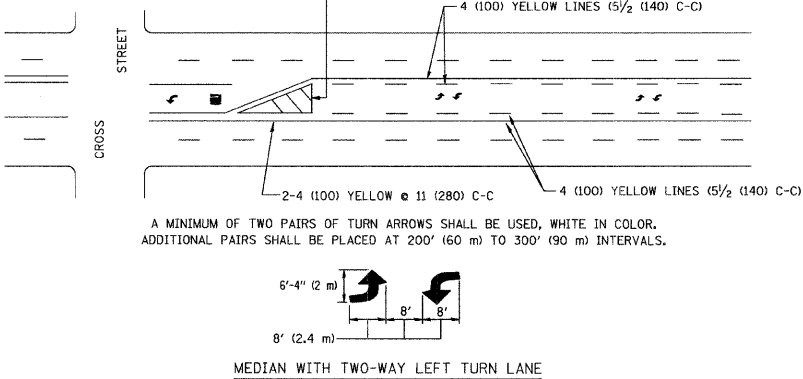

TYPICAL PAINTED MEDIAN MARKING

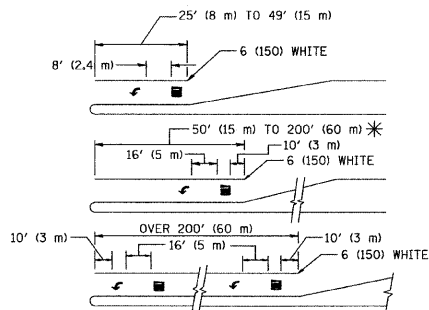

FULL SIZE LETTERS 8' (2.4 m) AND ARROWS SHALL BE USED.
 AREA = 15.6 SQ. FT. (1.5 m²) AREA = 20.8 SQ. FT. (1.9 m²)
 * TURN LANES IN EXCESS OF 400' (120 m) IN LENGTH MAY HAVE AN ADDITIONAL SET OF ARROW - "ONLY" INSTALLED MIDWAY BETWEEN THE OTHER TWO SETS OF ARROW - "ONLY".

TYPICAL LEFT (OR RIGHT) TURN LANE

TYPICAL TURN LANE MARKING

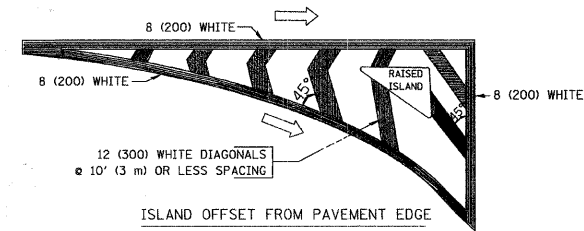

ISLAND OFFSET FROM PAVEMENT EDGE

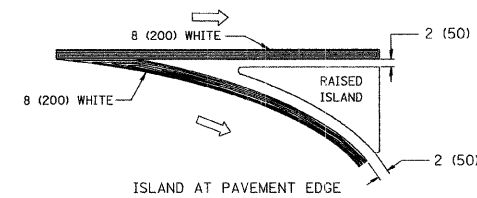

ISLAND AT PAVEMENT EDGE

TYPICAL ISLAND MARKING

TYPE OF MARKING	WIDTH OF LINE	PATTERN	COLOR	SPACING / REMARKS
CENTERLINE ON 2 LANE PAVEMENT	4 (100)	SKIP-DASH	YELLOW	10' (3 m) LINE WITH 30' (9 m) SPACE
CENTERLINE ON MULTI-LANE UNDIVIDED PAVEMENT	2 @ 4 (100)	SOLID	YELLOW	11 (280) C-C
NO PASSING ZONE LINES: FOR ONE DIRECTION	4 (100)	SOLID	YELLOW	5/2 (140) C-C FROM SKIP-DASH CENTERLINE
FOR BOTH DIRECTIONS	2 @ 4 (100)	SOLID	YELLOW	11 (280) C-C OMIT SKIP-DASH CENTERLINE BETWEEN
LANE LINES	4 (100)	SKIP-DASH	WHITE	10' (3 m) LINE WITH 30' (9 m) SPACE
	5 (125) ON FREEWAYS	SKIP-DASH	WHITE	
DOTTED LINES (EXTENSIONS OF CENTER, LANE OR TURN LANE MARKINGS)	SAME AS LINE BEING EXTENDED	SKIP-DASH	SAME AS LINE BEING EXTENDED	2' (600) LINE WITH 6' (1.8 m) SPACE
EDGE LINES	4 (100)	SOLID	YELLOW-LEFT WHITE-RIGHT	OUTLINE MOUNTABLE MEDIANS IN YELLOW; EDGE LINES ARE NOT USED NEXT TO BARRIER CURB
TURN LANE MARKINGS	6 (150) LINE; FULL SIZE LETTERS & SYMBOLS (8' (2.4m))	SOLID	WHITE	SEE TYPICAL TURN LANE MARKING DETAIL
TWO WAY LEFT TURN MARKING	2 @ 4 (100) EACH DIRECTION	SKIP-DASH AND SOLID	YELLOW	10' (3 m) LINE WITH 30' (9 m) SPACE FOR SKIP-DASH; 5/2 (140) C-C BETWEEN SOLID LINE AND SKIP-DASH LINE
	8' (2.4m) LEFT ARROW	IN PAIRS	WHITE	SEE TYPICAL TWO-WAY LEFT TURN MARKING DETAIL
CROSSWALK LINES (PEDESTRIAN) A. DIAGONALS (BIKE & EQUESTRIAN) B. LONGITUDINAL BARS (SCHOOL)	2 @ 6 (150) 12 (300) @ 45° 12 (300) @ 90°	SOLID SOLID SOLID	WHITE WHITE WHITE	NOT LESS THAN 6' (1.8 m) APART 2' (600) APART 2' (600) APART SEE TYPICAL CROSSWALK MARKING DETAILS.
STOP LINES	24 (600)	SOLID	WHITE	PLACE 4' (1.2 m) IN ADVANCE OF AND PARALLEL TO CROSSWALK, IF PRESENT. OTHERWISE, PLACE AT DESIRED STOPPING POINT. PARALLEL TO CROSSROAD CENTERLINE, WHERE POSSIBLE
PAINTED MEDIANS	2 @ 4 (100) WITH 12 (300) DIAGONALS @ 45° NO DIAGONALS USED FOR 4' (1.2 m) WIDE MEDIANS	SOLID	YELLOW: TWO WAY TRAFFIC WHITE: ONE WAY TRAFFIC	11 (280) C-C FOR THE DOUBLE LINE SEE TYPICAL PAINTED MEDIAN MARKING.
GORE MARKING AND CHANNELIZING LINES	8 (200) WITH 12 (300) DIAGONALS @ 45°	SOLID	WHITE	DIAGONALS: 15' (4.5 m) C-C (LESS THAN 30MPH (50 km/h)) 20' (6 m) C-C (30MPH (50 km/h) TO 45MPH (70 km/h)) 30' (9 m) C-C (OVER 45MPH (70 km/h))
RAILROAD CROSSING	24 (600) TRANSVERSE LINES; "RR" 15' (4.5 m) LETTERS; 16 (400) LINE FOR "X"	SOLID	WHITE	SEE STATE STANDARD 780001 AREA OF: "R"=3.6 SQ. FT. (0.33 m ²) EACH "X"=54.0 SQ. FT. (5.0 m ²)
SHOULDER DIAGONALS	12 (300) @ 45°	SOLID	WHITE - RIGHT YELLOW - LEFT	50' (15 m) C-C (LESS THAN 30MPH (50 km/h)) 75' (25 m) C-C (30 MPH (50 km/h) TO 45MPH (70 km/h)) 150' (45 m) C-C (OVER 45MPH (70 km/h))

FOR FURTHER DETAILS ON PAVEMENT MARKING REFER TO STANDARD SPECIFICATIONS FOR ROAD AND BRIDGE CONSTRUCTION AND STATE STANDARD 780001.

All dimensions are in inches (millimeters) unless otherwise shown.

FILE NAME = 08214-DTLS 02 - TC-13

USER NAME = gegljanobt	DESIGNED = EVERS	REVISED = T. RAMMACHER 10-27-94
	CHECKED =	REVISED = A. HOUSEH 10-09-96
PLOT SCALE = 50.000 / IN.	DRAWN =	REVISED = A. HOUSEH 10-17-96
PLOT DATE = 1/4/2008	CHECKED = 03-19-90	REVISED = T. RAMMACHER 01-06-00

STATE OF ILLINOIS
DEPARTMENT OF TRANSPORTATION

DISTRICT ONE		F.A.U. RTE.	SECTION	COUNTY	TOTAL SHEETS	SHEET NO.
TYPICAL PAVEMENT MARKINGS		1029	09-00058-00-RS	COOK	15	13
SCALE:		SHEET NO. 13 OF 15 SHEETS		STA.	TO STA.	
		TC-13		CONTRACT NO. 63259		
		FED. ROAD DIST. NO. 1		ILLINOIS FED. AID PROJECT M-9003 (339)		

LOOPS NEXT TO SHOULDERS

PROVIDE A PAVEMENT REPLACEMENT NOTE WHICH SHOULD EQUAL 3' (900 mm) X WIDTH OF PAVED SHOULDER.

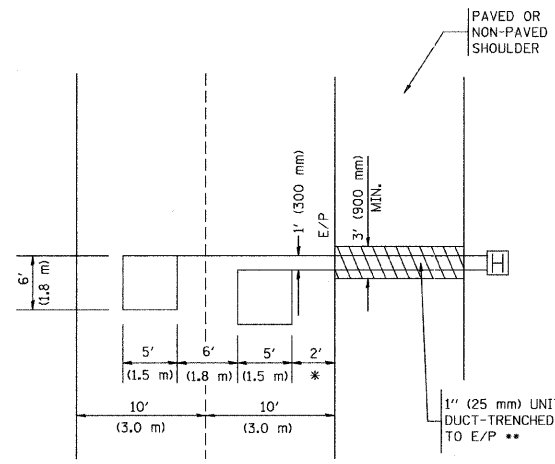

* = (600 mm)

** UNIT DUCT IS TO BE SHOWN ON PLAN SHEETS BUT SHALL NOT BE INCLUDED IN THE PAY ITEMS.

LEFT TURN LANES WITH MEDIANS
VOLUME DENSITY ("FAR OUT" DETECTION)
ON SAME APPROACH
(PROTECTED / PERMITTED LEFT TURN PHASING)

HANDHOLE LOCATION MAY VARY DEPENDING ON GEOMETRICS AND DESIGN OF TRAFFIC SIGNALS. HEAVY-DUTY HANDHOLES TO BE USED WHEN THE MEDIAN IS MOUNTABLE. REFER TO STANDARD B14001 TO ENSURE THAT HANDHOLE FITS IN MEDIAN.

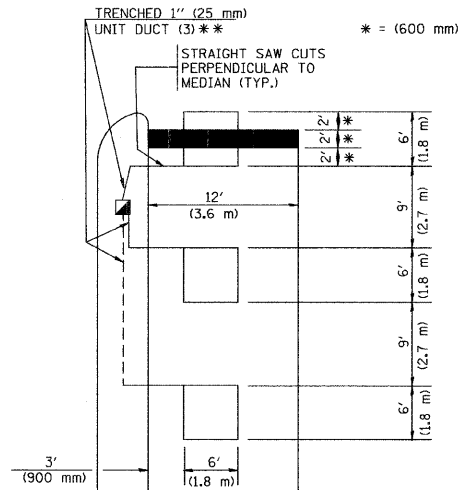

** UNIT DUCT IS TO BE SHOWN ON PLAN SHEETS BUT SHALL NOT BE INCLUDED IN THE PAY ITEMS.

NOTE: DUAL LEFT TURNS NOT SHOWN REFER TO PLAN SHEET FOR DETECTOR LOOP REPLACEMENT

LEFT TURN LANES WITHOUT MEDIANS
VOLUME DENSITY ("FAR OUT" DETECTION)
ON SAME APPROACH
(PROTECTED / PERMITTED LEFT TURN PHASING)

* = (600 mm)

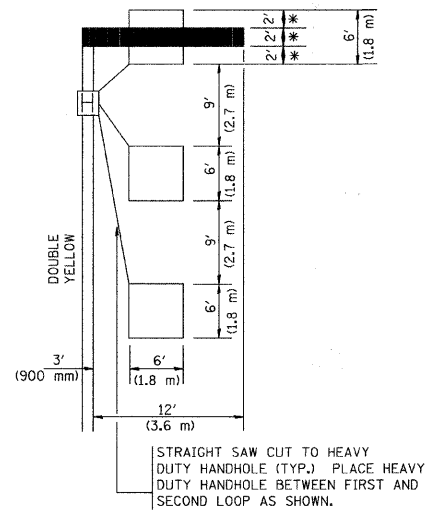

NOTE: DUAL LEFT TURNS NOT SHOWN REFER TO PLAN SHEET FOR DETECTOR LOOP REPLACEMENT

ARTERIAL-VOLUME DENSITY ("FAR OUT" DETECTION)
CROSS STREET-VOLUME DENSITY ("FAR OUT" DETECTION)

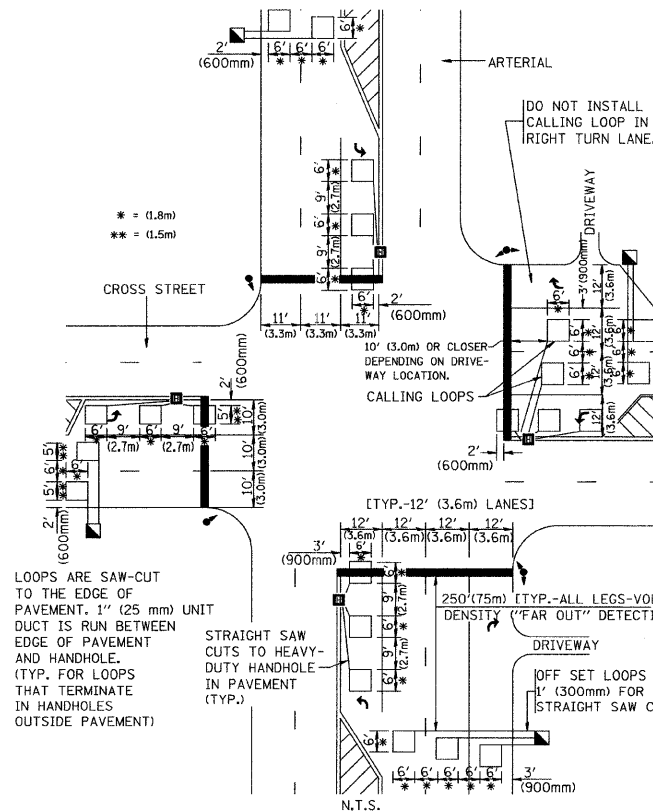

DETAIL 1
N.T.S.

ARTERIAL-VOLUME DENSITY ("FAR OUT" DETECTION)
CROSS STREET-NON VOLUME DENSITY ("UPTIGHT" PRESENCE DETECTION)

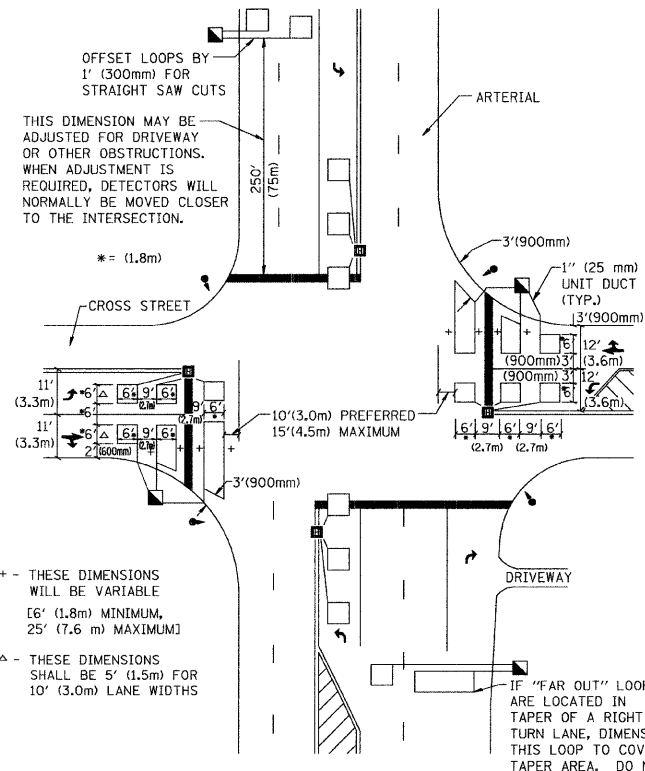

DETAIL 2
N.T.S.

NOTES:

VEHICLES LOOP DETECTORS

- * ALL LEAD IN CABLE SHALL BE TWO CONDUCTOR NO. 14 TWISTED, SHIELDED.
- * EACH DETECTOR LOOP SHALL HAVE ITS OWN SAW CUT FROM THE LOOP TO THE EDGE OF PAVEMENT OR TO A HANDHOLE IN THE PAVEMENT.
- * EACH DETECTOR LOOP SHALL HAVE ITS OWN ONE INCH (25 mm) UNIT DUCT BETWEEN THE EDGE OF PAVEMENT AND THE FIRST HANDHOLE OR JUNCTION BOX. EACH UNIT DUCT RUN SHALL BE SHOWN ON THE PLANS BY THE DESIGNER, BUT SHALL NOT BE PAID FOR SEPARATELY. THIS ITEM IS INCIDENTAL TO THE PAY ITEM FOR DETECTOR LOOPS.
- * ONE DIMENSION OF ALL DETECTOR LOOPS SHALL BE SIX FEET (1.8 m)
- * EACH LANE OF NON-LOCKING, PRESENCE DETECTION AND EACH LANE OF A DOUBLE LEFT TURN LANE REQUIRES A SEPARATE INDUCTIVE LOOP DETECTOR AND LEAD IN CABLE.
- * WHEN NON-LOCKING, PRESENCE DETECTION IS USED, MORE THAN ONE LOOP PER LANE IS REQUIRED BEHIND THE STOP BAR (i.e. 1-1/2, 1-3/4, 2).
- * WHEN SYSTEM LOOPS ARE REQUIRED ON AN APPROACH OF AN INTERSECTION, THE LOOPS USED FOR VOLUME DENSITY AND INTERSECTION TIMING SHALL ALSO BE USED AS SYSTEM DETECTORS. EACH ONE OF THESE TYPE OF LOOPS REQUIRES A SEPARATE TWO CONDUCTOR NO. 14 TWISTED SHIELDED CABLE AND A SEPARATE INDUCTIVE LOOP DETECTOR WHEN NEW CONTROLLERS ARE UTILIZED. THE DESIGNER SHALL LABEL THESE TYPES OF LOOPS AS "INTERSECTION AND SAMPLING (SYSTEM) DETECTORS" ON THE SIGNAL LAYOUT, THE INTERCONNECT PLAN AND THE SYSTEM CABLE PLAN. WHEN AN EXISTING CONTROLLER IS UTILIZED FOR THIS TYPE OF DETECTION, THE PAY ITEM "INDUCTIVE LOOP DETECTOR WITH SYSTEM OUTPUT" SHOULD BE USED.

PLACEMENT OF DETECTORS

THE FOLLOWING FIGURES REPRESENT THE MOST COMMON DETECTOR LOOP LOCATIONS AND SIZES. ADJUSTMENTS WILL BE NECESSARY FOR SPECIFIC GEOMETRIC CONSIDERATIONS.

LOCATIONS AND DEMENSIONS OF DETECTOR LOOPS ARE REQUIRED ON ALL SIGNAL LAYOUT PLAN SHEETS.

"FAR OUT" DETECTION REFERS TO LOCKING, PRESENCE TYPE DETECTION LOCATED IN THRU LANES, RIGHT TURN LANES, AND RIGHT TURN LANE TAPER AREAS (IF APPLICABLE), USUALLY 250' (75 m) IN ADVANCE OF STOP BARS. "UPTIGHT" DETECTION REFERS TO NON-LOCKING PRESENCE TYPE DETECTION LOCATED IN ALL LANES AND 10'-15' (3.0 m-4.5 m) BEHIND THE CROSSING STREET'S EDGE OF PAVEMENT EXTENDED.

NOTE:

ALL DETAILS AND NOTES SHOWN ARE FROM THE I.D.O.T. DISTRICT 1 TRAFFIC SIGNAL DESIGN GUIDELINES DATED JANUARY 1995

THIS DRAWING HAS BEEN PREPARED TO ASSIST THE RESIDENT ENGINEER FOR ALL ROADWAY RESURFACING OR S.M.A.R.T. PROJECTS WHERE THE DIMENSIONS ARE NOT SHOWN ON THE PLANS AND THE FINAL LOCATIONS FOR CROSSWALKS OR STOP BARS ARE NOT DETERMINED.

FILE NAME = 09214-DTIS-08 - TS-07	USER NAME = geglanoht	DESIGNED —	REVISIONS —	STATE OF ILLINOIS DEPARTMENT OF TRANSPORTATION	DISTRICT 1 - DETECTOR LOOP INSTALLATION DETAILS FOR ROADWAY RESURFACING	F.A.U. RT#	SECTION	COUNTY	TOTAL SHEETS	SHEET NO.	
PLOT SCALE = 50.0000' / IN.	DRAWN — R.K.F.	CHECKED —	REVISIONS —			1029	09-00058-00-RS	COOK	15	14	
PLOT DATE = 1/4/2008	CHECKED —	REVISIONS —	REVISIONS —			TS-07					
						CONTRACT NO. 63259					
SCALE: SHEET NO. 14 OF 15 SHEETS STA. TO STA.						FED. ROAD DIST. NO. 1 ILLINOIS FED. AID PROJECT M-9003 (339)					

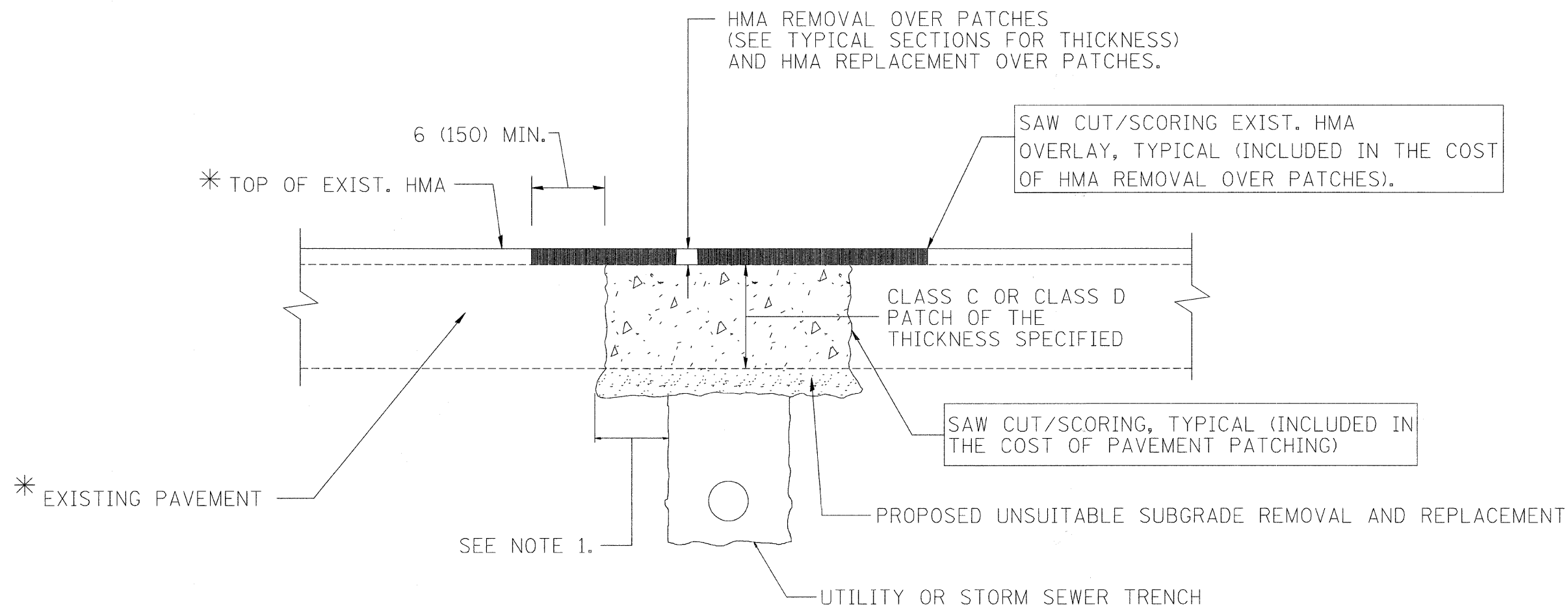

* SEE TYPICAL SECTIONS FOR THICKNESS AND MATERIALS

NOTES:

1. THE WIDTH OF THE FULL DEPTH PATCH OVER A TRENCH SHALL BE 12 (300) WIDER ON EACH SIDE OF THE TRENCH.
2. FOR METHOD OF MEASUREMENT AND BASIS OF PAYMENT, SEE RECURRING SPECIAL PROVISION "PATCHING WITH HOT-MIX ASPHALT OVERLAY REMOVAL".

SEQUENCE OF CONSTRUCTION

1. REMOVE THE EXISTING HMA MATERIAL OVER THE AREA TO BE PATCHED.
2. REMOVE AND REPLACE FULL DEPTH PATCHES
3. REPLACE HMA MATERIAL OVER THE AREA TO BE PATCHED.

ALL DIMENSIONS ARE IN INCHES (MILLIMETERS) UNLESS OTHERWISE SHOWN.

FILE NAME = 09214-DTLS-06 - BD-22	USER NAME = geglienobt	DESIGNED -- R. SHAH	REVISED -- A. ABBAS 01-20-98	STATE OF ILLINOIS DEPARTMENT OF TRANSPORTATION	PAVEMENT PATCHING FOR HMA SURFACED PAVEMENT	F.A.U. RTE.	SECTION	COUNTY	TOTAL SHEETS	SHEET NO.	
		CHECKED --	REVISED -- A. ABBAS 04-27-98			1029	09-00058-00-RS	COOK	15	15	
		PLOT SCALE = 50.000' / IN.	REVISED -- R. BORO 01-01-07			BD400-04 (BD-22)		CONTRACT NO. 63259			
		PLOT DATE = 1/4/2008	REVISED -- R. BORO 09-04-07			SCALE:	SHEET NO. 15 OF 15 SHEETS	STA.	TO STA.	FED. ROAD DIST. NO. 1	ILLINOIS