

F.A.P. RTE.	SECTION	COUNTY	TOTAL SHEETS	SHEET NO.
305	09-00112-00-TL	McHENRY	24+2=26	1
FED. ROAD DIST. NO. 7		ILLINOIS	FED. AID PROJECT ARA-9003(419)	

**STATE OF ILLINOIS
DEPARTMENT OF TRANSPORTATION
DIVISION OF HIGHWAYS**

**PLANS FOR PROPOSED FEDERAL AID HIGHWAY
F.A.P. ROUTE 305 - U.S. ROUTE 14 (VIRGINIA STREET)
DOLE AVENUE TO DEVONSHIRE LANE/KEITH AVENUE
A.R.R.A. IMPROVEMENT
SECTION 09-00112-00-TL
PROJECT NO. ARA-9003(419)
TRAFFIC SIGNAL MODERNIZATION AND INTERCONNECT
CITY OF CRYSTAL LAKE
McHENRY COUNTY
C-91-811-09**



LOCATION OF SECTION INDICATED THIS: - [shaded box] -

**STATE OF ILLINOIS
DEPARTMENT OF TRANSPORTATION
DIVISION OF HIGHWAYS**

APPROVED August 27, 2009
[Signature]
CITY ENGINEER, CITY OF CRYSTAL LAKE

PASSED SEPTEMBER 2, 2009
[Signature]
DISTRICT ONE ENGINEER OF LOCAL ROADS & STREETS

RELEASING FOR BID
BASED ON LIMITED
REVIEW SEPTEMBER 2, 2009
[Signature]
DEPUTY DIRECTOR OF HIGHWAYS, REGION ONE ENGINEER



[Signature] 11/30/09
REGISTERED P.E., STATE OF ILLINOIS
PLANS PREPARED BY:
CIVILTECH
450 E. Devon Ave, Suite 300 - Itasca, Illinois 60143
Tel: 630.773.3900 - Fax: 630.773.3975
www.civiltechinc.com

PRINTED BY THE AUTHORITY OF THE STATE OF ILLINOIS

INDEX OF SHEETS

SHEET NO.	DESCRIPTION
1	COVER SHEET
2	SUMMARY OF QUANTITIES, GENERAL NOTES AND STATE STANDARDS
3	TEMPORARY TRAFFIC SIGNAL INSTALLATION PLAN U.S. ROUTE 14 AND DOLE AVENUE
4	TEMPORARY CABLE PLAN U.S. ROUTE 14 AND DOLE AVENUE
5	TRAFFIC SIGNAL INSTALLATION PLAN U.S. ROUTE 14 AND DOLE AVENUE
6	CABLE PLAN U.S. ROUTE 14 AND DOLE AVENUE
7	TEMPORARY TRAFFIC SIGNAL INSTALLATION PLAN U.S. ROUTE 14 AND McHENRY AVENUE
8	TEMPORARY CABLE PLAN U.S. ROUTE 14 AND McHENRY AVENUE
9	TRAFFIC SIGNAL INSTALLATION PLAN U.S. ROUTE 14 AND McHENRY AVENUE
10	CABLE PLAN U.S. ROUTE 14 AND McHENRY AVENUE
11	TEMPORARY TRAFFIC SIGNAL INSTALLATION PLAN U.S. ROUTE 14 AND DEVONSHIRE LANE/KEITH AVENUE
12	TEMPORARY CABLE PLAN U.S. ROUTE 14 AND DEVONSHIRE LANE/KEITH AVENUE
13	TRAFFIC SIGNAL INSTALLATION PLAN U.S. ROUTE 14 AND DEVONSHIRE LANE/KEITH AVENUE
14	CABLE PLAN U.S. ROUTE 14 AND DEVONSHIRE LANE/KEITH AVENUE
15-17	TRAFFIC SIGNAL INTERCONNECT PLAN
18	INTERCONNECT SCHEMATIC
19-20	MAST ARM MOUNTED STREET NAME SIGNS
21-24	IDOT DISTRICT 1 STANDARD TRAFFIC SIGNAL DESIGN DETAILS
24a.	D.1 STANDARD TC-10 TRAFFIC CONTROL AND PROTECTION FOR SIDE ROADS, INTERSECTIONS, AND DRIVEWAYS
24b.	D.1 STANDARD TC-1A TRAFFIC CONTROL AND PROTECTION AT TURN BAYS

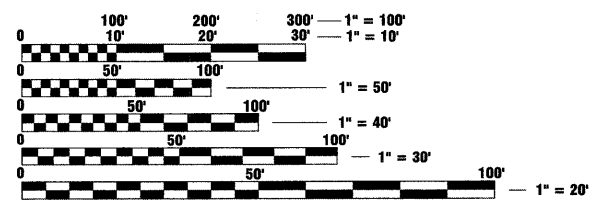

FULL SIZE PLANS HAVE BEEN PREPARED USING STANDARD ENGINEERING SCALES. REDUCED SIZED PLANS WILL NOT CONFORM TO STANDARD SCALES. IN MAKING MEASUREMENTS ON REDUCED PLANS, THE ABOVE SCALES MAY BE USED.

**J.U.L.I.E.
JOINT UTILITY LOCATION INFORMATION FOR EXCAVATION
1-800-892-0123**

CONTRACT NO. 63275

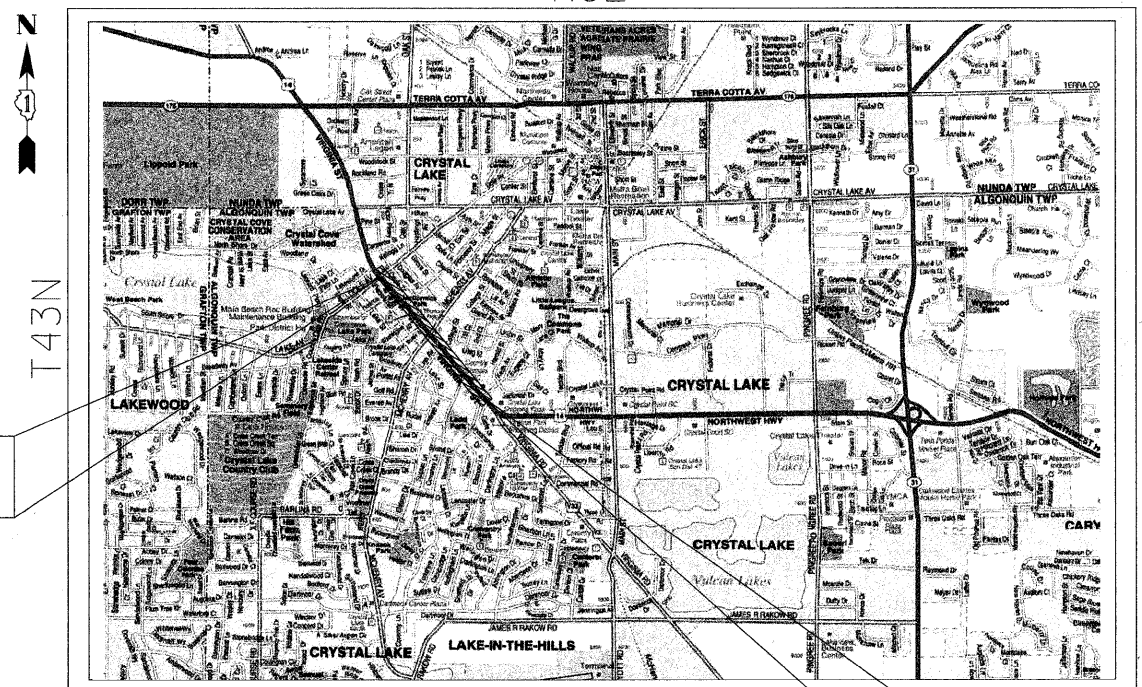

PROJECT LENGTH:
4,130 FT. (0.78 MILES)
POSTED SPEEDS:
U.S. ROUTE 14 (VIRGINIA STREET)
DEVONSHIRE LANE/KEITH AVENUE TO McHENRY AVENUE - 35 MPH
McHENRY AVENUE TO DOLE AVENUE - 30 MPH
DESIGN DESIGNATION:
U.S. ROUTE 14 (VIRGINIA STREET) - 24,800 (2007) - SRA

LOCATION MAP
NOT TO SCALE

PROJECT ENDS
DEVONSHIRE LANE/
KEITH AVENUE

PROJECT BEGINS
DOLE AVENUE

J:\2266\Cad\Sheets\2266_cover.dwg
Aug 26, 2009 - 1:26PM

FEDERAL AID ENGINEER: MR. ALEX HOUSEH, P.E. (847) 705-4410 SCHAMBURG, IL
CONSULTANT ENGINEER: JOSEPH EMRY, P.E. CIVILTECH ENGINEERING, INC.