

# STATE OF ILLINOIS DEPARTMENT OF TRANSPORTATION DIVISION OF HIGHWAYS

## PLANS FOR PROPOSED FEDERAL AID HIGHWAY

|                           |                |          |                  |           |
|---------------------------|----------------|----------|------------------|-----------|
| F.A.U. RTE.               | SECTION        | COUNTY   | TOTAL SHEETS     | SHEET NO. |
| --                        | 09-00186-00-RS | COOK     | 17               | 1         |
| FED. ROAD DIST. NO. 1     |                | ILLINOIS | FED. AID PROJECT |           |
| <b>CONTRACT NO. 63282</b> |                |          |                  |           |

| DESCRIPTION   | SHEET NO. |
|---|-----------|
| TITLE SHEET   | 1         |
| SUMMARY OF QUANTITIES   | 2         |
| GENERAL NOTES & IDOT STANDARDS  | 3         |
| TYPICAL SECTIONS  | 4         |
| EXISTING CONDITIONS AND REMOVAL PLAN  | 5-8       |
| PROPOSED PLAN   | 9-12      |
| CONSTRUCTION DETAILS  | 13        |
| BUTT JOINT AND BITUMINOUS TAPER DETAILS                                     | 14        |
| CURB OR CURB AND GUTTER REMOVAL AND REPLACEMENT                             | 15        |
| DISTRICT ONE TYPICAL PAVEMENT MARKINGS                                      | 16        |
| TRAFFIC CONTROL AND PROTECTION FOR SIDE ROADS, INTERSECTIONS, AND DRIVEWAYS | 17        |

**RESURFACING WILMETTE AVENUE/10TH STREET (FAU 1297)  
VILLAGE OF WILMETTE  
LAKE AVENUE TO SHERIDAN ROAD  
L.A SECTION 09-00186-00-RS  
PROJECT ARA-9003 (305)  
COOK COUNTY  
C-91-590-09**

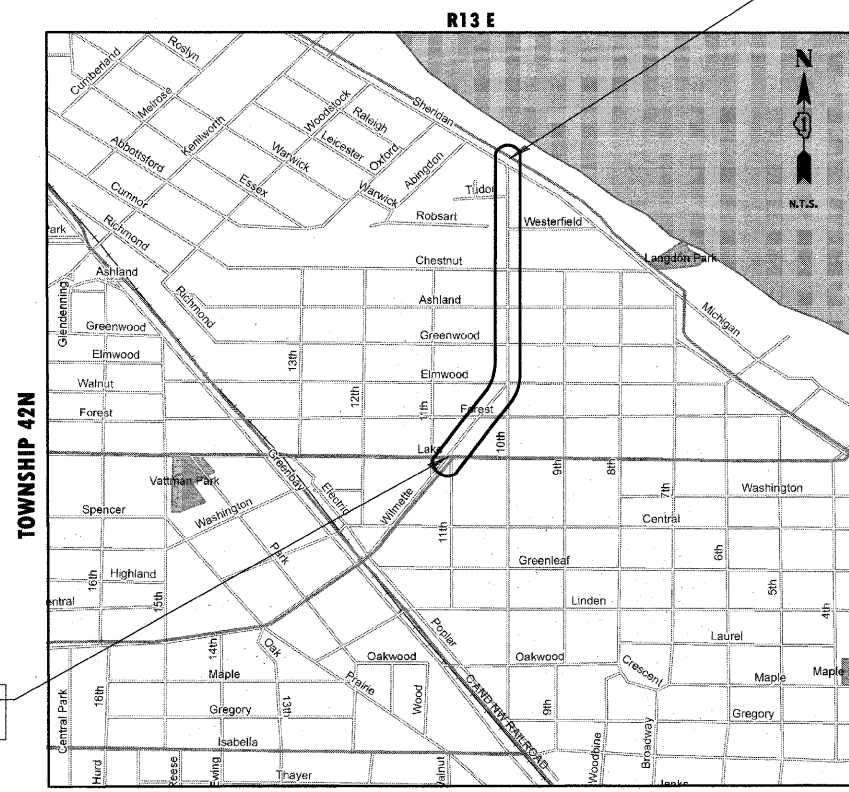
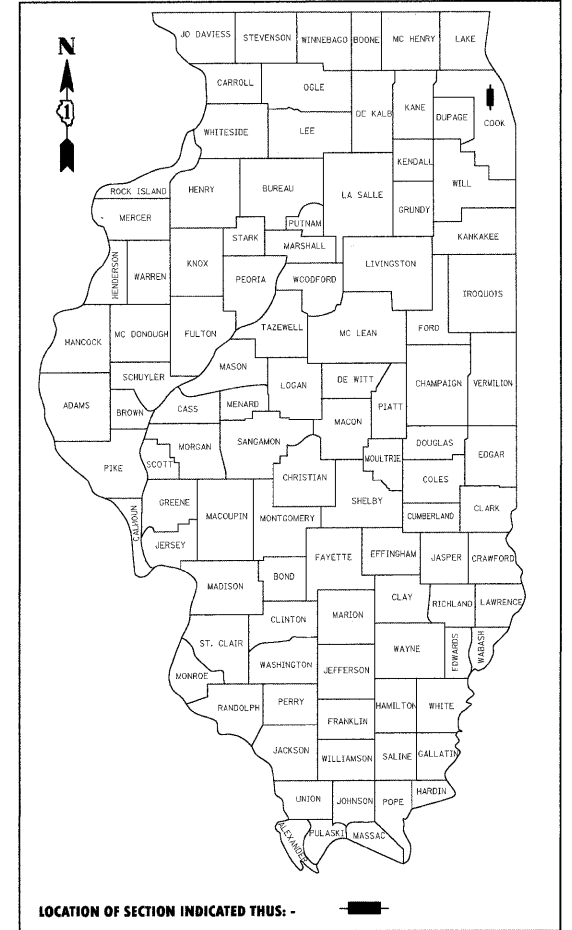

**PROJECT ENDS  
STA. 36+66**

**OMISSION:  
NONE**

**PROJECT BEGINS  
STA. 0+00**

**TRAFFIC DATA  
ADT (YEAR) = 5200 (2009)**

**POSTED SPEED  
30 MPH (EXISTING)  
30 MPH (PROPOSED)**

**DESIGN DESIGNATION: COLLECTOR**

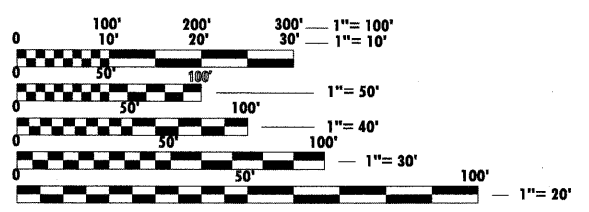

**FULL SIZE PLANS HAVE BEEN PREPARED USING STANDARD ENGINEERING SCALES. REDUCED SIZED PLANS WILL NOT CONFORM TO STANDARD SCALES. IN MAKING MEASUREMENTS ON REDUCED PLANS, THE ABOVE SCALES MAY BE USED.**

**J.U.L.I.E.  
JOINT UTILITY LOCATION INFORMATION FOR EXCAVATION  
8-1-1 OR 800-892-0123**

**CONTRACT NO. 63282**

**PROJECT ENGINEER: JORGE CRUZ  
PROJECT MANAGER: JORGE CRUZ**

**LOCATION MAP**

**GROSS LENGTH OF PROJECT = 3666 LINEAL FEET (0.70 MILES)  
NET LENGTH OF PROJECT = 3666 LINEAL FEET (0.70 MILES)**

**STATE OF ILLINOIS  
DEPARTMENT OF TRANSPORTATION  
DIVISION OF HIGHWAYS**

APPROVED AUGUST 14, 2009  
*Jorge Cruz*  
VILLAGE ENGINEER, VILLAGE OF WILMETTE

PASSED AUGUST 31, 2009  
*Cheryl A. ...*  
DISTRICT 1 ENGINEER OF LOCAL ROADS AND STREETS

RELEASING FOR BID BASED ON LIMITED REVIEW AUGUST 26, 2009  
*Diane M. O'Keefe*  
DEPUTY DIRECTOR OF HIGHWAYS, REGION ONE ENGINEER

**JORGE A. CRUZ**  
062-051712  
REGISTERED PROFESSIONAL ENGINEER  
STATE OF ILLINOIS

*Jorge Cruz*  
ENGINEER  
8-14-09  
DATE

ILLINOIS REGISTRATION No. 062-051712  
EXPIRATION DATE: 11/30/09

ASSOCIATE FIELD ENGINEER: KEVIN STALLWORTH (847) 705-4169