

PLAN	SURVEYED	DATE
	PLOTTED	
	NOTED	
	RT. OF WAY CHECKED	
	NO. _____	
	CADD FILE NAME	

PROFILE	SURVEYED	DATE
	PLOTTED	
	NOTED	
	GRADES CHECKED	
	STRUCTURE NOTATION CHECKED	
	NO. _____	

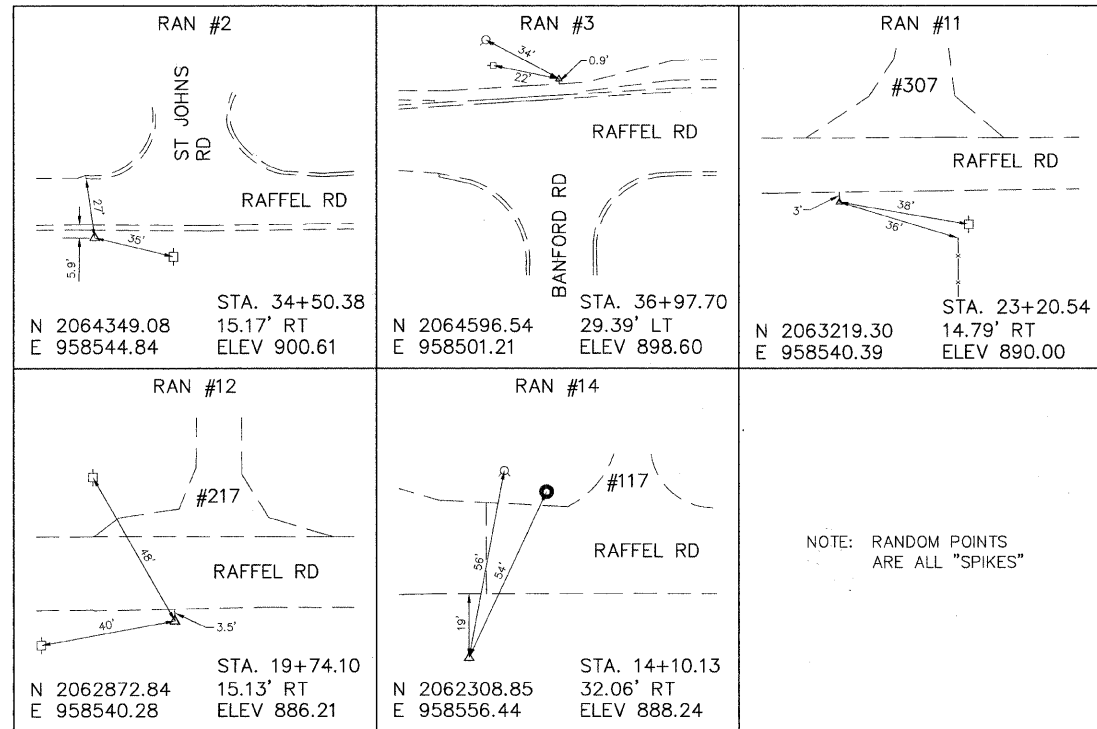

NOTE: RANDOM POINTS ARE ALL "SPIKES"

RAFFEL ROAD ALIGNMENT

STA. 13+00
N 2062198.77
E 958524.17

BENCHMARKS

- N.E. BOLT ON FIRE HYDRANT AT STA. 14+20, 23' LT, ELEV 889.77
- SPIKE EAST SIDE OF POWER POLE AT STA. 36+76, 36' LT, ELEV 898.16

PI STA. 24+00.15
N 2063298.92
E 958525.70

STA. 36+50
N 2064548.76
E 958530.43

HOT-MIX ASPHALT MIXTURE REQUIREMENTS		
ITEM	AC TYPE	AIR VOIDS
HOT-MIX ASPHALT (FULL DEPTH), 9"		
HOT-MIX ASPHALT SURFACE COURSE, MIX "C", N50, 1 1/2", (IL 9.5mm)	PG 64-22	4% @ 50 Gyr.
HOT-MIX ASPHALT BINDER COURSE, IL-19.0, N50, 2 1/2"	PG 64-22*	4% @ 50 Gyr.
HOT-MIX ASPHALT BASE COURSE, 5"	PG 58-22*	4% @ 50 Gyr.
HOT-MIX ASPHALT WIDENING		
HOT-MIX ASPHALT BASE COURSE WIDENING, 7 1/2"	PG 58-22*	4% @ 50 Gyr.
INCIDENTAL HOT-MIX ASPHALT SURFACING		
INCIDENTAL HOT-MIX ASPHALT SURFACING, MIX "C", N50, (IL 9.5mm)	PG 64-22*	4% @ 50 Gyr.
HOT-MIX ASPHALT SHOULDERS		
HOT-MIX ASPHALT SHOULDERS, 4" **	PG 64-22*	2% @ 30 Gyr.

THE UNIT WEIGHT USED FOR ALL HOT-MIX ASPHALT QUANTITIES IS 112 POUNDS PER INCH THICKNESS PER SQUARE YARD.
* WHEN RAP EXCEEDS 20%, THE NEW ASPHALT BINDER IN THE MIX SHALL BE PG 58-22.
** SAME MIXES AS BINDER COURSE AND SURFACE COURSE.

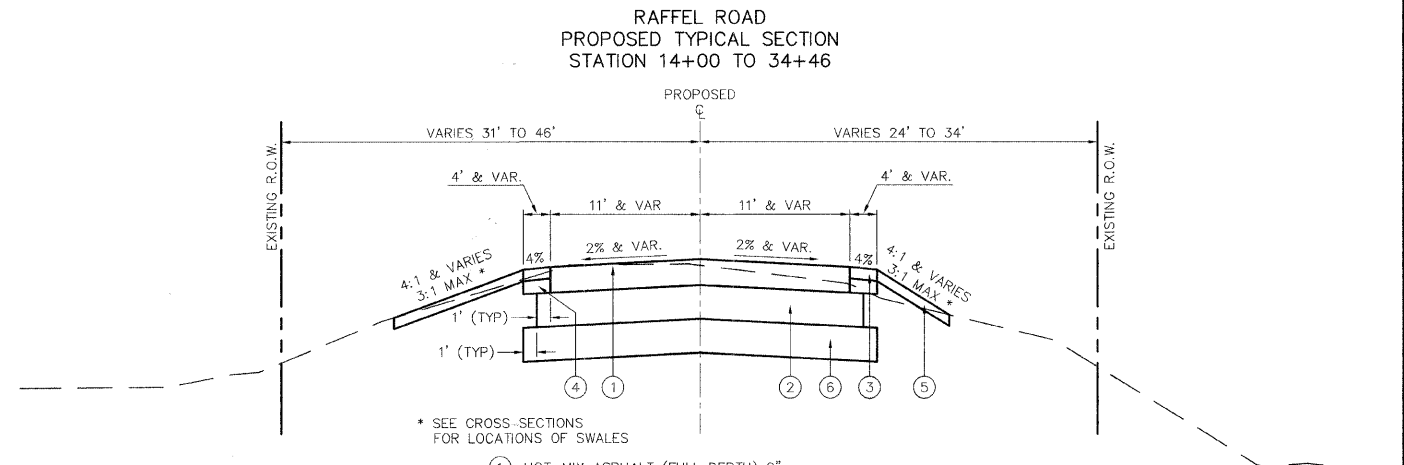
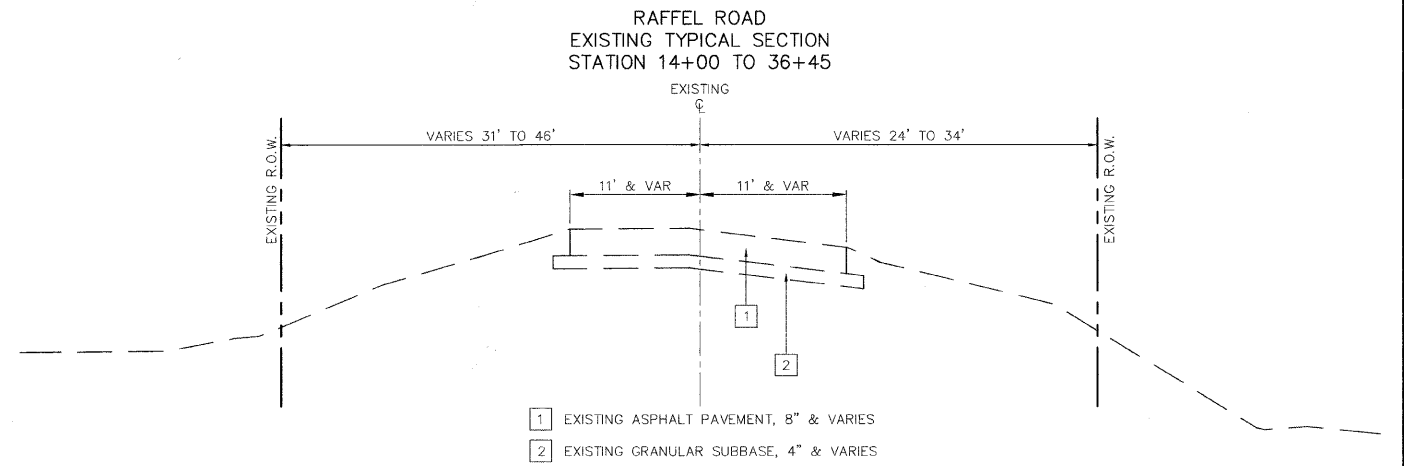

- * SEE CROSS SECTIONS FOR LOCATIONS OF SWALES
- HOT-MIX ASPHALT (FULL DEPTH) 9"
 - AGGREGATE SUBGRADE, 12"
 - HOT-MIX ASPHALT SHOULDERS, 4"
 - SUB-BASE GRANULAR MATERIAL, TYPE B
 - TOPSOIL FURNISH AND PLACE, 4" AND SEEDING, CLASS 2A
 - POROUS GRANULAR EMBANKMENT, SUBGRADE 12" NOMINAL (FIELD VERIFY DEPTH REQUIRED, SEE GEOTECHNICAL REPORT) STA. 14+00 TO STA. 34+46.

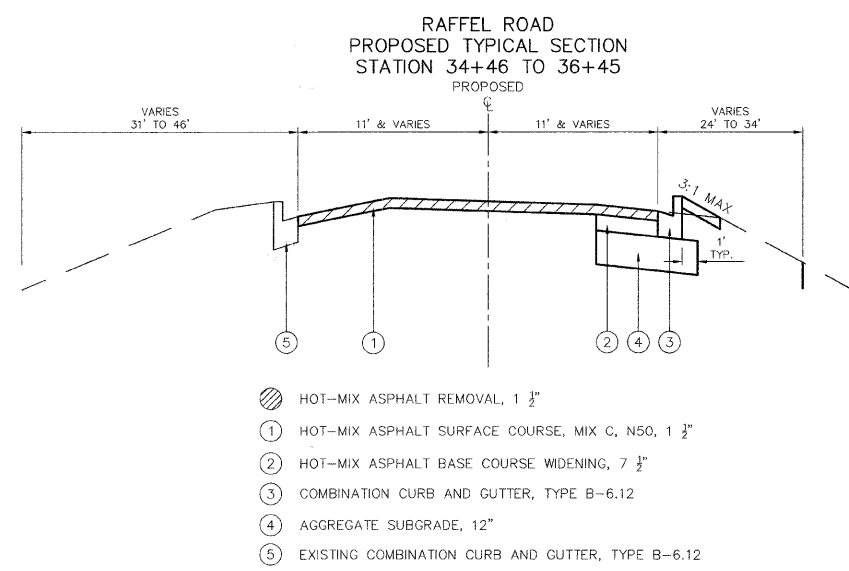

- HOT-MIX ASPHALT REMOVAL, 1 1/2"
- HOT-MIX ASPHALT SURFACE COURSE, MIX C, N50, 1 1/2"
- HOT-MIX ASPHALT BASE COURSE WIDENING, 7 1/2"
- COMBINATION CURB AND GUTTER, TYPE B-6.12
- AGGREGATE SUBGRADE, 12"
- EXISTING COMBINATION CURB AND GUTTER, TYPE B-6.12

APR 28, 2009 11:41:51 a.m. P:\03\03102003\CAD\PHASE 2\DWG\10203-SHT-NOTES.DWG

FILE NAME =	USER NAME =	DESIGNED --	REVISED --
		DRAWN --	REVISED --
		CHECKED --	REVISED --
		DATE --	REVISED --

**STATE OF ILLINOIS
DEPARTMENT OF TRANSPORTATION**



**RAFFEL ROAD IMPROVEMENTS
TYPICAL SECTIONS, ALIGNMENT AND TIES**

F.A.U. RTE.	SECTION	COUNTY	TOTAL SHEETS	SHEET NO.
041	09-00110-00-PV	McHENRY	22	4
RAFFEL ROAD		CONTRACT NO. 63283		
FED. ROAD DIST. NO. 1		ILLINOIS FED. AID PROJECT ARA-9003(445)		

SCALE: SHEET NO. OF SHEETS STA. TO STA.